

FILE: J:\INDO\102004_IL-DB\7\1-72_Illopolis\3-LongPoint\0840163-72C88-007-approxslab2.dgn
 SAVE DATE: 3/29/2013

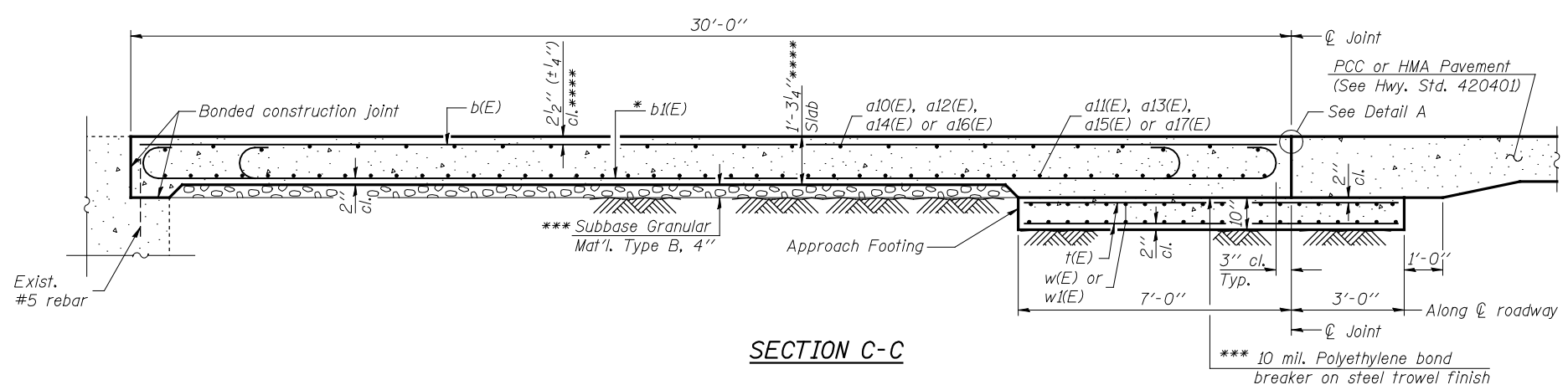

SECTION C-C

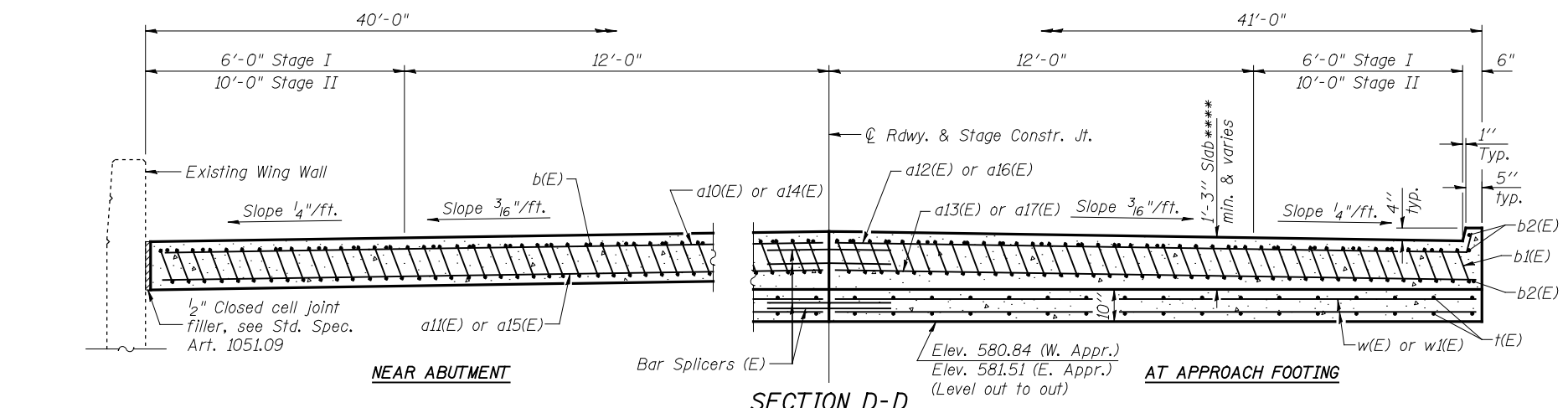

SECTION D-D

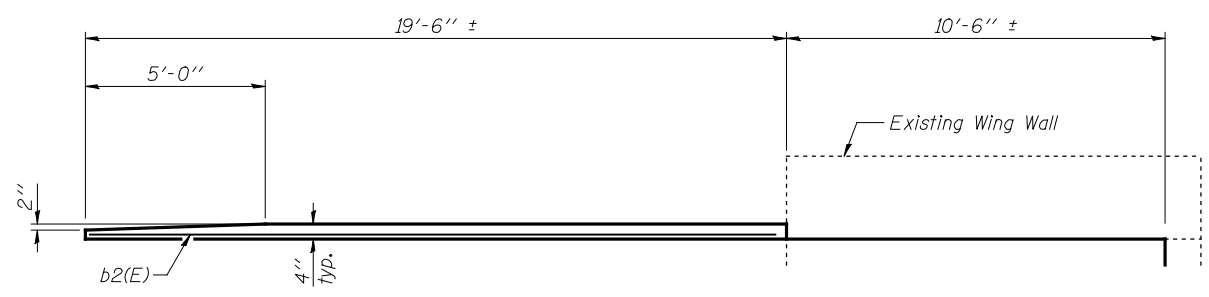

VIEW E-E

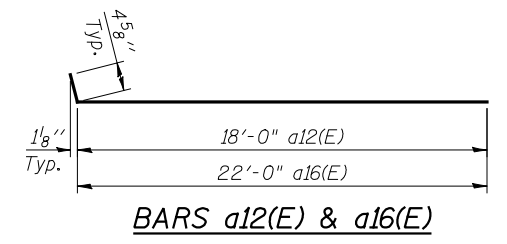

BARS a12(E) & a16(E)

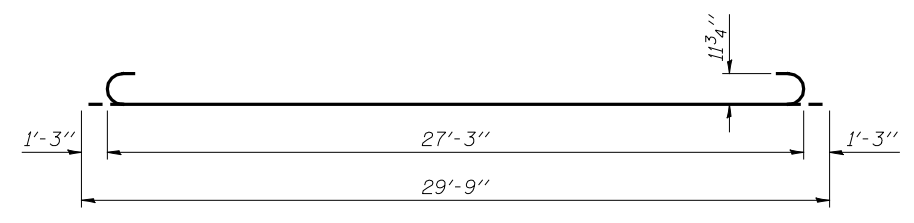

BAR b1(E)

Notes:
 See sheet 6 of 10 for Detail A.
 Approach slab and parapet concrete shall be paid for as Concrete Superstructure.
 Approach footing concrete shall be paid for as Concrete Structures.
 Reinforcement shall be paid for as Reinforcement Bars, Epoxy Coated.
 The approach footing maximum applied service bearing pressure (Qmax) = 2.0 ksf.
 For bar splicer details, see sheet 10 of 10.
 Cost of excavation for approach footing included with Concrete Structures.

* Tilt #9 b1(E) bars as required to maintain clearance.
 *** Cost included with Concrete Superstructure.
 **** Before grinding according to Bridge Smoothness Specification.

**BILL OF MATERIAL
(4 APPROACHES)**

Bar	No.	Size	Length	Shape		
a10(E)	36	#4	17'-8"	—		
a11(E)	64	#5	17'-8"	—		
a12(E)	64	#4	18'-5"	—		
a13(E)	120	#5	18'-2"	—		
a14(E)	36	#4	21'-8"	—		
a15(E)	64	#5	21'-8"	—		
a16(E)	64	#4	22'-5"	—		
a17(E)	120	#5	22'-2"	—		
b(E)	128	#4	29'-8"	—		
b1(E)	384	#9	29'-9"	—		
b2(E)	24	#4	19'-2"	—		
t(E)	336	#4	9'-8"	—		
w(E)	160	#5	18'-2"	—		
w1(E)	160	#5	22'-2"	—		
					EB	WB
Concrete Superstructure			Cu. Yd.		118.8	118.8
Concrete Structures			Cu. Yd.		25.3	25.3
Reinforcement Bars, Epoxy Coated			Pound		30480	30480

BA-0 12-12-12 (Modified)

(Sheet 2 of 2)

PART B - SHEET 56 of 67

FILE NAME =	USER NAME = DCD	DESIGNED - CMV	REVISED -
... \0840163-72C88-007-approxslab2.dgn	CHECKED - DCD	REVISIONS -	
PLOT SCALE =	DRAWN - P. Ray	REVISIONS -	
PLOT DATE = 04/02/2013 15:18:53	CHECKED - CMV/DCD	REVISIONS -	

**STATE OF ILLINOIS
DEPARTMENT OF TRANSPORTATION**

**BRIDGE APPROACH SLAB DETAILS
STRUCTURE NO. 084-0163(EB) & 084-0164(WB)**

SHEET NO. 7 OF 10 SHEETS

F.A.I. RTE. 72	SECTION (84-10-3)RS-5	COUNTY SANGAMON	TOTAL SHEETS 95	SHEET NO. 84
STA. 799+18.00		CONTRACT NO. 72C88		
ILLINOIS FED. AID PROJECT				