

TYPICAL SMART TRAFFIC MONITORING SYSTEM TO BE PLACED IN EACH DIRECTION

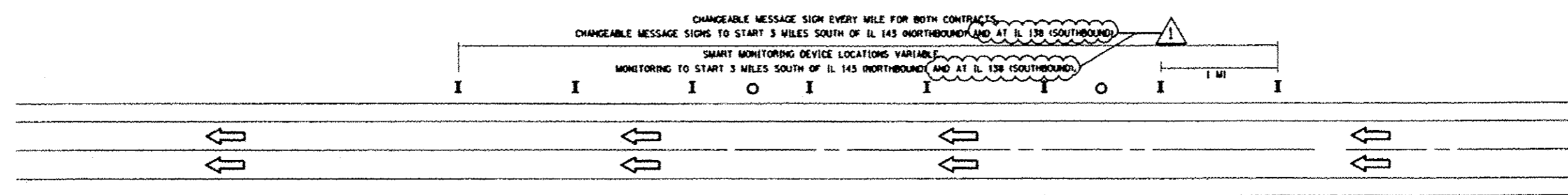

(SOUTHBOUND LANES ILLUSTRATED)

- NOTES:**
1. CONTRACT NO. 76099
 2. TYPICAL DRAWING SHOWN ABOVE REPRESENTS BOTH NORTHBOUND AND SOUTHBOUND. LUMP SUM PAY ITEM REPRESENTS BOTH DIRECTIONS.
 3. ACTUAL LOCATION OF SMART MONITORING DEVICES BASED ON MANUFACTURER'S SPECIFICATION AND "SMART TRAFFIC MONITORING SYSTEM" SPECIAL PROVISION.
 4. MESSAGE BOARDS SHOULD NOT BE PLACED IN THE MEDIAN.

LEGEND

- SMART MONITORING DEVICE LOCATION
- I CHANGEABLE MESSAGE SIGN

FILE NAME	USER NAME: *RUSRN	DESIGNED	REVISED	STATE OF ILLINOIS DEPARTMENT OF TRANSPORTATION	SMART TRAFFIC MONITORING SYSTEM CONTRACT 76099	SECTION	COUNTY	TOTAL SHEETS
#FILES		DRAWN	6-6-13			60-11-783-3	MONROE	212
	PLT SCALE: *SCALE*	CHECKED			SCALE: _____			CONTRACT NO. 76099
	PLT DATE: *DATE*	DATE			SHEET NO. OF SHEETS	STA. TO STA.		