

NOTE: THE CONTRACTOR HAS THE OPTION OF WORKING ON BOTH THE S.B. AND N.B. PAVEMENTS SIMULTANEOUSLY, LEAVING ONLY ONE LANE OPEN TO TRAFFIC IN EACH DIRECTION. IF THAT OPTION IS EXERCISED, STAGING WORK SHALL BE COMPLETED ON STAGES I AND III BEFORE WORK WILL BE ALLOWED TO COMMENCE ON STAGES II AND IV.

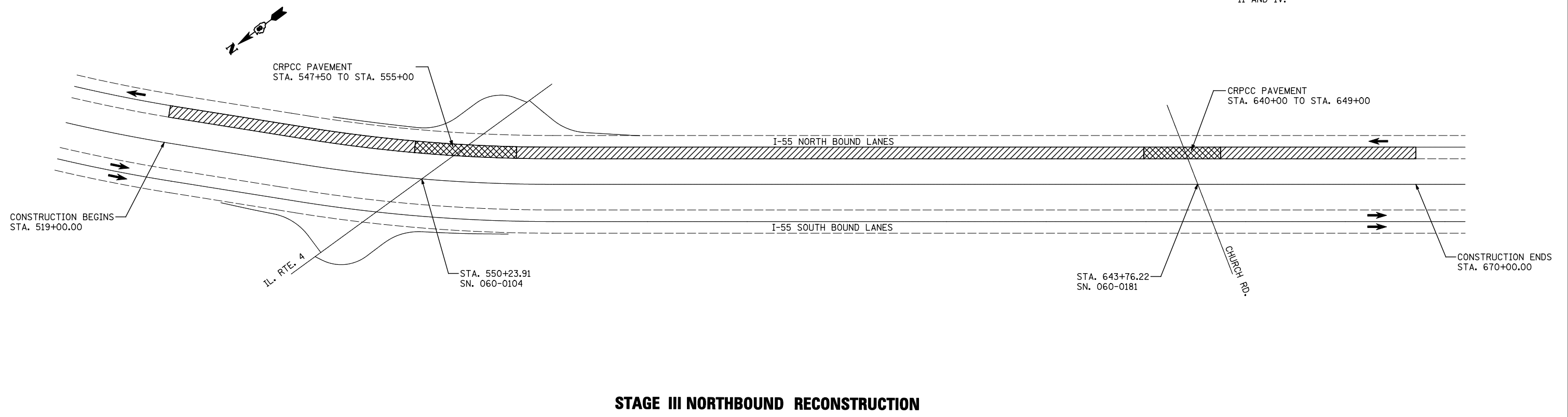

**STAGE III NORTHBOUND RECONSTRUCTION**

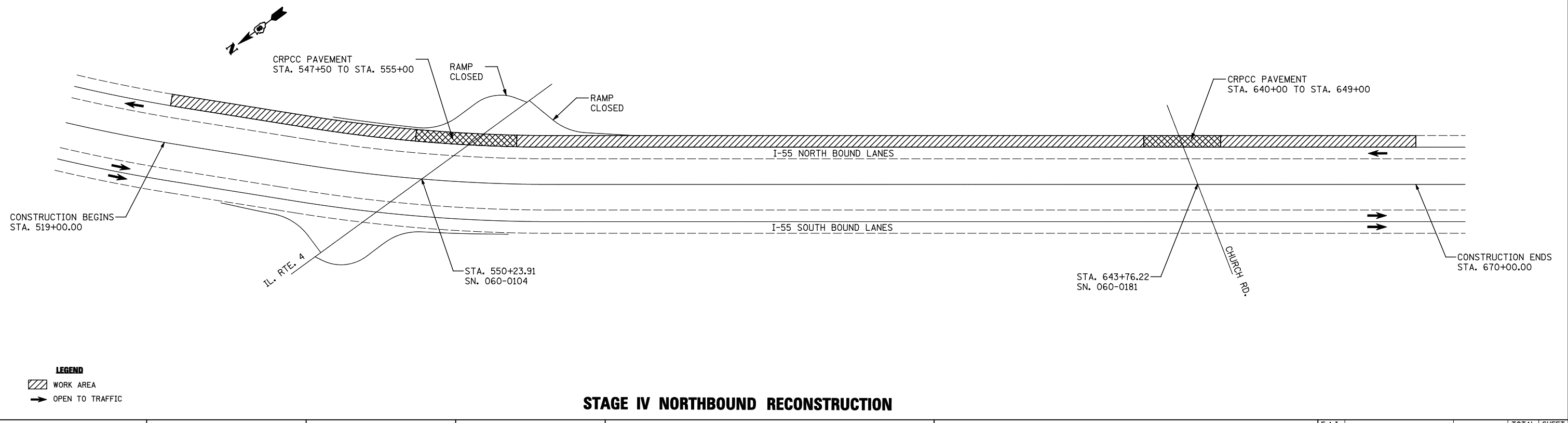

**STAGE IV NORTHBOUND RECONSTRUCTION**

**LEGEND**  
 WORK AREA  
 OPEN TO TRAFFIC

FILE NAME = ...\\oad\0876D99-Shit-Staging.dgn	USER NAME = \$(USER)	DESIGNED -	REVISED -	<b>STATE OF ILLINOIS DEPARTMENT OF TRANSPORTATION</b>	<b>I-55 TRAFFIC CONTROL AND STAGING</b>			F.A.I. RTE.	SECTION	COUNTY	TOTAL SHEETS	SHEET NO.
Johnson, Depp & Quisenberry CONSULTING ENGINEERS Springfield, Illinois	PLOT SCALE = 1200.0000 "/ IN.	DRAWN -	REVISED -					55	60-(1,2)RS-3	MADISON	212	55
PLOT DATE = 02/02/2012 17:45:02	DATE -	CHECKED -	REVISED -		SCALE: SHEET NO. OF SHEETS STA. TO STA.			CONTRACT NO. 76D99				
					ILLINOIS FED. AID PROJECT							