

ISLAND DETAILS

PAVEMENT ELEVATIONS (INTERMEDIATE ISLAND)

ISLAND	ELEV.
15 STA. 214+02.35	570.30
16 STA. 214+19.65	570.49
17 STA. 214+15.67, 15.5' RT.	569.87

PAVEMENT ELEVATIONS

RAMP 2-RT. EOP	ELEV.
22 0.17' RT., STA. 212+99.98	569.14
23 2.99' RT., STA. 213+24.81	569.37
24 9.22' RT., STA. 213+49.00	569.42
25 18.67' RT., STA. 213+71.97	569.25
26 35.26' RT., STA. 213+90.24	568.90
27 37.69' LT., STA. 42+39.38	568.62
28 29.42' LT., STA. 42+15.81	568.30
29 24.50' LT., STA. 41+91.32	568.98

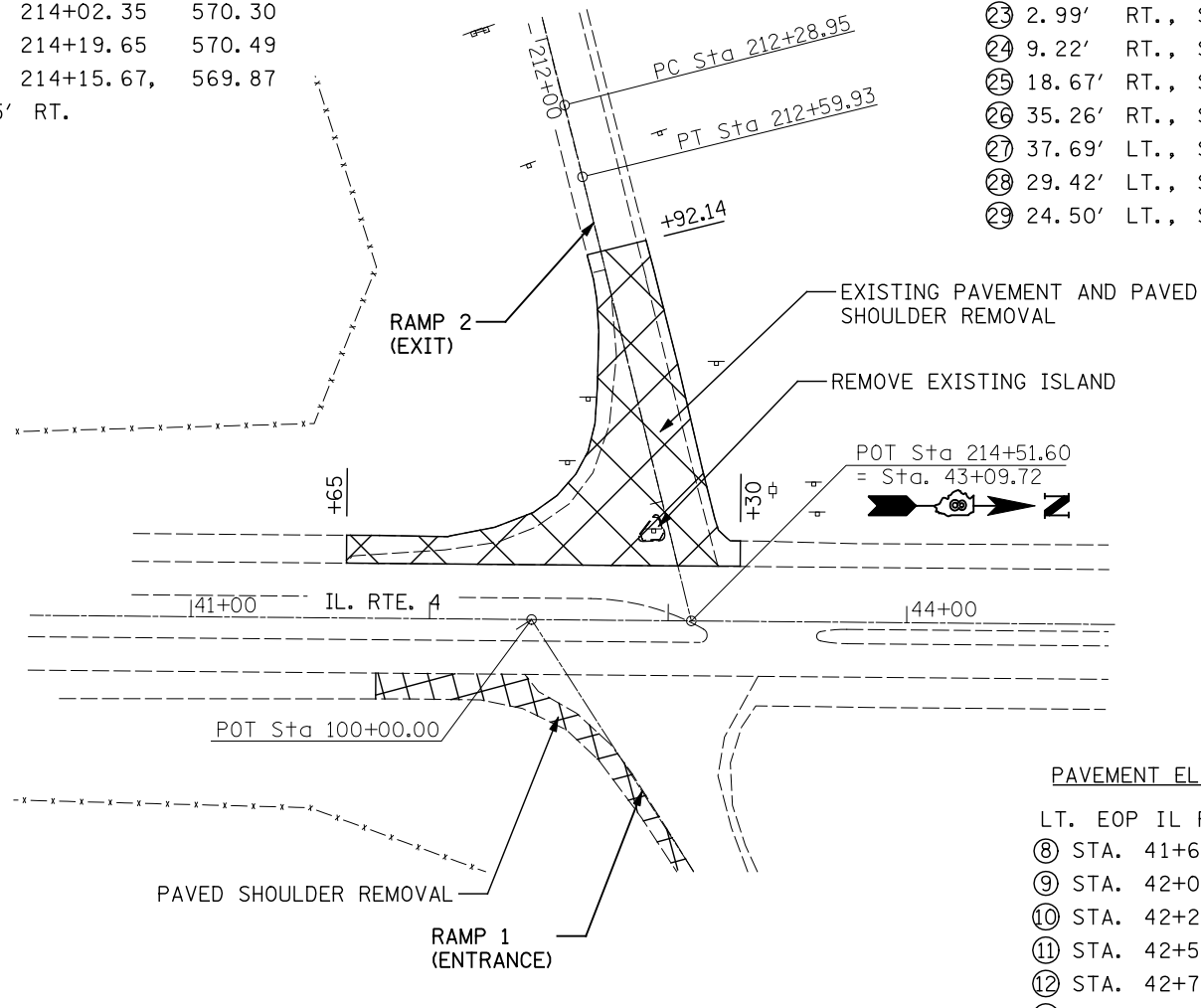

PAVEMENT ELEVATIONS

LT. EOP IL RTE 4	ELEV.
8 STA. 41+65	567.69
9 STA. 42+00	568.17
10 STA. 42+25	568.61
11 STA. 42+50	569.14
12 STA. 42+75	569.75
13 STA. 43+22.11	571.01
14 STA. 43+30	571.19

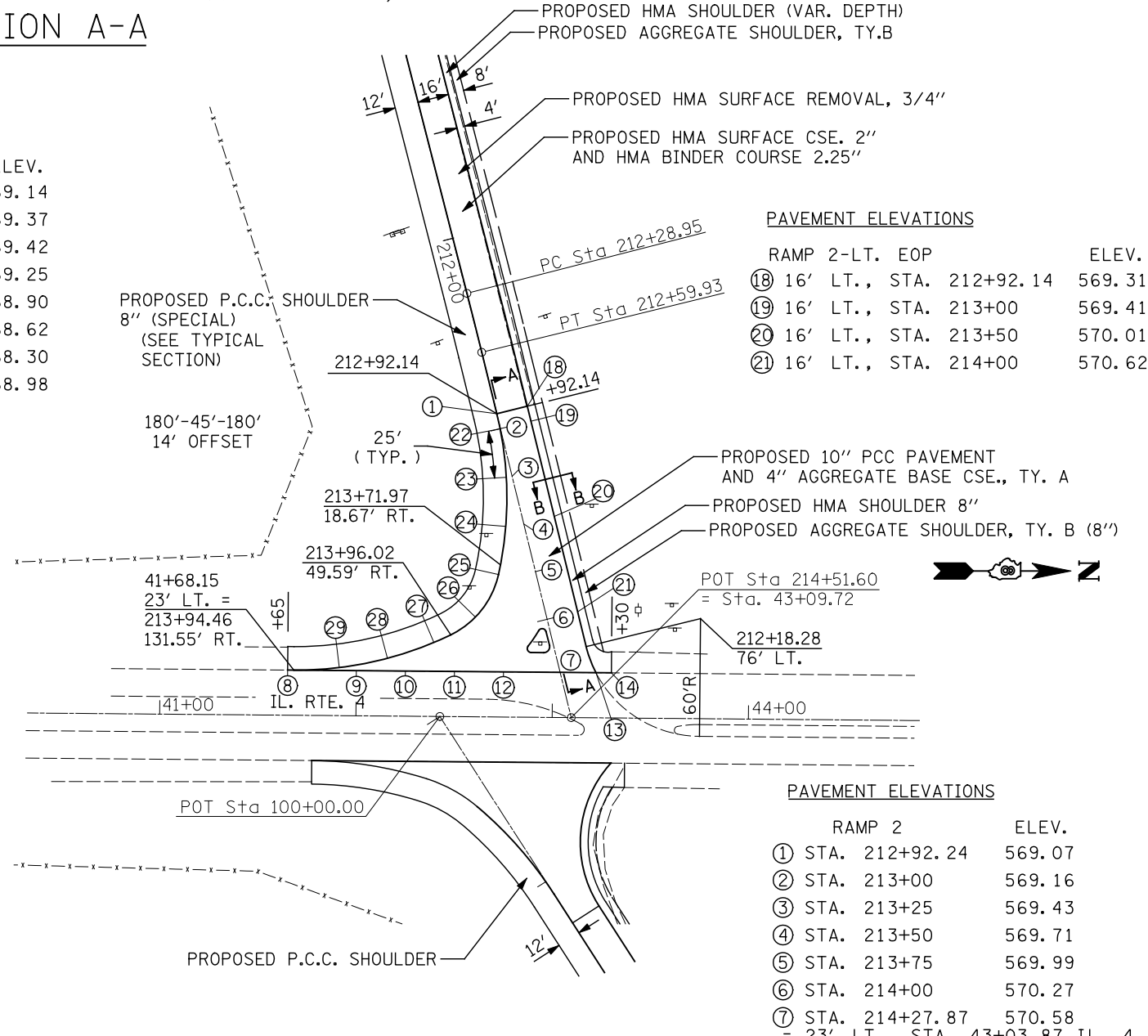

PAVEMENT ELEVATIONS

RAMP 2-LT. EOP	ELEV.
18 16' LT., STA. 212+92.14	569.31
19 16' LT., STA. 213+00	569.41
20 16' LT., STA. 213+50	570.01
21 16' LT., STA. 214+00	570.62

PAVEMENT ELEVATIONS

RAMP 2	ELEV.
1 STA. 212+92.24	569.07
2 STA. 213+00	569.16
3 STA. 213+25	569.43
4 STA. 213+50	569.71
5 STA. 213+75	569.99
6 STA. 214+00	570.27
7 STA. 214+27.87 = 23' LT., STA. 43+03.87 IL. 4	570.58

