

DATE	
BY	
REVISION	
NO.	
DESCRIPTION	
DATE	
BY	
REVISION	
NO.	
DESCRIPTION	
DATE	
BY	
REVISION	
NO.	
DESCRIPTION	

DATE	
BY	
REVISION	
NO.	
DESCRIPTION	
DATE	
BY	
REVISION	
NO.	
DESCRIPTION	
DATE	
BY	
REVISION	
NO.	
DESCRIPTION	

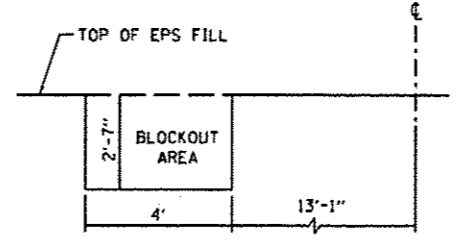
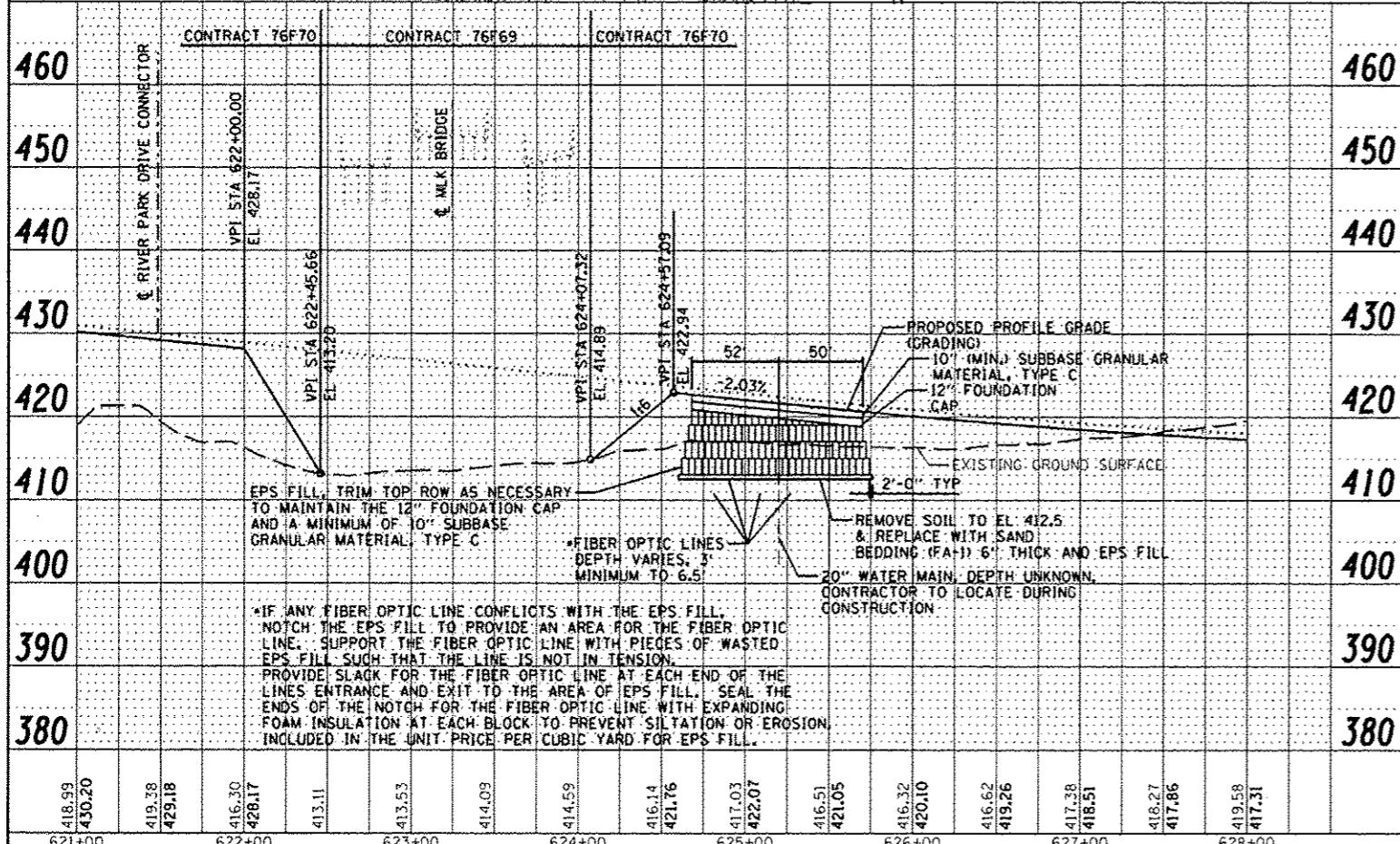
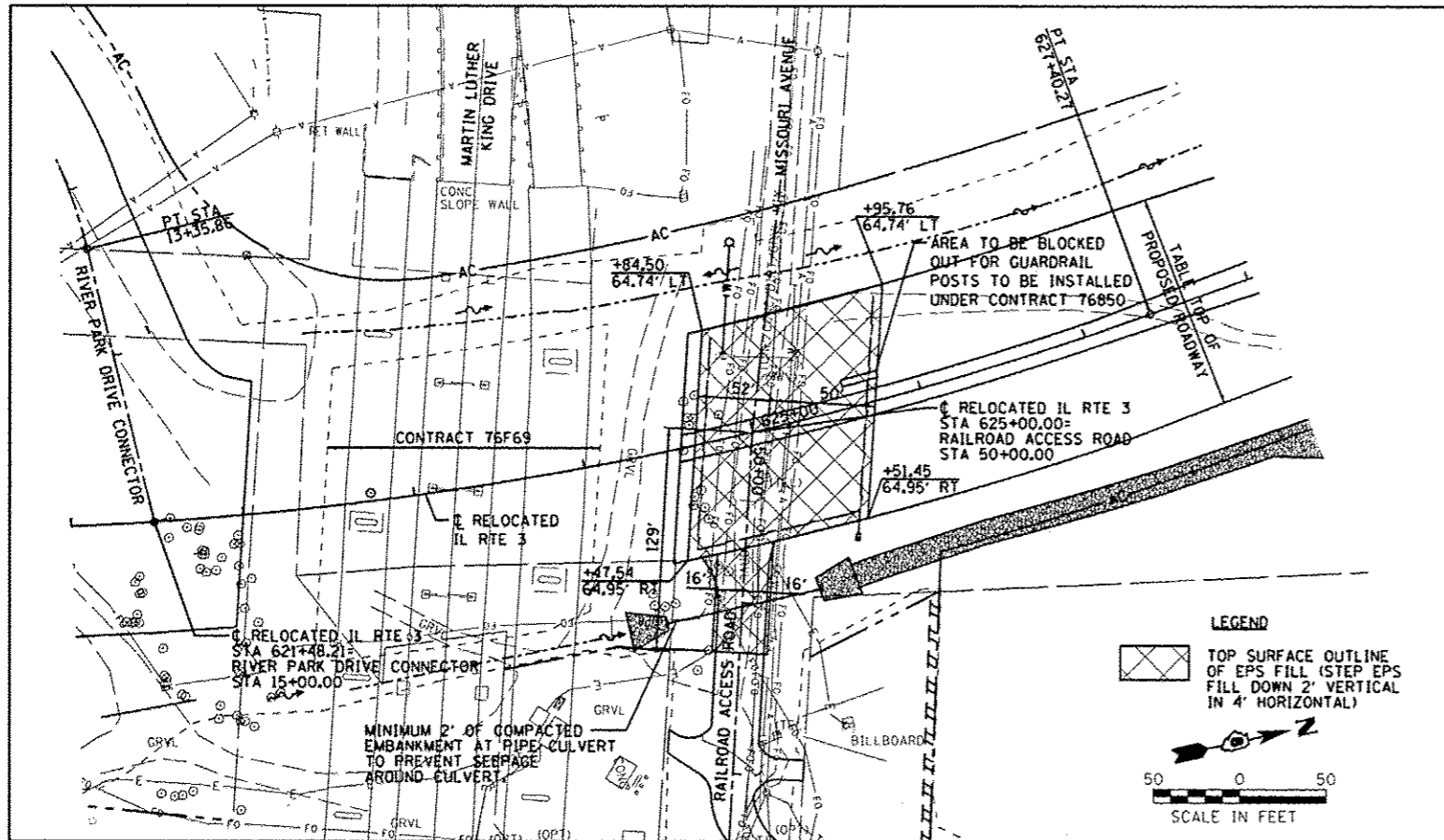

GUARDRAIL POST BLOCKOUT DETAIL
STA 625+56.59 TO STA 625+77.91

- NOTES:
1. THERE ARE SEVERAL FIBER OPTICS LINES AND OTHER UTILITIES, INCLUDING ELECTRICAL, TELEPHONE, WATER, AND AERIAL LINES LOCATED IN THE LIMITS OF CONSTRUCTION. THE CONTRACTOR SHALL HAND LOCATE AND VERIFY FIBER OPTIC LINES & SENSITIVE UTILITIES AND EXPOSE THESE PRIOR TO EXCAVATING FOR THE PROJECT PARTICULARLY ALONG MISSOURI AVE. AND THE MLK BRIDGE AREA. THIS WORK SHALL BE PAID FOR UNDER ARTICLE 109.04. SEE SUBSURFACE UNDERGROUND ENGINEERING PLANS FOR ADDITIONAL INFORMATION.
 2. EPS FILL SHALL BE A MINIMUM DENSITY OF 2.0 LBS PER CUBIC FOOT AND HAVE A MINIMUM COMPRESSIVE RESISTANCE AT 1/2 DEFORMATION OF 14.5 POUNDS PER SQUARE INCH. WRAP THE BOTTOM, SIDES AND TOP OF THE EPS FILL WITH A 10 MIL POLYETHYLENE WRAP. OVERLAP THE POLYWRAP AT THE ENDS BY 6" AND TAPE THE OVERLAP TOGETHER. THE POLYETHYLENE WRAP AND THE SAND (FA-1) BEDDING WILL NOT BE PAID FOR SEPARATELY, BUT SHALL BE INCLUDED IN THE CUBIC YARD PRICE FOR THE EXPANDED POLYSTYRENE FILL.
 3. A FOUNDATION CAP OF 12" OF AGGREGATE CA-6 OR CA-10 SHALL BE PLACED ON THE EPS FILL BEFORE ANY EQUIPMENT IS ALLOWED TO OPERATE ON TOP OF THE EPS FILL. THE FOUNDATION CAP SHALL BE PAID FOR AT THE UNIT PRICE PER CUBIC YARD OF SUBBASE GRANULAR MATERIAL, TYPE C.
 4. DUE TO BUOYANCY & FROST LEVEL CONCERNS, THE EPS FILL SHALL HAVE A MINIMUM OF 3 FEET OF MATERIAL PLACED ABOVE IT (INCLUDING PAVEMENT OR SUBBASE).

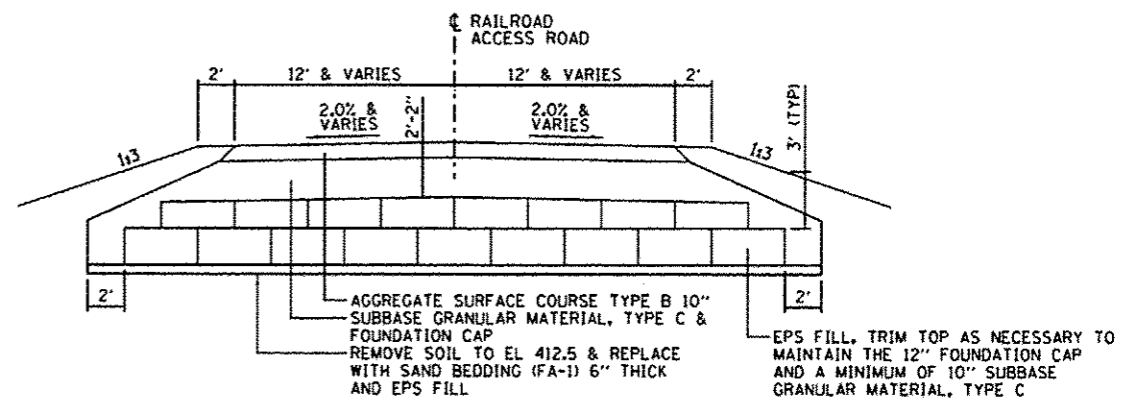

RAILROAD ACCESS ROAD
STA 50+67.70 TO STA 51+29.00

IF ANY FIBER OPTIC LINE CONFLICTS WITH THE EPS FILL, NOTCH THE EPS FILL TO PROVIDE AN AREA FOR THE FIBER OPTIC LINE. SUPPORT THE FIBER OPTIC LINE WITH PIECES OF WASTED EPS FILL SUCH THAT THE LINE IS NOT IN TENSION. PROVIDE SLACK FOR THE FIBER OPTIC LINE AT EACH END OF THE LINES ENTRANCE AND EXIT TO THE AREA OF EPS FILL. SEAL THE ENDS OF THE NOTCH FOR THE FIBER OPTIC LINE WITH EXPANDING FOAM INSULATION AT EACH BLOCK TO PREVENT SILTATION OR EROSION. INCLUDED IN THE UNIT PRICE PER CUBIC YARD FOR EPS FILL.

NOTE: EXPANDED POLYSTYRENE FILL = EPS FILL

418.99	419.38	419.87	416.30	413.11	413.53	414.03	414.53	416.14	417.03	416.51	416.32	416.62	417.28	418.51	418.27	419.58
430.20	429.18	428.17	428.17	428.17	428.17	428.17	428.17	428.17	428.17	428.17	428.17	428.17	428.17	428.17	428.17	428.17
621+00	622+00	623+00	624+00	625+00	626+00	627+00	628+00									

Farnsworth GROUP, INC.
2100 McGraw Drive
Bloomington, Illinois 61704
309.623.8435, 309.663.1271 fax

USER NAME: #USERS*
DESIGNED: JJO
DRAWN: JJO
CHECKED: PJM
DATE: 10/18/12

REVISED: 02/06/13
REVISED: 03/18/13
REVISED: 05/13/13
REVISED: 6-5-13

STATE OF ILLINOIS
DEPARTMENT OF TRANSPORTATION

ENTIRE SHEET 6-5-13

RELOCATED IL RTE 3		F.A.P. RTE.	SECTION	COUNTY	TOTAL SHEETS	SHEET NO.
EXPANDED POLYSTYRENE FILL PLAN & DETAILS		788	620-1-2-1	ST. CLAIR	121	22A
SCALE: SHEET NO. OF SHEETS STA. TO STA.		ILLINOIS FED. AID PROJECT				CONTRACT NO. 76F70