

STATE OF ILLINOIS  
DEPARTMENT OF TRANSPORTATION  
PLANS FOR  
PROPOSED LOCAL AGENCY IMPROVEMENT  
URBAN PROJECT

FAU 5768 (12TH AVENUE, 19TH STREET TO 34TH STREET)  
SECTION 12-00254-00-RS  
ROCK ISLAND COUNTY  
PROJECT NO M-5074(092)

CITY OF MOLINE  
JOB NO. C-92-120-12  
CONTRACT 85588

PAGE NO.	INDEX OF SHEETS
1	TITLE SHEET
2	GENERAL NOTES & SUMMARY OF QUANTITIES
3-6	SCHEDULE OF QUANTITIES
7	TYPICAL SECTIONS
8	STORM SEWER AT 25TH STREET
9	STORM SEWER AT 27TH STREET
10-15	SIDEWALKS
16-23	PLAN & PROFILE
24-30	STRIPING PLAN
31-33	CROSS SECTIONS
34-40	DETAILS

ILLINOIS HIGHWAY STANDARDS	
000001-06	STANDARD SYMBOLS, ABBREVIATIONS, PATTERNS
001001-02	AREAS OF REINFORCEMENT BARS
001006	DECIMAL OF INCH & FOOT
280001-07	TEMPORARY EROSION CONTROL SYSTEMS
424001-07	PERPENDICULAR CURB RAMPS
424006-01	DIAGONAL CURB RAMPS
424011-01	CORNER PARALLEL CURB RAMPS
442101-07	CLASS B PATCHES
602401-03	MANHOLE TYPE A
604001-03	FRAME & LIDS TYPE 1
606001-05	CONCRETE CURB TYPE B & COMBINATION CONCRETE CURB & GUTTER
701006-04	OFF-ROAD OPERATIONS, 2L, 2W, 15' TO 24" FROM PV EDGE
701011-03	OFF-ROAD MOVING OPERATIONS, 2L, 2W, DAY ONLY
701427-01	LANE CLOSURE MULTILANE - INTERMEDIATE OR MOVING OPERATIONS FOR SPEEDS < 40 MPH
701501-06	URBAN LANE CLOSURE 2L2W - UNDIVIDED
701601-08	URBAN LANE CLOSURE MULTILANE 1W2W & NONTRANSVERSABLE MEDIAN
701606-08	URBAN LANE CLOSURE MULTILANE 2W, MOUNTABLE MEDIAN
701701-08	URBAN LANE CLOSURE MULTILANE INTERSECTION
701801-05	SIDEWALK CORNER OR CROSSWALK CLOSURE
701901-02	TRAFFIC CONTROL DEVICES
720001-01	SIGN PANEL MOUNTING DETAILS
720006-03	SIGN PANEL ERECT DETAILS
720011-01	METAL POSTS FOR SIGNS, MARKERS, & DELINEATORS
728001-01	TELESCOPING STEEL SIGN SUPPORT
729001-01	APPLICATIONS OF TYPES A & B METAL POSTS
780001-03	TYPICAL PAVEMENT MARKINGS

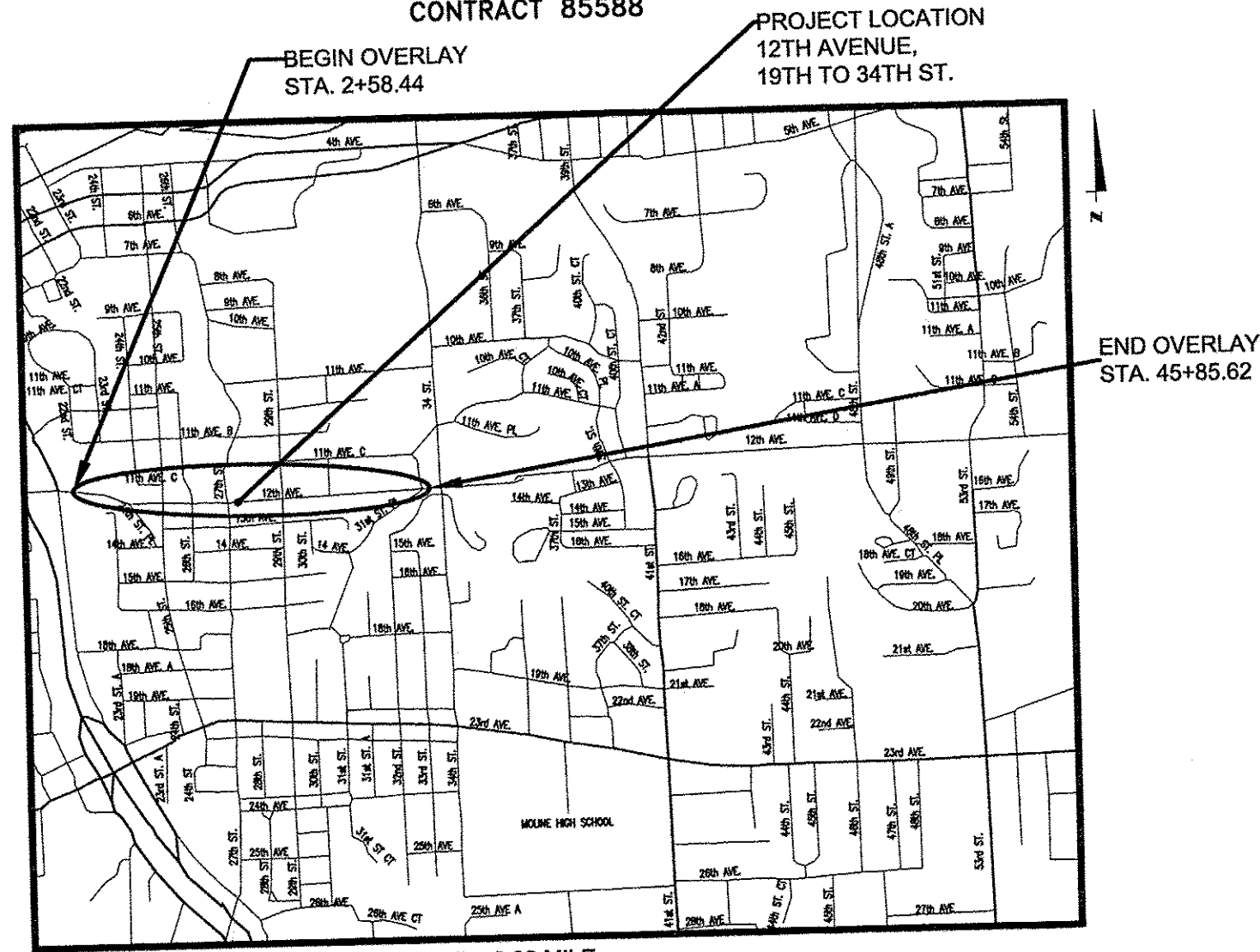

PROJECT LENGTH: 4327.18 LF = 0.82 MILE

CALL J.U.L.I.E.  
BEFORE YOU DIG  
1-800-892-0123

UTILITIES

THE FOLLOWING UTILITY COMPANIES MAY HAVE UTILITIES LOCATED ON THIS PROJECT:

- MID AMERICA GAS AND ELECTRIC COMPANY
- SBC - AMERITECH - TELEPHONE
- MEDIACOM CABLE T.V.
- CITY OF MOLINE WATER DEPT.
- CITY OF MOLINE STREET DEPT.
- CITY OF MOLINE WATER POLLUTION CONTROL DEPT.
- CITY OF MOLINE ELECTRICAL MAINTENANCE DEPT.

CONTRACTOR SHALL CALL J.U.L.I.E. TO CONTACT ALL UTILITY COMPANIES WHICH MAY HAVE FACILITIES IN THE AREA OF CONSTRUCTION AND OBTAIN THE EXACT LOCATION OF THESE FACILITIES.

FOR FIELD LOCATIONS CALL J.U.L.I.E. AT 1-800-892-0123.

URBAN COLLECTOR  
ADT (2013) = 13,900  
TRUCKS = 3%

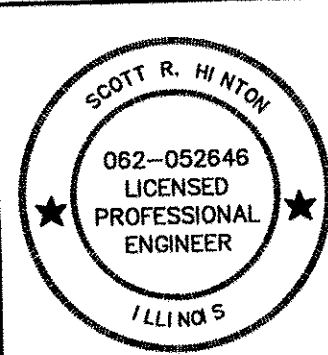

I HEREBY CERTIFY THAT THESE PLANS WERE PREPARED BY ME OR UNDER MY DIRECT PERSONAL SUPERVISION AND THAT I AM A DULY REGISTERED PROFESSIONAL ENGINEER UNDER THE LAWS OF THE STATE OF ILLINOIS.

*Scott R. Hinton*  
SCOTT R. HINTON P.E.  
LICENSE NO. 062-052646  
DATE EXPIRES 11-30-13

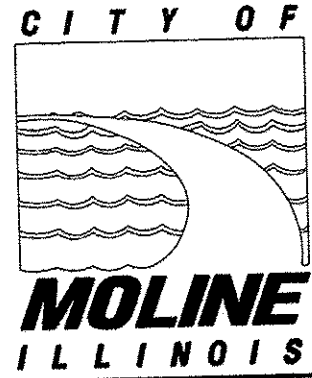

APPROVED	<i>4/15/13</i>
DATE	
<i>Scott Hinton</i>	
SCOTT HINTON, P.E. CITY ENGINEER	
PASSED	<i>April 18, 2013</i>
DATE	
<i>Paul A. Toole</i>	
DISTRICT 2 ENGINEER OF LOCAL ROADS & STREETS	
RELEASED FOR BID BASED ON LIMITED REVIEW	<i>April 18, 2013</i>
DATE	
<i>Paul A. Toole</i>	
DEPUTY DIRECTOR OF HIGHWAYS, REGION 2 ENGINEER	