

**WEST EDGE OF PARAPET**

Location	Station	Offset	Theoretical Grade Elevations
S. End S. App. Slab	18+61.47	-20.000	790.86
A	18+71.47	-20.000	790.94
B	18+81.47	-20.000	791.00
N. End S. App. Slab	18+91.47	-20.000	791.05

**WEST CURB LINE**

Location	Station	Offset	Theoretical Grade Elevations
S. End S. App. Slab	18+64.97	-15.000	790.99
A	18+74.97	-15.000	791.07
B	18+84.97	-15.000	791.13
N. End S. App. Slab	18+94.97	-15.000	791.17

**WEST EDGE OF ROADWAY PAVEMENT**

Location	Station	Offset	Theoretical Grade Elevations
S. End S. App. Slab	18+67.07	-12.000	791.07
A	18+77.07	-12.000	791.14
B	18+87.07	-12.000	791.20
N. End S. App. Slab	18+97.07	-12.000	791.24

**PROFILE GRADE LINE**

Location	Station	Offset	Theoretical Grade Elevations
S. End S. App. Slab	18+75.47	0.000	791.32
A	18+85.47	0.000	791.38
B	18+95.47	0.000	791.42
N. End S. App. Slab	19+05.47	0.000	791.46

**EAST EDGE OF ROADWAY PAVEMENT**

Location	Station	Offset	Theoretical Grade Elevations
S. End S. App. Slab	18+85.87	12.000	791.18
A	18+93.87	12.000	791.23
B	19+03.87	12.000	791.26
N. End S. App. Slab	19+13.87	12.000	791.29

**EAST CURB LINE**

Location	Station	Offset	Theoretical Grade Elevations
S. End S. App. Slab	18+85.97	15.000	791.13
A	18+95.97	15.000	791.18
B	19+05.97	15.000	791.21
N. End S. App. Slab	19+15.97	15.000	791.24

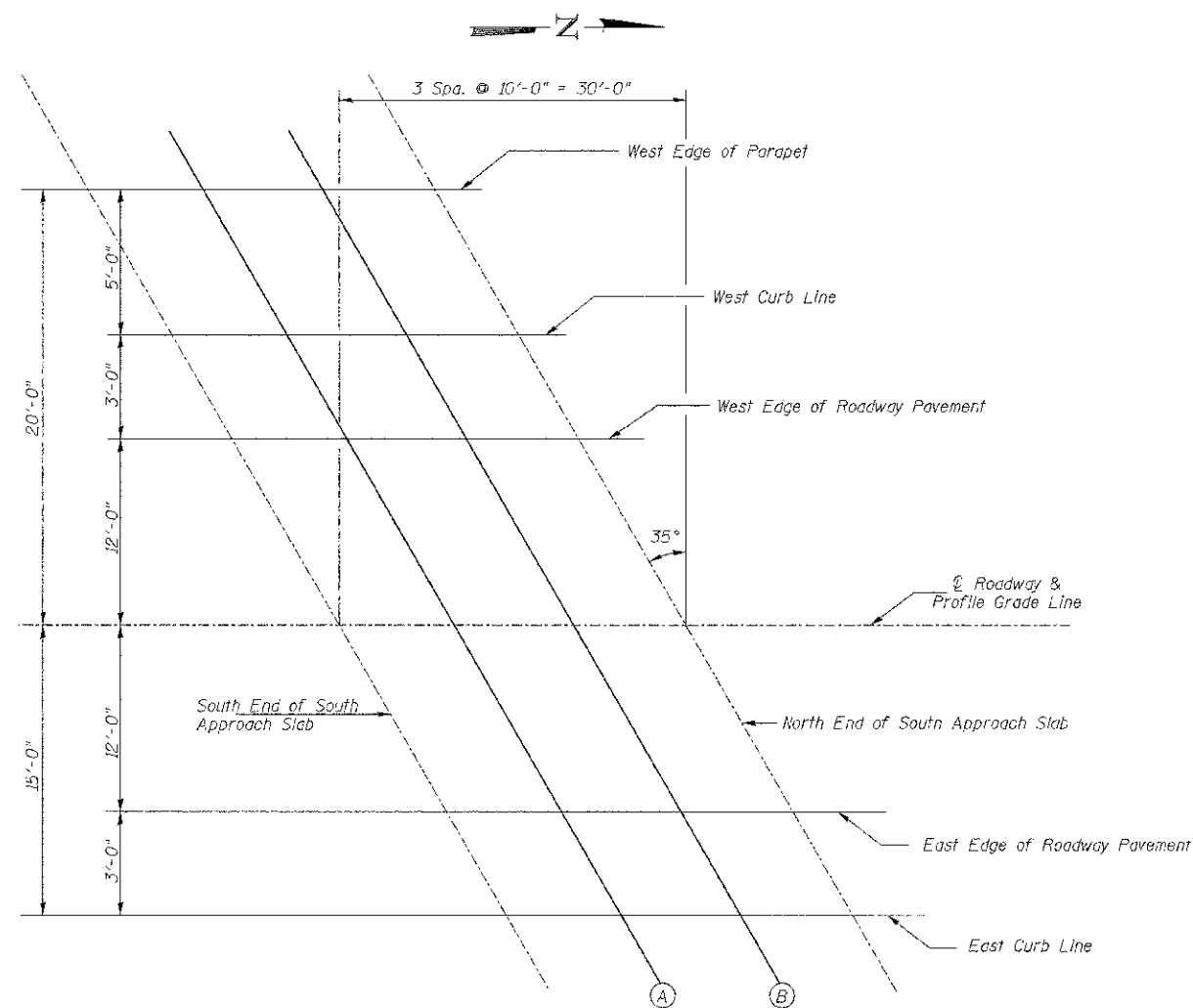

**PLAN SOUTH APPROACH PAVEMENT**

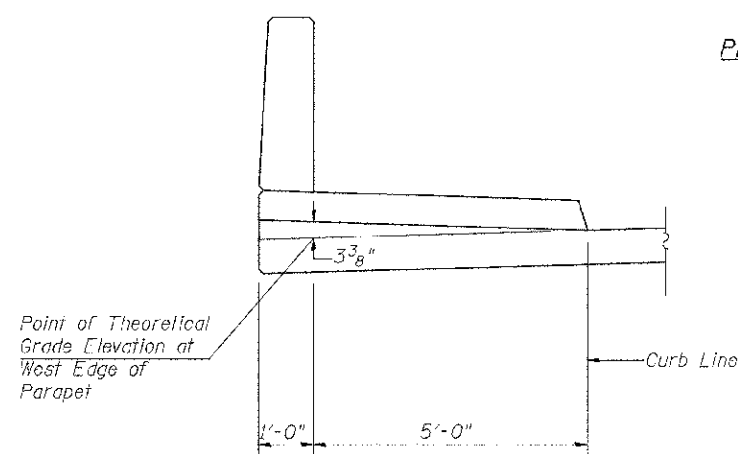

**SECTION THRU SIDEWALK**

FILE NAME =	USER NAME = smc/ntsl	DESIGNED BAN	REVISED -
W:\2555\ROAD STRUCTURES Rec'd	02 27 23:32:2555b306.dwg	DRAWN TAC	REVISED -
	PLOT SCALE - NONE	CHECKED CTM	REVISED -
	PLOT DATE = 3/26/2013	DATE -	REVISED -

**DEKALB COUNTY**  
**C.H. 26 (FIVE POINTS RD.)**  
**OVER SOUTH BRANCH OF KISHWAUKEE RIVER**

**TOP OF APPROACH SLAB ELEVATIONS - SOUTH APPROACH SLAB**

SCALE: N/A SHEET NO. 6 OF 28 SHEETS STA. N/A TO STA. N/A

RTE. NO.	SECTION	COUNTY	TOTAL SHEETS	SHEET NO.
CH 26	05-00044-01-BR	DEKALB	49	21
CONTRACT NO. 87477				
ILLINOIS FED. AID PROJECT BRS-1122008				