

PLAN	DATE
BY	
REVISIONS	
NO. 1	DATE
NO. 2	DATE
NO. 3	DATE
NO. 4	DATE
NO. 5	DATE
NO. 6	DATE
NO. 7	DATE
NO. 8	DATE
NO. 9	DATE
NO. 10	DATE
NO. 11	DATE
NO. 12	DATE
NO. 13	DATE
NO. 14	DATE
NO. 15	DATE
NO. 16	DATE
NO. 17	DATE
NO. 18	DATE
NO. 19	DATE
NO. 20	DATE
NO. 21	DATE
NO. 22	DATE
NO. 23	DATE
NO. 24	DATE
NO. 25	DATE
NO. 26	DATE
NO. 27	DATE
NO. 28	DATE
NO. 29	DATE
NO. 30	DATE
NO. 31	DATE
NO. 32	DATE
NO. 33	DATE
NO. 34	DATE
NO. 35	DATE
NO. 36	DATE
NO. 37	DATE
NO. 38	DATE
NO. 39	DATE
NO. 40	DATE
NO. 41	DATE
NO. 42	DATE
NO. 43	DATE
NO. 44	DATE
NO. 45	DATE
NO. 46	DATE
NO. 47	DATE
NO. 48	DATE
NO. 49	DATE
NO. 50	DATE

PROFILE	DATE
BY	
REVISIONS	
NO. 1	DATE
NO. 2	DATE
NO. 3	DATE
NO. 4	DATE
NO. 5	DATE
NO. 6	DATE
NO. 7	DATE
NO. 8	DATE
NO. 9	DATE
NO. 10	DATE
NO. 11	DATE
NO. 12	DATE
NO. 13	DATE
NO. 14	DATE
NO. 15	DATE
NO. 16	DATE
NO. 17	DATE
NO. 18	DATE
NO. 19	DATE
NO. 20	DATE
NO. 21	DATE
NO. 22	DATE
NO. 23	DATE
NO. 24	DATE
NO. 25	DATE
NO. 26	DATE
NO. 27	DATE
NO. 28	DATE
NO. 29	DATE
NO. 30	DATE
NO. 31	DATE
NO. 32	DATE
NO. 33	DATE
NO. 34	DATE
NO. 35	DATE
NO. 36	DATE
NO. 37	DATE
NO. 38	DATE
NO. 39	DATE
NO. 40	DATE
NO. 41	DATE
NO. 42	DATE
NO. 43	DATE
NO. 44	DATE
NO. 45	DATE
NO. 46	DATE
NO. 47	DATE
NO. 48	DATE
NO. 49	DATE
NO. 50	DATE

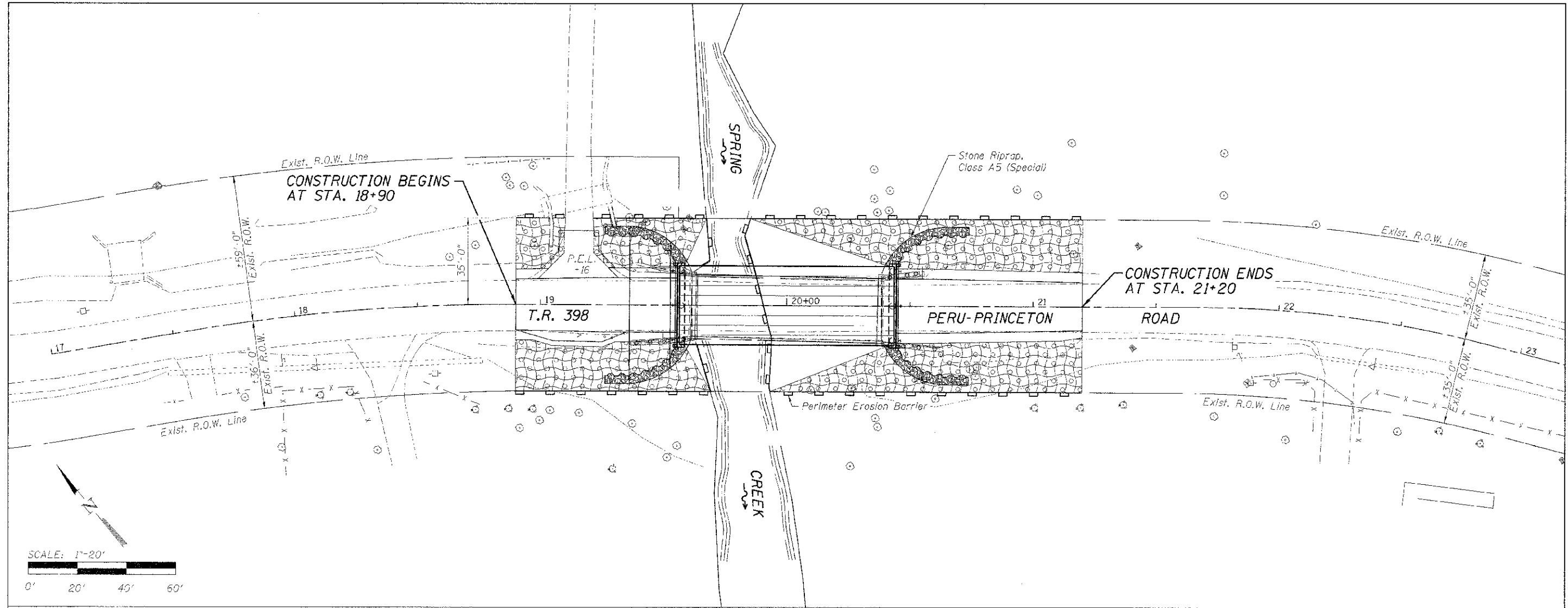

**EROSION CONTROL NOTES**

The soil erosion and sediment control practices will be inspected weekly and after 1/2" of rain or more by the individual on site in charge of soil erosion and sediment control during the construction of the project.

Perimeter erosion barrier shall comply with Section 280 of the Standard Specifications and shall be placed as shown on the Erosion Control Plan and in accordance with stations shown on the Schedule of Quantities sheet or as directed by the Engineer.

Silt fence shall be installed following the completion and stabilization of all areas adjacent to the on-site drainages. The silt fence will remain in place until the contributing area is stabilized.

For Seeding, Class 3 (Special) see Special Provisions.



Erosion control blanket shall be placed on all disturbed areas as shown on this Erosion Control Plan sheet and in accordance with Section 251 of the Standard Specifications for Road and Bridge Construction.

The use of green dye in the erosion control blanket is not acceptable.

Stockpiles of soil and other building materials to remain in place more than 3 days shall be furnished with erosion and sediment control measures (i.e. perimeter silt fence). Stockpiles to remain in place for 14 days or more shall receive temporary seeding.

All adjacent streets must be kept clear of debris, inspected daily and cleaned when necessary.

**LEGEND**

-  Perimeter Erosion Barrier
-  Seeding, Class 3 (Special)
-  Erosion Control Blanket

**BILL OF MATERIAL**

Item	Unit	Quantity
Erosion Control Blanket	Sq. Yd.	732
Temporary Erosion Control Seeding	Pound	16
Perimeter Erosion Barrier	Foot	513
Seeding, Class 3 (Special)	Acre	0.16



DESIGNED - IAN NILAUSEN	REVISED -
CHECKED - BRAD KLEINMAIER	REVISED -
DRAWN - RON ALLEN	REVISED -
CHECKED - BRAD KLEINMAIER	REVISED -

**BUREAU COUNTY**  
**T.R. 398 OVER SPRING CREEK**  
**STATION 20+00**

**EROSION CONTROL PLAN**  
**STRUCTURE NO. 006-4143**

SCALE: 1" = 20'-0" SHEET NO. 1 OF 1 SHEETS STA. 17+00.00 TO STA. 23+00.00

TWP. RTE.	SECTION	COUNTY	TOTAL SHEETS	SHEET NO.
15N	09-10115-00-BR	BUREAU	74	6
WHA* 1004D:2		CONTRACT NO. 87551		
ILLINOIS FED. AID PROJECT BR05-001(094)				

FILE = S:\PROJECTS\2017\1004D:2 Bureau TR398\03\01\01\TRANS-DE-SURGE\180412-EROSION.dgn