

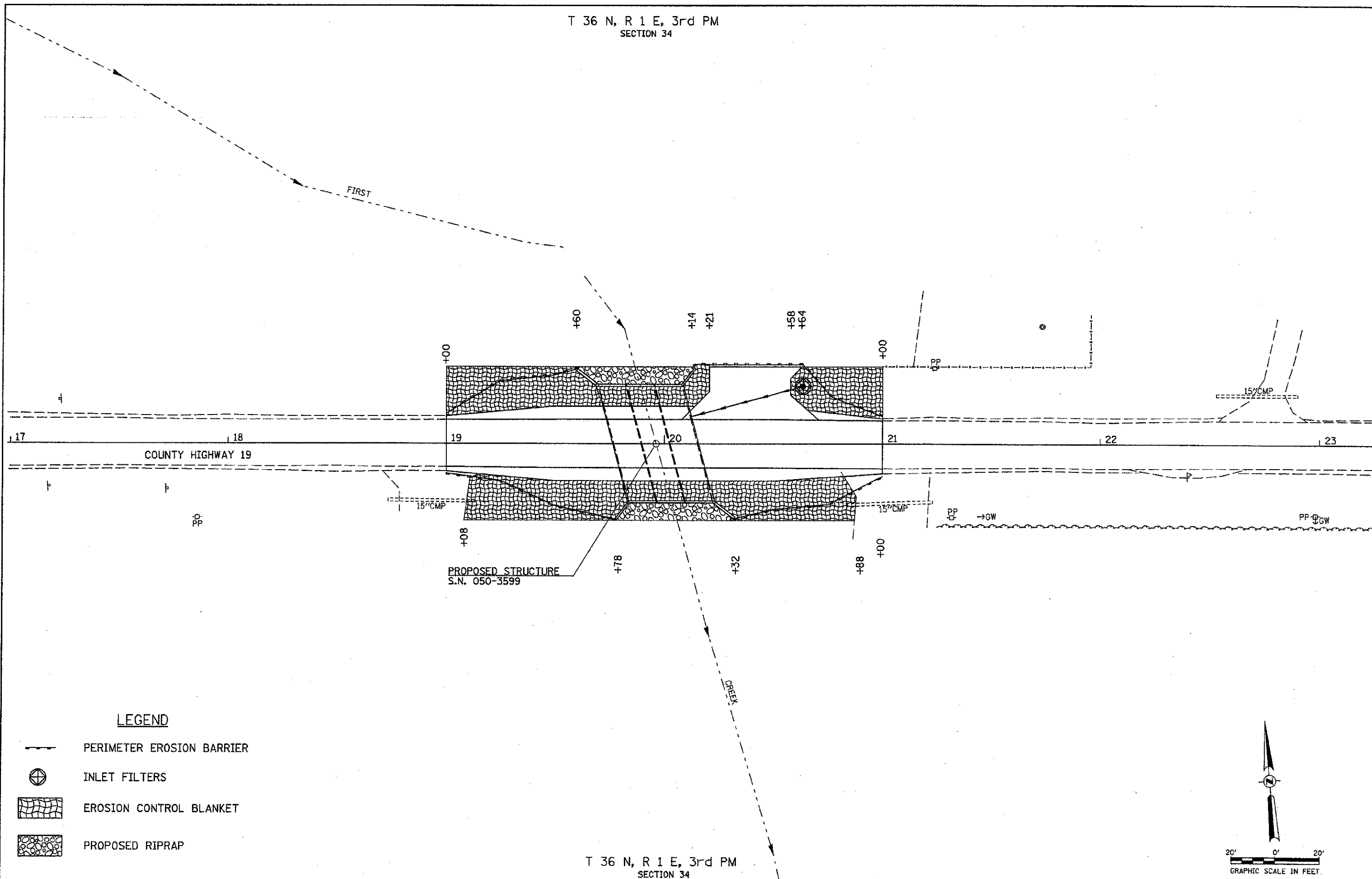

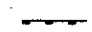

T 36 N, R 1 E, 3rd PM  
SECTION 34



**LEGEND**

-  PERIMETER EROSION BARRIER
-  INLET FILTERS
-  EROSION CONTROL BLANKET
-  PROPOSED RIPRAP

T 36 N, R 1 E, 3rd PM  
SECTION 34

**LASALLE COUNTY  
COUNTY HIGHWAY 19  
OVER FIRST CREEK**

**EROSION CONTROL PLAN**

SCALE: 1" = 20' SHEET NO. 1 OF 1 SHEETS STA. 19+00.00 TO STA. 21+00.00

F.A.S. / R.T.E.	SECTION	COUNTY	TOTAL SHEETS	SHEET NO.
270	13-00727-00-BR	LASALLE	13	5
FED. ROAD DIST. NO. 7 (ILLINOIS)			FED. AID PROJECT BR5-0270002	

FILE NAME =	USER NAME = jhutchison	DESIGNED -	REVISED -
\\bridge\3283-Lasalle\32838201\final.dgn		DRAWN -	REVISED -
	PLOT SCALE = 1/8" = 20' / IN.	CHECKED -	REVISED -
	PLOT DATE = 5/1/2013	DATE -	REVISED -