

SEC. 8, T.19N., R.9E., 3rd P.M.  
CHAMPAIGN COUNTY, ILLINOIS

PROPOSED  $\phi$   
MAIN STREET  
CURVE DATA  
P.I. STA. 13+39.16  
 $\Delta = 6^{\circ}14'29''$   
 $D = 4^{\circ}46'29''$   
 $T = 65.43'$   
 $R = 1200.00'$   
 $L = 130.72'$   
 $E = 1.78'$   
P.C. STA. 12+73.74  
P.T. STA. 14+04.46

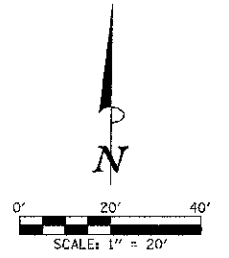

BEGIN IMPROVEMENTS  
MAIN STREET  
STA. 9+75.00  
(MATCH EXISTING)

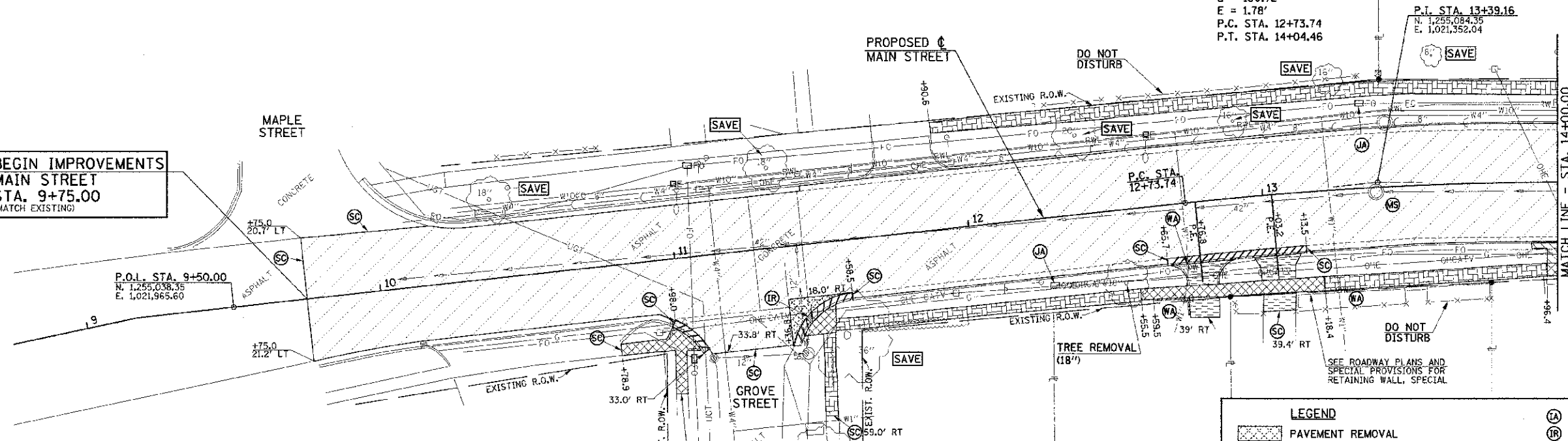

ALL TREES SHALL BE SAVED UNLESS OTHERWISE SHOWN ON THE PLANS OR DIRECTED BY THE ENGINEER.

ITEMS NOT SHOWN TO BE ADJUSTED OR REMOVED SHALL NOT BE DISTURBED UNLESS OTHERWISE DIRECTED BY THE ENGINEER.

UTILITY INFORMATION IS ONLY SHOWN IN AREAS OF PROPOSED UNDERGROUND WORK.

SEC. 17, T.19N., R.9E., 3rd P.M.  
CHAMPAIGN COUNTY, ILLINOIS

SEC. 9, T.19N., R.9E., 3rd P.M.  
CHAMPAIGN COUNTY, ILLINOIS

LEGEND	
	PAVEMENT REMOVAL
	HMA SURFACE REMOVAL
	P.C.C. SIDEWALK REMOVAL
	DRIVEWAY PAVEMENT REMOVAL
	CONCRETE STEP REMOVAL
	BRICK SIDEWALK REMOVAL
	CONCRETE MEDIAN SURFACE REMOVAL
	RETAINING WALL REMOVAL
	COMBINATION CURB AND GUTTER REMOVAL
	DOMESTIC METER VAULTS TO BE ADJUSTED
	DOMESTIC WATER SERVICE BOXES TO BE ADJUSTED
	INLET TO BE ADJUSTED
	INLET TO BE REMOVED
	VALVE BOXES TO BE ADJUSTED
	MANHOLES TO BE ADJUSTED
	VALVE BOXES TO BE ADJUSTED (SPECIAL)
	MANHOLES TO BE ADJUSTED (SPECIAL)
	HANDHOLE TO BE ADJUSTED
	JUNCTION BOX TO BE ADJUSTED
	INLETS TO BE ADJUSTED (SPECIAL)
	INLETS TO BE ADJUSTED WITH NEW FRAME AND GRATE (SPECIAL)
	SAW CUT

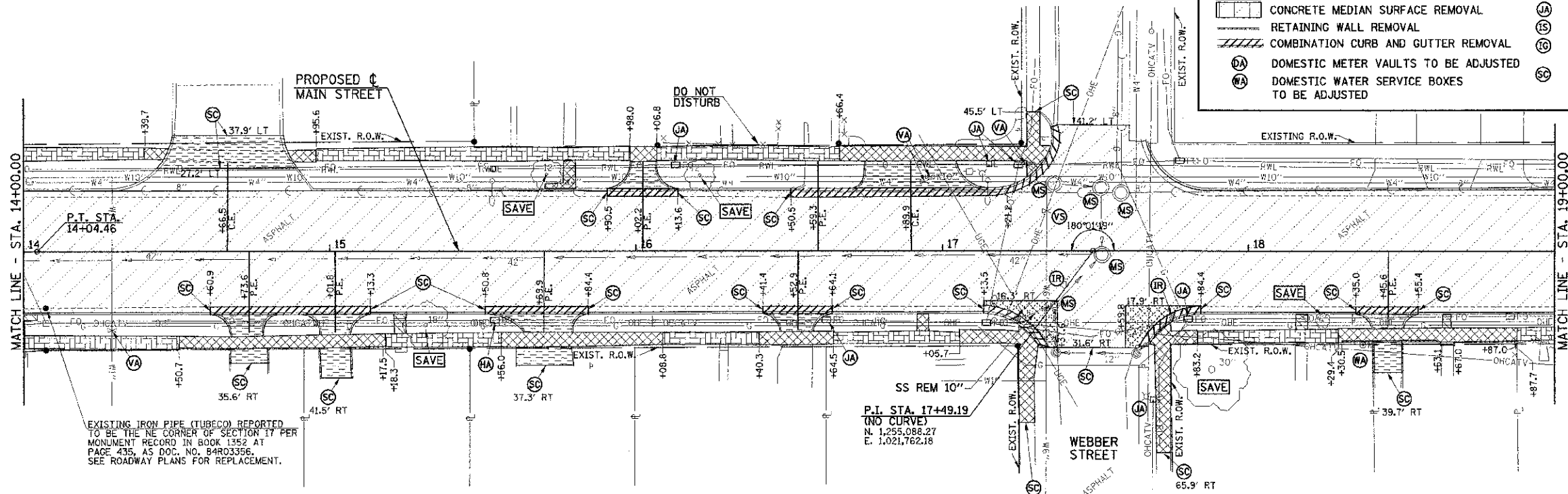

SEE SHEET 25 FOR REMOVAL NOTES.

EXISTING IRON PIPE (TUBECO) REPORTED TO BE THE NE CORNER OF SECTION 17 PER MONUMENT RECORD IN BOOK 1352 AT PAGE 435, AS DOC. NO. 84R03356. SEE ROADWAY PLANS FOR REPLACEMENT.

SEC. 16, T.19N., R.9E., 3rd P.M.  
CHAMPAIGN COUNTY, ILLINOIS

FILE NAME = p:\0070062\_Urbana - Main Street ITEMP\Plans\Sheets\08-removal.dgn  
PLOT DATE = 3/6/2013 11:44:11 PM

DESIGNED - J.A.J.	REVISED -
DRAWN - D.L.M.	REVISED -
CHECKED - S.W.W.	REVISED -
DATE - 03/2013	REVISED -

STATE OF ILLINOIS  
DEPARTMENT OF TRANSPORTATION

REMOVAL PLANS

SCALE: 1"=20' SHEET NO. 17 OF 75 SHEETS STA. 9+75.00 TO STA. 19+00.00

F.A.I. RTE.	SECTION	COUNTY	TOTAL SHEETS	SHEET NO.
7124	09-00483-01-RS	CHAMPAIGN	75	17
MAIN STREET			CONTRACT NO. 91480	
FED. ROAD DIST. NO.		ILLINOIS	FED. AID PROJECT	