

SEC. 9, T.19N., R.9E., 3rd P.M.
CHAMPAIGN COUNTY, ILLINOIS

TBM #6
TOP CENTER CAP BOLT OF FIRE
HYDRANT AT STA. 20+98.8 24.52' LT
ELEV.= 726.22

POLYMERIZED HOT-MIX ASPHALT SURFACE COURSE, MIX "D", N90 (2" THICK)
STA. 19+00.00 TO STA. 24+00.00

NOTE:
ALL SIDEWALK P.I. AND DRIVEWAY ELEVATION INFORMATION
IS GIVEN AT THE BACK OF WALK OR FACE OF CURB (S/W =
SIDEWALK, T/C = TOP OF CURB). SEE INTERSECTION DETAILS
FOR ADDITIONAL INFORMATION AT INTERSECTION QUADRANTS.

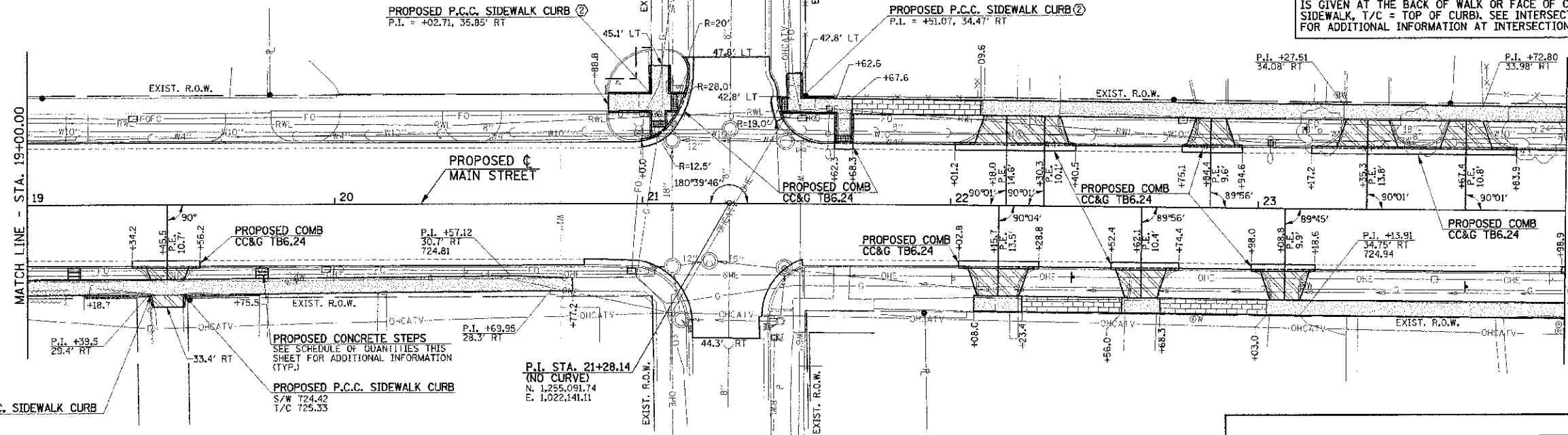
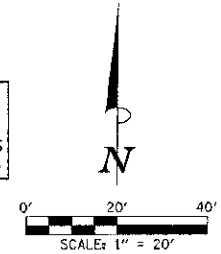

THE HEIGHT OF ALL PROPOSED MONOLITHIC
SIDEWALK CURB, P.C. SIDEWALK CURB, AND
CONCRETE CURB TYPE B (SPECIAL) SHALL
TRANSITION TO MATCH THE HEIGHT OF THE
EXISTING CURB OR STEPS THAT THE CURB
CONNECTS TO OR SHALL TRANSITION TO
ZERO HEIGHT AT EXISTING GROUND UNLESS
OTHERWISE DIRECTED BY THE ENGINEER.

ALL STREET RADII ARE DIMENSIONED TO
THE BACK OF CURB.

SEE HORIZONTAL ALIGNMENT LAYOUT AND
CONTROL SHEETS FOR TEMPORARY
CONSTRUCTION EASEMENT AND PERMANENT
EASEMENT GEOMETRY.

UTILITY INFORMATION IS ONLY SHOWN IN
AREAS OF PROPOSED UNDERGROUND WORK.

PROPOSED P.C.C. SIDEWALK CURB
S/W 724.36
T/C 725.44

XX000300 CONCRETE STEPS			
LOCATION (C. OF STEPS)	QUANTITY (50 FT)	RISER HEIGHT	TREAD WIDTH
19+15.3 RT.	15.7	2 @ 6.5"	16"
19+76.3 RT.	14.1	2 @ 6"	14"
24+37.2 LT.	33.3	2 @ 7"	12"
24+99.2 RT.	38.3	2 @ 6"	18"
25+53.2 RT.	39.3	2 @ 7"	18"
26+53.5 RT.	40.3	N/A	N/A
27+73.9 RT.	38.1	1 @ 7"	18"
28+55.3 LT.	33.2	2 @ 6"	18"
TOTAL	252.3		

SEC. 16, T.19N., R.9E., 3rd P.M.
CHAMPAIGN COUNTY, ILLINOIS

SEC. 9, T.19N., R.9E., 3rd P.M.
CHAMPAIGN COUNTY, ILLINOIS

PROPOSED REINFORCED P.C.C.
SIDEWALK, VARIABLE DEPTH
SEE MISC. DETAILS AND SPECIAL
PROVISIONS FOR ADDITIONAL
INFORMATION

TBM #7
TOP CENTER CAP BOLT OF FIRE
HYDRANT AT STA. 26+75.93 27.41' LT
ELEV.= 729.27

STRUCTURE LEGEND		LEGEND	
TA - TYPE A (MANHOLE OR INLET)			PORTLAND CEMENT CONCRETE BASE COURSE 10"
TB - TYPE B (INLET)			PORTLAND CEMENT CONCRETE DRIVEWAY PAVEMENT (6" P.E.-8" C.E.)
R.D. - RESTRICTED DEPTH			PORTLAND CEMENT CONCRETE SIDEWALK 6"
C RIM - CENTER OF 2' OPENING			DETECTABLE WARNINGS
RIM - TOP OF FRAME ELEVATION			BRICK SIDEWALK
T/F.S.T. - TOP OF FLAT SLAB TOP			TEMPORARY CONSTRUCTION EASEMENT
3 - TYPE 3 FRAME AND GRATE			
INV. - INVERT ELEVATION			

KEY NOTES

① 1' STUB (SEE PROP. TYPICAL SECTION NOTE 7)

② SEE INTERSECTION DETAILS FOR CURB LIMITS
AND ELEVATIONS

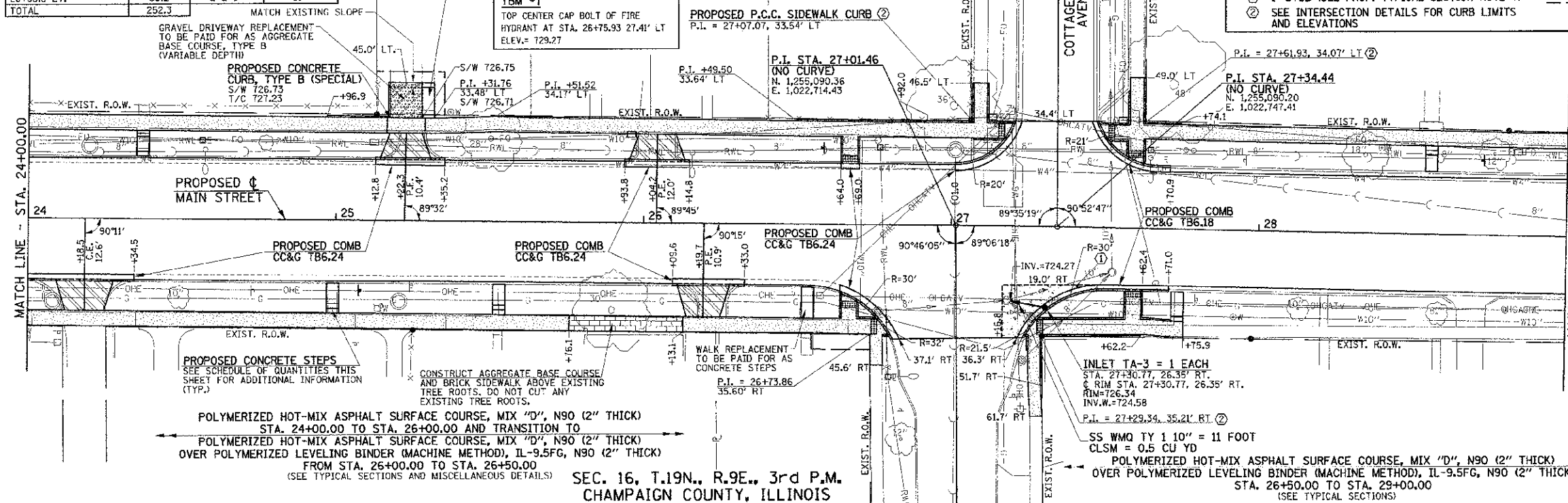

POLYMERIZED HOT-MIX ASPHALT SURFACE COURSE, MIX "D", N90 (2" THICK)
STA. 24+00.00 TO STA. 26+00.00 AND TRANSITION TO
POLYMERIZED HOT-MIX ASPHALT SURFACE COURSE, MIX "D", N90 (2" THICK)
OVER POLYMERIZED LEVELING BINDER (MACHINE METHOD), IL-9.5FG, N90 (2" THICK)
FROM STA. 26+00.00 TO STA. 26+50.00
(SEE TYPICAL SECTIONS AND MISCELLANEOUS DETAILS)

SEC. 16, T.19N., R.9E., 3rd P.M.
CHAMPAIGN COUNTY, ILLINOIS

FILE NAME =
p:\00070062_Urbana - Main Street I(T)P\Plans\sheet\09-roadway.dgn
PLOT DATE =
3/7/2013 7:11:51 PM

DESIGNED - J.A.J.	REVISED -
DRAWN - J.L.B.	REVISED -
CHECKED - S.M.W.	REVISED -
DATE - 03/2013	REVISED -

STATE OF ILLINOIS
DEPARTMENT OF TRANSPORTATION

ROADWAY PLANS

SCALE: 1"=20' SHEET NO. 27 OF 75 SHEETS STA. 19+00.00 TO STA. 29+00.00

F.A.U. R.I.E.	SECTION	COUNTY	TOTAL SHEETS	SHEET NO.
7124	09-00483-01-RS	CHAMPAIGN	75	27
MAIN STREET		CHAMPAIGN	CONTRACT NO. 91480	
FED. ROAD DIST. NO. [ILLINOIS] FED. AID PROJECT				