

SEC. 10, T.19N., R.9E., 3rd P.M.
CHAMPAIGN COUNTY, ILLINOIS

PROPOSED @
MAIN STREET
CURVE DATA
P.I. STA. 82+13.09
 $\Delta = 8^{\circ}07'28''$
 $D = 2^{\circ}23'14''$
 $T = 170.44'$
 $R = 2400.00'$
 $L = 340.32'$
 $E = 6.04'$
P.C. STA. 80+42.65
P.T. STA. 83+82.96

NOTE:
ALL SIDEWALK P.I. AND DRIVEWAY ELEVATION INFORMATION IS GIVEN AT THE BACK OF WALK OR FACE OF CURB (S/W = SIDEWALK, T/C = TOP OF CURB). SEE INTERSECTION DETAILS FOR ADDITIONAL INFORMATION AT INTERSECTION QUADRANTS.

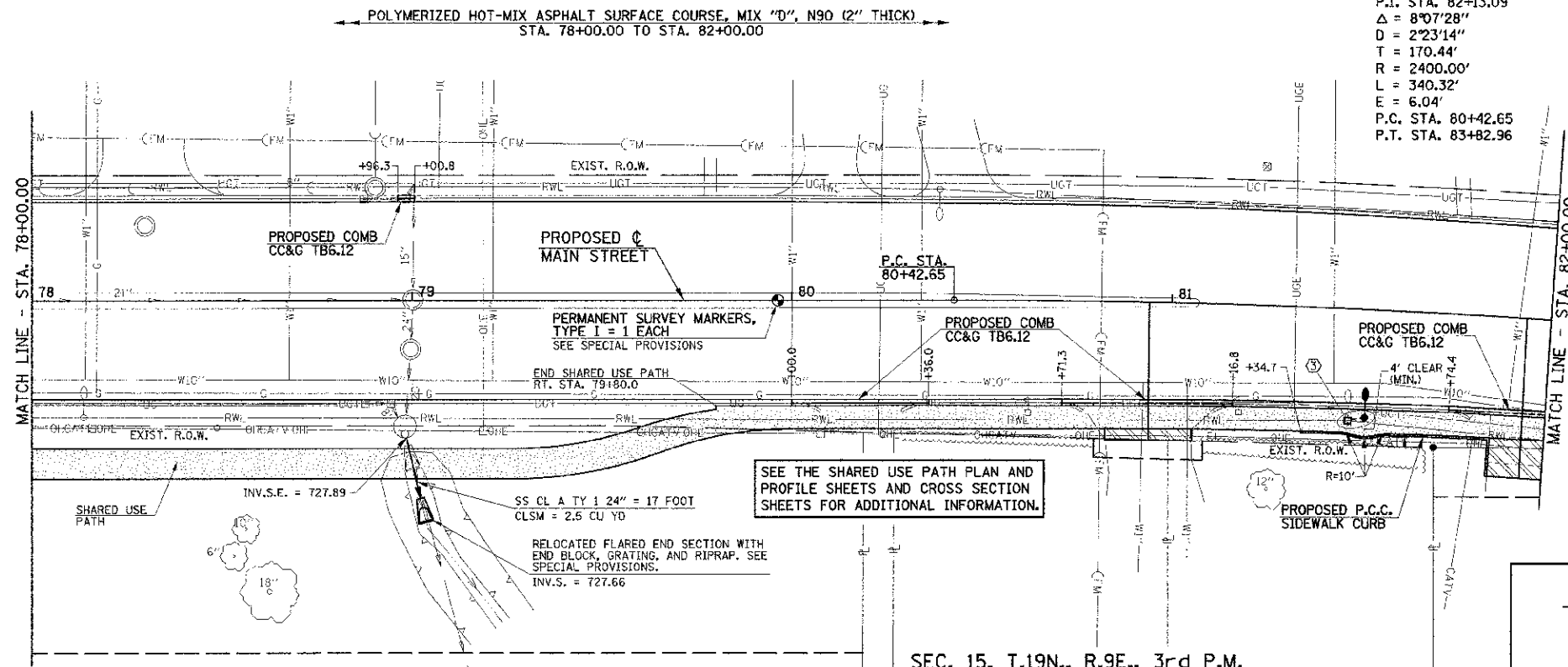
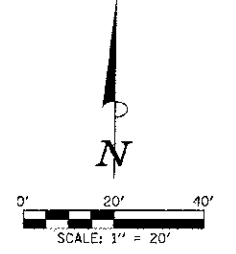

- ① THE HEIGHT OF ALL PROPOSED MONOLITHIC SIDEWALK CURB, PCC SIDEWALK CURB, AND CONCRETE CURB TYPE B (SPECIAL) SHALL TRANSITION TO MATCH THE HEIGHT OF THE EXISTING CURB OR STEPS THAT THE CURB CONNECTS TO OR SHALL TRANSITION TO ZERO HEIGHT AT EXISTING GROUND UNLESS OTHERWISE DIRECTED BY THE ENGINEER.
- ② ALL STREET RADII ARE DIMENSIONED TO THE BACK OF CURB.
- ③ SEE HORIZONTAL ALIGNMENT LAYOUT AND CONTROL SHEETS FOR TEMPORARY CONSTRUCTION EASEMENT AND PERMANENT EASEMENT GEOMETRY.
- ④ SOME OF THE TOPOGRAPHIC INFORMATION OUTSIDE OF THE ROADWAY SHOWN ON THIS SHEET IS BASED ON AERIAL PHOTOGRAPHY AND IS APPROXIMATE.
- ⑤ UTILITY INFORMATION IS ONLY SHOWN IN AREAS OF PROPOSED UNDERGROUND WORK.

SEC. 15, T.19N., R.9E., 3rd P.M.
CHAMPAIGN COUNTY, ILLINOIS

SEC. 10, T.19N., R.9E., 3rd P.M.
CHAMPAIGN COUNTY, ILLINOIS

- | STRUCTURE LEGEND | | LEGEND | |
|---------------------------------|--|--------|--|
| TA - TYPE A (MANHOLE OR INLET) | | | PORTLAND CEMENT CONCRETE BASE COURSE 10" |
| TB - TYPE B (INLET) | | | PORTLAND CEMENT CONCRETE DRIVEWAY PAVEMENT (6" P.E.-8" C.E.) |
| R.D. - RESTRICTED DEPTH | | | PORTLAND CEMENT CONCRETE SIDEWALK 6" |
| @ RIM - CENTER OF 2' OPENING | | | DETECTABLE WARNINGS |
| RIM - TOP OF FRAME ELEVATION | | | BRICK SIDEWALK |
| T/F.S.T. - TOP OF FLAT SLAB TOP | | | TEMPORARY CONSTRUCTION EASEMENT |
| 3 - TYPE 3 FRAME AND GRATE | | | |
| INV. - INVERT ELEVATION | | | |
- KEY NOTES
① 1' STUB (SEE PROP. TYPICAL SECTION NOTE 7)
② SEE INTERSECTION DETAILS FOR CURB LIMITS AND ELEVATIONS

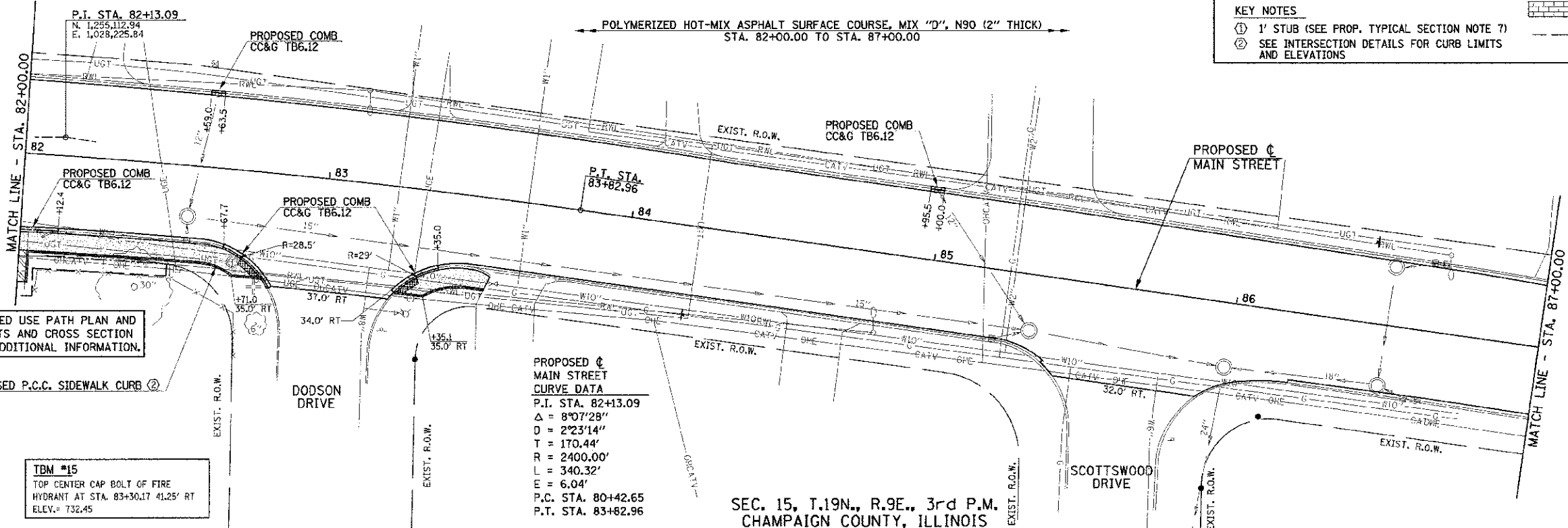

FILE NAME = p:\0070062_urbana - Main Street\11EPM\plans\sheet\09-roadway.dgn	DESIGNED - J.A.J.	REVISED -	F.A.U. RTE. 7124	SECTION 09-00483-01-RS	COUNTY CHAMPAIGN	TOTAL SHEETS 75	SHEET NO. 33
PLOT DATE = 5/8/2013 11:51:35 AM	DRAWN - J.L.B.	REVISED -	ROADWAY PLANS		CONTRACT NO. 91480		
	CHECKED - S.M.W.	REVISED -	SCALE: 1"=20'	SHEET NO. 33 OF 75 SHEETS	STA. 78+00.00 TO STA. 87+00.00	FED. ROAD DIST. NO. ILLINOIS FED. AID PROJECT	
	DATE - 03/2013	REVISED -	STATE OF ILLINOIS DEPARTMENT OF TRANSPORTATION				