

EROSION CONTROL GENERAL NOTES

1. THE TEMPORARY EROSION CONTROL SYSTEMS SHALL BE INSTALLED AND MAINTAINED BY THE CONTRACTOR AT THE LOCATIONS SHOWN ON THE STORM WATER POLLUTION PREVENTION PLAN AND AS DIRECTED BY THE ENGINEER. THE PLACEMENT OF THE TEMPORARY EROSION CONTROL SYSTEMS IS NECESSARY TO SATISFY THE REQUIREMENTS OF THE NPDES PERMIT. THE WORK SHALL BE IN ACCORDANCE WITH STANDARD 280001 AND SECTION 280 OF THE STANDARD SPECIFICATIONS.
2. ADDITIONAL TEMPORARY EROSION CONTROL SYSTEMS MAY BE REQUIRED DURING CONSTRUCTION. THE SYSTEMS SHALL BE PLACED AS DIRECTED BY THE ENGINEER AND SHALL BE PAID FOR IN ACCORDANCE WITH SECTION 280 OF THE STANDARD SPECIFICATIONS.
3. TEMPORARY EROSION CONTROL SEEDING SHALL BE PERFORMED AS DIRECTED BY THE ENGINEER AND IN ACCORDANCE WITH SECTION 280 OF THE STANDARD SPECIFICATIONS. THE QUANTITY OF TEMPORARY EROSION CONTROL SEEDING NEEDED TO COVER THE ENTIRE AREA OF PERMANENT SEEDING HAS BEEN ALLOWED FOR THIS PROJECT.
4. PERMANENT FERTILIZING, SEEDING, AND MULCHING OF DISTURBED EARTH AREAS SHALL BE PERFORMED AS SOON AS POSSIBLE AFTER THE COMPLETION OF EACH STAGE OF THE PROJECT TO EXPEDITE THE ESTABLISHMENT OF VEGETATION. THE FINAL GRADING MUST BE APPROVED BY THE ENGINEER BEFORE THE PERMANENT SEEDING IS PERFORMED.
5. THE MAINTENANCE OF THE TEMPORARY EROSION CONTROL SYSTEMS WILL NOT BE PAID FOR SEPARATELY AS DESCRIBED IN ARTICLE 280.08 OF THE STANDARD SPECIFICATIONS AND SHALL BE INCLUDED IN THE COST OF THE VARIOUS EROSION CONTROL PAY ITEMS.
6. THE CONTRACTOR SHALL BE RESPONSIBLE FOR THE SEEDED AREAS UNTIL THEY ARE FULLY ESTABLISHED WHICH MAY REQUIRE RESEEDING OF ANY BARE AREAS AND PLACING ADDITIONAL MULCH UNTIL SEED GROWTH IS ESTABLISHED. THE CONTRACTOR SHALL MAINTAIN THE SEEDED AREAS UNTIL SUCH TIME AS THE REQUIREMENTS OF THE NPDES PERMIT ARE SATISFIED AND THE PERMIT IS TERMINATED.
7. SEE THE ROADWAY PLANS, SHARED USE PATH PLAN AND PROFILE SHEETS, AND SHARED USE PATH CROSS SECTIONS FOR ADDITIONAL INFORMATION.

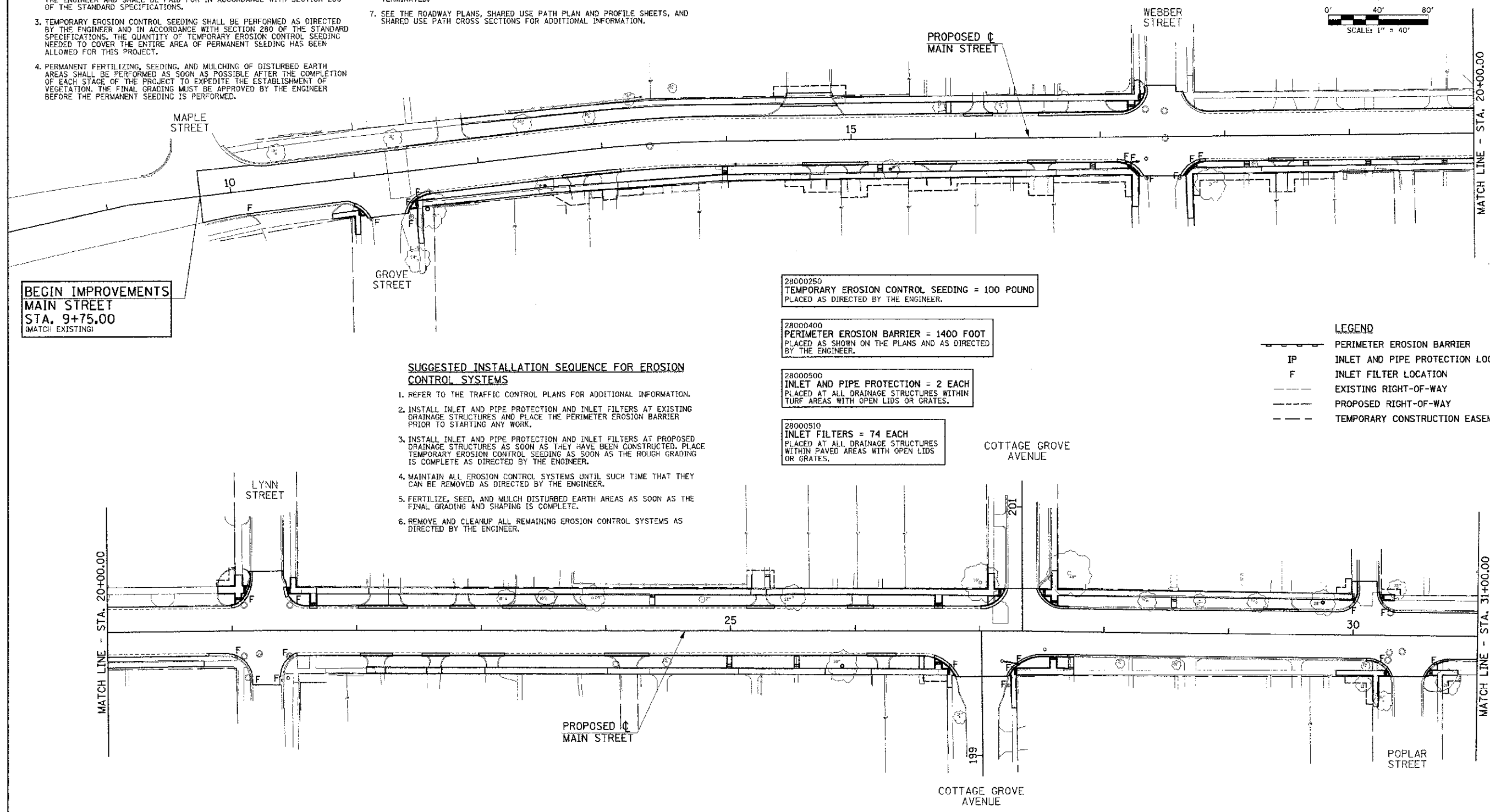
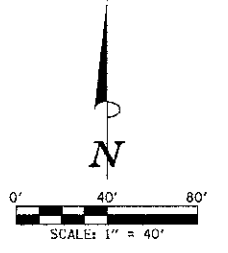

**BEGIN IMPROVEMENTS
MAIN STREET
STA. 9+75.00
(MATCH EXISTING)**

28000250
TEMPORARY EROSION CONTROL SEEDING = 100 POUND
PLACED AS DIRECTED BY THE ENGINEER.

28000400
PERIMETER EROSION BARRIER = 1400 FOOT
PLACED AS SHOWN ON THE PLANS AND AS DIRECTED
BY THE ENGINEER.

28000500
INLET AND PIPE PROTECTION = 2 EACH
PLACED AT ALL DRAINAGE STRUCTURES WITHIN
TURF AREAS WITH OPEN LIDS OR GRATES.

28000510
INLET FILTERS = 74 EACH
PLACED AT ALL DRAINAGE STRUCTURES
WITHIN PAVED AREAS WITH OPEN LIDS
OR GRATES.

SUGGESTED INSTALLATION SEQUENCE FOR EROSION CONTROL SYSTEMS

1. REFER TO THE TRAFFIC CONTROL PLANS FOR ADDITIONAL INFORMATION.
2. INSTALL INLET AND PIPE PROTECTION AND INLET FILTERS AT EXISTING DRAINAGE STRUCTURES AND PLACE THE PERIMETER EROSION BARRIER PRIOR TO STARTING ANY WORK.
3. INSTALL INLET AND PIPE PROTECTION AND INLET FILTERS AT PROPOSED DRAINAGE STRUCTURES AS SOON AS THEY HAVE BEEN CONSTRUCTED. PLACE TEMPORARY EROSION CONTROL SEEDING AS SOON AS THE ROUGH GRADING IS COMPLETE AS DIRECTED BY THE ENGINEER.
4. MAINTAIN ALL EROSION CONTROL SYSTEMS UNTIL SUCH TIME THAT THEY CAN BE REMOVED AS DIRECTED BY THE ENGINEER.
5. FERTILIZE, SEED, AND MULCH DISTURBED EARTH AREAS AS SOON AS THE FINAL GRADING AND SHAPING IS COMPLETE.
6. REMOVE AND CLEANUP ALL REMAINING EROSION CONTROL SYSTEMS AS DIRECTED BY THE ENGINEER.

LEGEND

—	PERIMETER EROSION BARRIER
IP	INLET AND PIPE PROTECTION LOCATION
F	INLET FILTER LOCATION
---	EXISTING RIGHT-OF-WAY
---	PROPOSED RIGHT-OF-WAY
---	TEMPORARY CONSTRUCTION EASEMENT

FILE NAME = p:\U0970062_Urbana - Main Street ITEP\plans\sheets\12-stormwater.dgn
 PLOT DATE = 3/6/2013 11:44:18 PM

DESIGNED - J.A.J.	REVISED -
DRAWN - A.E.A.	REVISED -
CHECKED - S.M.W.	REVISED -
DATE - 03/2013	REVISED -

STATE OF ILLINOIS
DEPARTMENT OF TRANSPORTATION

STORM WATER POLLUTION PREVENTION PLANS

SCALE : 1"=40' SHEET NO. 39 OF 75 SHEETS STA. 10+00.00 TO STA. 31+00.00

F.A.U. RTE. 7124	SECTION 09-00483-01-RS	COUNTY CHAMPAIGN	TOTAL SHEETS 75	SHEET NO. 39
MAIN STREET		CONTRACT NO. 91480		
FED. ROAD DIST. NO. ILLINOIS' FED. AID PROJECT				