

SEC. 9, T.19N., R.9E., 3rd P.M.  
CHAMPAIGN COUNTY, ILLINOIS

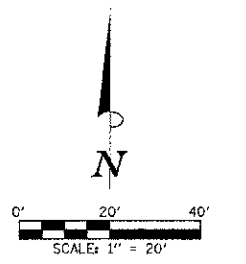
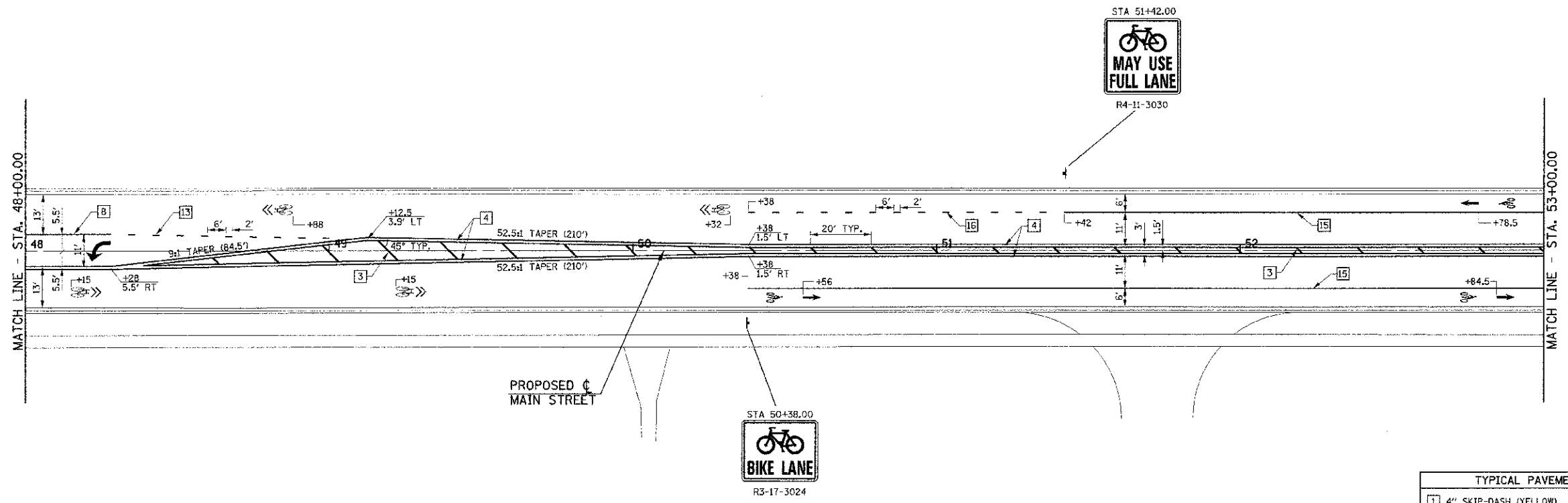

SEC. 16, T.19N., R.9E., 3rd P.M.  
CHAMPAIGN COUNTY, ILLINOIS

SEC. 9, T.19N., R.9E., 3rd P.M.  
CHAMPAIGN COUNTY, ILLINOIS

TYPICAL PAVEMENT MARKING AND SIGNING LEGEND	
1 4" SKIP-DASH (YELLOW)	9 12" DIAGONAL (WHITE)
2 4" SOLID (YELLOW)	10 6" CROSSWALK (WHITE)
3 12" DIAGONAL (YELLOW)	11 24" STOP BAR (WHITE)
4 4" DOUBLE (YELLOW) (NARROW)	12 8" SOLID (WHITE)*
5 4" DOUBLE (YELLOW) (WIDE)*	13 4" LANE LINE EXTENSIONS (WHITE)
6 6" DIAGONAL (YELLOW)*	14 12" CROSSWALK (WHITE)*
7 4" SKIP-DASH (WHITE)*	15 6" SOLID (WHITE)
8 4" SOLID (WHITE)	16 6" LANE LINE EXTENSIONS (WHITE)
*NOT USED	
— METAL POST - TYPE B	

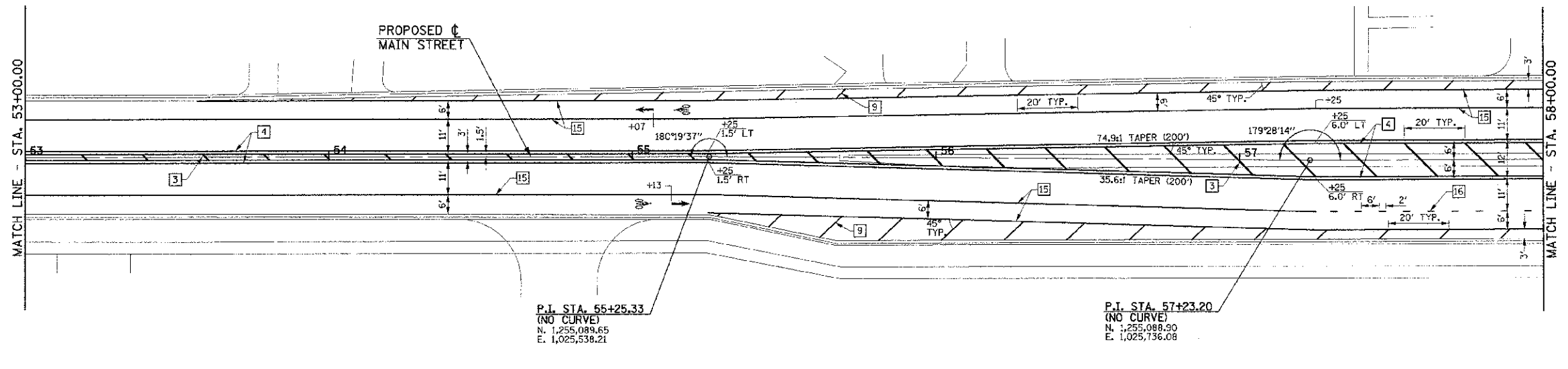

SEC. 16, T.19N., R.9E., 3rd P.M.  
CHAMPAIGN COUNTY, ILLINOIS

FILE NAME = p:\0070062_Urbana - Main Street\TEP\Plans\sheet\14-pvrr-marking.dgn	DESIGNED - J.A.W.	REVISED -	STATE OF ILLINOIS DEPARTMENT OF TRANSPORTATION	PAVEMENT MARKING AND SIGNING PLANS		F.A.U. RTE. = 7124	SECTION = 09-00483-01-RS	COUNTY = CHAMPAIGN	TOTAL SHEET NO. = 75	SHEET NO. = 51		
PLOT DATE = 3/6/2013 11:44:28 PM	DRAWN - D.L.M.	REVISED -				SCALE : 1"=20'	SHEET NO. 51 OF 75 SHEETS	STA. 48+00.00 TO STA. 58+00.00	FED. ROAD DIST. NO. =		ILLINOIS FED. AID PROJECT	CONTRACT NO. = 91480
	CHECKED - S.M.W.	REVISED -										
	DATE - 03/2013	REVISED -										