

SEC. 10, T.19N., R.9E., 3rd P.M.
CHAMPAIGN COUNTY, ILLINOIS

PROPOSED C
MAIN STREET
CURVE DATA
P.I. STA. 82+13.09
 $\Delta = 8^{\circ}07'28''$
 $D = 2^{\circ}23'14''$
 $T = 170.44'$
 $R = 2400.00'$
 $L = 340.32'$
 $E = 6.04'$
P.C. STA. 80+42.65
P.T. STA. 83+82.96

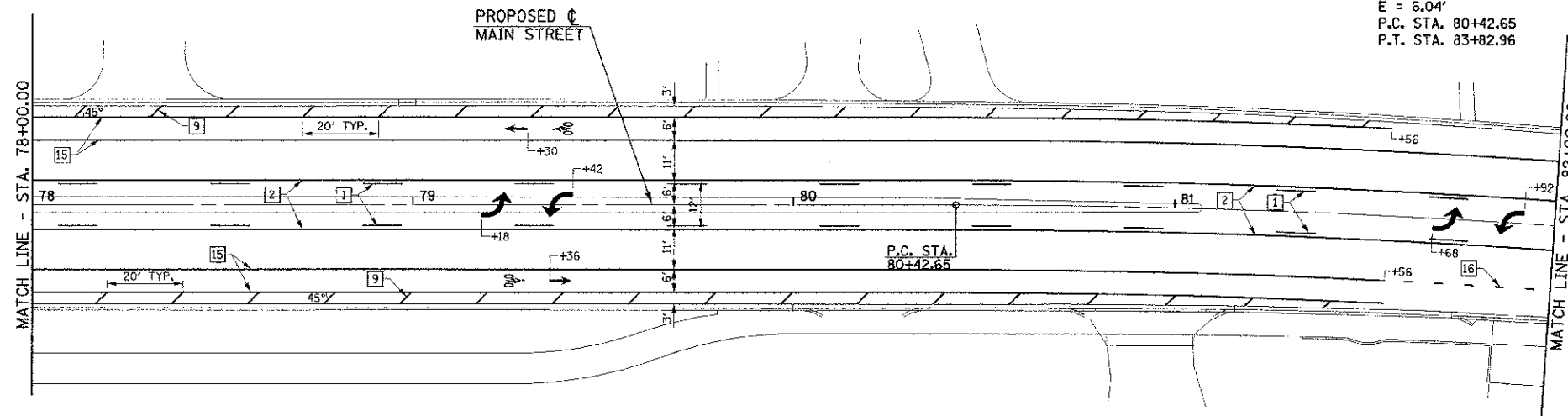
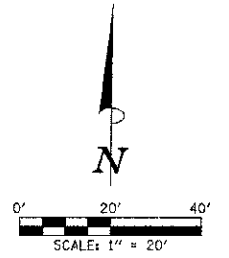

SEC. 15, T.19N., R.9E., 3rd P.M.
CHAMPAIGN COUNTY, ILLINOIS

SEC. 10, T.19N., R.9E., 3rd P.M.
CHAMPAIGN COUNTY, ILLINOIS

TYPICAL PAVEMENT MARKING AND SIGNING LEGEND	
1 4" SKIP-DASH (YELLOW)	9 12" DIAGONAL (WHITE)
2 4" SOLID (YELLOW)	10 6" CROSSWALK (WHITE)
3 12" DIAGONAL (YELLOW)	11 24" STOP BAR (WHITE)
4 4" DOUBLE (YELLOW) (NARROW)	12 8" SOLID (WHITE)*
5 4" DOUBLE (YELLOW) (WIDE)*	13 4" LANE LINE EXTENSIONS (WHITE)
6 6" DIAGONAL (YELLOW)*	14 12" CROSSWALK (WHITE)*
7 4" SKIP-DASH (WHITE)*	15 6" SOLID (WHITE)
8 4" SOLID (WHITE)	16 6" LANE LINE EXTENSIONS (WHITE)
*NOT USED	▲ METAL POST - TYPE B

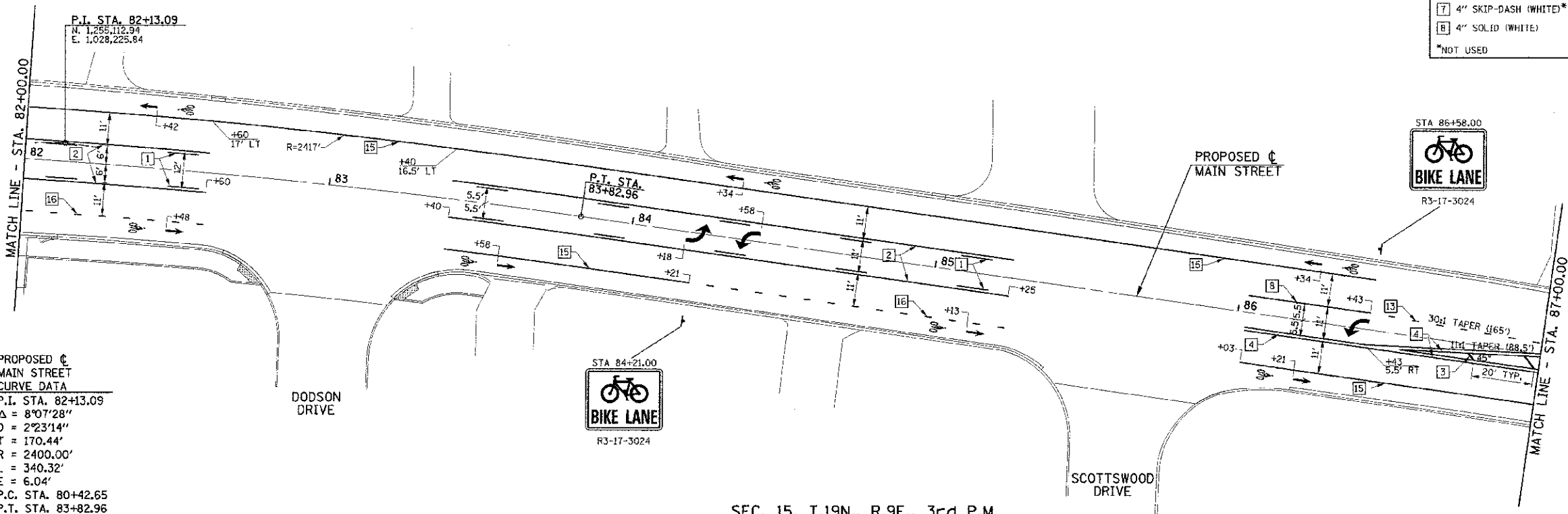

PROPOSED C
MAIN STREET
CURVE DATA
P.I. STA. 82+13.09
 $\Delta = 8^{\circ}07'28''$
 $D = 2^{\circ}23'14''$
 $T = 170.44'$
 $R = 2400.00'$
 $L = 340.32'$
 $E = 6.04'$
P.C. STA. 80+42.65
P.T. STA. 83+82.96



SEC. 15, T.19N., R.9E., 3rd P.M.
CHAMPAIGN COUNTY, ILLINOIS

FILE NAME = p:\U0070062_Urbana - Main Street ITC\Plans\sheet14-pvm1-marking.dgn	DESIGNED - J.A.J.	REVISED -	STATE OF ILLINOIS DEPARTMENT OF TRANSPORTATION	PAVEMENT MARKING AND SIGNING PLANS	F.A.U. RITE. 7124	SECTION 09-00483-01-RS	COUNTY CHAMPAIGN	TOTAL SHEETS 75	SHEET NO. 54	
PLOT DATE = 3/6/2013 11:44:28 PM	DRAWN - D.J.M.	REVISED -			SCALE: 1"=20'	SHEET NO. 54 OF 75 SHEETS	MAIN STREET		CONTRACT NO. 91480	
	CHECKED - S.M.W.	REVISED -			STA. 78+00.00 TO STA. 87+00.00	STA. 78+00.00 TO STA. 87+00.00	FED. ROAD DIST. NO. ILLINOIS		FED. AID PROJECT	
	DATE - 03/2013	REVISED -								