

ROUTE	SECTION	COUNTY	TOTAL SHEETS	SHEET NO.
FAS 680 (CH 4)	12-00111-00-RS	EDGAR	27	10
EDGAR COUNTY, ILLINOIS		CONTRACT NO. 91485		
		FED. AID PROJECT		

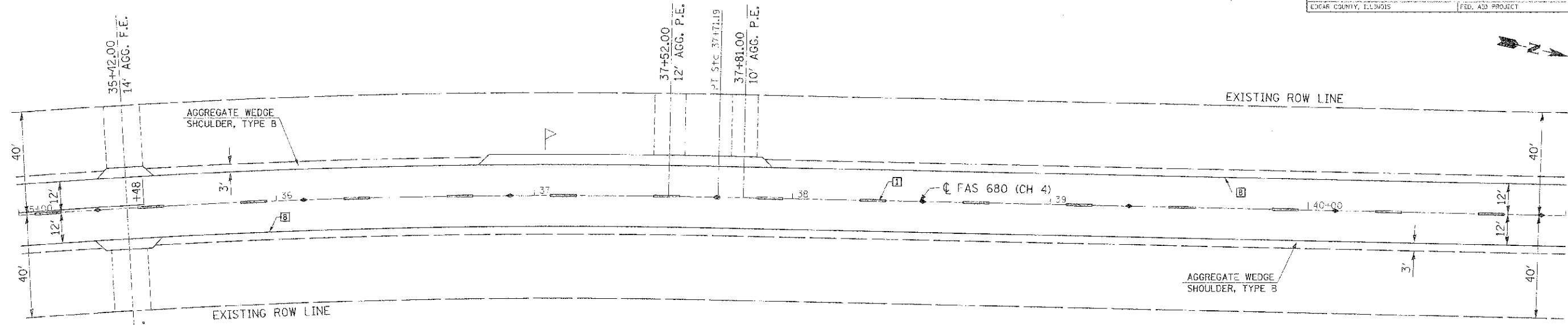

EXIST. CURVE LOWERT-2
 P.I. STA. = 34+42.66
 $\Delta = 13^\circ 11' 59''$ (RT)
 $D = 2^\circ 00' 00''$
 $R = 2,864.79'$
 $T = 331.46'$
 $L = 659.99'$
 $E = 19.11'$
 P.C. STA. = 31+11.20
 P.T. STA. = 37+71.19

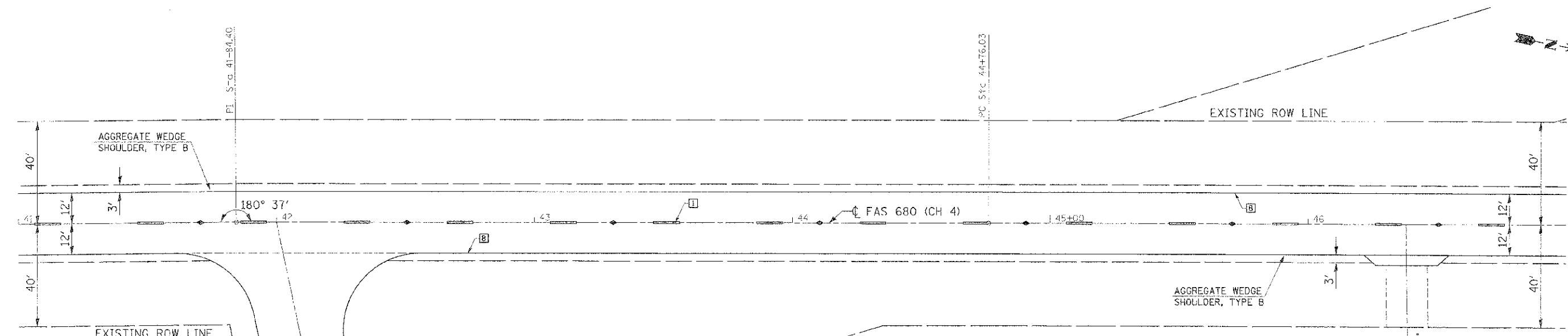

EXIST. CURVE LOWERT-3
 P.I. STA. = 49+51.01
 $\Delta = 0^\circ 57' 00''$ (RT)
 $D = 0^\circ 06' 30''$
 $R = 57,295.78'$
 $T = 474.98'$
 $L = 949.94'$
 $E = 1.97'$
 P.C. STA. = 44+76.03
 P.T. STA. = 54+25.97

TYPICAL PAVEMENT MARKING LEGEND

- 1 4" (100) SKIP-CASH (YELLOW)
- 2 4" (100) SOLID (YELLOW)
- 3 12" (300) DIAGONAL (YELLOW)
- 4 4" (100) DOUBLE YELLOW (NARROW)
- 8 4" (100) SOLID (WHITE)

TYPICAL PAVEMENT MARKERS LEGEND

- ◆ TWO-WAY AMBER MARKER
- ▼ ONE-WAY AMBER MARKER
- ▷ ONE-WAY CRYSTAL MARKER

PLAN
 DATE:
 SCALE: 1" = 20'



EDGAR COUNTY
 HIGHWAY DEPARTMENT