

ROUTE	SECTION	COUNTY	TOTAL SHEETS	SHEET NO.
FAS 680 (CH 4)	12-0011-00-RS	EDGAR	27	11
EDGAR COUNTY, ILLINOIS			FED. AID PROJECT	
CONTRACT NO. 91485				

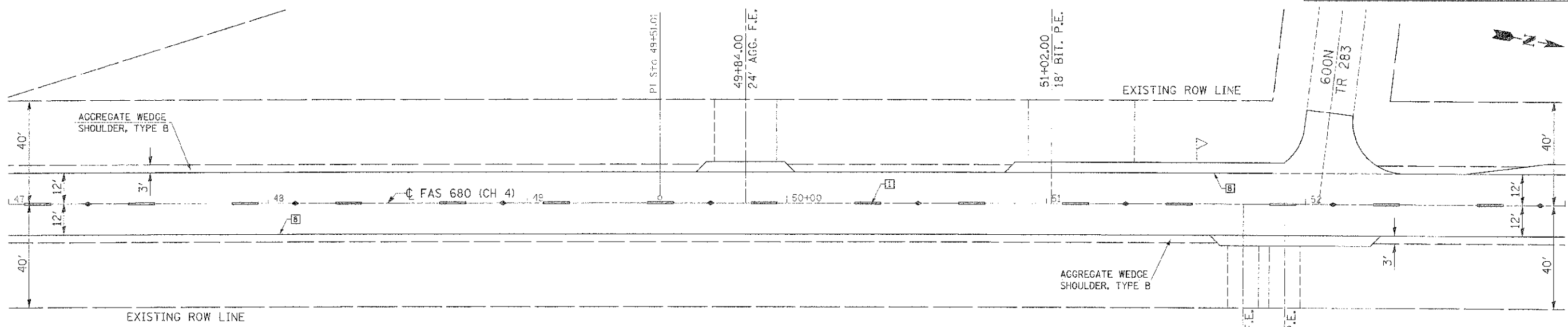

EXIST. CURVE LOWERT 3
 P.I. STA. = 49+51.01
 $\Delta = 0^\circ 57' 00''$ (RT)
 $D = 0^\circ 06' 00''$
 $R = 57,295.78'$
 $T = 474.98'$
 $L = 949.94'$
 $E = 1.97'$
 P.C. STA. = 44+76.03
 P.T. STA. = 54+25.97

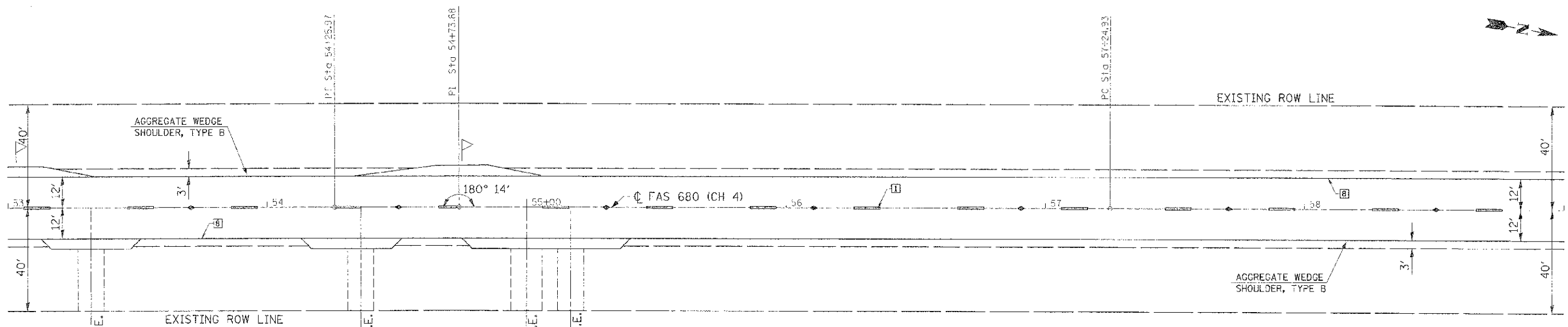

TYPICAL PAVEMENT MARKING LEGEND

- 1 4" (100) SKTP-DASH (YELLOW)
- 2 4" (100) SOLID (YELLOW)
- 3 12" (30C) DIAGONAL (YELLOW)
- 4 4" (100) DOUBLE YELLOW (NARROW)
- 8 4" (100) SOLID (WHITE)

TYPICAL PAVEMENT MARKERS LEGEND

- ◆ TWO-WAY AMBER MARKER
- ▶ ONE-WAY AMBER MARKER
- ▷ ONE-WAY CRYSTAL MARKER

EXIST. CURVE LOWERT-4
 P.I. STA. = 62+04.91
 $\Delta = 0^\circ 48' 00''$ (RT)
 $D = 0^\circ 05' 00''$
 $R = 68,754.94'$
 $T = 479.96'$
 $L = 959.94'$
 $E = 1.68'$
 P.C. STA. = 57+24.93
 P.T. STA. = 66+84.87

PLAN

DATE: _____
 SCALE: 1" = 20'

**EDGAR COUNTY
HIGHWAY DEPARTMENT**