

ROUTE	SECTION	COUNTY	TOTAL SHEETS	SHEET NO.
FAS 680 (CH 4)	12-00111-00-RS	EDGAR	27	13
EDGAR COUNTY, ILLINOIS			CONTRACT NO. 91485	
			FED. AID PROJECT	

EXIST. CURVE LOWERT-5
 PI STA. = 77+73.96
 $\Delta = 5^\circ 25' 00''$ (LT)
 $D = 0^\circ 36' 00''$
 $R = 9,549.30'$
 $T = 451.72'$
 $L = 902.77'$
 $E = 10.68'$
 P.C. STA. = 73+22.24
 P.T. STA. = 82+25.01

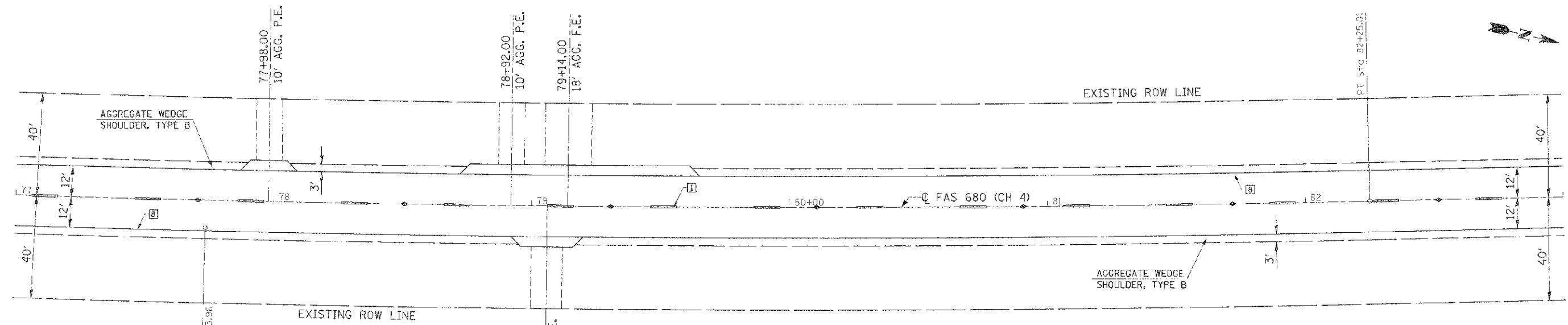
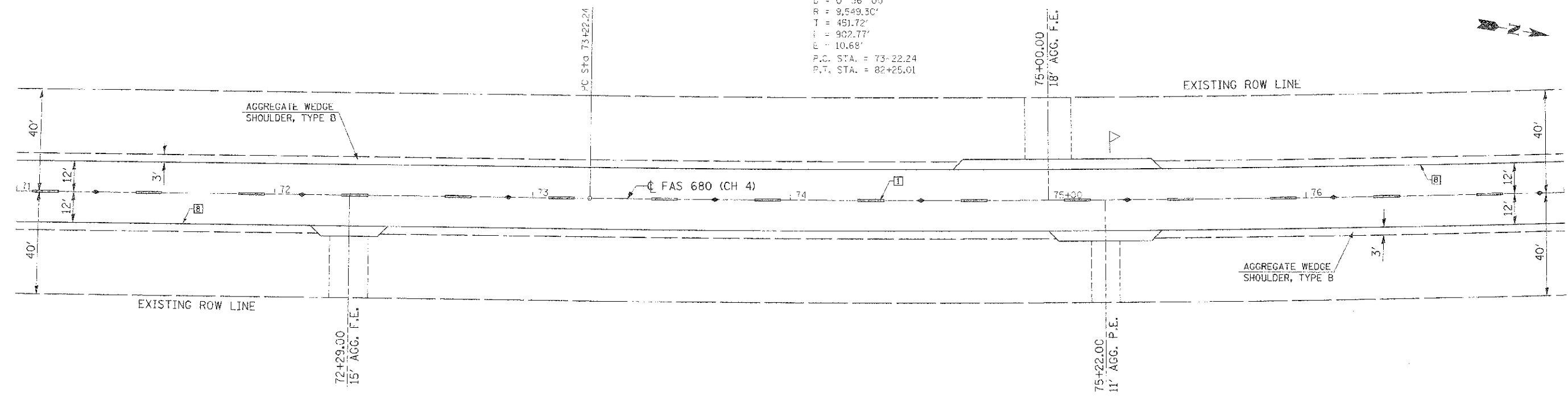
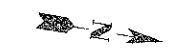

TYPICAL PAVEMENT MARKING LEGEND

- 1 4" (100) SKIP-DASH (YELLOW)
- 2 4" (100) SOLID (YELLOW)
- 3 12" (300) DIAGONAL (YELLOW)
- 4 4" (100) DOUBLE YELLOW (NARROW)
- 8 4" (100) SOLID (WHITE)

TYPICAL PAVEMENT MARKERS LEGEND

- ◆ TWO-WAY AMBER MARKER
- ▼ ONE-WAY AMBER MARKER
- ▷ ONE-WAY CRYSTAL MARKER

EXIST. CURVE LOWERT-5
 PI STA. = 77+73.96
 $\Delta = 5^\circ 25' 00''$ (LT)
 $D = 0^\circ 36' 00''$
 $R = 9,549.30'$
 $T = 451.72'$
 $L = 902.77'$
 $E = 10.68'$
 P.C. STA. = 73+22.24
 P.T. STA. = 82+25.01

PLAN
 SCALE: 1" = 20'



**EDGAR COUNTY
 HIGHWAY DEPARTMENT**

FILELY