

DATE	
BY	
REVISIONS	
NO.	
DATE	
BY	
REVISIONS	
NO.	
DATE	
BY	
REVISIONS	
NO.	

DATE	
BY	
REVISIONS	
NO.	
DATE	
BY	
REVISIONS	
NO.	
DATE	
BY	
REVISIONS	
NO.	

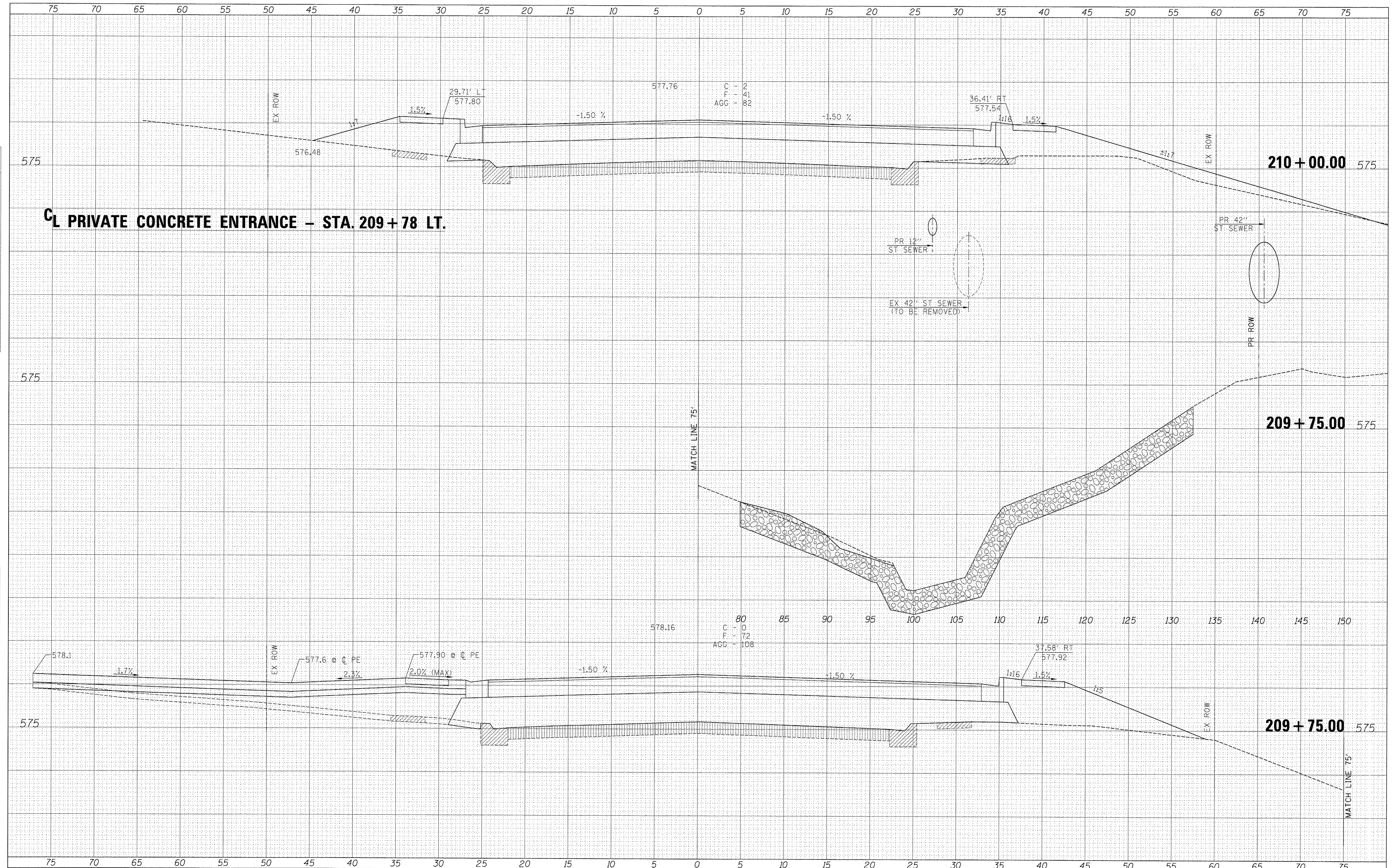

**CL PRIVATE CONCRETE ENTRANCE - STA. 209+78 LT.**

FILE NAME	#FILE#
USER NAME	#USER#
DESIGNED	-
REVISIONS	-
NO.	
DATE	
BY	
REVISIONS	
NO.	
DATE	
BY	
REVISIONS	
NO.	

DESIGNED	-	REVISIONS	-
DRAWN	-	REVISIONS	-
CHECKED	-	REVISIONS	-
DATE	-	REVISIONS	-

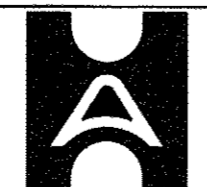

**Allen Henderson & Associates, Inc.**  
 Civil and Structural Engineers Springfield, IL  
 62703 Phone: (217)544-8033 IL Design Firm  
 No. 184-001907

**CROSS SECTIONS**  
 SCALE: VARIES SHEET NO. 17 OF 22 SHEETS STA. 209+75.00 TO STA. 210+00.00

F.A.U. RTE.	SECTION	COUNTY	TOTAL SHEETS	SHEET NO.
8006	10-00470-00-BR	SANGAMON	90	85
FED. ROAD DIST. NO.			ILLINOIS FED. AID PROJECT	
			CONTRACT NO. 93600	