

Benchmark:
 Railroad Spike in Power Pole on northerly side of Valmeyer Rd. Approximately 125' northwesterly from N.W. corner of existing abutment. Elevation 425.69.

Existing Structure:
 S.N. 067-6002 was built in 1979. The superstructure is three 33'-0" spans of 3'-9" wide by 1'-9" deep pre-cast channel beams. The abutments are cast in place concrete on a single row of timber piles and the piers are solid wall pile bents with steel H Piles. The existing substructure will be reused and superstructure will be replaced with PPC deck beams. The road will be closed during construction.

No slavage.
 Traffic Barrier Terminal
 Type 6A Std. 631032, typ.

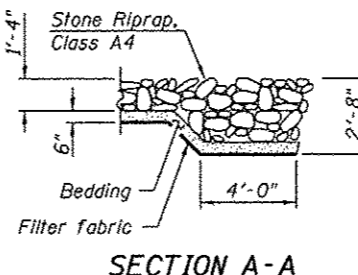
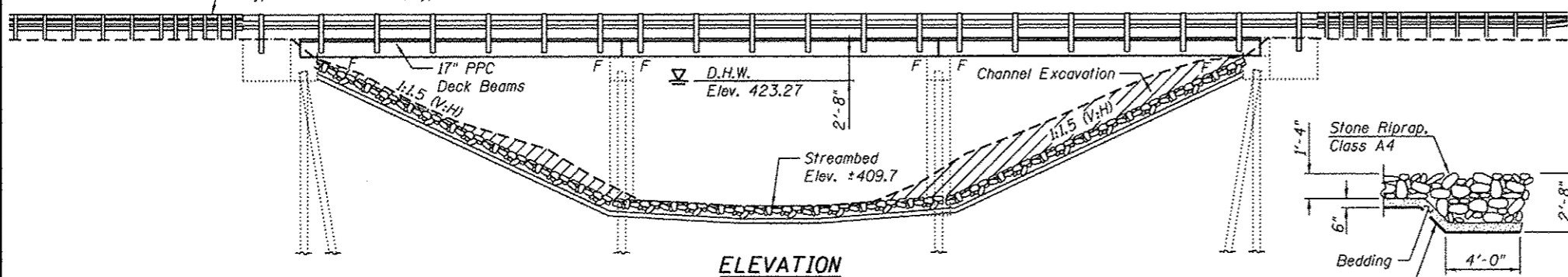

INDEX OF SHEETS

1. General Plan & Elevation
2. Superstructure
3. Steel Railing, Type SM
- 4-5. PPC Deck Beam Details
6. Substructure Details
- 7-12. Existing Bridge Plans

LOADING HL-93

Allow 50#/sq. ft. for future wearing surface.

DESIGN SPECIFICATIONS

PROPOSED SUPERSTRUCTURE
 2012 AASHTO LRFD Bridge Design Specifications, 6th Edition
EXISTING SUBSTRUCTURE
 AASHTO Standard Specifications for Highway Bridges, 17th Ed.

DESIGN STRESSES

PRECAST PRESTRESSED UNITS

f'c = 6,000 psi
 f'ci = 5,000 psi
 fpu = 270,000 psi (low-lax strands)

SEISMIC DATA

Seismic Performance Category (SPC) = B
 Bedrock Acceleration Coefficient (A) = 0.11g
 Site Coefficient (S) = 1.0

CARR CREEK
 RE-BUILT 20__ BY
 CITY OF COLUMBIA
 SEC. 78-00023-00-BR
 STATION 20+00
 STR. NO. 067-6002 LOADING HL-93

NAME PLATE

See Std. 515001
 Existing Name Plate shall be cleaned and relocated next to new Name Plate. Cost included with Name Plates. See Special Provisions.

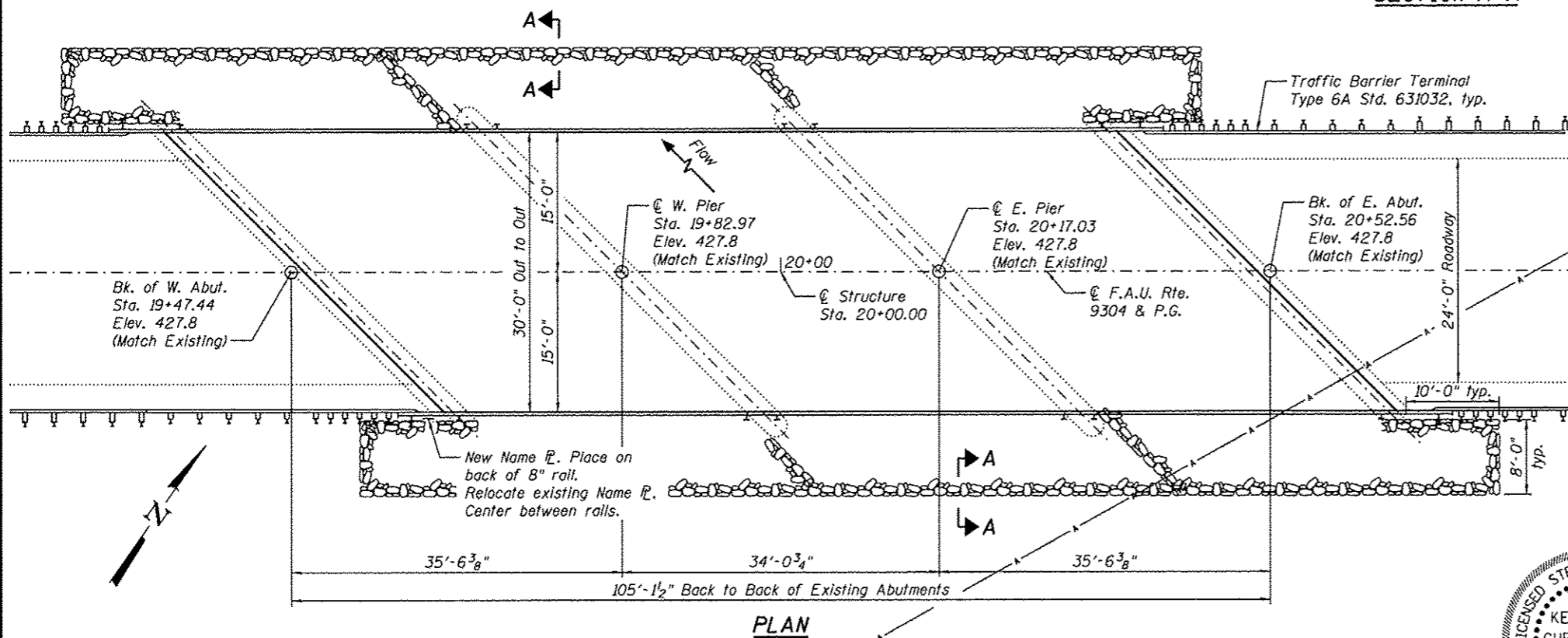

GENERAL NOTES

Reinforcement bars designated (E) shall be epoxy coated. Plan dimensions and details relative to existing plans are subject to nominal construction variations. The Contractor shall field verify existing dimensions and details affecting new construction and make necessary approved adjustments prior to construction or ordering of materials. Such variations shall not be cause for additional compensation for a change in scope of the work, however, the Contractor will be paid for the quantity actually furnished at the unit price bid for the work. Layout of the slope protection system may be varied to suit ground conditions in the field as directed by the Engineer.

TOTAL BILL OF MATERIAL

ITEM	UNIT	SUPER	SUB	TOTAL
Channel Excavation	Cu. Yd.	-	-	235
Stone Riprap, Class A4	Sq. Yd.	-	608	608
Filter Fabric	Sq. Yd.	-	608	608
HMA Surface Course, Mix "C", N70	Tons	53	-	53
Removal of Existing Superstructures	Each	1	-	1
Precast Prestressed Concrete Deck Beams (17" Depth)	Sq. Ft.	3053	-	3053
Steel Railing, Type SM	Foot	227	-	227
Name Plates	Each	-	-	1
Waterproofing Membrane System	Sq. Yd.	341	-	341
Portland Cement Mortar Fairing Course	Foot	916	-	916



Kermit P. Christmann
 EXPIRES 11/30/2014

I certify that to the best of knowledge, information and belief, this bridge design is structurally adequate for the design loading shown on the plans. This design is an economical one for the style of structure and complies with requirements of the edition of the AASHTO Bridge Design Specifications listed on the plans.

WATERWAY INFORMATION

Drainage Area = 10.9 sq. mi. Proposed Overtopping Elev. = 423.74 at Sta. 22+51

Flood	Freq. Yr.	Q C.F.S.	Opening Sq. Ft.		Nat. Head - Ft.		Headwater El.		
			Exist.	Prop.	H.W.E.	Exist.	Prop.	Exist.	Prop.
Ten-Year	10	2,590	335.56	424.92	421.41	0.72	0.32	422.13	421.73
Design	30	3,678	439.24	548.44	423.27	0.48	0.39	423.75	423.66
Base	100	5,070	560.82	674.68	425.03	1.03	0.73	426.06	425.76
Prop. Max.	500	7,020	560.82	674.68	427.38	0.00	0.00	427.38	427.38

DESIGN SCOUR ELEVATION TABLE

Design Scour Elevations (ft)			
W. Abut.	W. Pier	E. Pier	E. Abut.
423.96	403.70	403.70	423.96

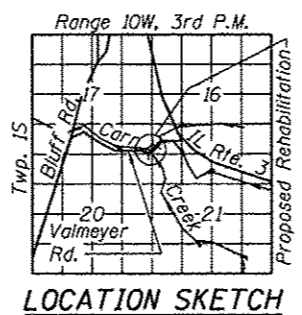

GENERAL PLAN & ELEVATION
VALMEYER ROAD OVER CARR CREEK
 F.A.U. 9304 - SECTION 78-00023-00-BR
 MONROE COUNTY
 STATION 20+00.00
 STRUCTURE NO. 067-6002

THOUVENOT, WADE & MOERCHEN, INC.
 SWANSEA • WATERLOO • EDWARDSVILLE • ST. LOUIS • ST. CHARLES



USER NAME • chaldaner	DESIGNED - MJJ	REVISED -
	CHECKED - ALN	REVISED -
PLOT SCALE • 0.1667" = 1'	DRAWN - MJJ	REVISED -
PLOT DATE • 4/8/2013	CHECKED - ALN	REVISED -

STATE OF ILLINOIS
 DEPARTMENT OF TRANSPORTATION

GENERAL PLAN
 STRUCTURE NO. 067-6002

SHEET NO. 1 OF 12 SHEETS

F.A.U. RTE. 9304	SECTION 12-00023-01-BR	COUNTY MONROE	TOTAL SHEETS 16	SHEET NO. 5
ROAD DIST. NO. [ILLINOIS] FED. AID PROJECT			CONTRACT NO. 97524	