

F.A.U. RTE.	SECTION	COUNTY	TOTAL SHEETS	SHEET NO.
B971	10-00047-02-RS	MADISON	45	11

CONTRACT NO. 97526

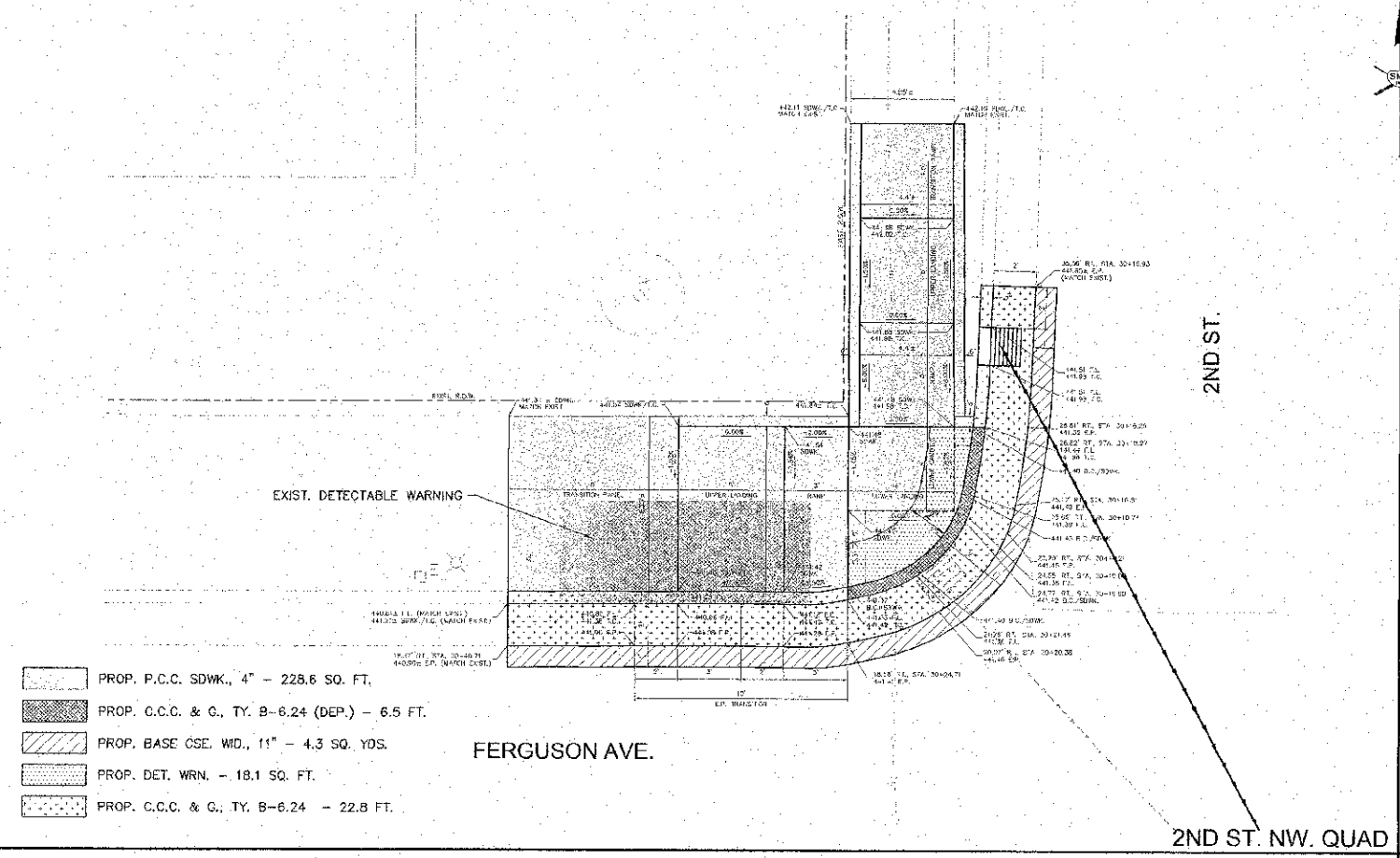

- PROP. P.C.C. SDWK., 4" - 228.6 SQ. FT.
- PROP. C.C.C. & G., TY. B-6.24 (DEP.) - 6.5 FT.
- PROP. BASE CSE. WD., 11" - 4.3 SQ. YDS.
- PROP. DET. WRN. - 18.1 SQ. FT.
- PROP. C.C.C. & G., TY. B-6.24 - 22.8 FT.

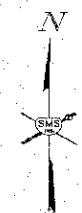
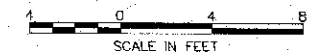
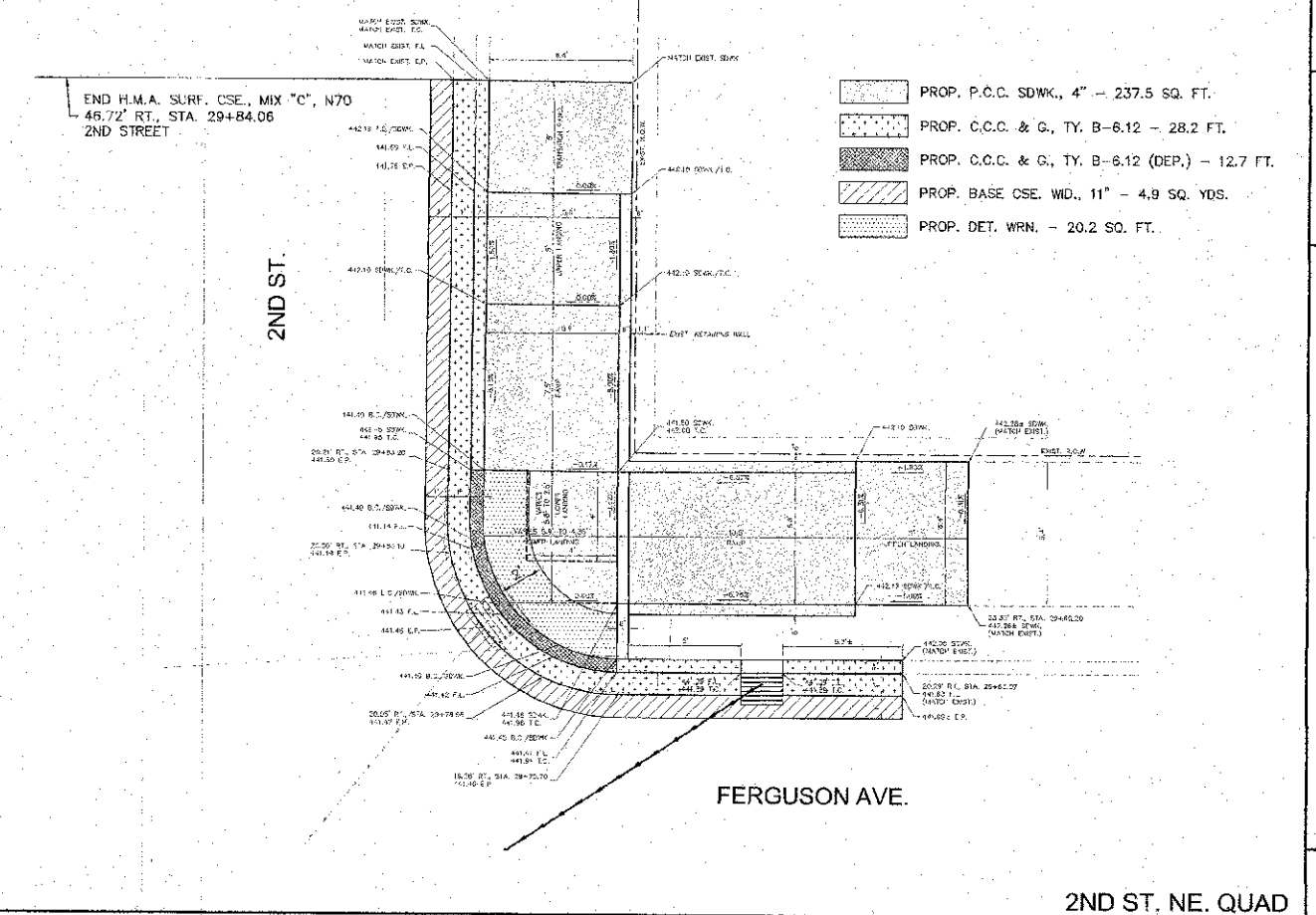

- PROP. P.C.C. SDWK., 4" - 237.5 SQ. FT.
- PROP. C.C.C. & G., TY. B-6.12 - 28.2 FT.
- PROP. C.C.C. & G., TY. B-6.12 (DEP.) - 12.7 FT.
- PROP. BASE CSE. WD., 11" - 4.9 SQ. YDS.
- PROP. DET. WRN. - 20.2 SQ. FT.

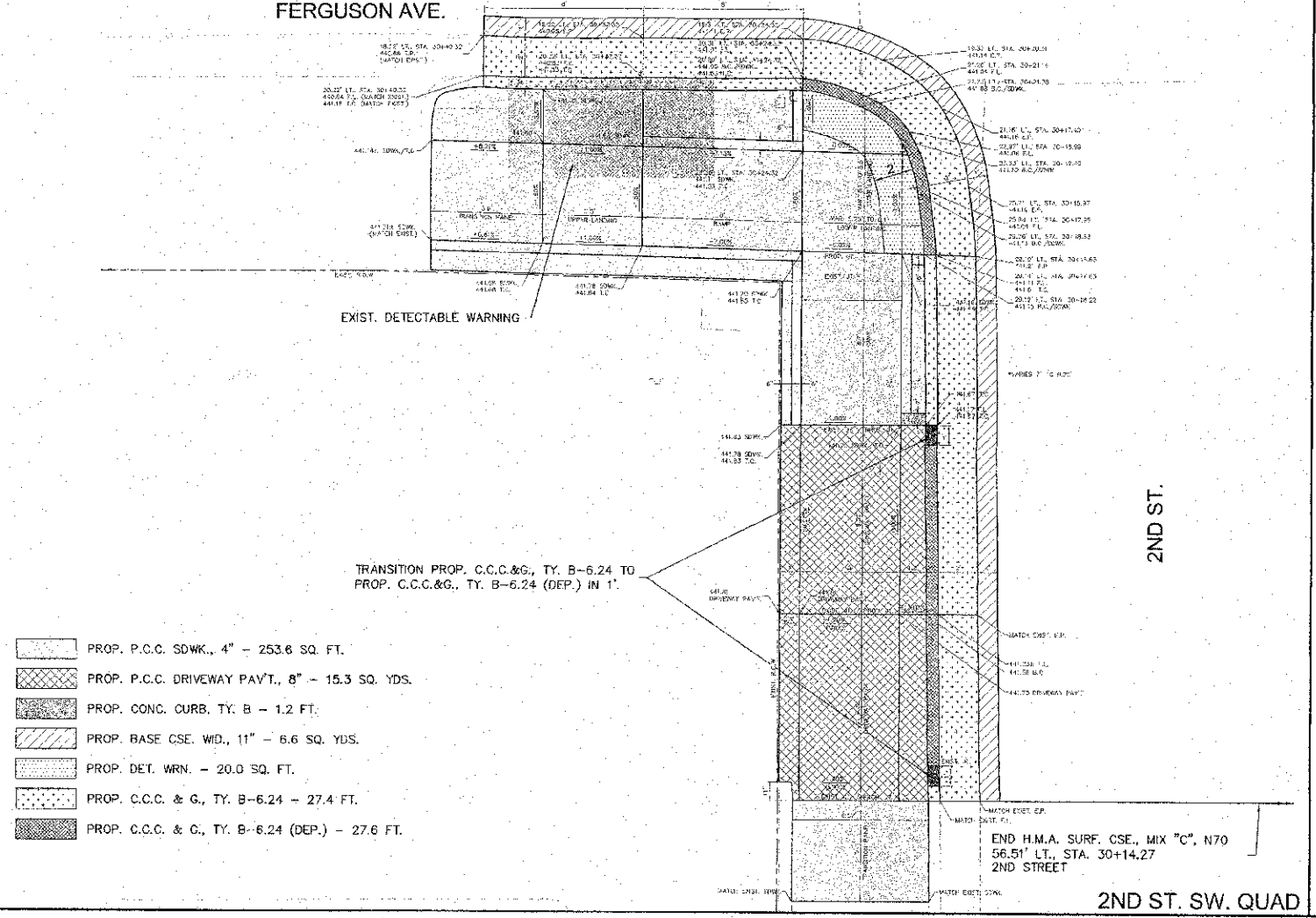

- PROP. P.C.C. SDWK., 4" - 253.6 SQ. FT.
- PROP. P.C.C. DRIVEWAY PAVT., 8" - 15.3 SQ. YDS.
- PROP. CONC. CURB, TY. B - 1.2 FT.
- PROP. BASE CSE. WD., 11" - 6.6 SQ. YDS.
- PROP. DET. WRN. - 20.0 SQ. FT.
- PROP. C.C.C. & G., TY. B-6.24 - 27.4 FT.
- PROP. C.C.C. & G., TY. B-6.24 (DEP.) - 27.6 FT.

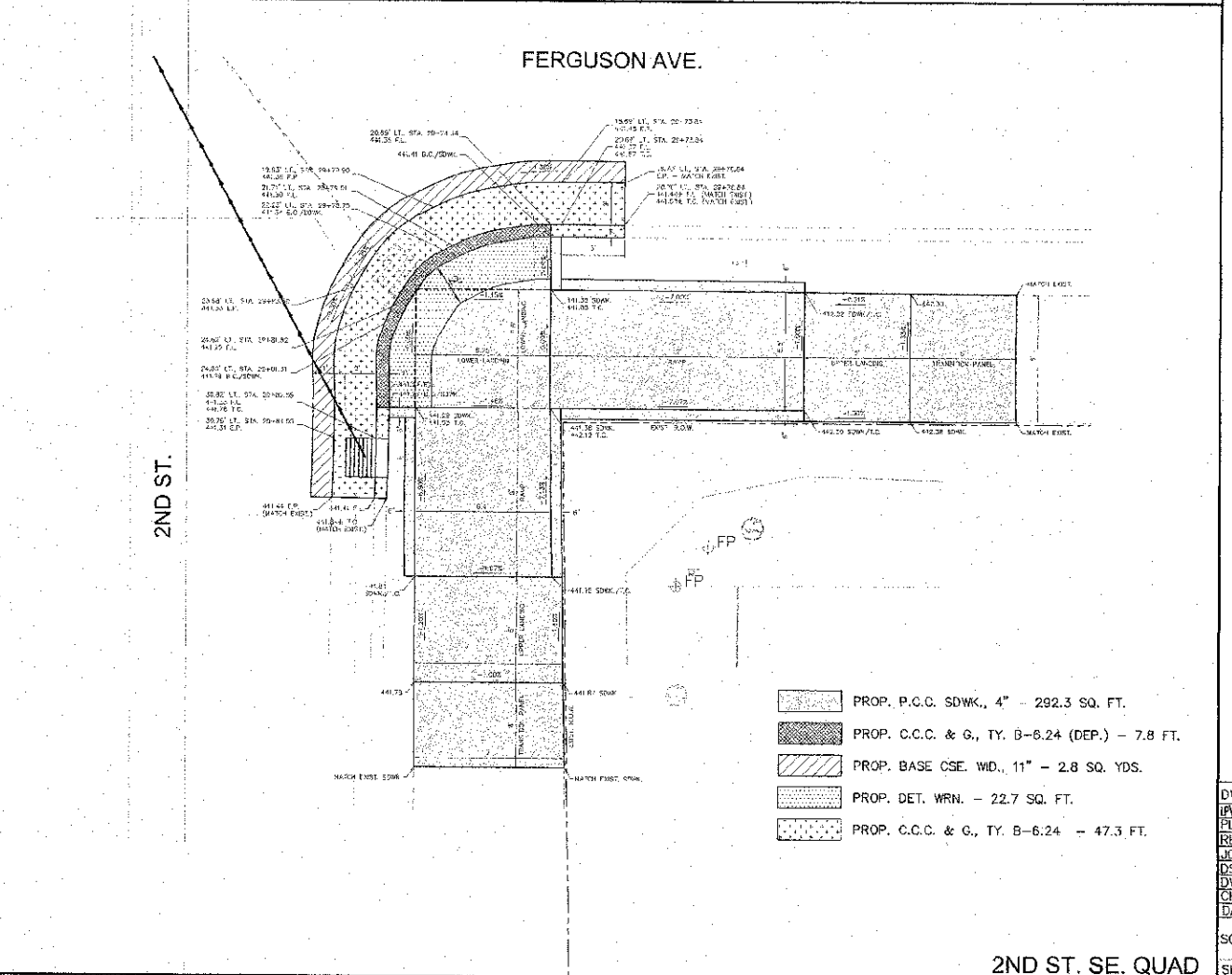

- PROP. P.C.C. SDWK., 4" - 292.3 SQ. FT.
- PROP. C.C.C. & G., TY. B-6.24 (DEP.) - 7.8 FT.
- PROP. BASE CSE. WD., 11" - 2.8 SQ. YDS.
- PROP. DET. WRN. - 22.7 SQ. FT.
- PROP. C.C.C. & G., TY. B-6.24 - 47.3 FT.

DESIGNER

SMS ENGINEERS

Sheppard, Morgan & Schwaab, Inc.
CONSULTING ENGINEERS AND LAND SURVEYORS
215 Market Street, P.O. Box E, Alton, IL 62602 618-462-9795 E-mail: mail@smsengineers.com
10 Central Expressway, Driv. Suite 3, Geneva, NY 14456 618-667-5700 E-mail: mail@smsengineers.com
DESIGNER: TMM # 184-1037692

CITY OF WOOD RIVER, ILLINOIS
FERGUSON AVENUE RESURFACING
SECTION 10-00047-02-RS
PLAN

DWG. NO.	PLAN FERGUSON 2ND.DWG
REF. BK.	PG.
DRAWN BY:	LDA
CHK. BY:	LDA
DATE:	APRIL, 2013

S:\Land Projects\WOOD RIVER PS HB8064\FERGUSON HC RAMP\dwg\PLAN FERGUSON 7ND.dwg 4/15/2013 8:25:21 AM jlrn 1/4