

SCALE IN FEET

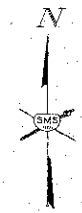

F.A.U. RITE	SECTION	COUNTY	TOTAL SHEETS	SHEET NO.
B971	10-00047-02-RS	MADISON	45	28

CONTRACT NO. 97526

REVISIONS

SMS Sheppard, Morgan & Schwaab, Inc.
 CONSULTING ENGINEERS AND LAND SURVEYORS
 216 Market Street, P.O. Box E, Alton, IL 62002, 618462-5755 E-mail: mail@smseng.com
 10 Central Industrial Circle, Suite 3, Granite City, IL 62040 618977-9200 E-mail: mail@smseng.com
 DESIGN FIRM # 184-000992

CITY OF WOOD RIVER, ILLINOIS
 FERGUSON AVENUE RESURFACING
 SECTION 10-00047-02-RS
 INTERSECTION DETAILS

4TH ST.

FERGUSON AVE.

4TH ST. NE. QUAD

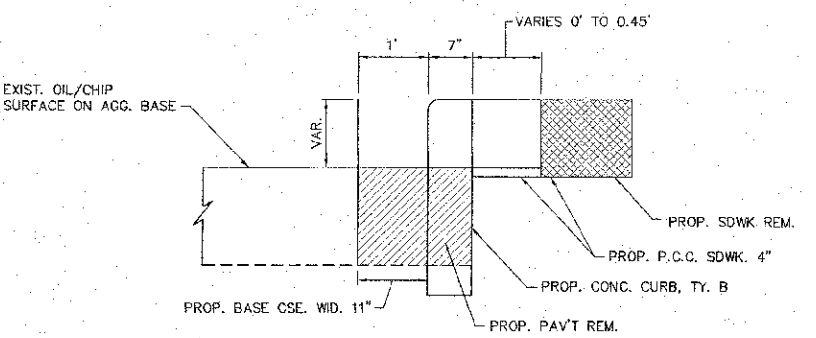
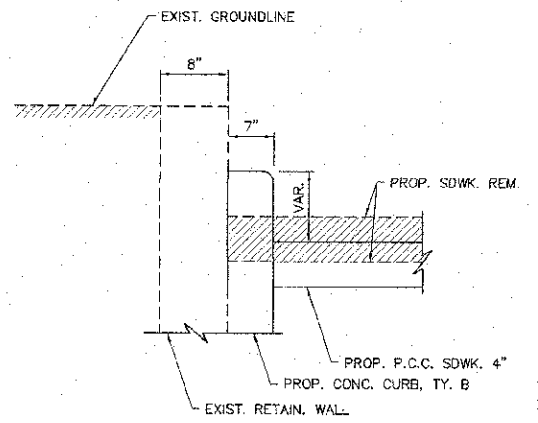
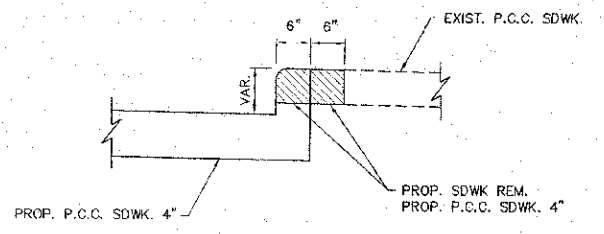
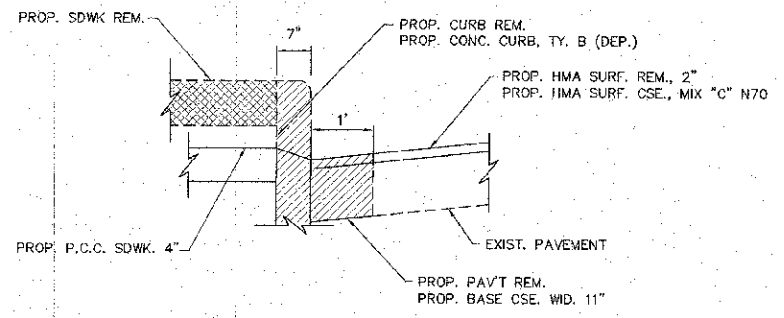
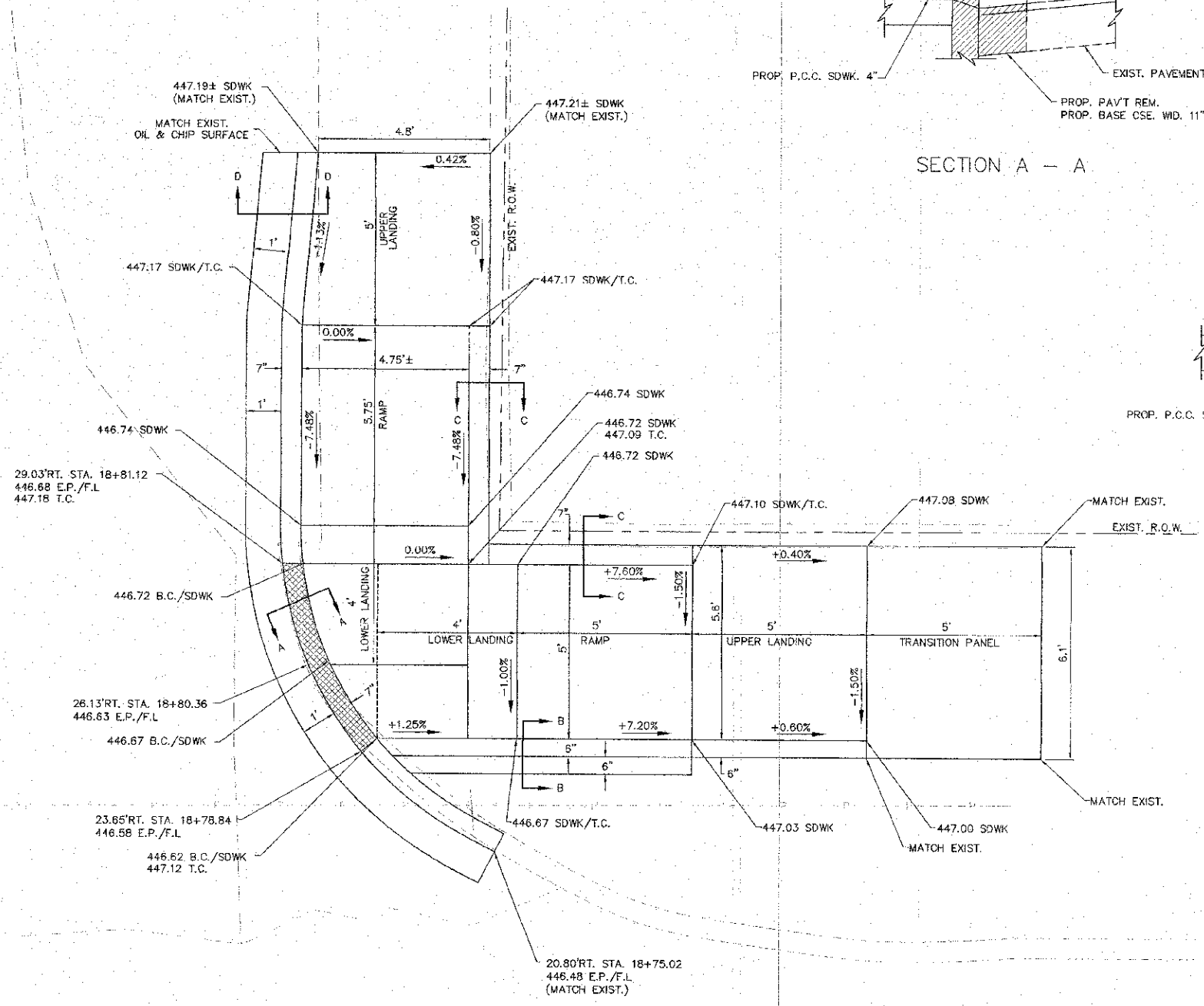

NOTE:
 IF THE FOOTING OF THE RETAINING WALL IS ENCOUNTERED PRIOR TO OBTAINING THE NECESSARY DEPTH FOR THE PROP. CONC. CURB, THEN EXCAVATION SHALL CEASE AND THE ENGINEER CONTACTED.

SEE PLAN SHEET FOR LOCATION OF DETECTABLE WARNING

DWG. NO.	10-00047-02-RS
DATE	APRIL, 2013
SCALE	NOT TO SCALE
SHEET	28 OF 45

S:\land Projects\WOOD RIVER PS (488044)\FERGUSON 4TH.dwg - 4/15/2013 11:35:03 AM, jman, 12