

K:\Moline\1301402\Draw Sheets

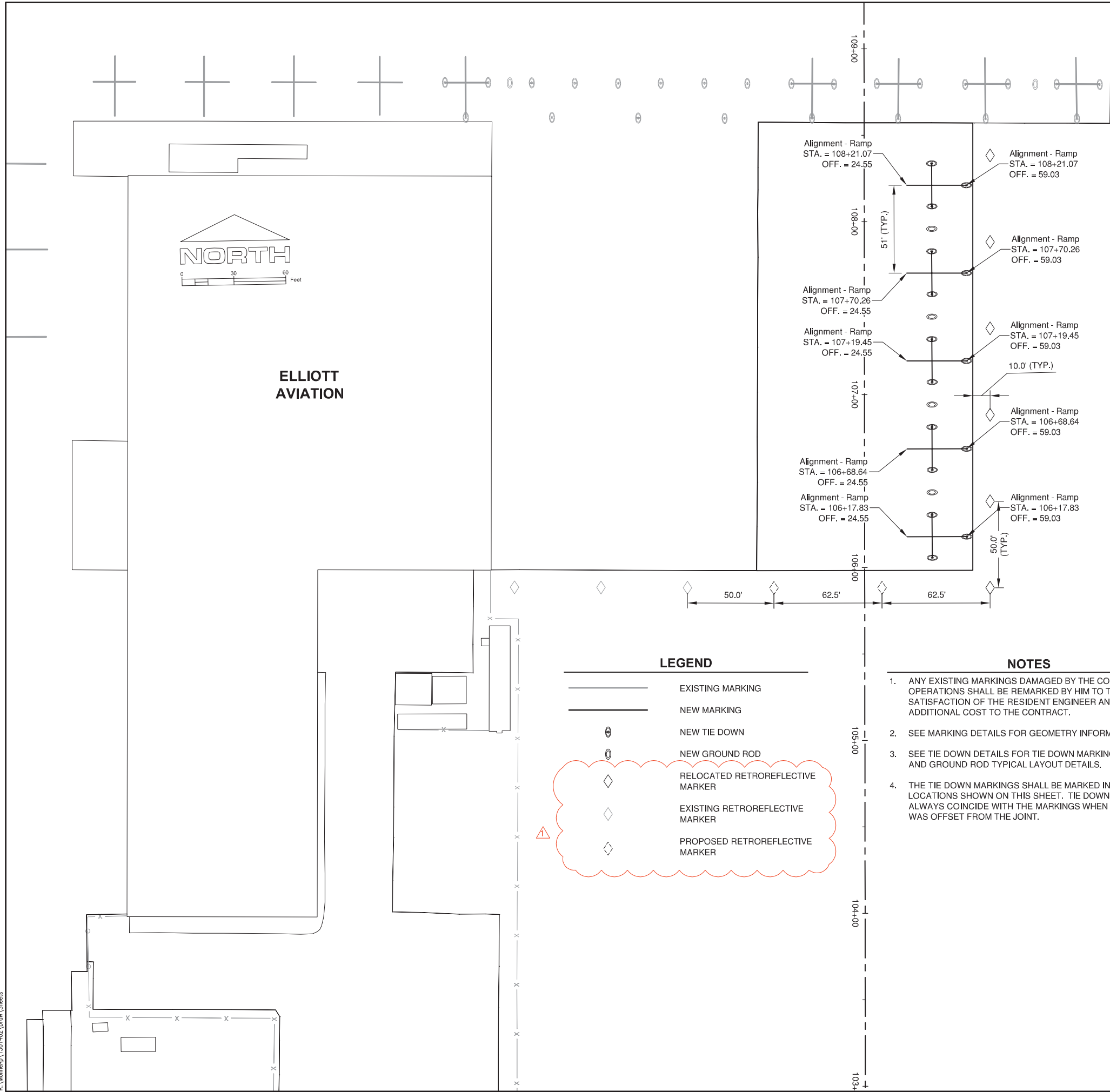

LEGEND

- EXISTING MARKING
- NEW MARKING
- NEW TIE DOWN
- NEW GROUND ROD
- RELOCATED RETROREFLECTIVE MARKER
- EXISTING RETROREFLECTIVE MARKER
- PROPOSED RETROREFLECTIVE MARKER

- NOTES**
- ANY EXISTING MARKINGS DAMAGED BY THE CONTRACTOR'S OPERATIONS SHALL BE REMARKED BY HIM TO THE SATISFACTION OF THE RESIDENT ENGINEER AND AT NO ADDITIONAL COST TO THE CONTRACT.
 - SEE MARKING DETAILS FOR GEOMETRY INFORMATION.
 - SEE TIE DOWN DETAILS FOR TIE DOWN MARKING, TIE DOWN, AND GROUND ROD TYPICAL LAYOUT DETAILS.
 - THE TIE DOWN MARKINGS SHALL BE MARKED IN THE LOCATIONS SHOWN ON THIS SHEET. TIE DOWNS MAY NOT ALWAYS COINCIDE WITH THE MARKINGS WHEN A TIE DOWN WAS OFFSET FROM THE JOINT.

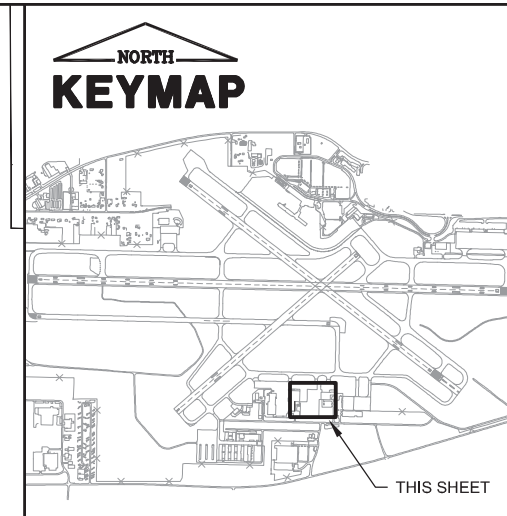

FILE: 17A MARKING PLAN.dwg
 UPDATE BY: Andrew Bodine
 PLOT DATE: 6/11/2013 2:12 PM

quad-plan
 BASE PROP GEO
 Keymap

QU017

REVISIONS		
NUMBER	BY	DATE
1	AJB	6/11/13

0 1 2
 THIS BAR IS EQUAL TO 2" AT FULL SCALE (34X22).

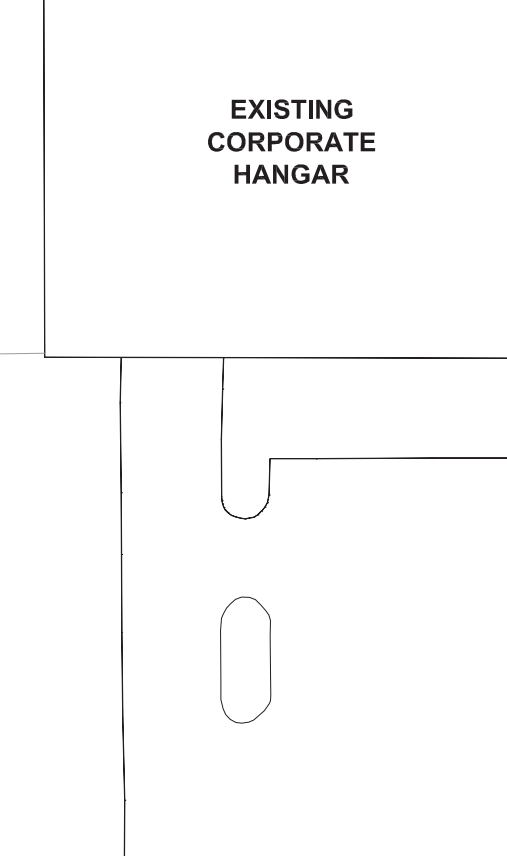

**METROPOLITAN AIRPORT AUTHORITY OF ROCK ISLAND
 QUAD CITY INTERNATIONAL AIRPORT
 MOLINE, ILLINOIS**

**SOUTH GA RAMP EXPANSION - PHASE 1
 MARKING PLAN**

© Copyright CMT, Inc.

CMT
 CRAWFORD, MURPHY & TILLY, INC.
 CONSULTING ENGINEERS
 License No. 184-000613

QUAD CITY INTERNATIONAL AIRPORT

DESIGN BY: AJB
 DRAWN BY: CMT
 CHECKED BY: CET
 APPROVED BY: CET
 DATE: APRIL 19, 2013
 JOB No: 13014-02-00

IL. PROJ. NO. MLI-4275

SHEET 17A OF 22 SHEETS