

INDEX OF SHEETS

06-14-2019 LETTING ITEM 070

- 1. COVER SHEET
- 2. GENERAL NOTES
- 3-4. SUMMARY OF QUANTITIES
- 5. TYPICAL SECTIONS
- 6. SCHEDULES
- 7. LAYOUT MAP
- 8-9. DETAILS

STATE OF ILLINOIS
DEPARTMENT OF TRANSPORTATION

**PROPOSED
HIGHWAY PLANS**

FAP ROUTE 326 (IL 47)
SECTION (125) I - 1

CENTERLINE REPAIR (MILL & FILL)
LIVINGSTON COUNTY

C-93-093-19

F.A.P. RTE.	SECTION	COUNTY	TOTAL SHEETS	SHEET NO.
326	(125) I - 1	LIVINGSTON	9	1
		BLMWS	CONTRACT NO. 66K09	

LIST OF ILLINOIS DOT HIGHWAY STANDARDS

000001-07	STANDARD SYMBOLS, ABBREVIATIONS AND PATTERNS
001006	DECIMAL OF AN INCH AND OF A FOOT
701001-02	OFF-ROAD OPERATIONS 2L, 2W, MORE THAN 15' (4.5 m) AWAY
701006-05	OFF-ROAD OPERATIONS 2L, 2W, 15' (4.5 m) TO 24' (600 mm) FROM PAVEMENT EDGE
701306-04	LANE CLOSURE, 2L, 2W, SLOW MOVING OPERATIONS DAY ONLY, FOR SPEEDS ≥ 45 MPH
701311-03	LANE CLOSURE, 2L, 2W, MOVING OPERATIONS - DAY ONLY
701901-08	TRAFFIC CONTROL DEVICES

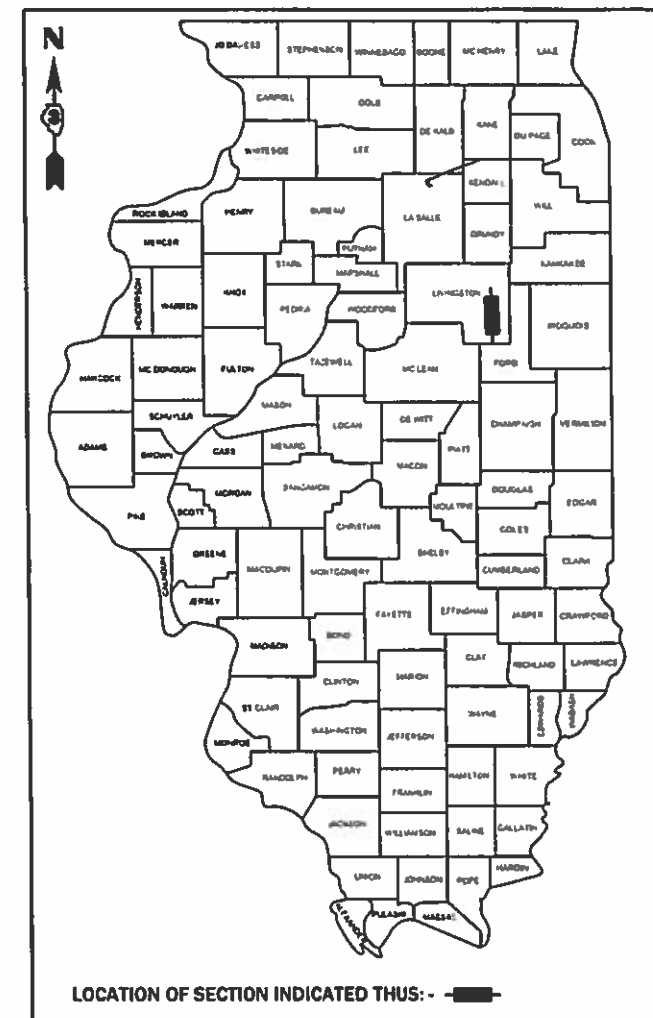

BEGIN IMPROVEMENT
STA 1646+00

BRIDGE OMISSION
SN 053-0169
STA 1745+53 TO STA 1747+04

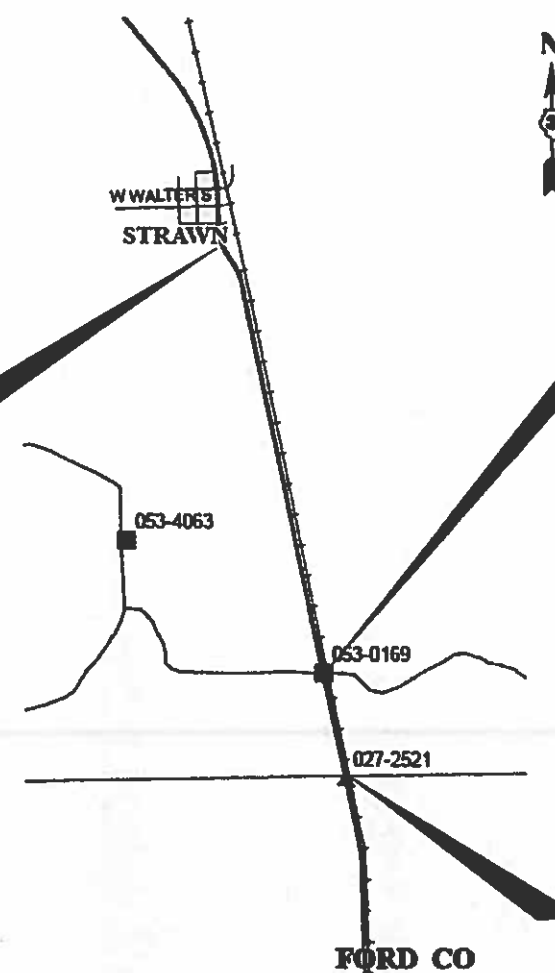

END IMPROVEMENT
STA 1769+40

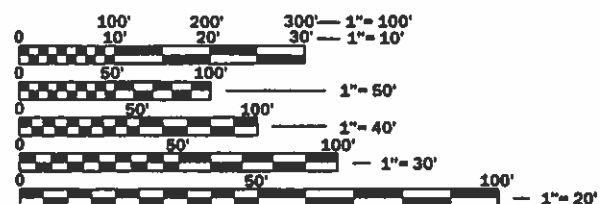

FULL SIZE PLANS HAVE BEEN PREPARED USING STANDARD ENGINEERING SCALES. REDUCED SIZED PLANS WILL NOT CONFORM TO STANDARD SCALES. IN MAKING MEASUREMENTS ON REDUCED PLANS, THE ABOVE SCALES MAY BE USED.

J.U.L.I.E.
JOINT UTILITY LOCATION INFORMATION FOR EXCAVATION
1-800-892-0123
OR 811

PROJECT ENGINEER: JOE KANNEL, P.E.
UNIT CHIEF: MICHELE LINDEMANN, P.E.
DISTRICT 3 NO. (815) 434-6131
CONTRACT NO. 66K09

GROSS LENGTH = 12340 FT. = 2.337 MILE
NET LENGTH = 12189 FT. = 2.309 MILE

FUNCTIONAL CLASSIFICATION
RURAL
MAJOR COLLECTOR
F.A.P. ROUTE 326 (IL 47)
2017 ADT = 2800
P.V. 64.11% S.U. 6.43% M.U. 29.46%

STATE OF ILLINOIS
DEPARTMENT OF TRANSPORTATION

SUBMITTED 3/29 2019
Mark
REGIONAL ENGINEER

May 10 2019
oc *E.A. Elk*
ENGINEER OF DESIGN AND ENVIRONMENT

May 10 2019
David P. Chif
DIRECTOR OF HIGHWAYS PROJECT IMPLEMENTATION

PRINTED BY THE AUTHORITY
OF THE STATE OF ILLINOIS

GENERAL NOTES

THE THICKNESS OF HMA SHOWN ON THE PLANS IS THE NOMINAL THICKNESS. DEVIATIONS FROM THE NOMINAL THICKNESS WILL BE PERMITTED WHEN SUCH DEVIATIONS OCCUR DUE TO IRREGULARITIES IN THE EXISTING SURFACE OR BASE ON WHICH THE HMA IS PLACED.

FOR STABILIZATION, ALL TYPE III BARRICADES WILL REQUIRE A MINIMUM OF FOUR SAND BAGS PER BARRICADE.

ALL EXCAVATED MATERIAL, WHICH INCLUDES DIGGING OR GRADING OF ANY SOIL OR FILL MATERIAL, WITH THE EXCEPTION OF AGGREGATE FILLS, MUST BE INCORPORATED WITHIN THE IDOT RIGHT OF WAY DUE TO ENVIRONMENTAL DOCUMENTATION REQUIREMENTS.

ON EXISTING PAVEMENT WHICH MAY BE SUPERELEVATED, THE NEW HMA PAVEMENT SHALL BE BUILT WITH THE SAME SUPERELEVATION UNLESS NEW SUPERELEVATION RATES ARE GIVEN ON THE PLANS.

ANY REFERENCE TO A STANDARD IN THESE PLANS SHALL BE INTERPRETED TO MEAN THE EDITION AS INDICATED BY THE SUBNUMBER SHOWN IN THE LIST OF STANDARDS OR THE COPY INCLUDED IN THESE PLANS.

THE CONTRACTOR SHALL CONTACT JULIE AT LEAST 48 HOURS PRIOR TO EXCAVATION TO DETERMINE WHICH UTILITIES ARE IN THE AREA.

COMMITMENTS

HMA MIXTURE REQUIREMENT TABLE	
LOCATION(S):	ENTIRE PROJECT
MIXTURE USE(S):	HMA SURFACE
BINDER GRADE (PG):	PG64-22
DESIGN AIR VOIDS:	4.0% @ N50
MIXTURE COMPOSITION: (MIXTURE GRADATION)	IL 9.5
FRICTION AGGREGATE:	MIXTURE C
MIXTURE WEIGHT:	112.0 LB/SY/IN
QUALITY MANAGEMENT PROGRAM:	QCQA
SUBLOT SIZE:	N/A
DENSITY TEST METHOD:	CORES/NUCLEAR

STATE OF ILLINOIS
DEPARTMENT OF TRANSPORTATION
DISTRICT THREE
AS BUILT INFORMATION

SUPERVISING CONSTRUCTION FIELD ENGINEER

RESIDENT ENGINEER / TECHNICIAN

START & END DATES
OF CONSTRUCTION:

INSPECTORS:

STATE OF ILLINOIS
DEPARTMENT OF TRANSPORTATION
DISTRICT THREE

PREPARED BY: *Don Benoit*
DISTRICT STUDIES & PLANS ENGINEER

DATE: 3/29/19

EXAMINED BY: *[Signature]*
DISTRICT CONSTRUCTION ENGINEER

Michael [Signature]
DISTRICT MATERIALS ENGINEER

Tom [Signature]
DISTRICT OPERATIONS ENGINEER

FILE NAME =	USER NAME = corcoranlm	DESIGNED - EVAN MARINI	REVISED -
c:\pw_work\pwidofcorcoranlm\060646266K09-cover.dwg		DRAWN - EVAN MARINI	REVISED -
		CHECKED - RON WOODSHANK	REVISED -
SMODELNAMES		PLOT DATE = 3/27/2019	DATE - 1/22/2019

STATE OF ILLINOIS
DEPARTMENT OF TRANSPORTATION

GENERAL NOTES

SCALE: SHEET 1 OF 1 SHEETS STA. TO STA.

F.A.P. RTE:	SECTION	COUNTY	TOTAL SHEETS	SHEET NO.
326	(125)1-1	LIVINGSTON	9	2
CONTRACT NO. 66K09				
ILLINOIS FED. AID PROJECT				

CONSTR. CODE

100% STATE

ROADWAY

0005

RURAL

CODE NO.	ITEM	UNIT	TOTAL QUANTITY	
40600290	BITUMINOUS MATERIALS (TACK COAT)	POUND	1219	1219
40600400	MIXTURE FOR CRACKS, JOINTS, AND FLANGEWAYS	TON	0.8	0.8
67100100	MOBILIZATION	L SUM	1	1
70100460	TRAFFIC CONTROL AND PROTECTION, STANDARD 701306	L SUM	1	1
70107025	CHANGEABLE MESSAGE SIGN	CAL DA	90	90
70300100	SHORT TERM PAVEMENT MARKING	FOOT	1234	1234
70300150	SHORT TERM PAVEMENT MARKING REMOVAL	SQ FT	411	411
70300240	TEMPORARY PAVEMENT MARKING - LINE 6"	FOOT	3085	3085
Δ 78001110	PAINT PAVEMENT MARKING - LINE 4"	FOOT	52516	52516
Δ 78001130	PAINT PAVEMENT MARKING - LINE 6"	FOOT	6170	6170
Δ 78100100	RAISED REFLECTIVE PAVEMENT MARKER	EACH	155	155
78300200	RAISED REFLECTIVE PAVEMENT MARKER REMOVAL	EACH	155	155
X0327980	PAVEMENT MARKING REMOVAL - WATER BLASTING	SQ FT	1543	1543
X4405020	LONGITUDINAL PARTIAL DEPTH REMOVAL 2"	FOOT	12189	12189

Δ SPECIALTY ITEM

FILE NAME =	USER NAME = corcoranlm	DESIGNED - EVAN MARINI	REVISED -
pw:\planroom\dot\illinois.gov\PWIDOT\Documents\IDOT	Files\District 3\Projects\0366K09\CADData\66K09-cover.dgn	DRAWN - EVAN MARINI	REVISED -
Default	PLOT SCALE = 100,0000' / in.	CHECKED - RON WOODSHANK	REVISED -
	PLOT DATE = 3/27/2019	DATE - 1/22/2019	REVISED -

**STATE OF ILLINOIS
DEPARTMENT OF TRANSPORTATION**

SUMMARY OF QUANTITIES

SCALE: SHEET 1 OF 2 SHEETS STA. TO STA.

F.A.P. RTE.	SECTION	COUNTY	TOTAL SHEETS	SHEET NO.
326	(125) I-1	LIVINGSTON	9	3
CONTRACT NO. 66K09			ILLINOIS FED. AID PROJECT	

CODE NO.	ITEM	UNIT	TOTAL QUANTITY	CONSTR. CODE	
				100% STATE	
				ROADWAY	RURAL
				0005	
X4420900	LONGITUDINAL PARTIAL DEPTH PATCHING	TON	304		304

Δ SPECIALTY ITEM

FILE NAME =	USER NAME = corcoranlm	DESIGNED - EVAN MARINI	REVISED -	STATE OF ILLINOIS DEPARTMENT OF TRANSPORTATION	SUMMARY OF QUANTITIES				F.A.P. RTE.	SECTION	COUNTY	TOTAL SHEETS	SHEET NO.
p:\planroom\dot\illinois.gov\PWIDOT\Documents\IDOT\Files\District 3\Projects\I366K09\CADData\66K09-cover.dgn	DRAWN - EVAN MARINI	REVISIED -							326	(125) I-1	LIVINGSTON	9	4
Default	PLOT SCALE = 100,0000' / in.	CHECKED - RON WOODSHANK	REVISED -		CONTRACT NO. 66K09								
	PLOT DATE = 3/27/2019	DATE - 1/22/2019	REVISED -		SCALE:	SHEET 2	OF 2	SHEETS	STA.	TO STA.	ILLINOIS	FED. AID PROJECT	

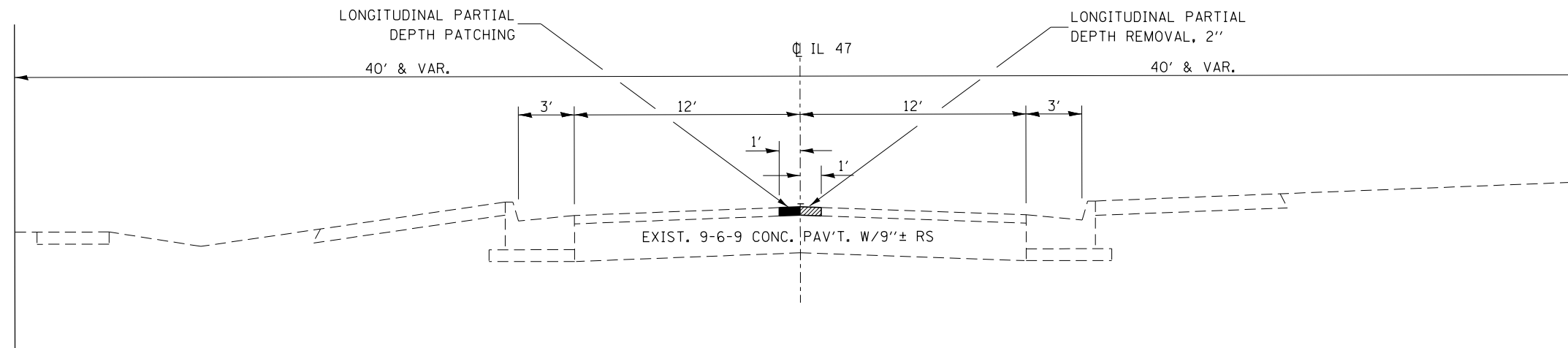

PROPOSED TYPICAL SECTION – IL 47

STA 1646+00 TO STA 1646+25

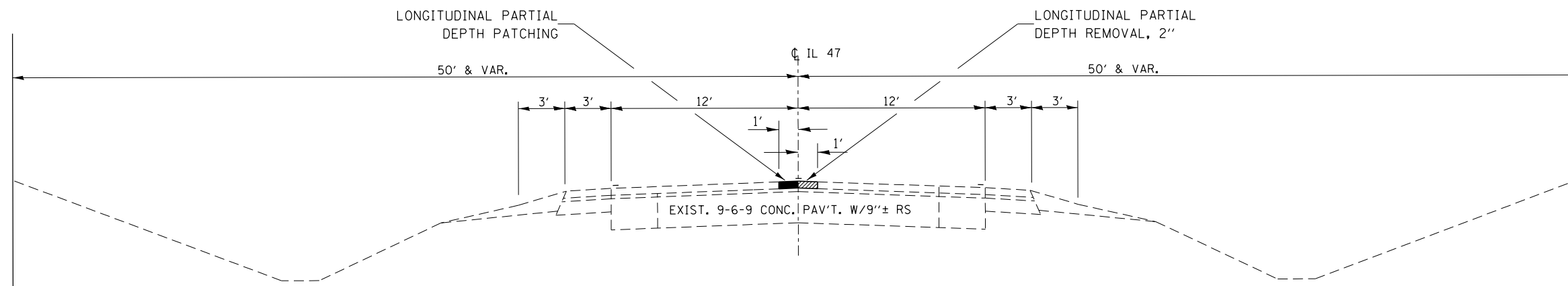

PROPOSED TYPICAL SECTION – IL 47

STA 1646+25 TO STA 1745+53
 STA 1747+04 TO STA 1769+40

OMISSION
 SN 053-0169 STA 1745+53 TO STA 1747+04

FILE NAME =	USER NAME = corcoranlm	DESIGNED - EVAN MARINI	REVISED -	STATE OF ILLINOIS DEPARTMENT OF TRANSPORTATION	TYPICAL SECTIONS			F.A.P. RTE.	SECTION	COUNTY	TOTAL SHEETS	SHEET NO.
pwc:\planroom.dot\illinois.gov\PWIDOT\Documents\IDOT	Office\District 3\Projects\0366K09\CADData\66K09-cover.dgn	DRAWN - EVAN MARINI	REVISED -		326	(125) I-1	LIVINGSTON	9	5			
Default	PLOT SCALE = 100.0000' / in.	CHECKED - RON WOODSHANK	REVISED -		CONTRACT NO. 66K09							
	PLOT DATE = 3/27/2019	DATE - 1/22/2019	REVISED -		SCALE:	SHEET 1	OF 1	SHEETS	STA.	TO STA.	ILLINOIS	FED. AID PROJECT

MAINLINE SCHEDULE					
LOCATION	LENGTH	LONGITUDINAL PARTIAL DEPTH REMOVAL 2"	LONGITUDINAL PARTIAL DEPTH PATCHING	BIT MAT (TACK COAT)	MIX FOR CRACKS, JTS & FLGWYS
STA TO STA	FOOT	FOOT	TON	POUNDS	TON
STA 1646+00 TO STA 1745+53	9953	9953	248	995	0.7
STA 1747+04 TO STA 1769+40	2236	2236	56	224	0.1
TOTALS	12189	12189	304	1219	0.8

PAVEMENT MARKING								
LOCATION	LENGTH	PAINT PAVEMENT MARKING			SHORT TERM PVMT MARK	SHORT TERM PVMT MARK REM	RAISED REFLECTIVE PVMT MARK REMOVAL	RAISED REFLECTIVE PAVEMENT MARKERS
		4 INCH		6 INCH				
		YELLOW	WHITE	YELLOW				
STA	FOOT	FOOT	FOOT	FOOT	SQ FT	EACH	EACH	
1646+00 TO 1769+40	12340	3156	49360	6170	1234	411	155	155
TOTALS	12340	52516		6170	1234	411	155	155

NOTE: THE FOLLOWING NO PASSING ZONES SHOULD BE FIELD VERIFIED BY THE ENGINEER PRIOR TO MILLING AND RESURFACING
 NB - STA 1732+83 TO STA 1740+28
 SB - STA 1723+49 TO STA 1731+82

NOTE: ADDITIONAL QUANTITY HAS BEEN INCLUDED TO ALLOW FOR TWO SEPARATE APPLICATIONS OF PAINT PAVEMENT MARKING LINE

TEMPORARY PAVEMENT MARKING			
LOCATION	LENGTH	TEMP PVMT MARK	PAVEMENT MARK REM WATER BLASTING
		6 INCH	
		YELLOW	
STA TO STA	FOOT	FOOT	SQ FT
1646+00 TO 1769+40	12340	3085	1543
TOTALS	12340	3085	1543

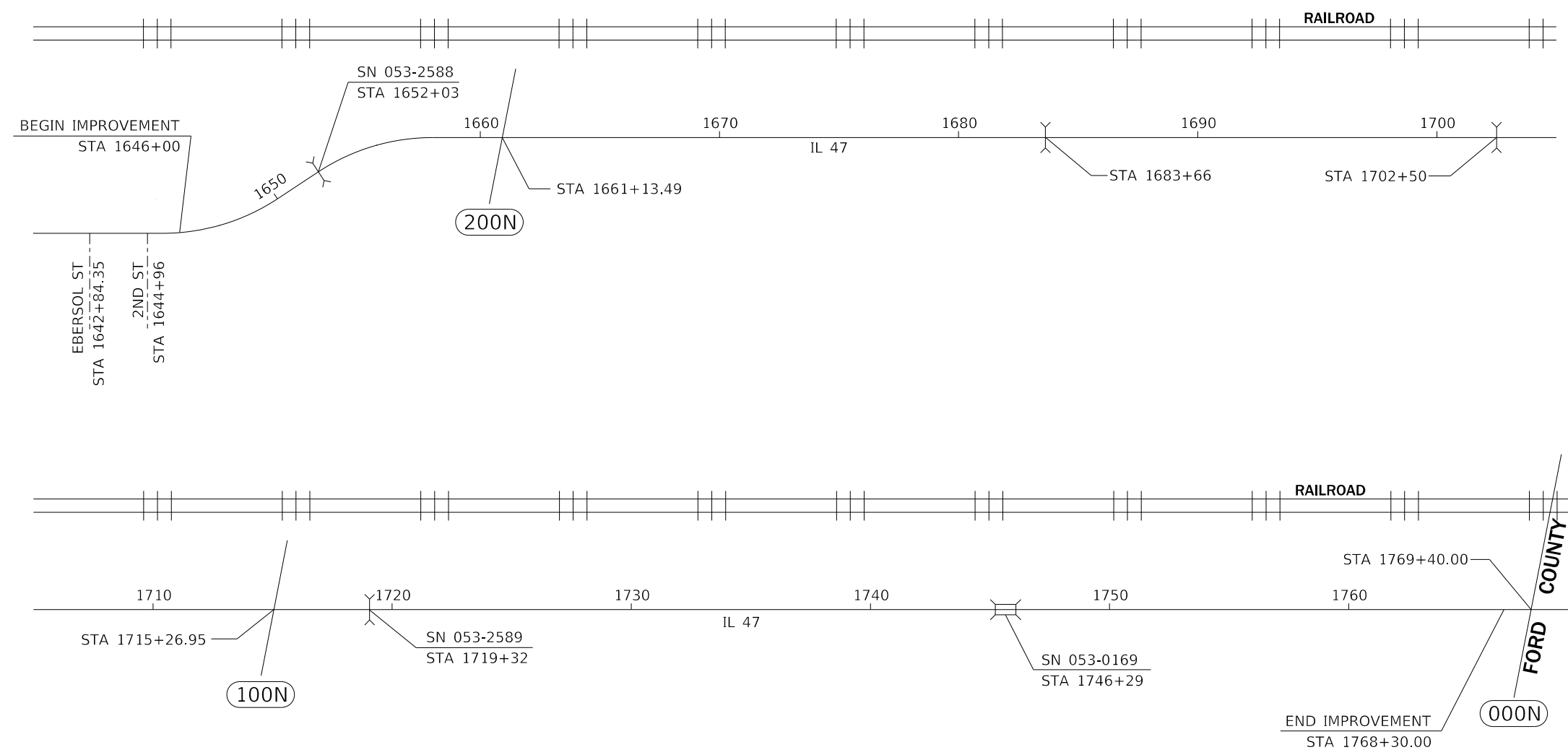
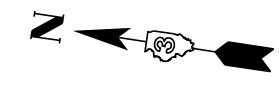

GPS NUMBER	DESCRIPTION	EXISTING MONUMENT TYPE	PROPOSED MONUMENT TYPE	MONUMENT RECORD TO BE RECORDED	RESPONSIBILITY
N/A	NO PERMANENT SURVEY MARKERS OR SECTION CORNER MARKERS TO BE SET ON THIS JOB	N/A	N/A	N/A	N/A

NO KNOWN SURVEY OR CENTERLINE CONTROL MONUMENTS ARE IN A LOCATION THAT WILL BE DISTURBED BY THE CENTERLINE JOINT MILLING AND RESURFACING. IF A MONUMENT IS FOUND THAT WILL BE REMOVED DUE TO THIS WORK, THE R.E. WILL INFORM THE PLATS AND PLANS SECTION OF THE LOCATION, AND THE PLATS AND PLANS SECTION WILL SET AND TIE A SUITABLE REPLACEMENT MONUMENT AFTER RESURFACING IS COMPLETED. NO MONUMENT RECORDS ARE ANTICIPATED FOR THIS JOB.

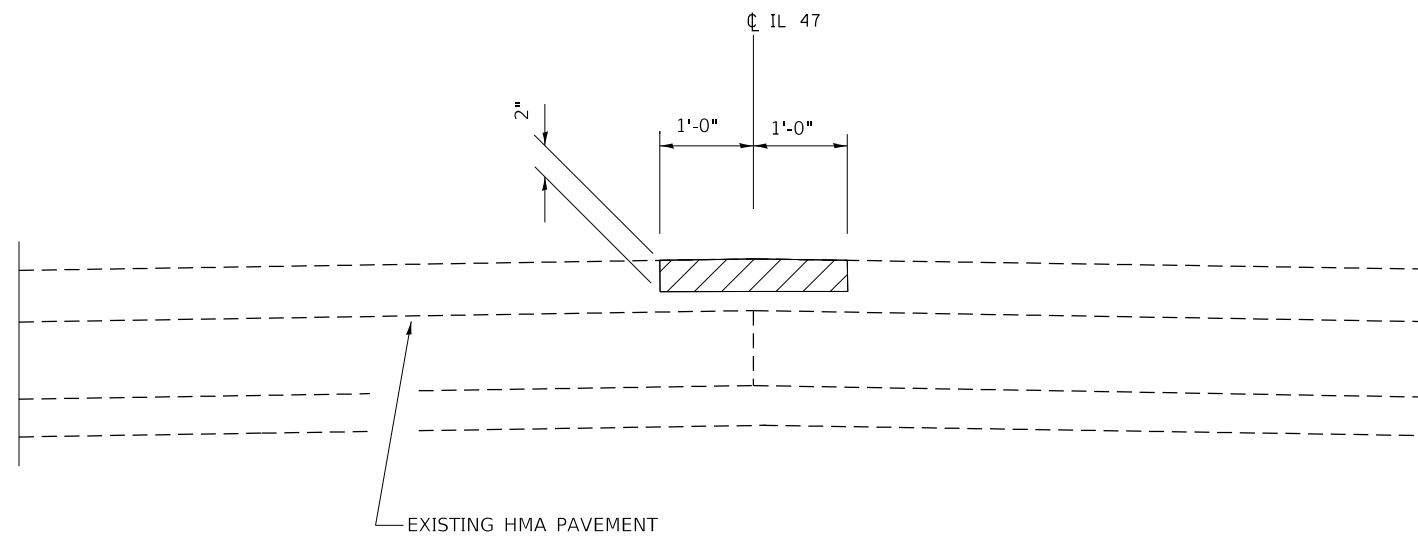

LONGITUDINAL PARTIAL DEPTH REMOVAL



LONGITUDINAL PARTIAL DEPTH PATCHING

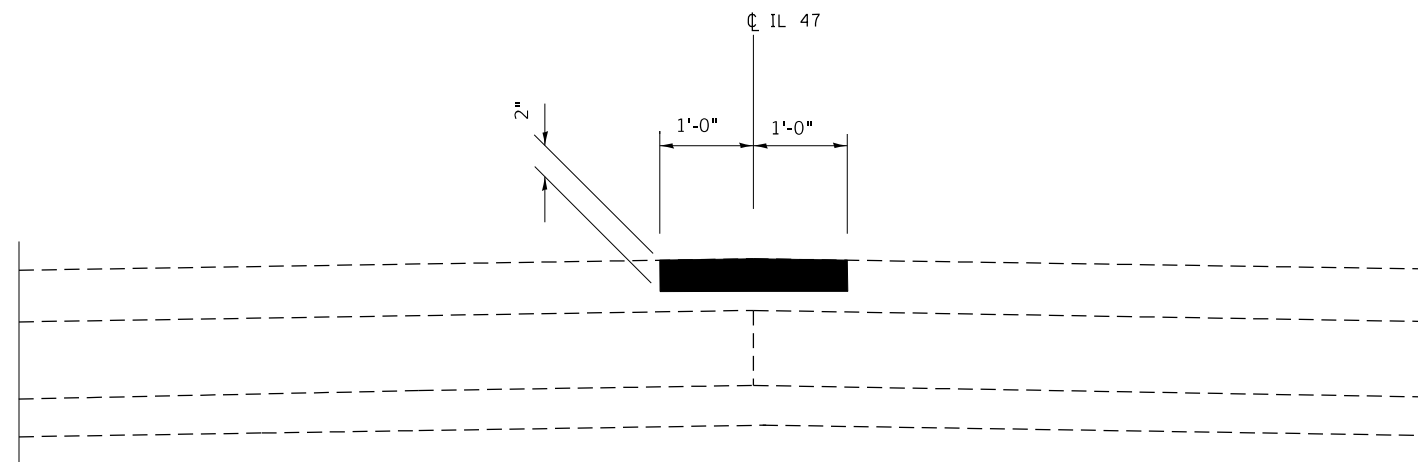

FILE NAME =	USER NAME = corcoranlm	DESIGNED - EVAN MARINI	REVISED -
pw:\planroom\dot\illinois.gov\PWIDOT\Documents\IDOT\Files\District 3\Projects\D366K09\CADData\66K09-cover.dgn		DRAWN - EVAN MARINI	REVISED -
Default	PLOT SCALE = 100,0000' / in.	CHECKED - RON WOODSHANK	REVISED -
	PLOT DATE = 3/27/2019	DATE - 1/22/2019	REVISED -

**STATE OF ILLINOIS
DEPARTMENT OF TRANSPORTATION**

DETAILS

SCALE: SHEET 1 OF 2 SHEETS STA. TO STA.

F.A.P. RTE.	SECTION	COUNTY	TOTAL SHEETS	SHEET NO.
326	(125) I-1	LIVINGSTON	9	8
			CONTRACT NO. 66K09	
		ILLINOIS FED. AID PROJECT		

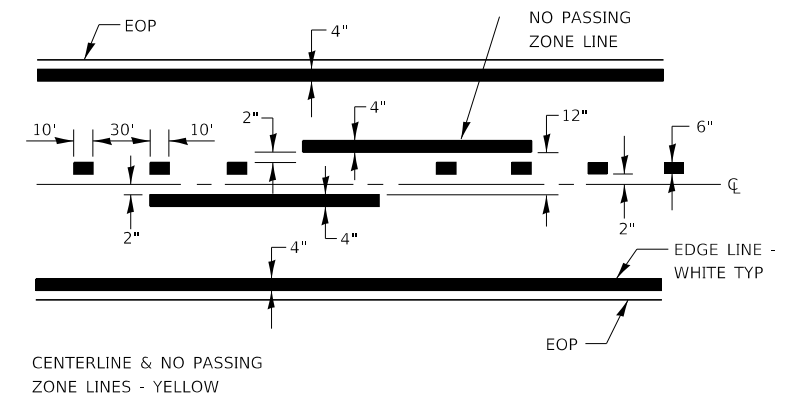

PAVEMENT MARKING

FILE NAME =	USER NAME = corcoranlm	DESIGNED - EVAN MARINI	REVISED -	STATE OF ILLINOIS DEPARTMENT OF TRANSPORTATION	DETAILS			F.A.P. RTE.	SECTION	COUNTY	TOTAL SHEETS	SHEET NO.
pw:\planroom.dot\illinois.gov\PWIDOT\Documents\IDOT\Files\District 3\Projects\66K09\CADData\66K09-cover.dgn	DRAWN - EVAN MARINI	REVISED -	326					(125) I-1	LIVINGSTON	9	9	
Default	PLOT SCALE = 100,0000' / in.	CHECKED - RON WOODSHANK	REVISED -		CONTRACT NO. 66K09							
	PLOT DATE = 3/27/2019	DATE - 1/22/2019	REVISED -		SCALE:	SHEET 2	OF 2	SHEETS	STA.	TO STA.	ILLINOIS	FED. AID PROJECT