

F.A.P. RTE.	SECTION	COUNTY	TOTAL SHEETS	SHEET NO.
296	(0) SFY	GRUNDY	14	1
		ILLINOIS	CONTRACT NO. 66N62	

INDEX OF SHEETS

- 1 COVER SHEET
- 2 GENERAL NOTES
- 3-4 SUMMARY OF QUANTITIES
- 5-9 CONDUIT PLAN
- 10 CABLE PLAN
- 11 DETAILS
- 12-13 TRAFFIC CONTROL DETAILS
- 14 SOIL BORING LOGS

LIST OF ILLINOIS DOT HIGHWAY STANDARDS

- 000001-08 STANDARD SYMBOLS, ABBREVIATIONS AND PATTERNS
- 001006 DECIMAL OF AN INCH AND OF A FOOT
- 701001-02 OFF-ROAD OPERATIONS 2L, 2W, MORE THAN 15' AWAY
- 701006-05 OFF-ROAD OPERATIONS 2L, 2W, 15' TO 24" FROM PAVEMENT EDGE
- 701201-05 LANE CLOSURE, 2L, 2W, DAY ONLY, FOR SPEEDS ≥ 45 MPH
- 701901-09 TRAFFIC CONTROL DEVICES
- 720001-01 SIGN PANEL MOUNTING DETAILS
- 720006-04 SIGN PANEL ERECTION DETAILS
- 805001-01 ELECTRICAL SERVICE INSTALLATION DETAILS
- 814001-03 HANDHOLES
- 838001-01 BREAKAWAY DEVICES
- 862001-01 UNINTERRUPTABLE POWER SUPPLY (UPS)
- 873001-02 TRAFFIC SIGNAL GROUNDING & BONDING
- 878001-11 CONCRETE FOUNDATION DETAILS
- 880001-01 SPAN WIRE MOUNTED SIGNALS AND FLASHING BEACON INSTALLATION

STATE OF ILLINOIS
DEPARTMENT OF TRANSPORTATION

**PROPOSED
HIGHWAY PLANS**

**FAS ROUTE 296 (US 6)
SECTION (0)SFY
PROJECT HSIP-W12M(183)
FLASHING BEACONS INSTALLATION
GRUNDY COUNTY**

C-93-098-23

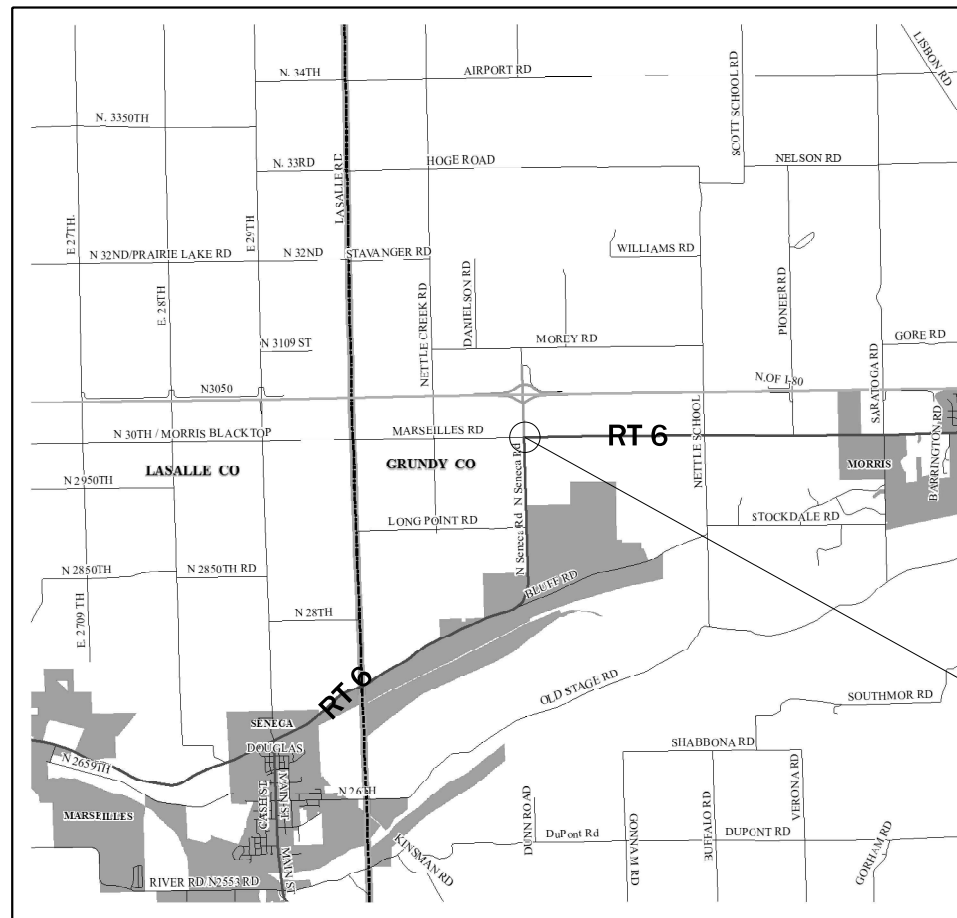

PROJECT LOCATION
US 6 & MARSEILLES RD

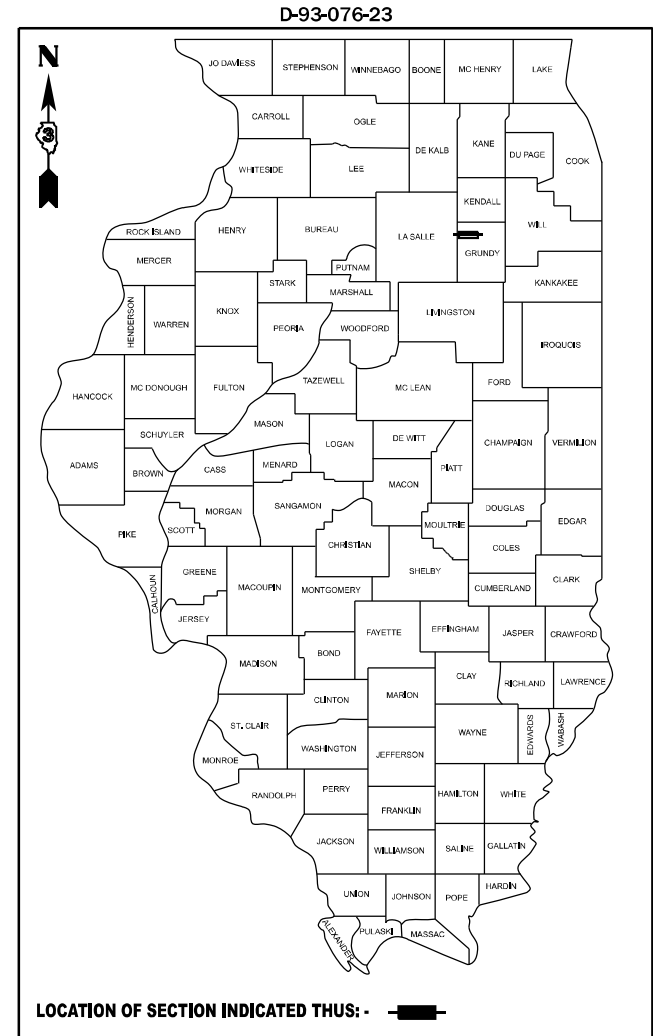

LOCATION OF SECTION INDICATED THIS: - [black rectangle] -

US 6 - MINOR ARTERIAL
2023 ADT = 3550
P.V. = 96.1% S.U. = 2.8% M.U. = 1.1%

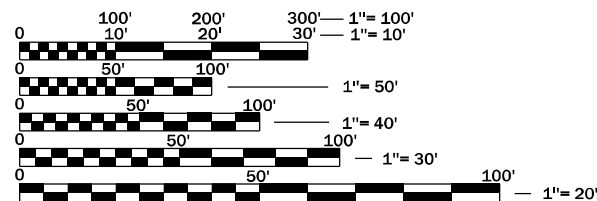

FULL SIZE PLANS HAVE BEEN PREPARED USING STANDARD ENGINEERING SCALES. REDUCED SIZED PLANS WILL NOT CONFORM TO STANDARD SCALES. IN MAKING MEASUREMENTS ON REDUCED PLANS, THE ABOVE SCALES MAY BE USED.

J.U.L.I.E.
JOINT UTILITY LOCATION INFORMATION FOR EXCAVATION
1-800-892-0123
OR 811

PROJECT ENGINEER: NICHOLAS SPENCE, P.E.
UNIT CHIEF: BRANDON CRISS
DISTRICT 3 NO. (815) 434-6131
CONTRACT NO. 66N62

GROSS & NET LENGTH = POINT LOCATION

STATE OF ILLINOIS
DEPARTMENT OF TRANSPORTATION

SUBMITTED March 26 20 24

Julie Thompson
REGIONAL ENGINEER

May 10, 2024 *[Signature]*
ENGINEER OF DESIGN AND ENVIRONMENT

May 10, 2024 *[Signature]*
DIRECTOR OF HIGHWAYS PROJECT IMPLEMENTATION

**PRINTED BY THE AUTHORITY
OF THE STATE OF ILLINOIS**

GENERAL NOTES

THE TRAFFIC SIGNAL SECTION AT THE ILLINOIS DEPARTMENT OF TRANSPORTATION, DISTRICT 3. SHALL BE NOTIFIED BY THE CONTRACTOR AT 815-434-8506 AT LEAST 72 HOURS PRIOR TO TURNING ON ANY FLASHER OR CONTROLLER UNITS.

A 1/4" DIAMETER CONTINUOUS RODENT RESISTANT NYLON ROPE SHALL BE FURNISHED AND LEFT IN PLACE IN ALL CONDUITS BETWEEN HANDHOLES AND FOUNDATIONS OR CONTROLLER. THIS COST SHALL BE INCLUDED WITH THE COST OF CONDUIT PAY ITEM.

THE CONTRACTOR SHALL ARRANGE FOR A FACTORY OR SUPPLIER REPRESENTATIVE TO BE PRESENT AT THE INTERSECTION WHEN THE SIGNAL IS TURNED ON. COST TO BE INCLUDED WITH THE FLASHER CONTROLLER PAY ITEM.

ALL CONDUIT IN TRENCH SHALL BE P.V.C. ALL PUSHED CONDUIT SHOULD BE GALVANIZED STEEL. CONDUIT ATTACHED TO STRUCTURES SHALL BE GALVANIZED STEEL.

NO ADDITIONAL COMPENSATION WILL BE ALLOWED FOR PLACING CONDUIT AT A GREATER THAN 2' MINIMUM DEPTH TO AVOID OBSTACLES SUCH AS UNDERGROUND UTILITIES.

THE ELECTRICAL CONDUCTORS FOR ALL TRAFFIC SIGNAL HEADS SHALL BE SOLID, SOFT COPPER.

ALL THREADS OF BOLTS USED IN THE ASSEMBLY OF TRAFFIC SIGNAL COMPONENTS SHALL BE COATED WITH A NON-LEAD BASED ANTI-SEIZE COMPOUND, SIMILAR TO LEAD PLATE, PRIOR TO ASSEMBLY.

ALL HARDWARE SHALL BE TIGHTENED AND WELL SECURED, CABLES SHALL BE NEATLY WOUND IN HANDHOLES. CABLES SHALL BE NEATLY TRAINED IN THE CONTROLLER CABINET.

THE CONTRACTOR SHALL BE RESPONSIBLE FOR OBTAINING ELECTRICAL SERVICE FOR THE TRAFFIC SIGNALS. THE CONTRACTOR SHALL CONTACT THE UTILITY COMPANY PRIOR TO BEGINNING WORK TO OBTAIN THE UTILITY COMPANY REQUIREMENTS FOR THE SERVICE INSTALLATION.

BACKPLATES SHALL BE POLYCARBONATE, LOUVERED FORMED BACKPLATES.

ALL VEHICLE AND PEDESTRIAN SIGNAL HEADS SHALL HAVE POLYCARBONATE BLACK HOUSING AND BLACK BRACKETS.

ALL UNINTERRUPTIBLE POWER SUPPLIES SHALL BE EQUIPPED WITH ALPHA GUARD MONITORS.

ALL AREAS DISTURBED BY THE CONTRACTOR SHALL BE RESTORED WITH SEED OR SOD TO THE SATISFACTION OF THE ENGINEER. SEEDING OR SODDING SHALL NOT BE PERMITTED AT ANY TIME WHEN THE GROUND IS FROZEN, WET, OR IN AN UNTILLABLE CONDITION.

THE SURGE PROTECTOR IN THE CONTROLLER CABINET SHALL HAVE AN INDICATOR LIGHT.

ALL EXCAVATED MATERIAL, WHICH INCLUDES DIGGING OR GRADING OF ANY SOIL OR FILL MATERIAL, WITH THE EXCEPTION OF AGGREGATE FILLS, MUST BE INCORPORATED WITHIN THE IDOT RIGHT OF WAY DUE TO ENVIRONMENTAL DOCUMENTATION REQUIREMENTS.

MEMBERS OF JULIE KNOWN TO BE WITHIN THE LIMITS OF THE IMPROVEMENT ARE:

- AT&T
- COMED
- COMCAST

COMMITMENTS:

NONE

STATE OF ILLINOIS
DEPARTMENT OF TRANSPORTATION
DISTRICT THREE
AS BUILT INFORMATION

SUPERVISING CONSTRUCTION FIELD ENGINEER

RESIDENT ENGINEER / TECHNICIAN

START & END DATES
OF CONSTRUCTION:

INSPECTORS:

MODEL: General Notes 1 [Sheet]
FILE NAME: c:\p\work\dot\brandon.criss@illinois.gov\0878502\0368N62 SHEET.dgn

USER NAME = Brandon.Criss	DESIGNED -	REVISED -
	DRAWN -	REVISED -
	CHECKED -	REVISED -
PLOT DATE = 3/19/2024	DATE -	REVISED -

**STATE OF ILLINOIS
DEPARTMENT OF TRANSPORTATION**

GENERAL NOTES

SCALE: SHEET 1 OF 1 SHEETS STA. TO STA.

F.A.P. RTE.	SECTION	COUNTY	TOTAL SHEETS	SHEET NO.
296	(0) SFY	GRUNDY	14	2
CONTRACT NO. 66N62				
ILLINOIS FED. AID PROJECT				

CODE NO.	ITEM	UNIT	TOTAL QUANTITY	CONSTR. CODE	
				10% STATE 90% FED	SAFETY 0021 RURAL
67100100	MOBILIZATION	L SUM	1		1
70100450	TRAFFIC CONTROL AND PROTECTION, STANDARD 701201	L SUM	1		1
80500300	SERVICE INSTALLATION, TYPE C	EACH	1		1
81028200	UNDERGROUND CONDUIT, GALVANIZED STEEL, 2" DIA.	FOOT	368		368
81028350	UNDERGROUND CONDUIT, PVC, 2" DIA.	FOOT	3268		3268
81100500	CONDUIT ATTACHED TO STRUCTURE, 1 1/2" DIA., GALVANIZED STEEL	FOOT	52		52
81400700	HANDHOLE, PORTLAND CEMENT CONCRETE	EACH	10		10
85800100	FLASHER CONTROLLER	EACH	1		1
87200400	SPAN WIRE	FOOT	197		197
87200500	TETHER WIRE	FOOT	197		197
87301215	ELECTRIC CABLE IN CONDUIT, SIGNAL NO. 14 2C	FOOT	3938		3938
87301805	ELECTRIC CABLE IN CONDUIT, SERVICE, NO. 6 2C	FOOT	5		5
87301900	ELECTRIC CABLE IN CONDUIT, EQUIPMENT GROUNDING CONDUCTOR, NO. 6 1C	FOOT	3938		3938
87302212	ELECTRIC CABLE AERIAL SUSPENDED, SIGNAL, NO. 14 2C	FOOT	466		466

MODEL: SOQ (Sheet)
FILE NAME: c:\p\work\wifid\brandon.criss@illinois.gov\0878502\366N62 SHEET.dgn

USER NAME = Brandon.Criss	DESIGNED -	REVISED -	STATE OF ILLINOIS DEPARTMENT OF TRANSPORTATION	SUMMARY OF QUANTITIES			F.A.P RTE.	SECTION	COUNTY	TOTAL SHEETS	SHEET NO.			
	DRAWN -	REVISED -		SCALE:	SHEET 1	OF 2	SHEETS	STA.	TO STA.	296	(0) SFY	GRUNDY	14	3
	CHECKED -	REVISED -		CONTRACT NO. 66N62										
PLOT DATE = 3/19/2024	DATE -	REVISED -		ILLINOIS FED. AID PROJECT										

CODE NO.	ITEM	UNIT	TOTAL QUANTITY	CONSTR. CODE	
				10% STATE 90% FED	SAFETY 0021 RURAL
87302705	ELECTRIC CABLE AERIAL SUSPENDED, EQUIPMENT GROUNDING CONDUCTOR, NO. 6 1C	FOOT	466		466
87800400	CONCRETE FOUNDATION, TYPE E 30-INCH DIAMETER	FOOT	24		24
88040030	SIGNAL HEAD, POLYCARBONATE, LED, 1-FACE, 1-SECTION, POST MOUNTED	EACH	4		4
X1400357	STEEL STRAIN POLE, 30FT	EACH	2		2
X8620200	UNINTERRUPTABLE POWER SUPPLY (SPECIAL)	EACH	1		1
X8800081	SIGNAL HEAD, LED, 4-FACE, 1-SECTION, SPAN WIRE MOUNTED	EACH	1		1
Z0030850	TEMPORARY INFORMATION SIGNING	SQ FT	84		84

MODEL: SOO 2 [Sheet]
FILE NAME: c:\pw\work\wvictor\brandon.criss@illinois.gov\0078502\0366N62_SHEET.dgn

USER NAME = Brandon.Criss	DESIGNED -	REVISED -	STATE OF ILLINOIS DEPARTMENT OF TRANSPORTATION	SUMMARY OF QUANTITIES				F.A.P RTE.	SECTION	COUNTY	TOTAL SHEETS	SHEET NO.
	DRAWN -	REVISED -		296	(0) SFY	GRUNDY	14	4				
	CHECKED -	REVISED -						CONTRACT NO. 66N62				
PLOT DATE = 3/19/2024	DATE -	REVISED -		SCALE:	SHEET 2	OF 2	SHEETS	STA.	TO STA.	ILLINOIS	FED. AID PROJECT	

BREAKLINE - SEE SHEET 6 - STA 2+00



NOTE: PROP STEEL STRAIN POLES SHALL BE PLACED AT LEAST 18' FROM EOP TO FACE OF POLE

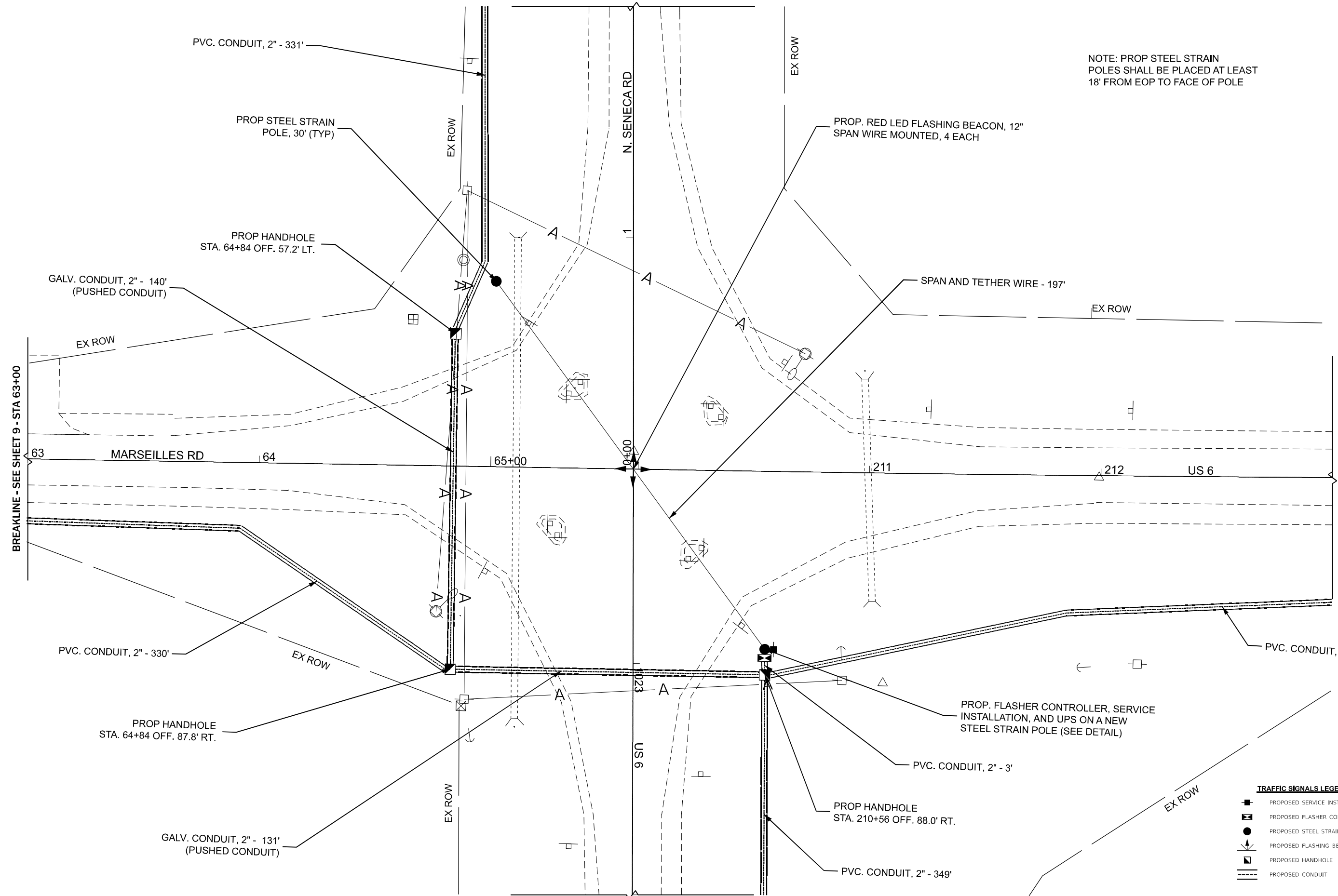

TRAFFIC SIGNALS LEGEND

	PROPOSED SERVICE INSTALLATION
	PROPOSED FLASHER CONTROLLER
	PROPOSED STEEL STRAIN POLE
	PROPOSED FLASHING BEACON
	PROPOSED HANDHOLE
	PROPOSED CONDUIT

MODEL: Center plane-1 (Sheet)
 FILE NAME: c:\p\work\pav\td\brandon.criss@illinois.gov\0878502\0366N62_Layout.dgn

USER NAME = Brandon.Criss	DESIGNED -	REVISED -
PLOT SCALE = \$SCALE\$	DRAWN -	REVISED -
PLOT DATE = 3/19/2024	CHECKED -	REVISED -
	DATE -	REVISED -

STATE OF ILLINOIS
DEPARTMENT OF TRANSPORTATION

CONDUIT PLAN
INTERSECTION

SCALE: SHEET 1 OF 5 SHEETS STA. TO STA.

F.A.P. RTE. 296	SECTION (0) SFY	COUNTY GRUNDY	TOTAL SHEETS 14	SHEET NO. 5
CONTRACT NO. 66N62				
ILLINOIS FED. AID PROJECT				

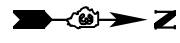
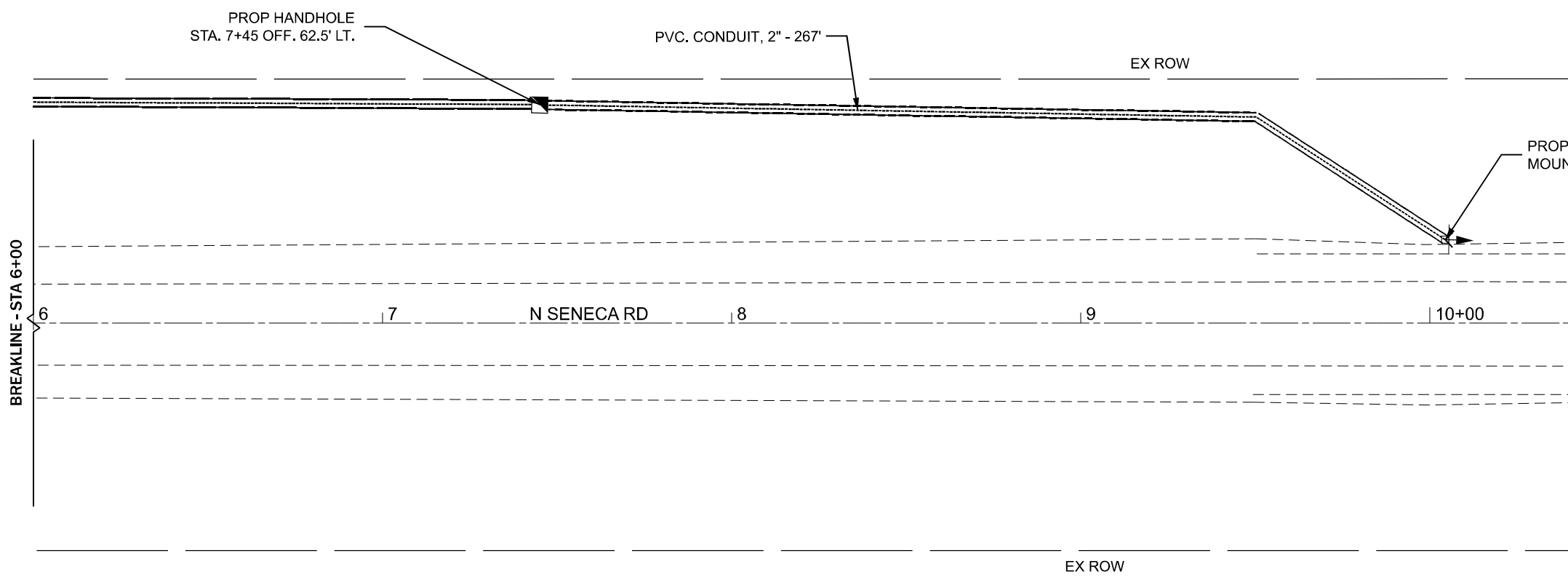
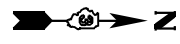
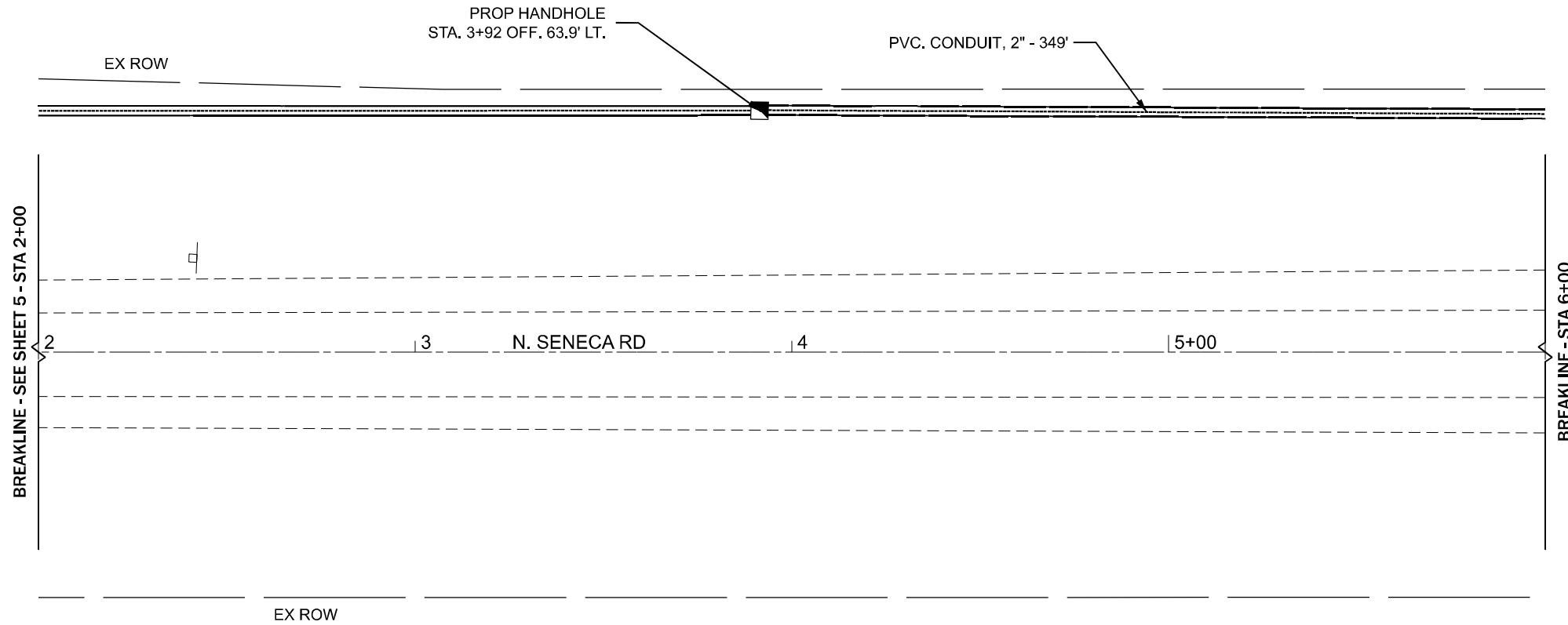

- TRAFFIC SIGNALS LEGEND**
- PROPOSED SERVICE INSTALLATION
 - PROPOSED FLASHER CONTROLLER
 - PROPOSED STEEL STRAIN POLE
 - PROPOSED FLASHING BEACON
 - PROPOSED HANDHOLE
 - PROPOSED CONDUIT

MODEL: EXCL_USGS - NORTH
 FILE NAME: c:\p\work\pvt\brandon.crisss@illinois.gov\0878502\366N62_Layout.dgn

USER NAME = brandon.crisss	DESIGNED -	REVISED -
	DRAWN -	REVISED -
PLOT SCALE = \$SCALE\$	CHECKED -	REVISED -
PLOT DATE = 3/7/2024	DATE -	REVISED -





STATE OF ILLINOIS
DEPARTMENT OF TRANSPORTATION

CONDUIT PLAN
NORTH LEG

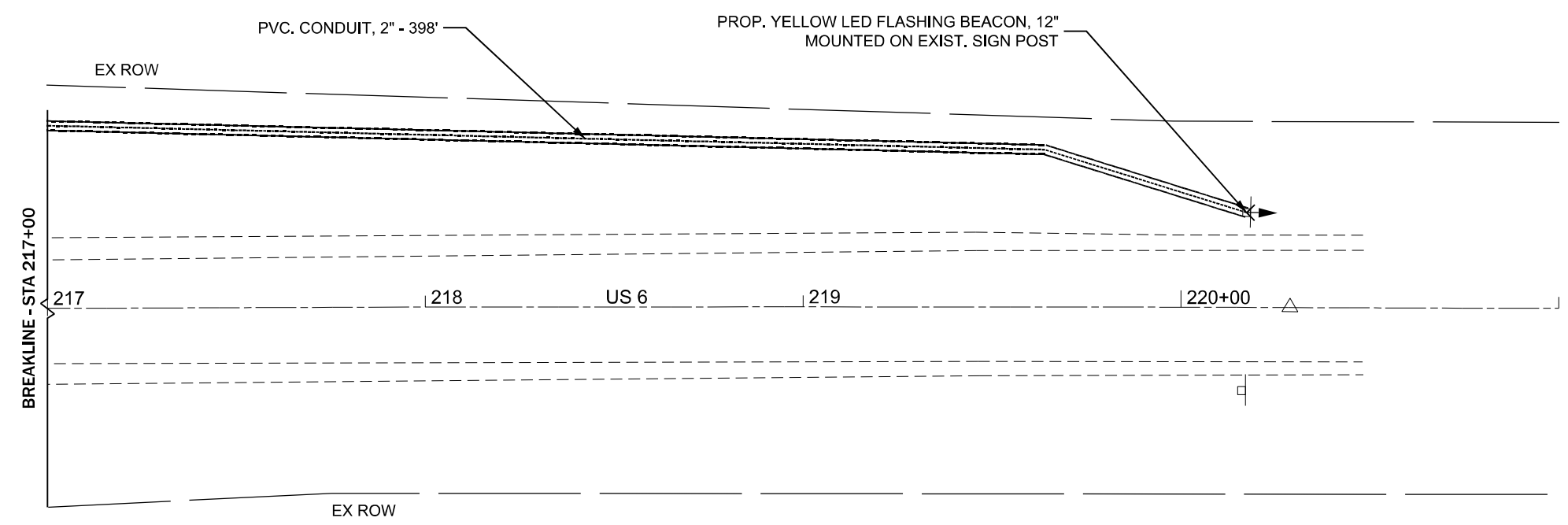
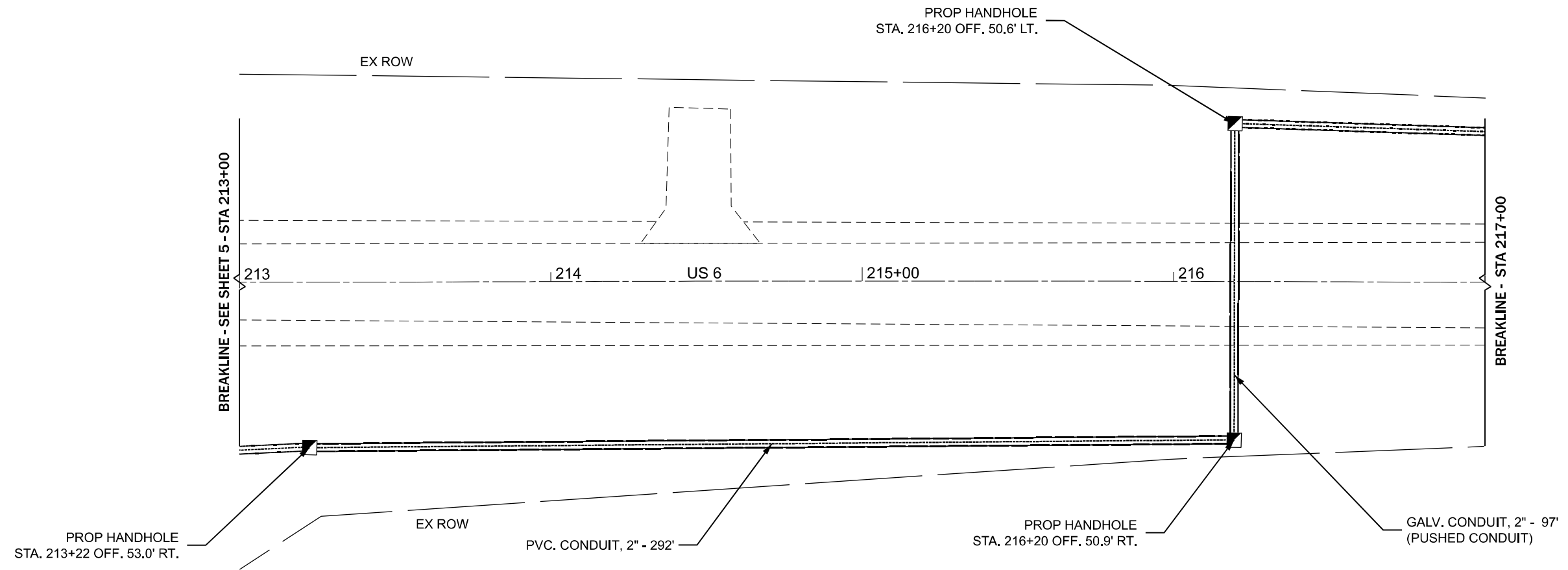
SCALE: SHEET 2 OF 5 SHEETS STA. 2+00 TO STA. 10+00

F.A.P. RTE. 296	SECTION (0) SFY	COUNTY GRUNDY	TOTAL SHEETS 14	SHEET NO. 6
CONTRACT NO. 66N62				
ILLINOIS FED. AID PROJECT				

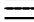

- TRAFFIC SIGNALS LEGEND**
-  PROPOSED SERVICE INSTALLATION
 -  PROPOSED FLASHER CONTROLLER
 -  PROPOSED STEEL STRAIN POLE
 -  PROPOSED FLASHING BEACON
 -  PROPOSED HANDHOLE
 -  PROPOSED CONDUIT

MODEL: EXCL_US6S - EAST
 FILE NAME: c:\p\work\pvt\brandon.criss@illinois.gov\0878502\366N62_Layout.dgn

USER NAME = brandon.criss	DESIGNED -	REVISED -
	DRAWN -	REVISED -
PLOT SCALE = \$SCALE\$	CHECKED -	REVISED -
PLOT DATE = 3/7/2024	DATE -	REVISED -

STATE OF ILLINOIS
DEPARTMENT OF TRANSPORTATION

CONDUIT PLAN
EAST LEG

SCALE: SHEET 3 OF 5 SHEETS STA. 213+00.00 TO STA. 221+00.00

F.A.P. RTE.	SECTION	COUNTY	TOTAL SHEETS	SHEET NO.
296	(0) SFY	GRUNDY	14	7
CONTRACT NO. 66N62				
ILLINOIS FED. AID PROJECT				

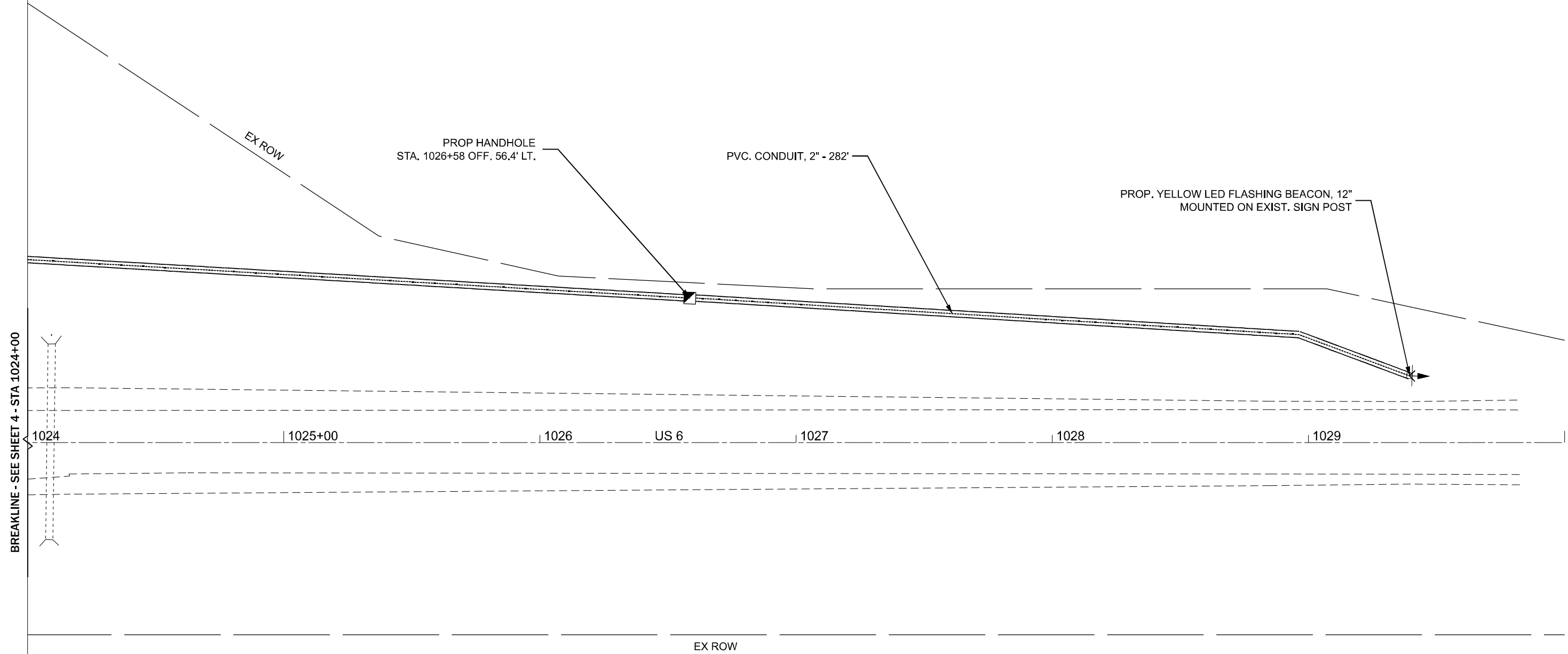

TRAFFIC SIGNALS LEGEND

- PROPOSED SERVICE INSTALLATION
- PROPOSED FLASHER CONTROLLER
- PROPOSED STEEL STRAIN POLE
- PROPOSED FLASHING BEACON
- PROPOSED HANDHOLE
- PROPOSED CONDUIT

MODEL: EXCL_US6S - SOUTH
 FILE NAME: c:\pwwork\pwwork\brandon.criss@illinois.gov\00878502\0366N62_Layout.dgn

USER NAME = brandon.criss	DESIGNED -	REVISED -
	DRAWN -	REVISED -
PLOT SCALE = \$SCALE\$	CHECKED -	REVISED -
PLOT DATE = 3/7/2024	DATE -	REVISED -

STATE OF ILLINOIS
 DEPARTMENT OF TRANSPORTATION



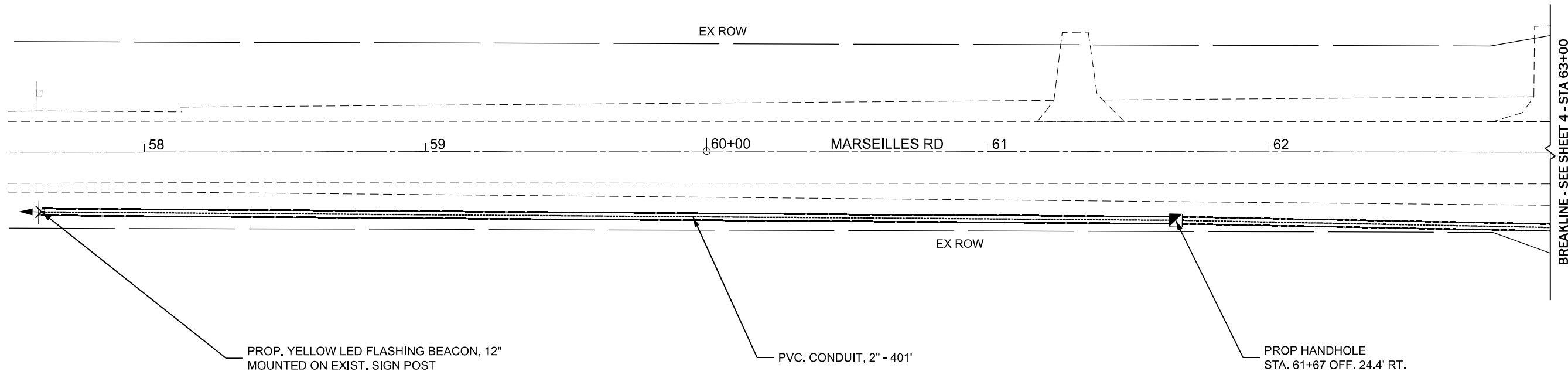

CONDUIT PLAN
 SOUTH LEG

SCALE: SHEET 4 OF 5 SHEETS STA. 1024+00 TO STA. 1030+00

F.A.P. RTE.	SECTION	COUNTY	TOTAL SHEETS	SHEET NO.
296	(0) SFY	GRUNDY	14	8
CONTRACT NO. 66N62				
ILLINOIS FED. AID PROJECT				

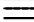

TRAFFIC SIGNALS LEGEND

-  PROPOSED SERVICE INSTALLATION
-  PROPOSED FLASHER CONTROLLER
-  PROPOSED STEEL STRAIN POLE
-  PROPOSED FLASHING BEACON
-  PROPOSED HANDHOLE
-  PROPOSED CONDUIT

MODEL: EXCL_USGS - WEST (Sheet)
 FILE NAME: c:\p\work\pav\td\brandon.criss@illinois.gov\0878502\0366N62_Layout.dgn

USER NAME = Brandon.Criss	DESIGNED -	REVISED -
	DRAWN -	REVISED -
PLOT SCALE = \$SCALE\$	CHECKED -	REVISED -
PLOT DATE = 3/20/2024	DATE -	REVISED -

STATE OF ILLINOIS
DEPARTMENT OF TRANSPORTATION

CONDUIT PLAN
WEST LEG

SCALE: SHEET 5 OF 5 SHEETS STA. 57+75 TO STA. 63+00

F.A.P. RTE.	SECTION	COUNTY	TOTAL SHEETS	SHEET NO.
296	(0) SFY	GRUNDY	14	9
CONTRACT NO. 66N62				

ILLINOIS FED. AID PROJECT

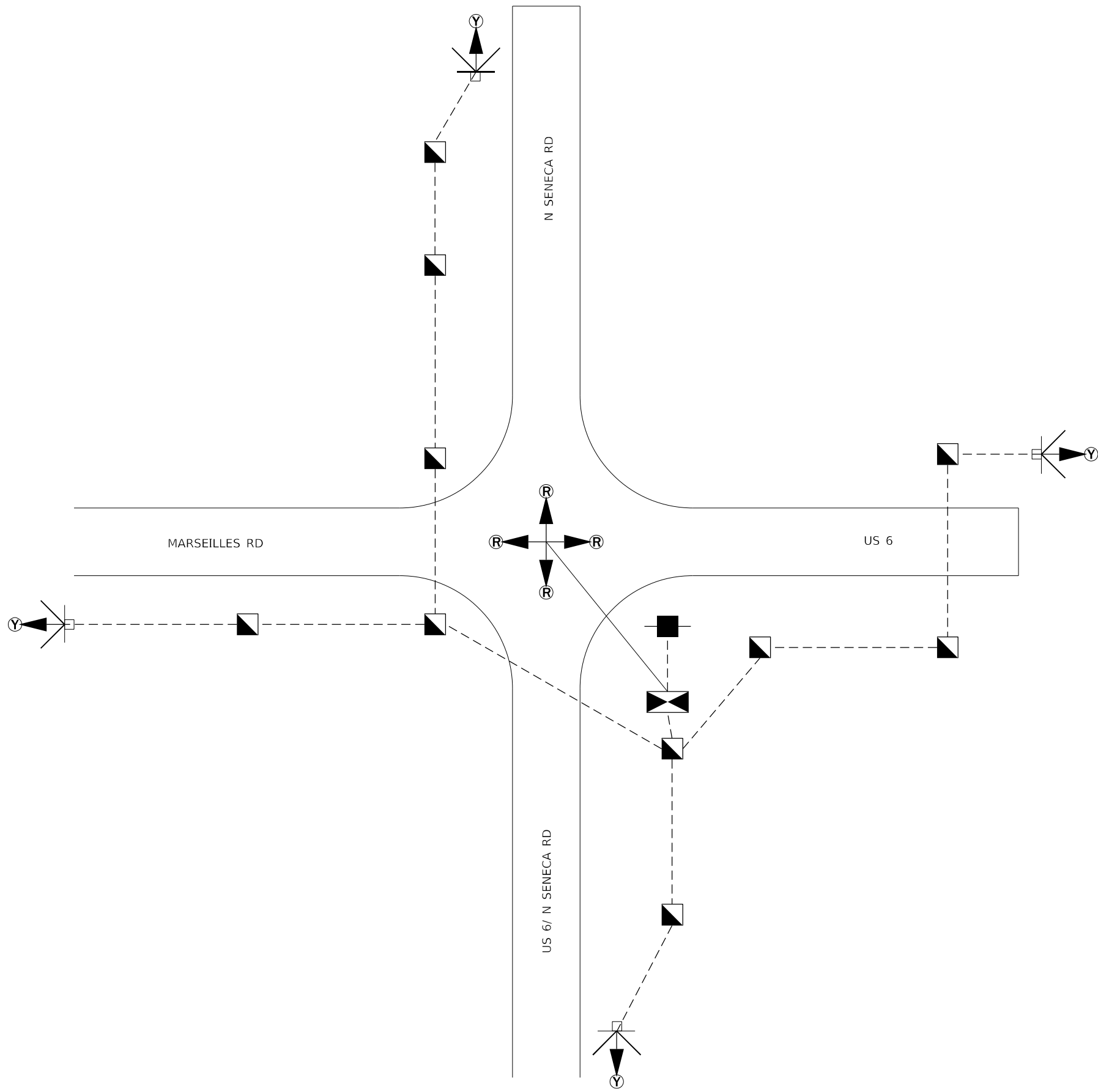

- TRAFFIC SIGNALS LEGEND**
- PROPOSED SERVICE INSTALLATION
 - PROPOSED FLASHER CONTROLLER
 - PROPOSED FLASHING BEACON
 - PROPOSED HANDHOLE
 - ELECTRIC CABLE AERIAL
 - ELECTRIC CABLE IN CONDUIT

MODEL: Cable Plan (Sheet)
 FILE NAME: c:\p\work\brandon.criss@illinois.gov\0878502\366N62_SHEET.dgn

USER NAME = brandon.criss	DESIGNED -	REVISED -
	DRAWN -	REVISED -
	CHECKED -	REVISED -
PLOT DATE = 3/6/2024	DATE -	REVISED -

STATE OF ILLINOIS
DEPARTMENT OF TRANSPORTATION

CABLE PLAN			
US 6 & Marseilles Rd			
SCALE:	SHEET 1	OF 1 SHEETS	STA. TO STA.

F.A.P. RTE.	SECTION	COUNTY	TOTAL SHEETS	SHEET NO.
296	(0) SFY	GRUNDY	14	10
CONTRACT NO. 66N62				
ILLINOIS FED. AID PROJECT				

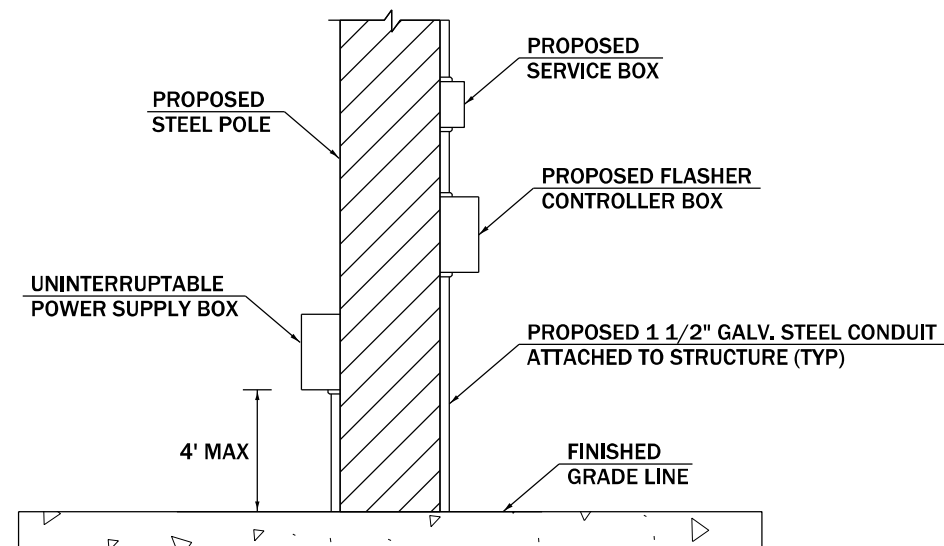

INTERSECTION CONTROLLER/SERVICE BOX INSTALLATION DETAIL (NTS)

NOTE: THE IDOT TRAFFIC SIGNAL SECTION SHALL BE CONTACTED AT 815-434-8506 BEFORE THE EQUIPMENT IS MOUNTED TO VERIFY AN ACCEPTABLE PLACEMENT AND ORIENTATION ON THE POLE

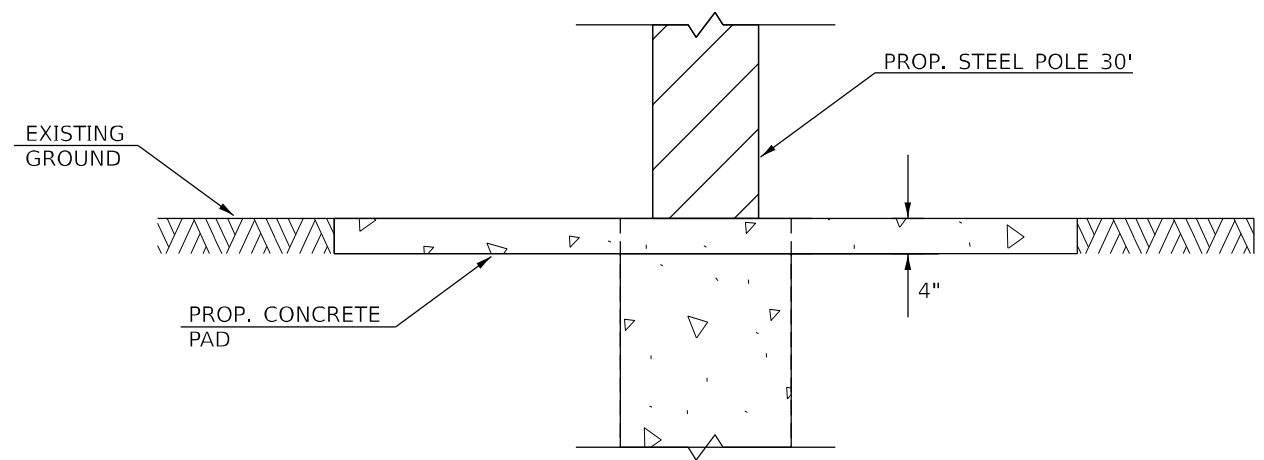

FRONT VIEW

STEEL POLE AND CONCRETE PAD LAYOUT

MODEL: Details [Sheet]
FILE NAME: c:\p\work\wv\idot\brandon.criss@illinois.gov\0878502\0366N62 SHEET.dgn

USER NAME = Brandon.Criss	DESIGNED -	REVISED -
	DRAWN -	REVISED -
	CHECKED -	REVISED -
PLOT DATE = 3/20/2024	DATE -	REVISED -

**STATE OF ILLINOIS
DEPARTMENT OF TRANSPORTATION**

DETAILS

SCALE: SHEET 1 OF 1 SHEETS STA. TO STA.

F.A.P. RTE.	SECTION	COUNTY	TOTAL SHEETS	SHEET NO.
296	(0) SFY	GRUNDY	14	11
CONTRACT NO. 66N62			ILLINOIS FED. AID PROJECT	

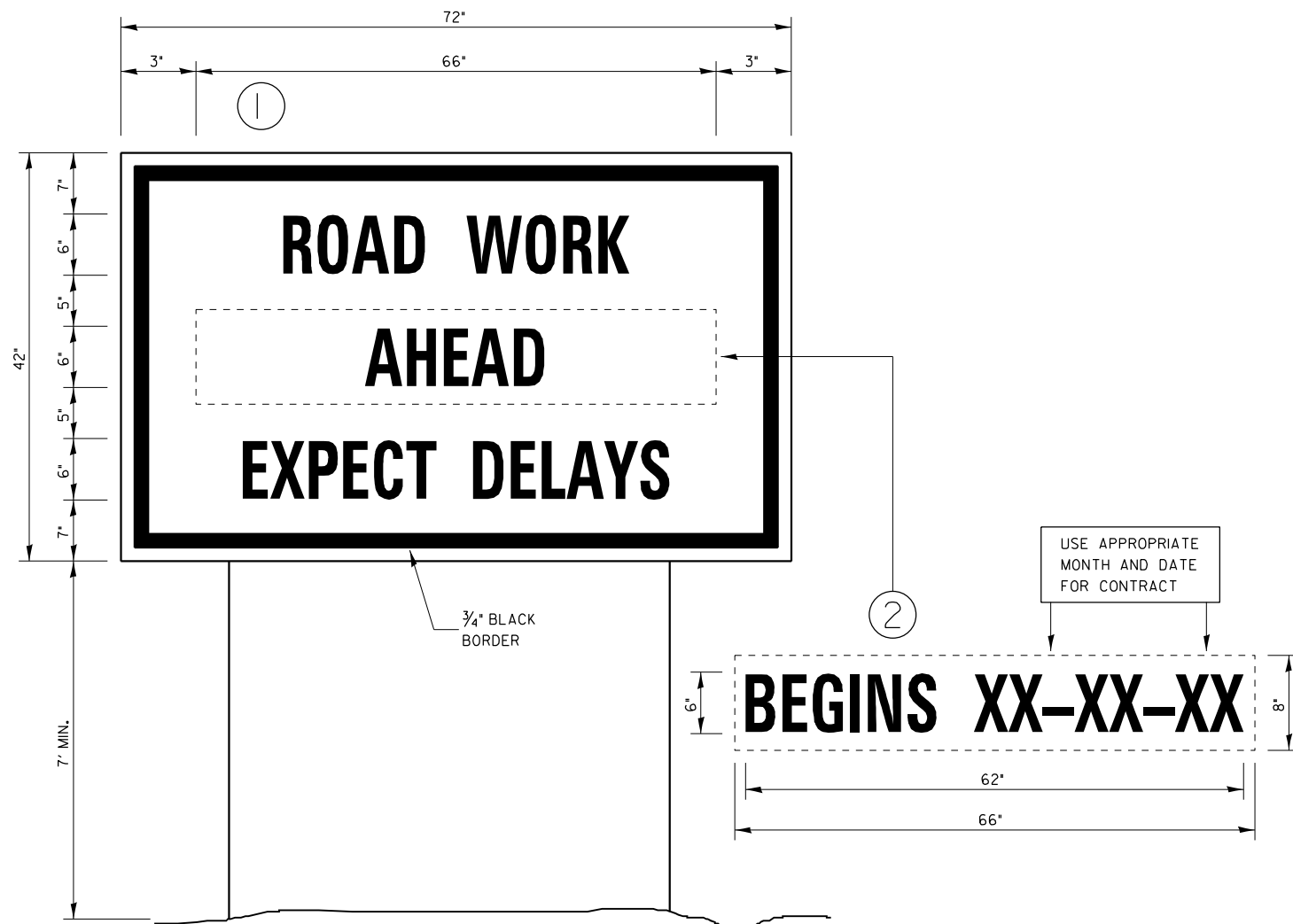

TEMPORARY INFORMATION SIGNING

NOTES:

1. USE 6" D BLACK LETTERING ON FLUORESCENT ORANGE BACKGROUND.
2. ERECT SIGNS AT LOCATIONS IN ADVANCE OF THE "ROAD CONSTRUCTION AHEAD" SIGNS AS DIRECTED BY THE ENGINEER.
3. ERECT SIGN ① WITH INSTALLED PANEL ② A MINIMUM OF ONE WEEK PRIOR TO THE START OF THE LANE CLOSURE.
4. REMOVE PANEL ② ON THAT DATE.
5. SEE SPECIAL PROVISION "TEMPORARY INFORMATION SIGNING" FOR ADDITIONAL INFORMATION.
6. WILL BE PAID FOR PER SQ FT AS "TEMPORARY INFORMATION SIGNING". EACH SIGN = 21 SQ FT AND THE DATE PANEL ② WILL NOT BE MEASURED SEPARATELY FOR PAYMENT.

MODEL: Traffic Control 2 (Sheet)
FILE NAME: c:\p\work\ivict\brandon.criss@illinois.gov\0878502\0366N62 SHEET.dgn

USER NAME = Brandon.Criss	DESIGNED -	REVISED -
	DRAWN -	REVISED -
	CHECKED -	REVISED -
PLOT DATE = 3/20/2024	DATE -	REVISED -

**STATE OF ILLINOIS
DEPARTMENT OF TRANSPORTATION**

TRAFFIC CONTROL DETAILS

SCALE: SHEET 2 OF 2 SHEETS STA. TO STA.

F.A.P. RTE.	SECTION	COUNTY	TOTAL SHEETS	SHEET NO.
296	(0) SFY	GRUNDY	14	13
CONTRACT NO. 66N62				
ILLINOIS FED. AID PROJECT				

