

STATE OF ILLINOIS
DEPARTMENT OF TRANSPORTATION

F.A.P. RTE.	SECTION	COUNTY	TOTAL SHEETS	SHEET NO.
322	D5 CM INLAY 2024-1	DEWITT	11	1
		ILLINOIS	CONTRACT NO. 70H07	

D-95-011-24

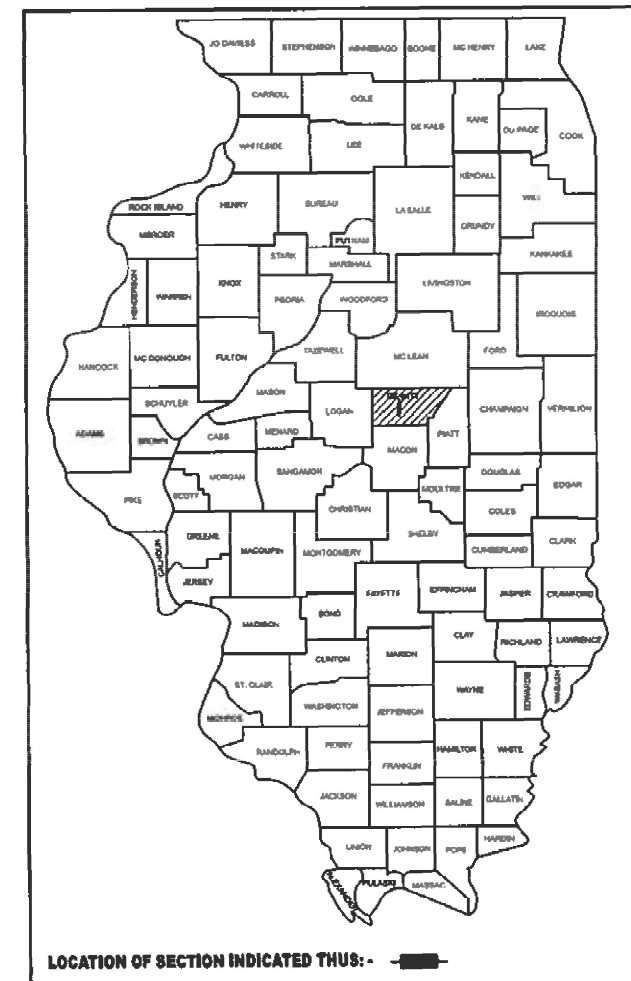

FOR INDEX OF SHEETS, SEE SHEET NO. 2
FOR SUMMARY OF QUANTITIES, SEE SHEET NO. 3

TRAFFIC DATA	
FAP 322 (US 51)	
LEG "A"	
2023 ADT =	10,300
P.U. %	87.4
S.U. %	3.4
M.U. %	9.2
TRAFFIC DATA LOCATIONS	
LEG "A" is US 51 from 0.4 mile north of Autumn Rd. to 0.3 miles south of Tabor Rd.	
FUNCTIONAL CLASSIFICATION	
Freeway and Expressway	
TOWNSHIP	
CLINTONIA	

PROPOSED HIGHWAY PLANS

FAP ROUTE 322 (US 51)
SECTION D5 CM INLAY 2024-1
PROJECT
SMART OVERLAY & BRIDGE DECK OVERLAY
DEWITT COUNTY
0.4 MI N OF AUTUMN RD TO 0.3 MI S OF TABOR RD N OF CLINTON

C-95-029-24

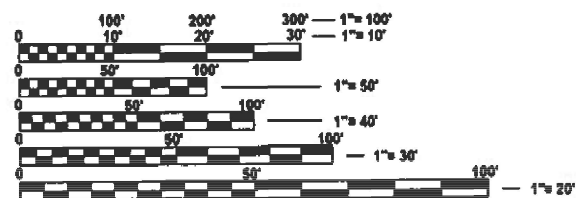
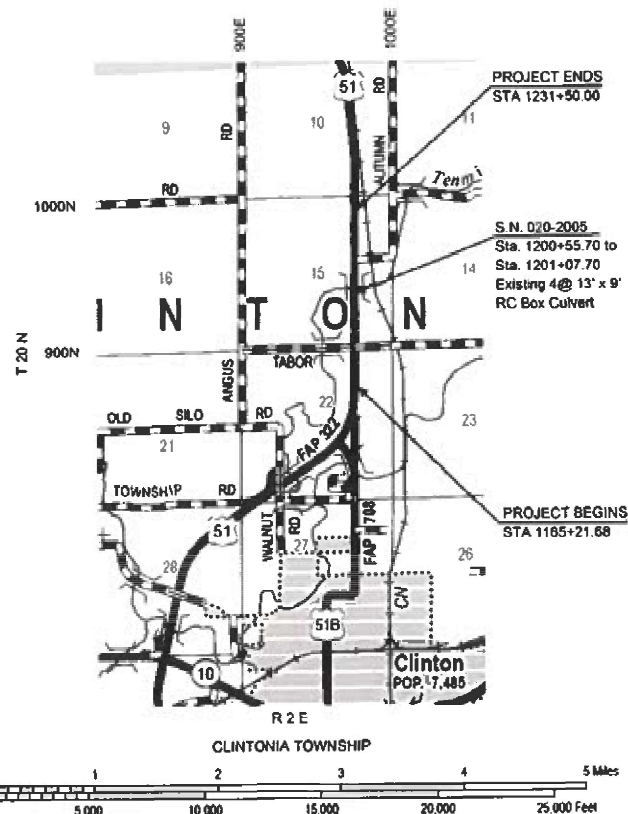

FULL SIZE PLANS HAVE BEEN PREPARED USING STANDARD ENGINEERING SCALES. REDUCED SIZED PLANS WILL NOT CONFORM TO STANDARD SCALES. IN MAKING MEASUREMENTS ON REDUCED PLANS, THE ABOVE SCALES MAY BE USED.

J.U.L.I.E.
JOINT UTILITY LOCATION INFORMATION FOR EXCAVATION
1-800-892-0123
OR 811

PROJECT ENGINEER: JASON STULTS
DESIGNER: JEANNIE BLAND
PHONE: (217)465-4181
CONTRACT NO. 70H07

GROSS LENGTH = 6,628.32 FT. = 1.26 MILE
NET LENGTH = 6,628.32 FT. = 1.26 MILE

STATE OF ILLINOIS
DEPARTMENT OF TRANSPORTATION

SUBMITTED 2/29 2024
Kennel A. Barnitt swn
REGIONAL ENGINEER

May 10, 2024 [Signature]
ENGINEER OF DESIGN AND ENVIRONMENT

May 10, 2024 [Signature]
DIRECTOR OF HIGHWAYS PROJECT IMPLEMENTATION

PRINTED BY THE AUTHORITY
OF THE STATE OF ILLINOIS

INDEX OF SHEETS

SHEET NO.	DESCRIPTION
1	COVER SHEET
2	INDEX OF SHEETS
2	HIGHWAY STANDARDS
2	GENERAL NOTES
2	COMMITMENTS
3 - 4	SUMMARY OF QUANTITIES
5	TYPICAL CROSS SECTIONS
6	SCHEDULE OF QUANTITIES
7 - 10	PAVEMENT MARKING AND MARKERS (RURAL & URBAN APPLICATIONS) DETAIL
11	WATERPROOFING MEMBRANE SYSTEM DETAIL

HIGHWAY STANDARDS

STANDARD NO.	DESCRIPTION
000001-08	STANDARDS SYMBOLS, ABBREVIATIONS, & PATTERNS
001001-02	AREAS OF REINFORCEMENT
001006	DECIMAL OF AN INCH AND OF A FOOT
701101-05	OFF-ROAD OPERATIONS, MULTILANE, 15' TO 24" FROM PAVEMENT EDGE
701106-02	OFF-ROAD OPERATIONS, MULTILANE, MORE THAN 15' AWAY
701400-12	APPROACH TO LANE CLOSURE, FREEWAY/EXPRESSWAY
701401-13	LANE CLOSURE, FREEWAY/EXPRESSWAY
701406-13	LANE CLOSURE, FREEWAY/EXPRESSWAY, DAY OPERATIONS ONLY
701426-09	LANE CLOSURE, MULTILANE, INTERMITTENT OR MOVING OPERATION, FOR SPEEDS \geq 45 MPH
701901-09	TRAFFIC CONTROL DEVICES

GENERAL NOTES

G.N.-100A
ELECTRONIC FILES AND/OR ELECTRONIC SURVEY INFORMATION INCLUDING CADD FILES WILL NOT BE AVAILABLE TO THE CONTRACTOR.

G.N.-406H

MIXTURE REQUIREMENTS

THE FOLLOWING MIXTURE REQUIREMENTS ARE APPLICABLE FOR THIS PROJECT:

LOCATION(S):	US ROUTE 51	S.N. 020-2005
MIXTURE USE(S):	SURFACE	WEARING SURFACE (DECK)
AC/PG:	64-22	64-22
DESIGN AIR VOIDS	4.00%	4.00%
MIXTURE COMP (GRADATION)	IL-9.5	IL-9.5
FRICTION AGGREGATE	"D"	"D"
MIXTURE WEIGHT	112	112
QUALITY MANAGE- MENT PROGRAM	QC/QA	QC/QA
SUBLOT SIZE	1000	1000
MATERIAL TRANSFER DEVICE (REQUIRED?)	NO	NO

G.N.-406M

MATERIAL TRANSFER DEVICE (MTD) INFORMATION

IF THE CONTRACTOR ELECTS TO USE A MATERIAL TRANSFER DEVICE (MTD), THEN THE FOLLOWING REQUIREMENTS WILL APPLY.

BASED ON STRUCTURAL ANALYSIS, THE FOLLOWING STRUCTURES CAN BE CROSSED WITH AN EMPTY MTD WITH THE FOLLOWING MAXIMUM GROSS WEIGHT RESTRICTIONS:

STRUCTURE NUMBER	WEIGHT RESTRICTION
020-2005	40 TONS
020-8017	40 TONS
020-8018	40 TONS

IF THE SAME MTD IS USED THROUGHOUT THE ENTIRE CONTRACT, THEN IT MUST BE LIMITED TO AN EMPTY GROSS WEIGHT OF 40 TONS OR LESS.

G.N.-406S

PROJECT POSTED SPEED LIMITS

THE FOLLOWING TABLE IS A LISTING OF POSTED SPEED LIMITS WITHIN THE PROJECT LIMITS. THE ENGINEER SHALL FIELD VERIFY THESE LIMITS:

STATION	TO	STATION	POSTED SPEED LIMIT (MPH)
1165+21.68		1231+50.00	65

COMMITMENTS

THERE ARE NO COMMITMENTS FOR THIS CONTRACT

MODEL: Index (Sheet)
FILE NAME: c:\p\work\vw\cd\pierson\bc\0948896\0570107_Sht-CemNote.dgn

USER NAME = Bridgette.Pierson	DESIGNED -	REVISED -
	DRAWN -	REVISED -
PLOT SCALE = 0.1666667 / in.	CHECKED -	REVISED -
PLOT DATE = 12/26/2023	DATE -	REVISED -

**STATE OF ILLINOIS
DEPARTMENT OF TRANSPORTATION**

**INDEX OF SHEETS, HIGHWAY STANDARDS,
GENERAL NOTES & COMMITMENTS**

SCALE: NONE SHEET 1 OF 1 SHEETS STA. TO STA.

F.A.P. RTE.	SECTION	COUNTY	TOTAL SHEETS	SHEET NO.
322	D5 CM INLAY 2024-1	DEWITT	11	2
CONTRACT NO. 70H07				
		ILLINOIS	FED. AID PROJECT	

LOCATION OF WORK:	FAP 322 (US 51) FREEWAY AND EXPRESSWAY	FAP 322 (US 51) FREEWAY AND EXPRESSWAY
	URBAN STA. 1165+21.68 TO STA. 1231+50.0	URBAN STA. 1165+21.68 TO STA. 1231+50.0
FUNDING BREAKOUT:	DEWITT 100% STATE	S.N. 020-2005 DEWITT 100% STATE
CONSTRUCTION TYPE CODE:	0005	0059

CODE NO.	ITEM	UNIT	TOTAL QUANTITY	ROADWAY QUANTITY	ROADWAY QUANTITY	
40600290	BITUMINOUS MATERIALS (TACK COAT)	POUND	7,892.0	7,892.0		
40600370	LONGITUDINAL JOINT SEAL	FOOT	6,576.0	6,576.0		
40600990	TEMPORARY RAMP	SQ YD	54.0	54.0		
40604062	HOT-MIX ASPHALT SURFACE COURSE, IL9.5,MIX"D" N70	TON	1,493.0	1,473.0	20.0	
44000155	HOT-MIX SURFACE REMOVAL, 1 1/2"	SQ YD	17,537.0	17,537.0		
58100200	WATERPROOFING MEMBRANE SYSTEM	SQ YD	230.0		230.0	
67100100	MOBILIZATION	L SUM	1.0	0.5	0.5	
70100700	TRAFFIC CONTROL AND PROTECTION, STANDARD 701406	L SUM	1.0	1.0		
70100800	TRAFFIC CONTROL AND PROTECTION, STANDARD 701401	L SUM	1.0	0.5	0.5	
70103815	TRAFFIC CONTROL SURVEILLANCE	CAL DA	8.0	4.0	4.0	
70107025	CHANGEABLE MESSAGE SIGN	CAL DA	3.0	3.0		
70300100	SHORT TERM PAVEMENT MARKING	FOOT	663.0	663.0		
70300150	SHORT TERM PAVEMENT MARKING REMOVAL	SQ FT	221.0	221.0		
*	78001110	PAINT PAVEMENT MARKING - LINE 4"	FOOT	14,224.0	14,107.0	117.0

*= SPECIALTY ITEM

MODEL: SOQ (Sheet)
FILE NAME: c:\p\work\pawed\pawed\pawed\048896\0570107_Sht-SOQ.dgn

USER NAME = Bridgette.Pierson	DESIGNED -	REVISED -
	DRAWN -	REVISED -
PLOT SCALE = 0.16666667 / in.	CHECKED -	REVISED -
PLOT DATE = 12/26/2023	DATE -	REVISED -

**STATE OF ILLINOIS
DEPARTMENT OF TRANSPORTATION**

SUMMARY OF QUANTITIES	
SCALE: NONE	SHEET 1 OF 2 SHEETS
STA.	TO STA.

F.A.P. RTE.	SECTION	COUNTY	TOTAL SHEETS	SHEET NO.
322	D5 CM INLAY 2024-1	DEWITT	11	3
CONTRACT NO. 70H07				
ILLINOIS FED. AID PROJECT				

LOCATION OF WORK:

FAP 322 (US 51) FREEWAY AND EXPRESSWAY	FAP 322 (US 51) FREEWAY AND EXPRESSWAY
URBAN STA. 1165+21.68 TO STA. 1231+50.0	URBAN STA. 1165+21.68 TO STA. 1231+50.0
DEWITT 100% STATE 0005	S.N. 020-2005 DEWITT 100% STATE 0059

FUNDING BREAKOUT:
CONSTRUCTION TYPE CODE:

	CODE NO.	ITEM	UNIT	TOTAL QUANTITY	ROADWAY QUANTITY	ROADWAY QUANTITY
*	78100100	RAISED REFLECTIVE PAVEMENT MARKER	EACH	83.0	83.0	
	Z0004556	HMA SURFACE REMOVAL (DECK)	SQ YD	230.0		230.0
	Z0013798	CONSTRUCTION LAYOUT	L SUM	1.0	0.5	0.5
	Z0016200	DECK SLAB REPAIR (PARTIAL)	SQ YD	23.0		23.0
* DENOTES SPECIALTY ITEM						

MODEL: SOQ-2 [Sheet]
FILE NAME: c:\p\work\p\pierson\c094889\0570107_Sht-SOQ.dgn

USER NAME = Bridgette.Pierson	DESIGNED -	REVISED -
	DRAWN -	REVISED -
PLOT SCALE = 0.16666667' / in.	CHECKED -	REVISED -
PLOT DATE = 12/26/2023	DATE -	REVISED -

**STATE OF ILLINOIS
DEPARTMENT OF TRANSPORTATION**

SUMMARY OF QUANTITIES

SCALE: NONE SHEET 2 OF 2 SHEETS STA. TO STA.

F.A.P. RTE.	SECTION	COUNTY	TOTAL SHEETS	SHEET NO.
322	D5 CM INLAY 2024-1	DEWITT	11	4
CONTRACT NO. 70H07				
ILLINOIS FED. AID PROJECT				

**EXISTING TYPICAL CROSS SECTION
SOUTHBOUND LANES ONLY**

STRUCTURE:
S.N. 020-2005
STA. 1200+55.70 TO STA. 1201+07.70

STATION TO STATION
1165+21.68 1231+50.00

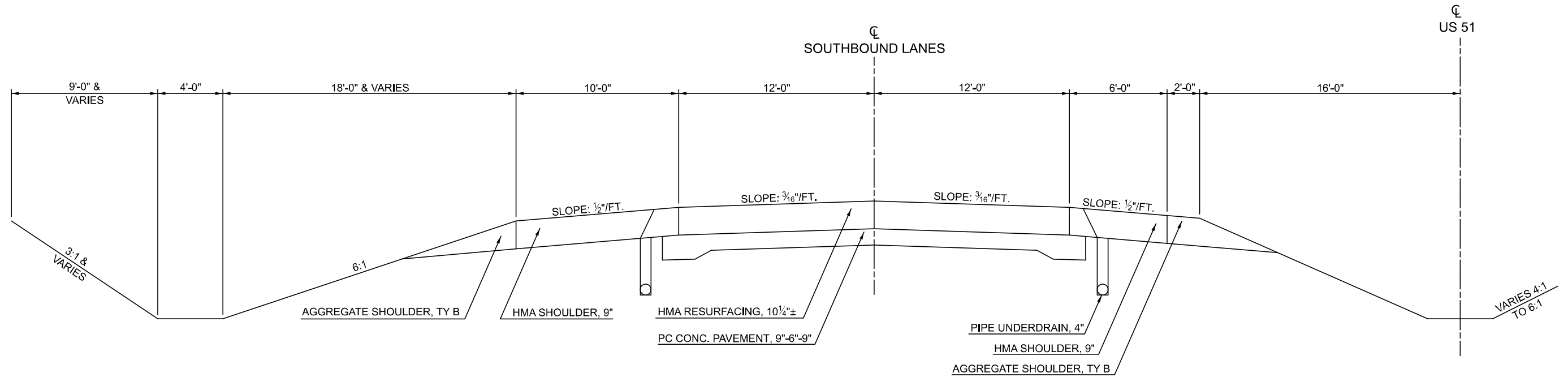

**PROPOSED TYPICAL CROSS SECTION
SOUTHBOUND LANES ONLY**

STRUCTURE:
S.N. 020-2005
STA. 1200+55.70 TO STA. 1201+07.70

STATION TO STATION
1165+21.68 1231+50.00

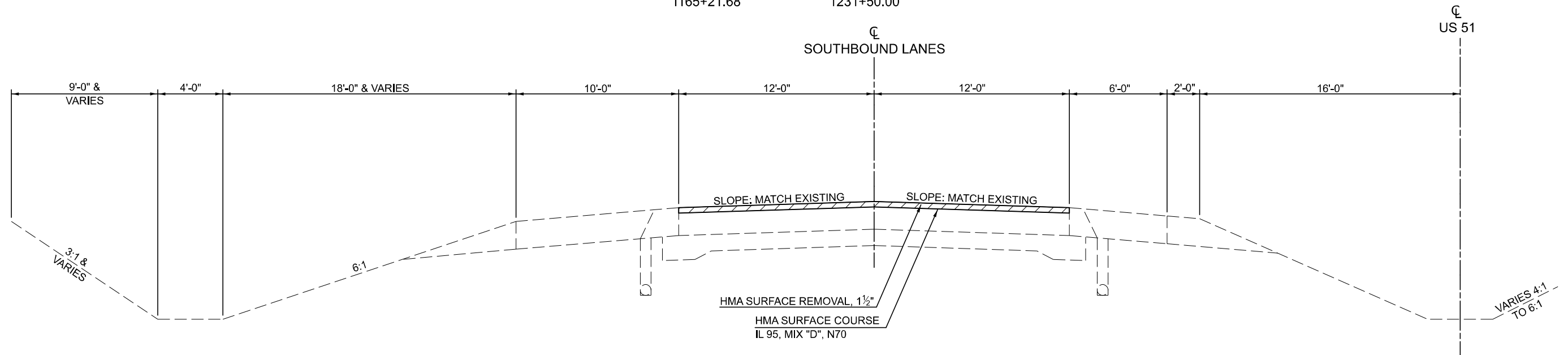

MODEL: Typical (Sheet)
FILE NAME: c:\p\work\p\work\p\person\br\0948898\0570107_Sht-Typicals.dgn

USER NAME = Bridgette.Pierson	DESIGNED -	REVISED -
	DRAWN -	REVISED -
PLOT SCALE = 0.1666667' / in.	CHECKED -	REVISED -
PLOT DATE = 12/26/2023	DATE -	REVISED -

**STATE OF ILLINOIS
DEPARTMENT OF TRANSPORTATION**

**TYPICAL CROSS SECTIONS
SOUTHBOUND LANES - US 51**

SCALE: NONE SHEET 1 OF 1 SHEETS STA. TO STA.

F.A.P. RTE.	SECTION	COUNTY	TOTAL SHEETS	SHEET NO.
322	D5 CM INLAY 2024-1	DEWITT	11	5
CONTRACT NO. 70H07				
ILLINOIS FED. AID PROJECT				

PAVING SCHEDULE

LOCATION								BITUMINOUS MATERIALS (TACK COAT) POUND	HOT MIX ASPHALT SURFACE REMOVAL 1 1/2" SQ YD	TEMPORARY RAMP SQ YD	LONGITUDINAL JOINT SEALANT FT	HOT MIX ASPHALT SURFACE CSE IL 9.5 MIX "D" N70 TON
US 51 SOUTHBOUND								0.05LBS PER SQFT				
STATION	TO	STATION	DESCRIPTION	LENGTH FT	WIDTH FT	AREA SQ FT	DEPTH INCH	40600290	44000155	40600990	40600370	40604062
1165+21.68		1200+55.70	406009850	3,534.02	12.00	42,408.24	1.50	2,120.41	4,712.03		3,534.02	395.81
1165+21.68		1165+26.68	PASSING LANE	5.00	12.00	6.67	1.50			6.67		
1200+50.70		1200+55.70	PASSING LANE	5.00	12.00	6.67	1.50			6.67		
1200+55.70		1201+07.70	S. N. 020-2005	52.00	41.50	2,158.00	1.50					20.14
1201+07.70		1231+50.00	PASSING LANE	3,042.30	12.00	36,507.60	1.50	1,825.38	4,056.40		3,042.30	340.74
1201+07.70		1201+12.70	PASSING LANE	5.00	12.00	6.67	1.50			6.67		
1231+45.00		1231+50.00	PASSING LANE	5.00	12.00	6.67	1.50			6.67		
1165+21.68		1200+55.70	DRIVING LANE	3,534.02	12.00	42,408.24	1.50	2,120.41	4,712.03			395.81
1165+21.68		1165+26.68	DRIVING LANE	5.00	12.00	6.67	1.50			6.67		
1200+50.70		1200+55.70	DRIVING LANE	5.00	12.00	6.67	1.50			6.67		
1201+07.70		1231+50.00	DRIVING LANE	3,042.30	12.00	36,507.60	1.50	1,825.38	4,056.40			340.74
1201+07.70		1201+12.70	DRIVING LANE	5.00	12.00	6.67	1.50			6.67		
1231+45.00		1231+50.00	DRIVING LANE	5.00	12.00	6.67	1.50			6.67		
TOTAL =								7,891.58	17,536.85	53.33	6,576.32	1,493.24
USE =								7,892.0	17,537.0	54.0	6,576.0	1,493.0

PAVEMENT MARKING SCHEDULE

LOCATION					SHORT TERM PAVEMENT MARKING FT	SHORT TERM PAVEMENT MARKING REMOVAL SQ FT	PAINT PAVEMENT MARKING 4" FT	RAISED REFLECTIVE PAVEMENT MARKER EACH
US 51 SOUTHBOUND					70300100	70300150	78001110	78100100
STATION	TO	STATION	DESCRIPTION	TYPE	WHITE		WHITE	YELLOW
1165+21.68		1231+50.00	CENTERLINE	SKIP-DASH	662.83	220.94	1,657.08	
1165+21.68		1182+51.10	EDGE LINE LT	SOLID				1,729.42
1182+51.10		1184+46.10	LT TURN LANE	SOLID			195.00	
1186+76.10		1211+63.32	EDGE LINE LT	SOLID				2,487.22
1211+63.32		1213+58.32	LT TURN LANE	SOLID			195.00	
1215+88.32		1231+50.00	EDGE LINE LT	SOLID				1,561.68
1165+21.68		1184+33.84	EDGE LINE RT	SOLID			1,912.16	
1186+63.84		1231+50.00	EDGE LINE RT	SOLID			4,486.16	
TOTAL =					662.83	220.94	8,445.40	5,778.32
USE =					663.0	221.0	14,224.0	83.0

MODEL: Schedules [Sheet]
 FILE NAME: c:\p\work\wtd\p\person\br\0948896\0570107_Sht-Schedules.dgn

USER NAME = Bridgette.Pierson	DESIGNED -	REVISED -
	DRAWN -	REVISED -
PLOT SCALE = 0.1666667 / in.	CHECKED -	REVISED -
PLOT DATE = 12/26/2023	DATE -	REVISED -

**STATE OF ILLINOIS
DEPARTMENT OF TRANSPORTATION**

SCHEDULE OF QUANTITIES

SCALE: NONE SHEET 1 OF 1 SHEETS STA. TO STA.

F.A.P. RTE.	SECTION	COUNTY	TOTAL SHEETS	SHEET NO.
322	D5 CM INLAY 2024-1	DEWITT	11	6
CONTRACT NO. 70H07				
ILLINOIS FED. AID PROJECT				

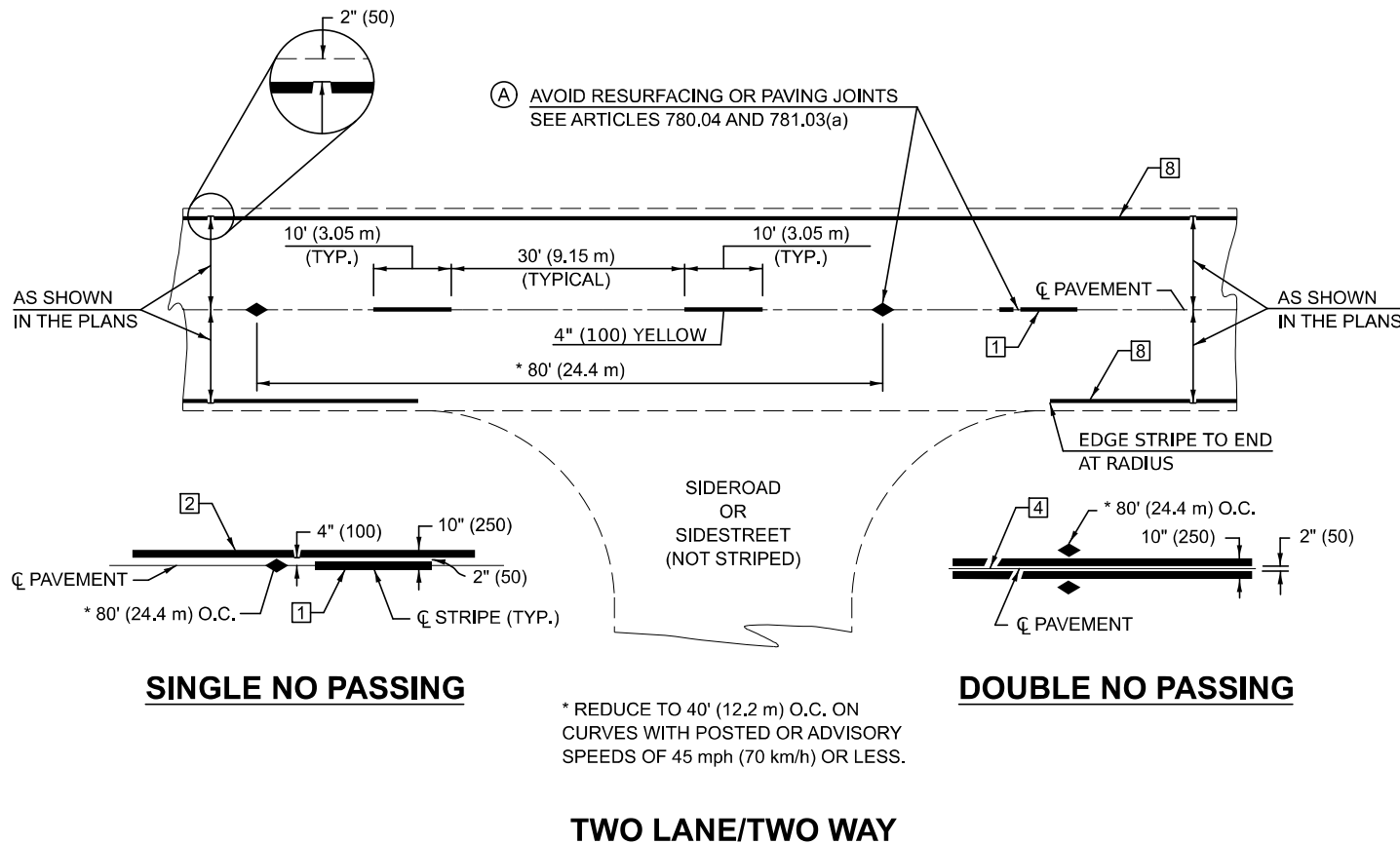

TYPICAL PAVEMENT MARKING LENGEND

- 1 4" (100) SKIP-DASH (YELLOW)
- 2 4" (100) SOLID (YELLOW)
- 3 12" (300) DIAGONAL (YELLOW)
- 4 4" (100) DOUBLE YELLOW (NARROW)
- 5 RESERVED
- 6 RESERVED
- 7 4" (100) SKIP-DASH (WHITE)
- 8 4" (100) SOLID (WHITE)
- 9 12" (300) DIAGONAL (WHITE)
- 10 6" (150) SOLID (WHITE)
- 11 24" (600) STOP BAR (WHITE)
- 12 8" (200) SOLID (WHITE)
- 13 4" (100) LANE LINE EXTENSIONS (WHITE)
- 14 4" (100) PARKING WHITE

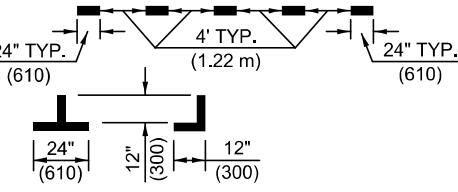
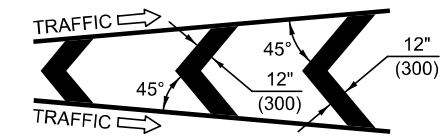
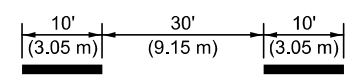
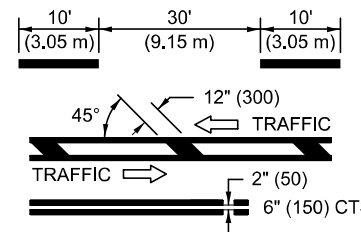

TYPICAL PAVEMENT MARKERS LENGEND

- ◆ TWO-WAY AMBER MARKER
- ▶ ONE-WAY AMBER MARKER
- ▷ ONE-WAY CRYSTAL MARKER

RURAL LEFT TURN

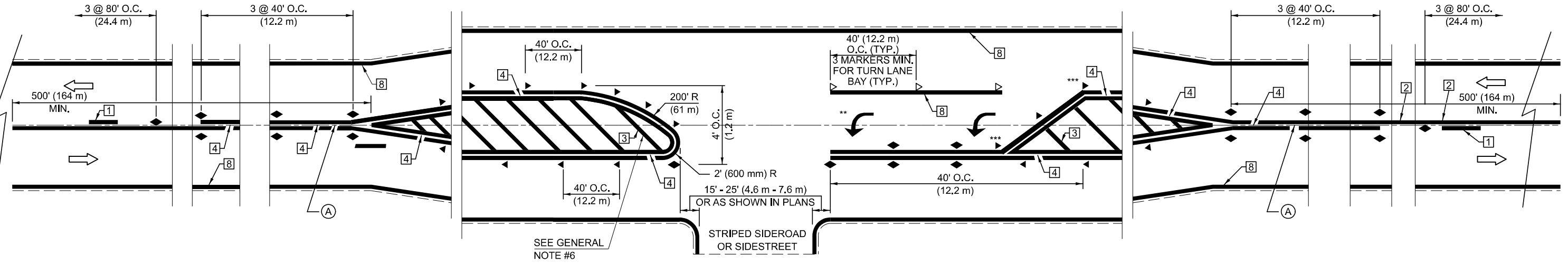

*** REDUCE SPACING IF NECESSARY TO ASSURE MARKERS AT CORNER POINTS.

** TURN ARROWS SHALL BE PLACED AS SHOWN OF SHEET #2.

Note: All dimensions are in INCHES (millimeters) unless otherwise shown.

DISTRICT 5 DETAIL NO. 7800AAAA

MODEL: SHT_PLAN
FILE NAME: C:\Bentley\CONNECT1011\Organization\Civil\DOT_Standards\Civil\DOT_Sheets.ctb

USER NAME = Eric.Thomas	DESIGNED -	REVISED - 4/2014 JLA
	DRAWN -	REVISED - 3/2019 SWN
PLOT SCALE = 0.1666600' / in.	CHECKED -	REVISED - 8/2022 JLA
PLOT DATE = 12/7/2022	DATE -	REVISED - 9/2022 JWS

**STATE OF ILLINOIS
DEPARTMENT OF TRANSPORTATION**

**PAVEMENT MARKING AND MARKERS
(RURAL & URBAN APPLICATIONS)**

SCALE: 1"=50' SHEET 1 OF 4 SHEETS STA. TO STA.

F.A.P. RTE.	SECTION	COUNTY	TOTAL SHEETS	SHEET NO.
322	D5 CM INLAY 2024-1	DEWITT	11	7
CONTRACT NO. 70H07				
ILLINOIS FED. AID PROJECT				

GENERAL NOTES

1. WHEN MEDIANS ARE PRESENT, PAVEMENT MARKINGS ARE TO BE PLACED ADJACENT TO MEDIANS.
2. SOME OF THE INFORMATION INCLUDED WITH THIS DETAIL MAY NOT BE APPLICABLE TO THIS IMPROVEMENT.
3. PAVEMENT MARKINGS ARE TO BE EXTENDED THROUGH OMISSIONS WHEN APPLICABLE.
4. A STRIPING KEY IS AVAILABLE ELSEWHERE AND SHALL BE SHOWN WHERE THE QUANTITIES ARE LISTED.
5. FINAL PAVEMENT MARKINGS SHALL BE IN PLACE PRIOR TO PLACING ANY RAISED REFLECTIVE PAVEMENT MARKERS.
6. THE FOLLOWING CRITERIA SHALL BE USED FOR SELECTING THE DIAGONAL PAVEMENT MARKING SPACING,
 - <30 MPH USE 15' (<50 km/h USE 4.5 m)
 - 30-45 MPH USE 20' (50-75 km/h USE 6.0 m)
 - >45 MPH USE 30' (>75 km/h USE 9.0 m)

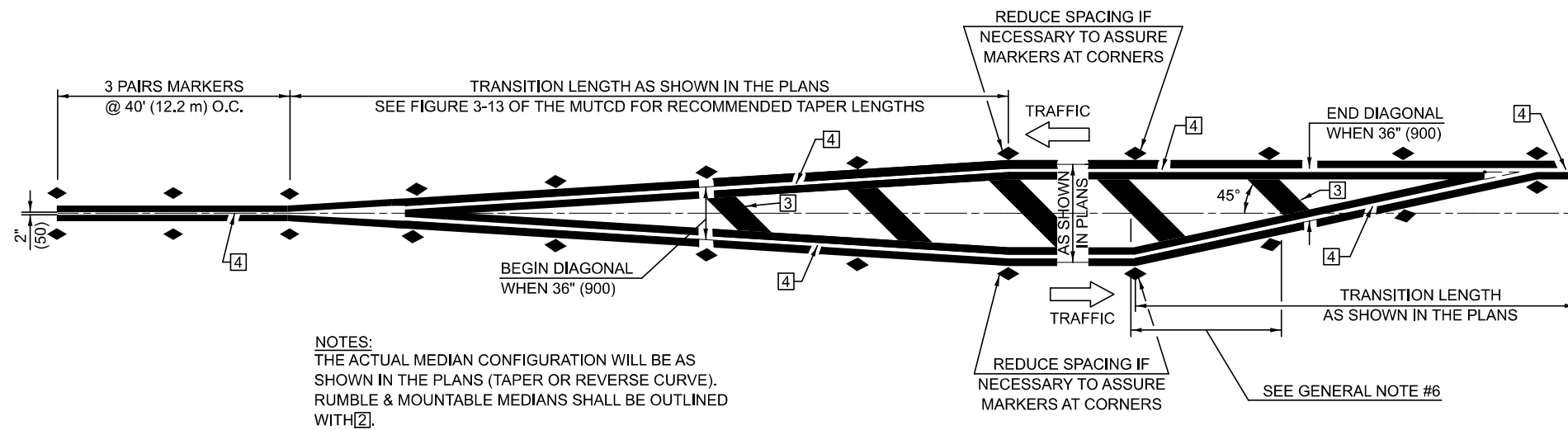

NOTES:
THE ACTUAL MEDIAN CONFIGURATION WILL BE AS SHOWN IN THE PLANS (TAPER OR REVERSE CURVE). RUMBLE & MOUNTABLE MEDIANS SHALL BE OUTLINED WITH [2].

TYPICAL MEDIAN TRANSITIONS

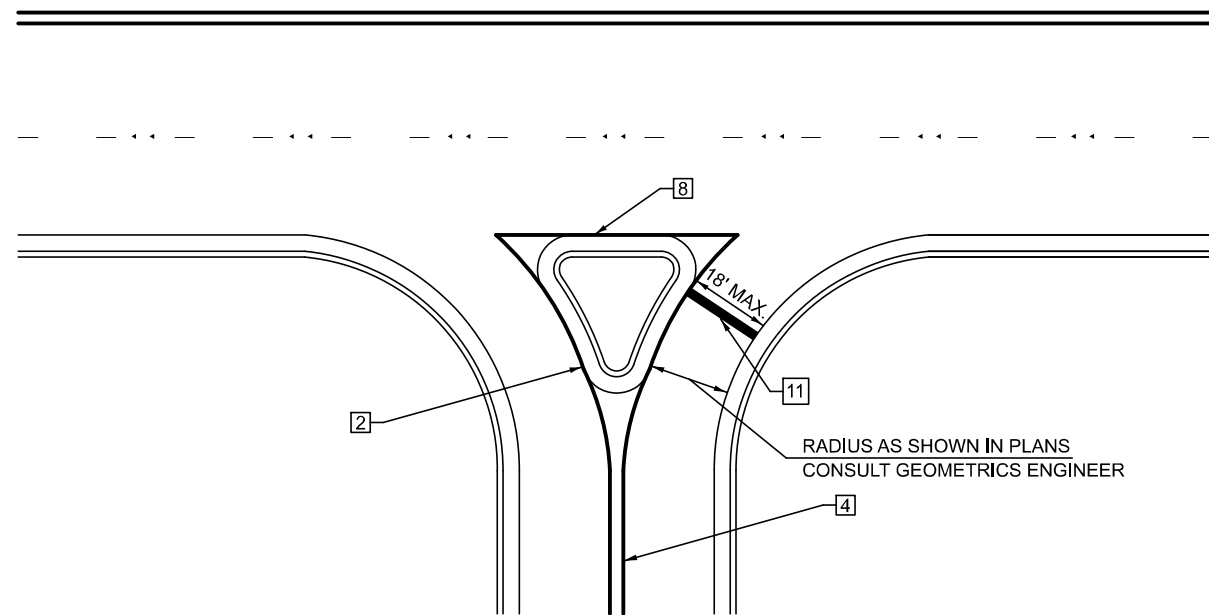

RIGHT IN - RIGHT OUT ACCESS

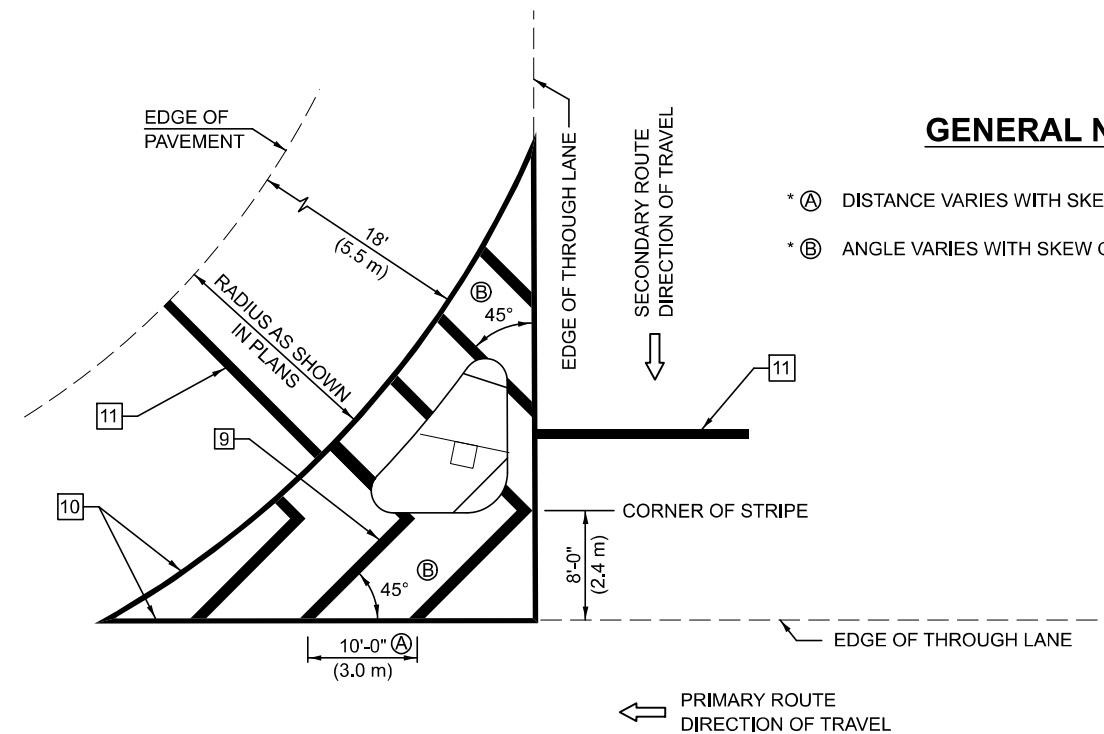

GENERAL NOTES

- * (A) DISTANCE VARIES WITH SKEW OF INTERSECTION.
- * (B) ANGLE VARIES WITH SKEW OF INTERSECTION.

ISLAND

* FOR RIGHT TURN LANE AND ISLAND STRIPING CONSULT GEOMETRICS ENGINEER.

Note: All dimensions are in INCHES (millimeters) unless otherwise shown.

DISTRICT 5 DETAIL NO. 7800AAAA

USER NAME = Eric.Thomas	DESIGNED -	REVISED - 4/2014 JLA
	DRAWN -	REVISED - 3/2019 SWN
PLOT SCALE = 0.16666600' / in.	CHECKED -	REVISED - 8/2022 JLA
PLOT DATE = 12/7/2022	DATE -	REVISED - 9/2022 JWS

STATE OF ILLINOIS
DEPARTMENT OF TRANSPORTATION

PAVEMENT MARKING AND MARKERS
(RURAL & URBAN APPLICATIONS)

SCALE: 1"=50' SHEET 3 OF 4 SHEETS STA. TO STA.

F.A.P. RTE.	SECTION	COUNTY	TOTAL SHEETS	SHEET NO.
322	D5 CM INLAY 2024-1	DEWITT	11	9
CONTRACT NO. 70H07				

ILLINOIS FED. AID PROJECT

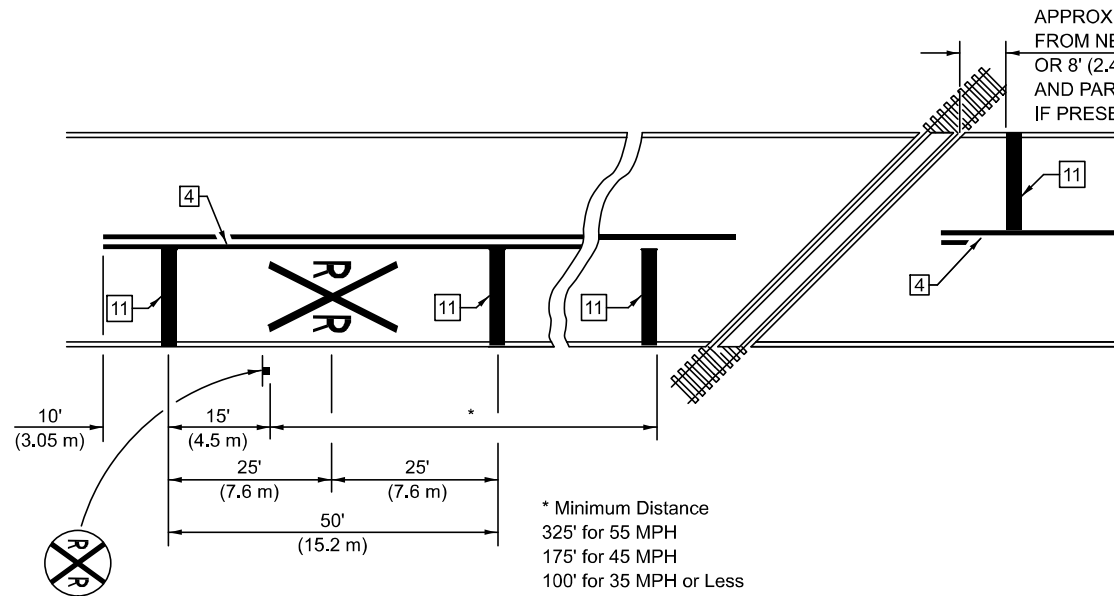

PAVEMENT MARKINGS AT RAILROAD-HIGHWAY GRADE CROSSING

RAILROAD CROSSING WITH INTERCONNECT ONLY

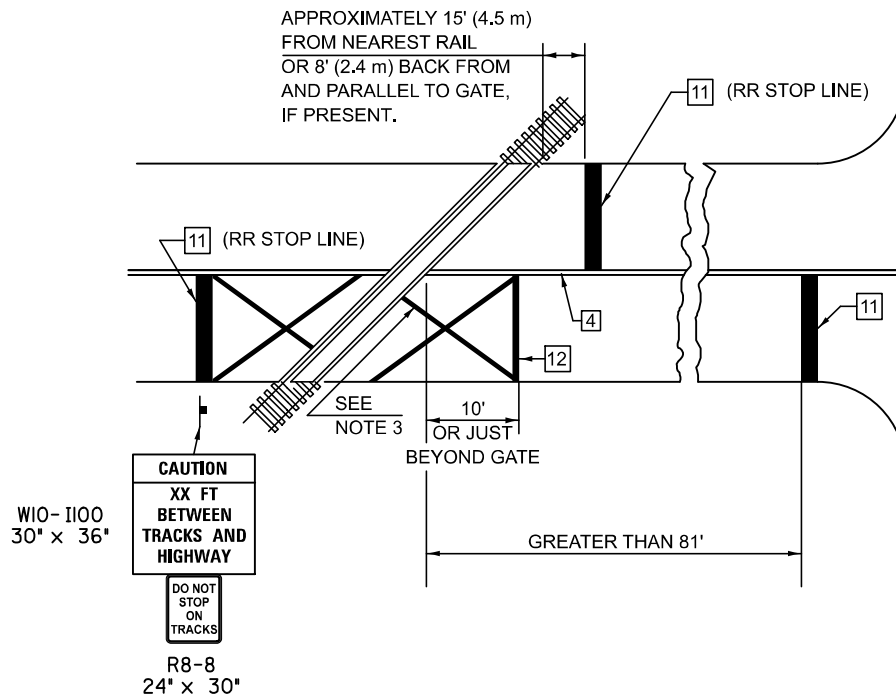

RAILROAD CROSSING WITH INTERCONNECT AND PRE-SIGNALS

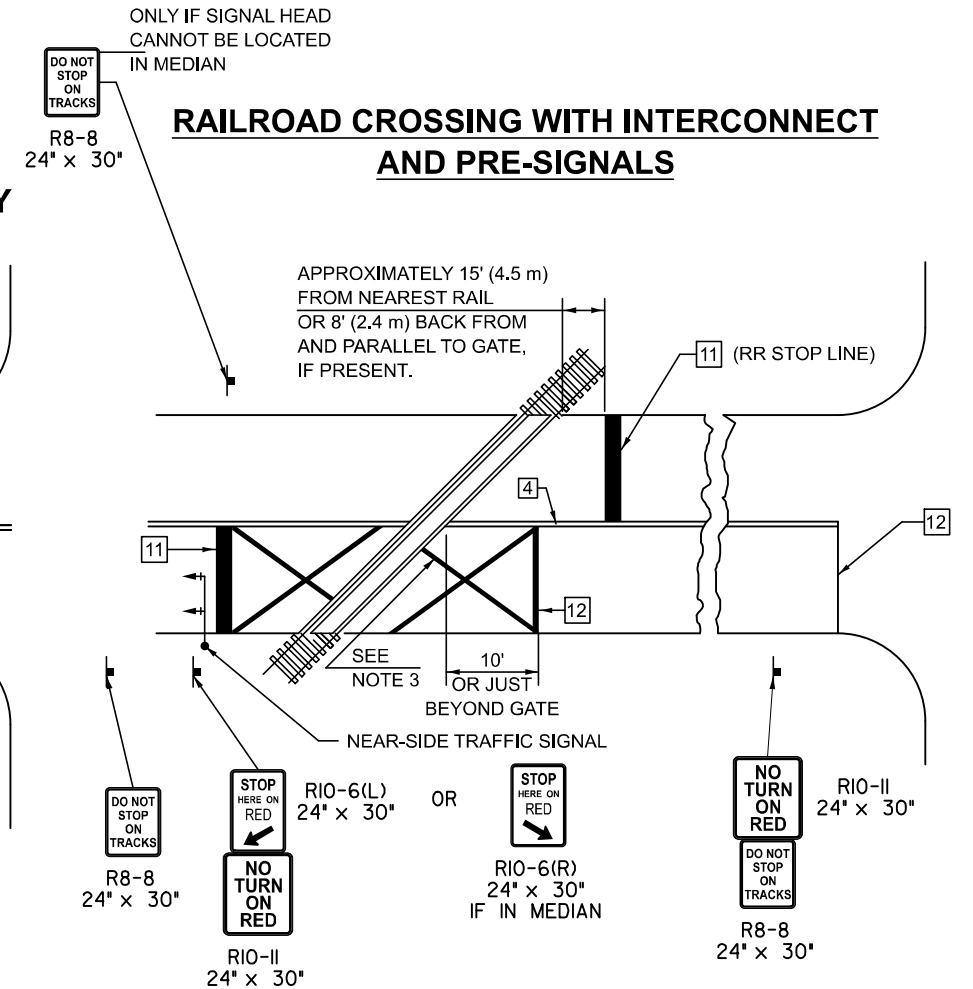

GENERAL NOTES

1. SUPPLEMENTAL PAVEMENT MARKINGS TO BE INSTALLED ONLY ON APPROACHES TO INTERSECTIONS CONTROLLED BY TRAFFIC SIGNALS WHICH ARE INTERCONNECTED WITH THE RAILROAD WARNING SIGNALS.
2. EXTEND PAVEMENT MARKINGS TO THE INTERSECTION ONLY WHERE NEAR-SIDE TRAFFIC SIGNALS ARE USED.
3. 6" WHITE PAVEMENT MARKINGS AT 45° TO PAVEMENT, 8' CENTER TO CENTER.
4. XX DISTANCE TO BE SHOWN ON SIGN MEASURED FROM A POINT 6 FEET FROM THE RAIL CLOSEST TO THE INTERSECTION OR FROM THE CLOSEST POINT ALONG THE EXIT GATE IF PRESENT OVER THE ROADWAY WHEN IN THE LOWERED POSITION TO THE STOP BAR OR CROSSWALK, WHICH EVER IS CLOSEST, ROUNDED DOWN TO NEAREST 5 FEET. WHERE THERE IS NO STOP LINE, MEASURE TO POINT WHERE DRIVER HAS A VIEW OF APPROACHING TRAFFIC.
5. THE CLEARANCE SIGN IS ALSO TO BE USED AS AN INTERIM MEASURE AT LOCATIONS WITH INTERCONNECTED INTERSECTION TRAFFIC SIGNALS WHERE IT IS PLANNED TO CHANGE THEM TO NEAR-SIDE SIGNALS AT A FUTURE TIME. IN THIS CASE, THE DISTANCE TO BE SHOWN ON THE SIGN IS MEASURED FROM THE EDGE OF THE STRIPED-OUT AREA INSTEAD OF 6 FEET FROM THE RAIL. THE SIGN IS TO BE REMOVED WHEN THE NEAR-SIDE SIGNALS ARE INSTALLED AND THE PAVEMENT MARKINGS EXTENDED TO THE INTERSECTION.

SUPPLEMENT PAVEMENT MARKING TREATMENT FOR RAILROAD-HIGHWAY GRADE CROSSING

ALTERNATE SIGNS



NOTES

THE TRAVERSE SPREAD OF THE "X" MAY VARY ACCORDING TO LANE WIDTH.

ON MULTI-LANE ROADS, THE STOP LINES SHALL EXTEND ACROSS ALL APPROACH LANES AND SEPARATE RXR SYMBOLS SHALL BE PLACED ADJACENT TO EACH OTHER IN EACH LANE.

WHEN THE PAVEMENT MARKING SYMBOL IS USED, A PORTION OF THE SYMBOL SHOULD BE LOCATED DIRECTLY ADJACENT TO THE ADVANCE WARNING SIGN (W10-1) AS PLACED BY TABLE II-1, CONDITION B OF THE MUTCD.

Note: All dimensions are in INCHES (millimeters) unless otherwise shown.

DISTRICT 5 DETAIL NO. 7800AAAA

F.A.P. RTE.	SECTION	COUNTY	TOTAL SHEETS	SHEET NO.
322	D5 CM INLAY 2024-1	DEWITT	11	10
				CONTRACT NO. 70H07

**STATE OF ILLINOIS
DEPARTMENT OF TRANSPORTATION**

**PAVEMENT MARKING AND MARKERS
(RURAL & URBAN APPLICATIONS)**

SCALE: 1"=50' SHEET 4 OF 4 SHEETS STA. TO STA.

USER NAME = Eric.Thomas	DESIGNED -	REVISED - 4/2014 JLA
	DRAWN -	REVISED - 3/2019 SWN
PLOT SCALE = 0.16666600' / in.	CHECKED -	REVISED - 8/2022 JLA
PLOT DATE = 12/7/2022	DATE -	REVISED - 9/2022 JWS

Existing Structure 020-2005 was built in 1979 as Section 53BR at Sta. 108+78.60 in Dewitt County. The structure is a 4 @ 12'x9'-3"x41'-6" RCBC carrying F.A.P. 322 (US 51 SB) over Ten Mile Creek 1.5 miles south of Wapella.

Work shall be completed with stage construction.

GENERAL NOTES

Plan dimensions and details relative to existing structure have been taken from existing plans and are subject to nominal construction variations. It shall be the Contractor's responsibility to verify such dimensions and details in the field and make necessary approved adjustments prior to construction or ordering of materials. Such variations shall not be cause for additional compensation for a change in the scope of the work, however, the Contractor will be paid for the quantity actually furnished at the unit price bid for the work.

Deck Slab Repair (Partial) has been estimated at 10%. The Engineer shall determine need and locations as necessary.

See Special Provision "Deck Slab Repair" for requirements of deck slab repair and hma surface removal (deck).

SCOPE OF WORK

1. Remove existing HMA (+/- 1 1/2") from Top Slab to limits shown.
2. Perform Deck Slab Repair (Partial) as necessary.
3. Place Waterproofing Membrane System on Top Slab to limits shown.
5. Place proposed HMA (+/- 1 1/2") on Top Slab to limits shown.

TOTAL BILL OF MATERIAL

ITEM	UNIT	TOTAL
HMA Surface Removal (Deck)	Sq. Yd.	230.0
Waterproofing Membrane System	Sq. Yd.	230.0
HMA Surface Course, IL-9.5, Mix D, N70	Ton	20.0
Deck Slab Repair (Partial)	Sq. Yd.	23.0



EXPIRES 11-30-2024

Jayme F. Schuff

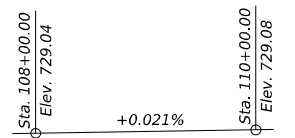

PROFILE GRADE

S.N. 020-2005
F.A.P. RTE. 322 (U.S. 51)
OVER TEN MILE CREEK
SECTION 53BR
DEWITT COUNTY
STATION 108+78.60

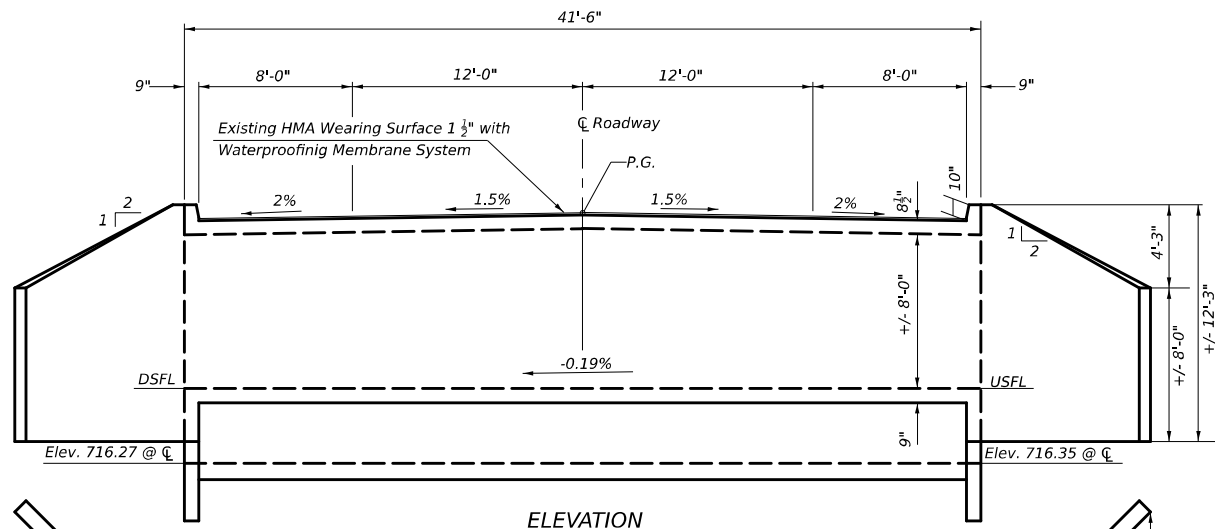

ELEVATION

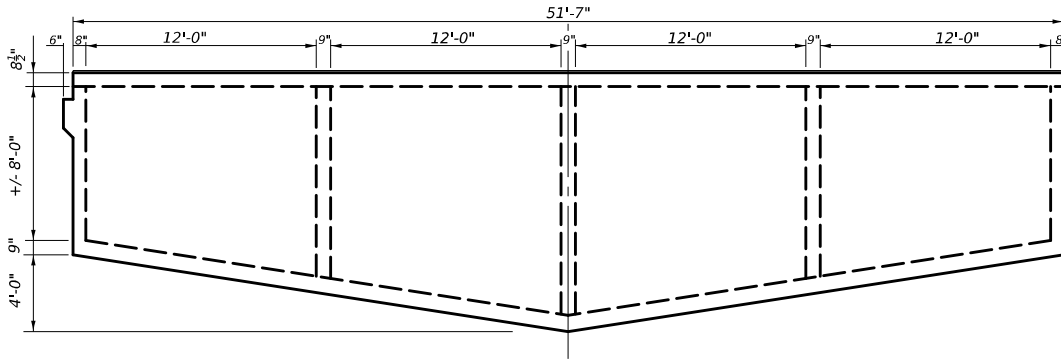

SECTION THRU BARREL

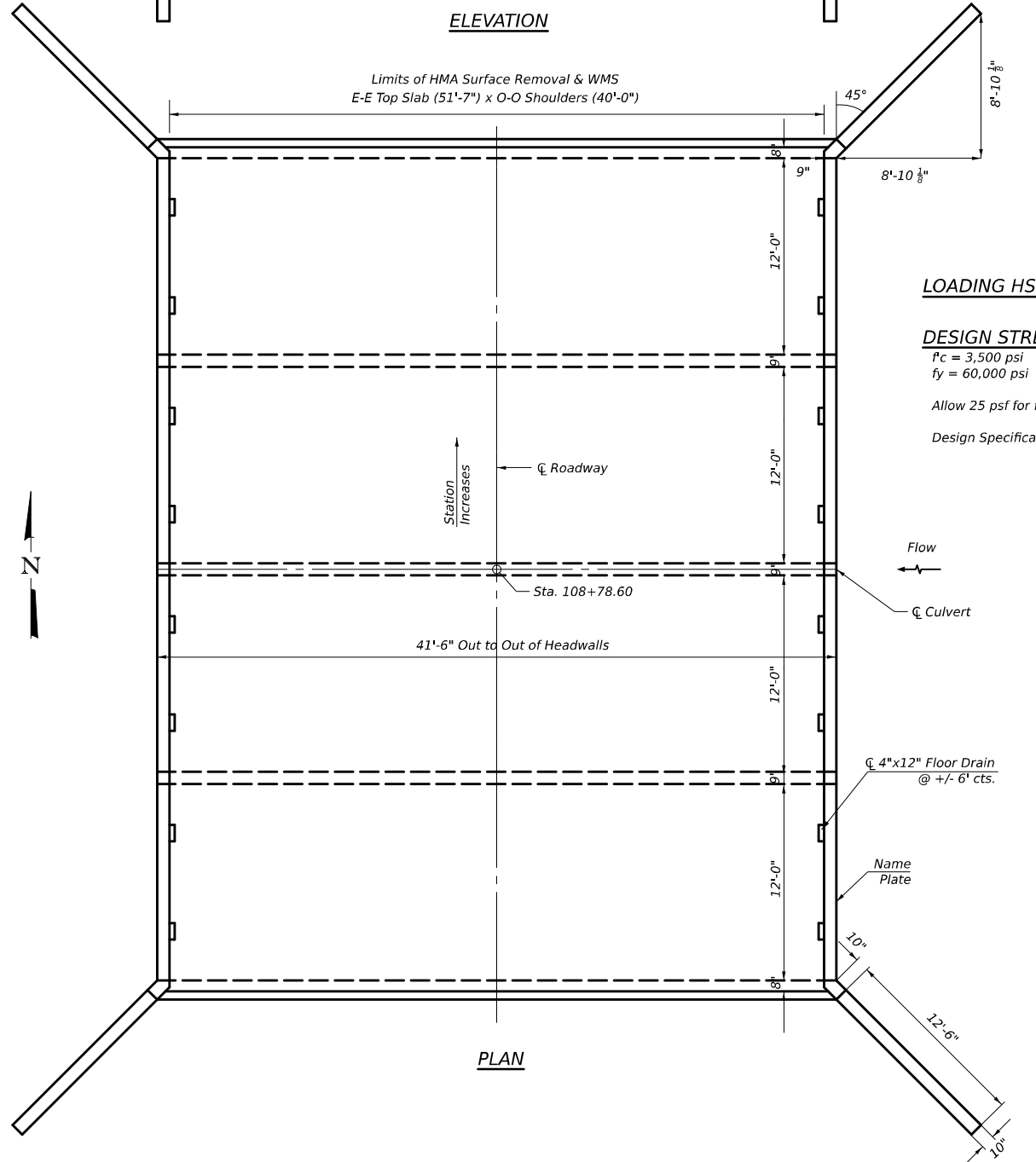

PLAN

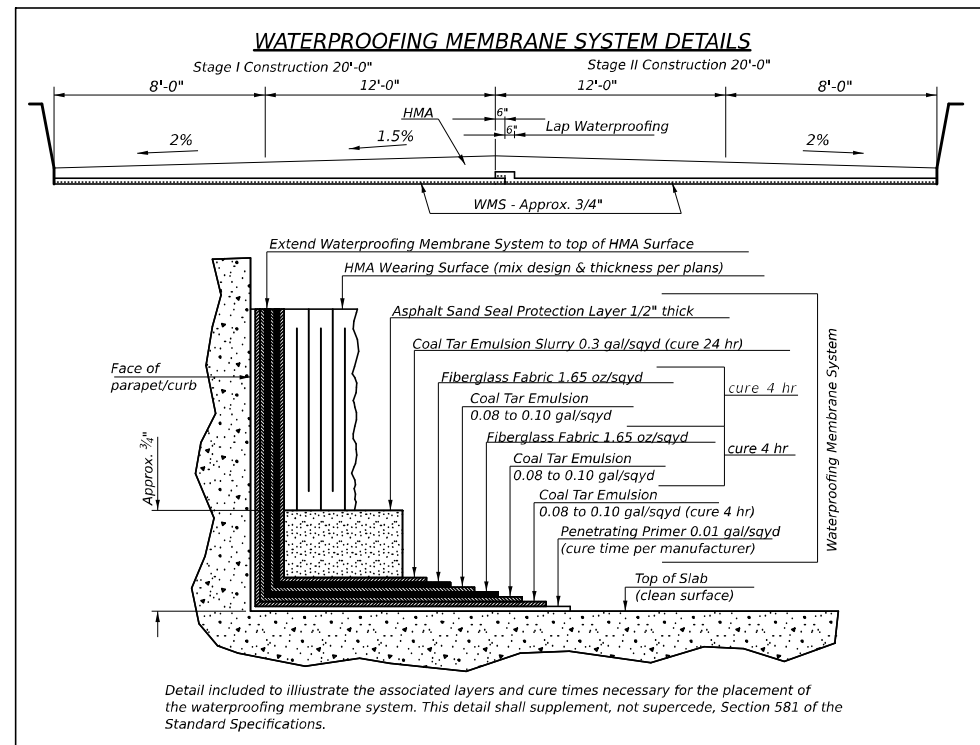

Detail included to illustrate the associated layers and cure times necessary for the placement of the waterproofing membrane system. This detail shall supplement, not supercede, Section 581 of the Standard Specifications.

MODEL: General Plan Elevation Detail SN 092-2021 - Copy#2 (Sheet)
 FILE NAME: c:\pwworking\dwg\pierson\0348307\057\0107-0202005-Details.dgn

USER NAME = Bridgette.Pierson	DESIGNED - TJB	REVISED -
PLOT SCALE = 0.1666667' / in.	CHECKED -	REVISED -
PLOT DATE = 12/26/2023	DATE - 12/19/2023	REVISED -

STATE OF ILLINOIS
DEPARTMENT OF TRANSPORTATION

GENERAL PLAN, ELEVATION & DETAILS
S.N. 020-2005

SCALE: NONE SHEET 1 OF 1 SHEETS STA. TO STA.

F.A.P. RTE.	SECTION	COUNTY	TOTAL SHEETS	SHEET NO.
322	D5 CM INLAY 2024-1	DEWITT	11	11
CONTRACT NO. 70H07				
ILLINOIS FED. AID PROJECT				