

SECTION	COUNTY	TOTAL SHEETS	SHEET NO.
21-00080-00-SW	CASS	35	1
ILLINOIS		CONTRACT NO. 93819	

CONTRACT NO. 93819

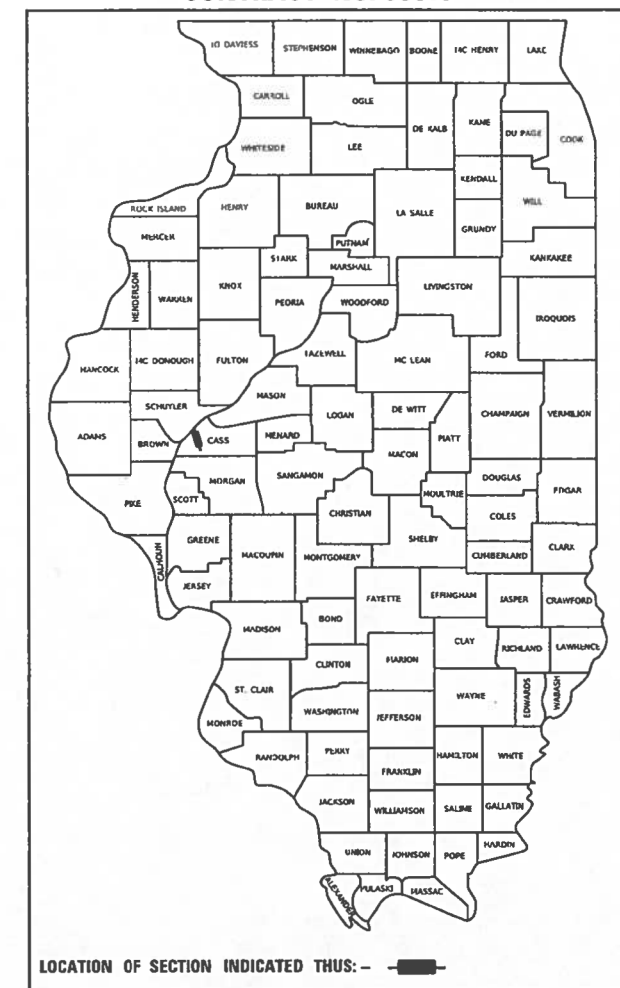

LOCATION OF SECTION INDICATED THIS: - [shaded box] -

DESCRIPTION OF WORK
 THIS PROJECT SHALL CONSIST OF BUILDING A HMA/PCC MULTI-USE PATH ALONG 15TH STREET FROM SANGAMON STREET ROW TO CANAL STREET, AND SANGAMON STREET FROM 15TH STREET TO SCHMOLDT PARK. THIS PROJECT SHALL ALSO INCLUDE CURB AND GUTTER, INLET AND STORM SEWER IMPROVEMENTS, SEEDING, STRIPING, SIGNING, AND ASSOCIATED WORK.

STATE OF ILLINOIS DEPARTMENT OF TRANSPORTATION PLANS FOR PROPOSED ILLINOIS TRANSPORTATION ENHANCEMENT PROGRAM CITY OF BEARDSTOWN, ILLINOIS SANGAMON, & 15TH STREETS MULTI-USE PATH

**SECTION 21-00080-00-SW
 TRAIL PROJECT
 JOB NO. C-96-050-24**

INDEX OF SHEETS

- 1 COVER
- 2 GENERAL NOTES, BOLLARD DETAIL, & HIGHWAY STANDARDS
- 3 TYPICAL SECTIONS
- 4-6 SUMMARY OF QUANTITIES
- 7-8 SCHEDULES OF QUANTITIES
- 9 ALIGNMENT AND BENCHMARKS
- 10-19 PLAN AND PROFILE
- 20-34 SIDEWALK RAMP DETAILS
- 35 DRAINAGE DETAILS

GAS & ELECTRIC
 AMEREN CIPS
 104 EAST 3rd ST
 BEARDSTOWN, IL 62618

COMMUNICATIONS
 AT&T COMMUNICATIONS
 1000 COMMERCE DRIVE
 OAK BROOK, IL 60523

WATER & SEWER
 CITY OF BEARDSTOWN
 CITY HALL
 105 WEST 3rd ST
 BEARDSTOWN, IL 62618

METRO COMMUNICATIONS
 8 S WASHINGTON ST
 SULLIVAN, IL 61951

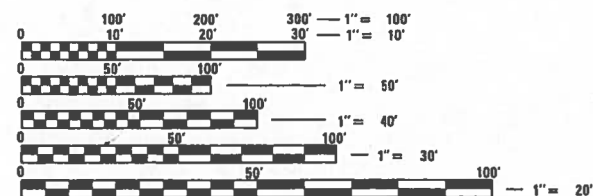
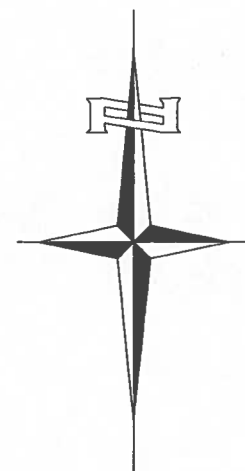

FULL SIZE PLANS HAVE BEEN PREPARED USING STANDARD ENGINEERING SCALES. REDUCED SIZED PLANS WILL NOT CONFORM TO STANDARD SCALES. IN MAKING MEASUREMENTS ON REDUCED PLANS, THE ABOVE SCALES MAY BE USED.

J.U.L.I.E.
 JOINT UTILITY LOCATION INFORMATION FOR EXCAVATORS
 1-800-892-0123
 OR 811

PROJECT MANAGER:
M. BRIAN BORGMAN, P.E.
HUTCHISON ENGINEERING, INC.
JACKSONVILLE, ILLINOIS

GROSS LENGTH (15TH STREET) = 532.72 FT. = 0.101 MILE
 GROSS LENGTH (SANGAMON STREET) = 4,501.14 FT. = 0.853 MILE
 GROSS LENGTH (TOTAL) = 5,038.86 FT. = 0.954 MILE
 NET LENGTH (15TH STREET) = 532.72 FT. = 0.101 MILE
 NET LENGTH (SANGAMON STREET) = 4,501.14 FT. = 0.853 MILE
 NET LENGTH (TOTAL) = 5,038.86 FT. = 0.954 MILE

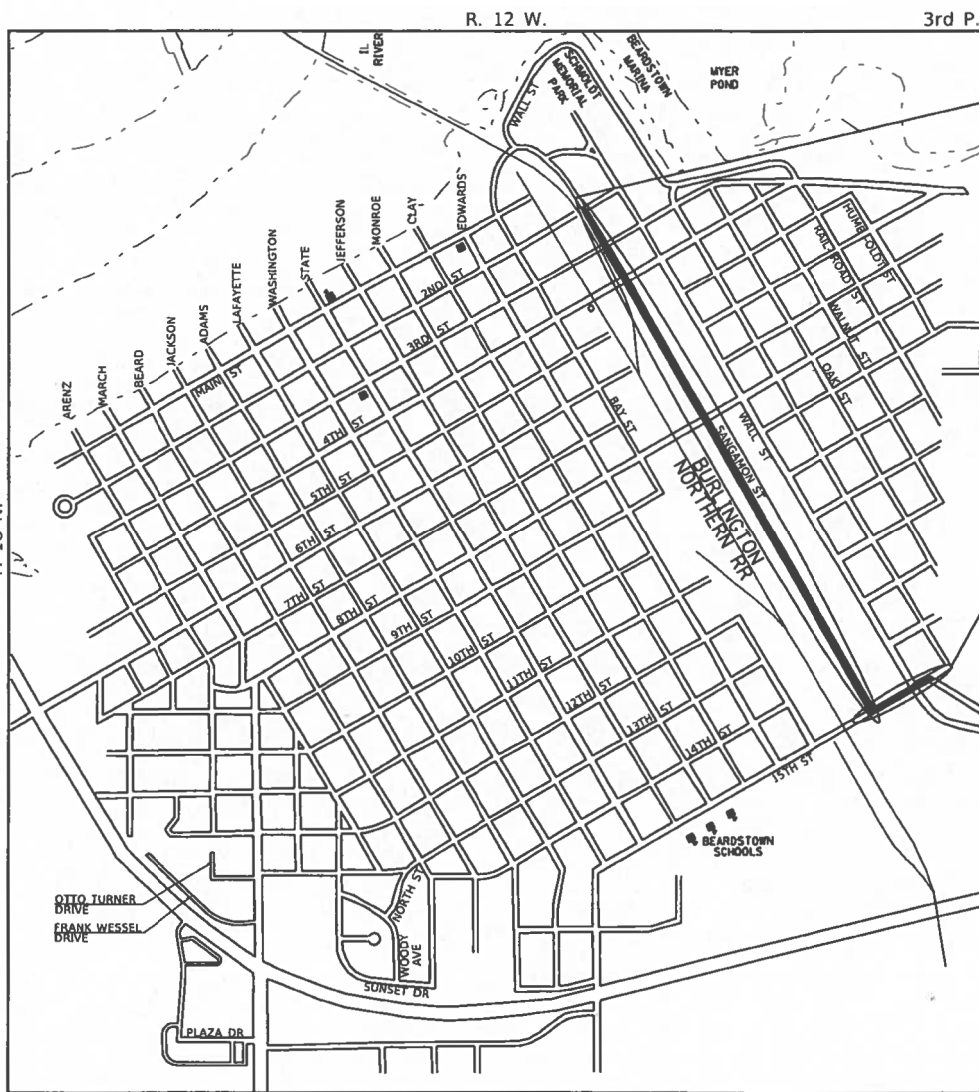
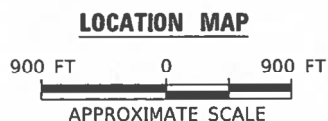

SANGAMON STREET
 BEGINS
 STATION 330+91.28
 ENDS
 STATION 375+97.42

15TH STREET
 BEGINS
 STATION 124+49.91
 ENDS
 STATION 129+82.63

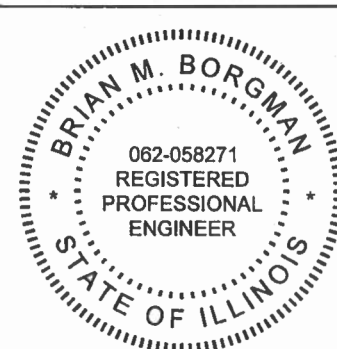

Brian Borgman
 SIGNATURE DATE 02/26/2024
 ENGINEER'S SEAL EXPIRES 11/30/2025

APPROVED February 29, 2024
Janeth M. Harris
 MAYOR - CITY OF BEARDSTOWN

PASSED March 5, 2024
Brian Borgman
 DISTRICT SIX ENGINEER OF LOCAL ROADS & STREETS

RELEASING FOR BID BASED ON LIMITED REVIEW March 5, 2024
John P. Moore
 REGION 4 ENGINEER - ILLINOIS DEPT OF TRANSPORTATION

GENERAL NOTES

1. THE LOCATION OF UNDERGROUND UTILITIES SHOWN ON THE PLANS REPRESENTS THE BEST KNOWLEDGE OF THE CITY AND THE INDICATED ADJUSTMENTS OR RECONSTRUCTION ARE CONSIDERED TO BE REASONABLY ACCURATE. IT SHALL BE THE CONTRACTORS RESPONSIBILITY TO VERIFY LOCATIONS OF UNDERGROUND INSTALLATIONS BEFORE STARTING CONSTRUCTION OPERATIONS. THE CONTRACTOR SHALL INDEMNIFY THE CITY, ITS OFFICERS, AND EMPLOYEES AGAINST ALL CLAIMS DUE TO DAMAGE TO CORPORATE OR PRIVATE PROPERTY RESULTING FROM HIS CONSTRUCTION OPERATIONS AS DESCRIBED IN ARTICLE 107.20 AND 107.26 OF THE STANDARD SPECIFICATIONS FOR ROAD AND BRIDGE CONSTRUCTION.
2. THE CONTRACTOR MAY BE REQUIRED TO CONDUCT SOME OF HIS PAVING, GRADING AND SHOULDER OPERATIONS AROUND TRANSMISSION POLES AND UNDER TRANSMISSION LINES. THE ADDED COST OF SO DOING SHALL BE INCLUDED WITH THE COST OF THE CONTROLLING PAY ITEM FOR THE OPERATION.
3. EXISTING CONCRETE BASES AND OTHER MISCELLANEOUS CONCRETE FROM WORK NOT SPECIFICALLY SHOWN ON THE PLANS, BUT INTERFERING WITH PROPOSED CONSTRUCTION, SHALL BE REMOVED AND VOID FILLED WITH TRENCH BACKFILL. ALL COSTS ASSOCIATED WITH THIS WORK SHALL BE INCLUDED IN THE COST OF THE CONTROLLING PAY ITEM FOR THE OPERATION.
4. WHERE SECTION OR SUB-SECTION MONUMENTS ARE ENCOUNTERED, THE ENGINEER SHALL BE NOTIFIED BEFORE SUCH MONUMENTS ARE REMOVED. THE CONTRACTOR SHALL PROTECT AND PRESERVE PROPERTY MARKERS AND MONUMENTS UNTIL THE OWNER, AN AUTHORIZED SURVEYOR OR AGENT HAS WITNESSED OR OTHERWISE REFERENCED THEIR LOCATION.
5. WHEREVER IN THESE PLANS REFERENCE IS MADE TO THE "STANDARD SPECIFICATIONS", IT IS UNDERSTOOD TO INCLUDE THE "SUPPLEMENTAL SPECIFICATIONS" INCLUDED IN THE PROPOSAL.
6. ALL ELEVATIONS SHOWN REFER TO THE U.S.G.S. DATUM AT MEAN SEA LEVEL.
7. THE CONTRACTOR WILL BE REQUIRED TO COMPLY WITH ALL STATE REGULATIONS REGARDING AIR, WATER AND NOISE POLLUTION. THE CONTRACTOR WILL NOT BE ALLOWED TO BUILD FIRES ON THE SITE.
8. IT IS THE CONTRACTOR'S RESPONSIBILITY TO ASCERTAIN EXISTING FIELD CONDITIONS BEFORE BIDDING ON THIS PROJECT, SPECIFICALLY AS THEY RELATE TO THE LUMP SUM PAY ITEMS.
9. THE CONTRACTOR SHALL NOTIFY THE AGENCIES AND UTILITIES AT LEAST 10 (TEN) DAYS PRIOR TO ANY CONSTRUCTION IN THE AREA AND SHALL COMPLY WITH ALL RESTRICTIONS FOR EQUIPMENT MOVEMENTS AND CLEARANCES AS REGARDS TO THEIR FACILITIES.
10. BEFORE STARTING ANY EXCAVATION, THE CONTRACTOR MUST CALL J.U.L.I.E. AT 1-800-892-0123 OR 811 FOR FIELD LOCATIONS OF BURIED ELECTRICAL, TELEPHONE, GAS FACILITIES, AND ALL PUBLIC UTILITIES. A 48 HOUR NOTIFICATION IS REQUIRED.
11. THE CONTRACTOR SHALL USE ALL NECESSARY PRECAUTIONS AND PROTECTIVE MEASURES REQUIRED TO MAINTAIN EXISTING UTILITIES, SEWER AND APPURTENANCES THAT MUST BE KEPT IN OPERATION. IN PARTICULAR, THE CONTRACTOR WILL TAKE ADEQUATE MEASURES TO PREVENT THE UNDERMINING OF UTILITIES AND SEWERS WHICH ARE STILL IN SERVICE.
12. VERIFICATION OF DIMENSIONS: IT IS THE CONTRACTOR'S RESPONSIBILITY TO VERIFY ALL DIMENSIONS AND CONDITIONS EXISTING IN THE FIELD PRIOR TO CONSTRUCTION AND ORDERING MATERIALS.
13. THE CONTRACTOR SHALL BE REQUIRED TO PROVIDE ACCESS TO ABUTTING PROPERTY OWNERS AT ALL TIMES DURING CONSTRUCTION OF THE PROJECT.
14. DURING CONSTRUCTION OPERATIONS, IF ANY LOOSE MATERIAL IS DEPOSITED IN THE FLOW LINE OF DITCHES, GUTTERS OR DRAINAGE STRUCTURES SO THAT THE NATURAL FLOW OF WATER IS OBSTRUCTED, IT SHALL BE REMOVED AT THE CLOSE OF EACH WORKING DAY. AT THE CONCLUSION OF CONSTRUCTION OPERATIONS, ALL DRAINAGE STRUCTURES SO AFFECTED SHALL BE FREE FROM ALL DEBRIS. THIS WORK SHALL BE CONSIDERED INCLUDED IN THE COST OF THE CONTRACT.
15. ALL FRAMES, GRATES, SIGNS, FENCES AND DELINEATORS, DRIVEWAY PAVEMENT, CURB AND GUTTER, NEW OR EXISTING, DAMAGED THROUGH CONTRACTOR'S NEGLIGENCE DURING CONSTRUCTION SHALL BE REPLACED BY THE CONTRACTOR AT HIS EXPENSE.
16. THE COST OF ADDITIONAL LABOR AND MATERIALS NOT ACCOUNTED FOR ON THE PLANS, WHICH MIGHT BE INVOLVED IN MAINTAINING THE FLOW OF STORM WATER TO EXISTING DRAINAGE STRUCTURES, SHALL BE INCLUDED IN THE COST OF THE CONTROLLING PAY ITEM FOR THE OPERATION.
17. TRAFFIC SIGNS REMOVED MUST BE RESET AT THEIR PERMANENT LOCATIONS IN A WORKMANLIKE MANNER AND VISIBLE TO TRAFFIC ON THE ROADWAY AS DIRECTED BY THE ENGINEER. THESE SIGNS SHALL BE RESET BEFORE THE ROADWAY IS OPEN TO TRAFFIC. COST OF SUCH WORK SHALL BE CONSIDERED INCLUDED IN THE COST OF THE CONTRACT.
18. ALL STATION AND OFFSET CALL-OUTS IN THESE PLANS THAT ARE MADE IN REFERENCE TO THE LOCATION OF DRAINAGE STRUCTURE ARE UNDERSTOOD TO BE TAKEN AT THE MIDDLE OF THE STRUCTURE ALONG THE FACE OF THE CURB FOR THOSE IN THE CURB LINE, AND AT THE CENTER OF THE STRUCTURE FOR THOSE WITHIN PAVEMENT.
19. WHENEVER IT IS NECESSARY TO REMOVE EXISTING HMA SURFACE MIXTURE, OIL AND CHIP SURFACE, GRAVEL OR CRUSHED STONE BASE COURSE, IT SHALL BE REMOVED AT THE CONTRACT UNIT PRICE PER CUBIC YARD FOR EARTH EXCAVATION. EXISTING HMA SURFACE MIXTURE TO REMAIN IN PLACE SHALL BE SAW CUT.

THE FOLLOWING RATES OF APPLICATION HAVE BEEN ASSUMED IN CALCULATING PLAN QUANTITIES :

BITUMINOUS MATERIALS (PRIME COAT) (ON AGG BASE)	_____	0.05 POUND/SQUARE FOOT
BITUMINOUS MATERIALS (TACK COAT) (BETWEEN LIFTS)	_____	0.025 POUND/SQUARE FOOT
HOT-MIX ASPHALT	_____	0.056 TON/SQUARE YARD/INCH

MIXTURE REQUIREMENTS

THE FOLLOWING MIXTURE REQUIREMENTS ARE APPLICABLE FOR THIS PROJECT:

LOCATION(S):	MULTI-USE PATH	
	SURFACE	BINDER
MIXTURE USE(S):	PG 64-22	PG 64-22
AC/PG:	PG 64-22	PG 64-22
DESIGN AIR VOIDS	4% @ Ndes=50	4% @ Ndes=50
MIXTURE COMP		
(GRADATION)	IL-9.5	IL-9.5
FRICITION		
AGGREGATE	MIX "C"	N/A
MIXTURE WEIGHT	112	112
QUALITY MANAGEMENT		
PROGRAM	QC/QA	QC/QA
SUBLOT SIZE	N/A	N/A
MATERIAL TRANSFER DEVICE (REQUIRED?)	N/A	N/A

HIGHWAY STANDARDS

000001-08	STANDARD SYMBOLS, ABBREVIATIONS AND PATTERNS
001006	DECIMAL OF AN INCH AND OF A FOOT
280001-07	TEMPORARY EROSION CONTROL SYSTEMS
424001-11	PERPENDICULAR CURB RAMPS FOR SIDEWALKS
424011-04	CORNER PARALLEL CURB RAMPS FOR SIDEWALKS
424016-05	MID-BLOCK CURB RAMPS FOR SIDEWALKS
424021-06	DEPRESSED CORNER FOR SIDEWALKS
442201-03	CLASS C AND D PATCHES
602301-04	INLET - TYPE A
602306-03	INLET - TYPE B
602601-06	PRECAST REINFORCED CONCRETE FLAT SLAB TOP
604001-05	FRAME AND LIDS TYPE 1
604046-03	FRAME AND GRATE TYPE 10
604051-04	FRAME AND GRATE TYPE 11
606001-08	CONCRETE CURB TYPE B AND COMBINATION CURB AND GUTTER
701006-05	OFF-RD OPERATIONS, 2L, 2W, 15' TO 24" FROM PAVEMENT EDGE
701501-06	URBAN LANE CLOSURE, 2L, 2W, UNDIVIDED
701801-06	SIDEWALK, CORNER, OR CROSSWALK CLOSURE
701901-09	TRAFFIC CONTROL DEVICES
720001-01	SIGN PANEL MOUNT DETAILS
720006-04	SIGN PANEL ERECTION DETAILS
728001-01	TELESCOPING STEEL SIGN SUPPORT
780001-05	TYPICAL PAVEMENT MARKINGS
BLR 21-9	TYPICAL APPLICATION OF TRAFFIC CONTROL DEVICES FOR CONSTRUCTION ON RURAL LOCAL HIGHWAYS

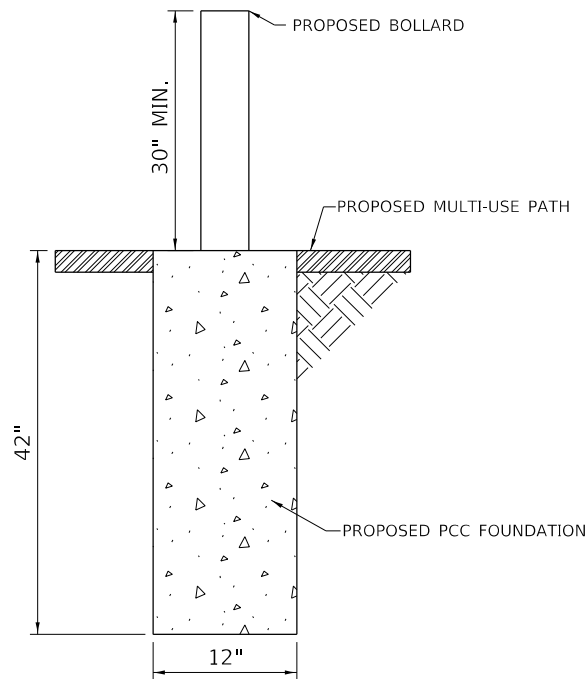

BOLLARD DETAIL
NOT TO SCALE

MODEL Detail FILE: 2024 - Sangamon St. Multi-Use Path (Bearsfootown)CDDDCDD - Sheets102-5025-sht-GenNotes.dgn 2024



USER NAME = Cburke	DESIGNED - CMB	REVISED -
PLOT SCALE = 2,0000 ' / in.	DRAWN - CMB	REVISED -
PLOT DATE = 2/28/2024	CHECKED - BMB	REVISED -
	DATE - 10/01/2022	REVISED -

STATE OF ILLINOIS
DEPARTMENT OF TRANSPORTATION

SANGAMON, & 15TH STREETS - MULTI-USE PATH
GENERAL NOTES, BOLLARD DETAIL, & HIGHWAY STANDARDS

SCALE: N/A SHEET 1 OF 1 SHEETS

SECTION	COUNTY	TOTAL SHEETS	SHEET NO.
21-00080-00-SW	CASS	35	2
CONTRACT NO. 93819			
ILLINOIS FED. AID PROJECT			

CODE NO.	ITEM	UNIT	TOTAL QUANTITY	CITY OF BEARDSTOWN	
				MULTIUSE PATH	
				0028	URBAN
20200100	EARTH EXCAVATION	CU YD	1455	1455	
20800150	TRENCH BACKFILL	CU YD	51	51	
28000250	TEMPORARY EROSION CONTROL SEEDING	POUND	93	93	
28000400	PERIMETER EROSION BARRIER	FOOT	8149	8149	
28000500	INLET AND PIPE PROTECTION	EACH	7	7	
31100300	SUBBASE GRANULAR MATERIAL, TYPE A 4"	SQ YD	446	446	
35102000	AGGREGATE BASE COURSE, TYPE B 8"	SQ YD	4108	4108	
40600275	BITUMNOUS MATERIALS (PRIME COAT)	POUND	9242	9242	
40600290	BITUMNOUS MATERIALS (TACK COAT)	POUND	925	925	
40602978	HOT-MIX ASPHALT BINDER COURSE, IL- 9.5, N50	TON	358	358	
40604050	HOT-MIX ASPHALT SURFACE COURSE, IL-9.5, MIX "C", N50	TON	350	350	
42300400	PORTLAND CEMENT CONCRETE DRIVEWAY PAVEMENT, 8 INCH	SQ YD	128	128	
42400300	PORTLAND CEMENT CONCRETE SIDEWALK 6 INCH	SQ FT	10216	10216	
42400800	DETECTABLE WARNINGS	SQ FT	369	369	

SPECIALTY ITEMS

MODEL: \$MODELNAME\$ FILE NAME: V33223 - Sangamon St Multi-Use Path - Beardstown\ICDD\ICDD_Sheets\04-5025-sh-5001.dgn 2024



USER NAME = Cburke	DESIGNED - CMB	REVISED -
	DRAWN - CMB	REVISED -
PLOT SCALE = 2.0000' / in.	CHECKED - BMB	REVISED -
PLOT DATE = 2/28/2024	DATE - 10/01/2022	REVISED -

**STATE OF ILLINOIS
DEPARTMENT OF TRANSPORTATION**

**SANGAMON, & 15TH STREETS - MULTI-USE PATH
SUMMARY OF QUANTITIES**

SCALE: N/A SHEET 1 OF 3 SHEETS

SECTION	COUNTY	TOTAL SHEETS	SHEET NO.
21-00080-00-SW	CASS	35	4
		CONTRACT NO. 93819	
ILLINOIS		FED. AID PROJECT	

CODE NO.	ITEM	UNIT	TOTAL QUANTITY	CITY OF BEARDSTOWN	
				MULTIUSE PATH	
				0028	URBAN
44000100	PAVEMENT REMOVAL	SQ YD	308	308	
44000200	DRIVEWAY PAVEMENT REMOVAL	SQ YD	187	187	
44000500	COMBINATION CURB AND GUTTER REMOVAL	FOOT	402	402	
44000600	SIDEWALK REMOVAL	SQ FT	2496	2496	
44201329	CLASS C PATCHES, TYPE II, 8 INCH	SQ YD	20	20	
44201333	CLASS C PATCHES, TYPE III, 8 INCH	SQ YD	57	57	
55100300	STORM SEWER REMOVAL 8"	FOOT	99	99	
55100400	STORM SEWER REMOVAL 10"	FOOT	32	32	
60234200	INLETS, TYPE A, TYPE 1 FRAME, OPEN LID	EACH	1	1	
60236700	INLETS, TYPE A, TYPE 10 FRAME AND GRATE	EACH	1	1	
60236800	INLETS, TYPE A, TYPE 11 FRAME AND GRATE	EACH	3	3	
60240305	INLETS, TYPE B, TYPE 10 FRAME AND GRATE	EACH	1	1	
60257900	MANHOLES TO BE RECONSTRUCTED	EACH	2	2	
60500060	REMOVING INLETS	EACH	6	6	

SPECIALTY ITEMS

MODEL: \$MODELNAME\$
FILE NAME: V33223 - Sangamon St Multi-Use Path - Beardstown\CADD\CADD_Sheets\04-5025-shh-5001.dgn
2024



USER NAME = Cburke	DESIGNED - CMB	REVISED -
	DRAWN - CMB	REVISED -
PLOT SCALE = 2.0000' / in.	CHECKED - BMB	REVISED -
PLOT DATE = 2/28/2024	DATE - 10/01/2022	REVISED -

STATE OF ILLINOIS
DEPARTMENT OF TRANSPORTATION

SANGAMON, & 15TH STREETS - MULTI-USE PATH
SUMMARY OF QUANTITIES

SCALE: N/A SHEET 2 OF 3 SHEETS

SECTION	COUNTY	TOTAL SHEETS	SHEET NO.
21-00080-00-SW	CASS	35	5
		CONTRACT NO. 93819	
ILLINOIS		FED. AID PROJECT	

CODE NO.	ITEM	UNIT	TOTAL QUANTITY	CITY OF BEARDSTOWN	
				MULTIUSE PATH	URBAN
60603800	COMBINATION CONCRETE CURB AND GUTTER, TYPE B-6.12	FOOT	2004	2004	
67100100	MOBILIZATION	L SUM	1	1	
# 72000100	SIGN PANEL - TYPE 1	SQ FT	236	236	
# 72800100	TELESCOPING STEEL SIGN SUPPORT	FOOT	352	352	
# 78001130	PAINT PAVEMENT MARKING - LINE 6"	FOOT	559	559	
# 78001150	PAINT PAVEMENT MARKING - LINE 12"	FOOT	467	467	
# 78001180	PAINT PAVEMENT MARKING - LINE 24"	FOOT	56	56	
X2501000	SEEDING, CLASS 2 (SPECIAL)	ACRE	1.0	1.0	
X7010216	TRAFFIC CONTROL AND PROTECTION, (SPECIAL)	L SUM	1	1	
Z0004002	BOLLARDS	EACH	8	8	
* Z0076600	TRAINEES	HOURL	500		
Z0013798	CONSTRUCTION LAYOUT	L SUM	1	1	
* Z0076604	TRAINEES TRAINING PROGRAM GRADUATE	HOURL	500		
Z0058608	STORM SEWER (WATER MAIN REQUIREMENTS) 12 INCH	FOOT	140	140	

SPECIALTY ITEMS
* 0042

MODEL \$MODELNAME\$
FILE NAME: V33223 - Sangamon St Multi-Use Path - Beardstown\CADD\CADD_Sheets\04-5025-sht-5001.dgn
2024



USER NAME = CBurke	DESIGNED - CMB	REVISED -
PLOT SCALE = 2.0000' / in.	DRAWN - CMB	REVISED -
PLOT DATE = 2/28/2024	CHECKED - BMB	REVISED -
	DATE - 10/01/2022	REVISED -

**STATE OF ILLINOIS
DEPARTMENT OF TRANSPORTATION**

**SANGAMON, & 15TH STREETS - MULTI-USE PATH
SUMMARY OF QUANTITIES**

SCALE: N/A SHEET 3 OF 3 SHEETS

SECTION	COUNTY	TOTAL SHEETS	SHEET NO.
21-00080-00-SW	CASS	35	6
		CONTRACT NO. 93819	
ILLINOIS FED. AID PROJECT			

SIGNING SCHEDULE						
STATION	FACING	DESIGNATION	72000100	72800100	COLOR	DESCRIPTION
			SIGN PANEL - TYPE 1	TELESCOPING STEEL SIGN SUPPORT		
			SQ FT	FOOT		
15TH STREET						
130+72	NE	W11-2	6.3	15.5	YELLOW	PED CROSSING (30" X 30")
		W16-9P	2.0		YELLOW	"AHEAD" (12" X 24")
129+60	NE	W11-2	6.3	15.5	YELLOW	PED CROSSING (30" X 30")
		W16-7P(L)	2.0		YELLOW	"DIAGONAL ARROW" (12" X 24")
	SW	W11-2	6.3		YELLOW	PED CROSSING (30" X 30")
		W16-7P(R)	2.0		YELLOW	"DIAGONAL ARROW" (12" X 24")
129+77	NE	W11-2	6.3	15.5	YELLOW	PED CROSSING (30" X 30")
		W16-7P(R)	2.0		YELLOW	"DIAGONAL ARROW" (12" X 24")
	SW	W11-2	6.3		YELLOW	PED CROSSING (30" X 30")
		W16-7P(L)	2.0		YELLOW	"DIAGONAL ARROW" (12" X 24")
130+72	NE	W11-2	6.3	15.5	YELLOW	PED CROSSING (30" X 30")
		W16-9P	2.0		YELLOW	"AHEAD" (12" X 24")
SANGAMON STREET						
331+13	NW	R1-1	2.3	13.0	RED	"STOP" (18" X 18")
	SE	R9-16	2.3		WHITE	"NO ALL TERRIAN VEHICLES" ("18 X 18")
356+44	SE	R1-1	2.3	13.0	RED	"STOP" (18" X 18")
	NW	R9-16	2.3		WHITE	"NO ALL TERRIAN VEHICLES" ("18 X 18")
356+55	NE	W11-2	6.3	15.5	YELLOW	PED CROSSING (30" X 30")
		W16-7P(R)	2.0		YELLOW	"DIAGONAL ARROW" (12" X 24")
	SW	W11-2	6.3		YELLOW	PED CROSSING (30" X 30")
		W16-7P(L)	2.0		YELLOW	"DIAGONAL ARROW" (12" X 24")
356+55	SW	W11-2	6.3	15.5	YELLOW	PED CROSSING (30" X 30")
		W16-9P	2.0		YELLOW	"AHEAD" (12" X 24")
356+95	NE	W11-2	6.3	15.5	YELLOW	PED CROSSING (30" X 30")
		W16-7P(L)	2.0		YELLOW	"DIAGONAL ARROW" (12" X 24")
	SW	W11-2	6.3		YELLOW	PED CROSSING (30" X 30")
		W16-7P(R)	2.0		YELLOW	"DIAGONAL ARROW" (12" X 24")
356+95	NE	W11-2	6.3	15.5	YELLOW	PED CROSSING (30" X 30")
		W16-9P	2.0		YELLOW	"AHEAD" (12" X 24")
357+07	NW	R1-1	2.3	13.0	RED	"STOP" (18" X 18")
	SE	R9-16	2.3		WHITE	"NO ALL TERRIAN VEHICLES" ("18 X 18")
368+88	SE	R1-1	2.3	13.0	RED	"STOP" (18" X 18")
	NW	R9-16	2.3		WHITE	"NO ALL TERRIAN VEHICLES" ("18 X 18")
368+98	NE	W11-2	6.3	15.5	YELLOW	PED CROSSING (30" X 30")
		W16-7P(R)	2.0		YELLOW	"DIAGONAL ARROW" (12" X 24")
	SW	W11-2	6.3		YELLOW	PED CROSSING (30" X 30")
		W16-7P(L)	2.0		YELLOW	"DIAGONAL ARROW" (12" X 24")
368+98	SW	W11-2	6.3	15.5	YELLOW	PED CROSSING (30" X 30")
		W16-9P	2.0		YELLOW	"AHEAD" (12" X 24")
369+35	NE	W11-2	6.3	15.5	YELLOW	PED CROSSING (30" X 30")
		W16-7P(L)	2.0		YELLOW	"DIAGONAL ARROW" (12" X 24")
	SW	W11-2	6.3		YELLOW	PED CROSSING (30" X 30")
		W16-7P(R)	2.0		YELLOW	"DIAGONAL ARROW" (12" X 24")
369+35	NE	W11-2	6.3	15.5	YELLOW	PED CROSSING (30" X 30")
		W16-9P	2.0		YELLOW	"AHEAD" (12" X 24")
369+48	NW	R1-1	2.3	13.0	RED	"STOP" (18" X 18")
	SE	R9-16	2.3		WHITE	"NO ALL TERRIAN VEHICLES" ("18 X 18")
371+87	SE	R1-1	2.3	13.0	RED	"STOP" (18" X 18")
	NW	R9-16	2.3		WHITE	"NO ALL TERRIAN VEHICLES" ("18 X 18")
371+99	NE	W11-2	6.3	15.5	YELLOW	PED CROSSING (30" X 30")
		W16-7P(L)	2.0		YELLOW	"DIAGONAL ARROW" (12" X 24")
	SW	W11-2	6.3		YELLOW	PED CROSSING (30" X 30")
		W16-7P(R)	2.0		YELLOW	"DIAGONAL ARROW" (12" X 24")
371+99	SW	W11-2	6.3	15.5	YELLOW	PED CROSSING (30" X 30")
		W16-9P	2.0		YELLOW	"AHEAD" (12" X 24")
372+32	NE	W11-2	6.3	15.5	YELLOW	PED CROSSING (30" X 30")
		W16-7P(R)	2.0		YELLOW	"DIAGONAL ARROW" (12" X 24")
	SW	W11-2	6.3		YELLOW	PED CROSSING (30" X 30")
		W16-7P(L)	2.0		YELLOW	"DIAGONAL ARROW" (12" X 24")
372+33	NE	W11-2	6.3	15.5	YELLOW	PED CROSSING (30" X 30")
		W16-9P	2.0		YELLOW	"AHEAD" (12" X 24")
372+44	NW	R1-1	2.3	13.0	RED	"STOP" (18" X 18")
	SE	R9-16	2.3		WHITE	"NO ALL TERRIAN VEHICLES" ("18 X 18")
375+02	SE	R1-1	2.3	13.0	RED	"STOP" (18" X 18")
	NW	R9-16	2.3		WHITE	"NO ALL TERRIAN VEHICLES" ("18 X 18")
TOTAL			235.1			352.0
USE			236			352

REMOVAL SCHEDULE								
STATION TO STATION	PAVEMENT REMOVAL	DRIVEWAY PAVEMENT REMOVAL	COMBINATION CURB AND GUTTER REMOVAL	SIDEWALK REMOVAL	44000100	44000200	44000500	44000600
					SQ YD	FOOT	SQ FT	
					FOOT			
15TH STREET								
124+49.91	125+15.29						65.4	
124+49.91	127+71.66							1579.4
124+49.91	127+76.41	136.6						
125+17.52	125+96.77		48.9					
125+91.88	127+19.82			128.0				
126+45.76	126+85.19		22.8					
127+13.81	127+34.82		10.3					
127+36.15	127+75.26			52.4				
128+06.68	129+61.53	119.5						
128+07.87	128+24.50			26.6				
128+08.30	128+17.94						169.5	
128+25.97	129+61.53		104.9					
129+69.40	129+83.23						85.1	
SANGAMON STREET								
356+48.46	356+52.34						69.4	
356+56.54	356+57.25			35.0				
356+91.22	356+93.35			39.5				
356+97.42	357+01.23				69.3			
368+84.27	369+00.91	51.4						
368+88.17	368+99.20						257.5	
368+89.13	368+98.87			16.2				
369+32.27	369+46.67			38.3				
369+32.22	369+56.23						264.9	
TOTAL		307.6	186.9	401.4			2495.1	
USE		308	187	402			2496	

PAVEMENT MARKING SCHEDULE					
STATION TO STATION	PAINT PAVEMENT MARKING	78001130	78001150	78001180	FOOT
		SOLID WHITE			
		6"	12"	24"	
15TH STREET					
127+60.50	128+15.16	87.3			
127+75.46	127+91.31			14.6	
129+45.46	129+72.61	79.6	118.8		
SANGAMON STREET					
331+14.51			5.0		
356+42.34			5.0		
356+58.15	356+91.45	66.4	121.0		
357+07.49			5.0		
368+82.86				8.7	
368+88.34			5.0		
368+88.86	369+00.88	47.7			
369+00.88	369+32.56	62.9	110.0		
369+32.56	369+41.79	46.9			
369+49.16			4.0		
369+49.76				8.9	
371+88.14			4.0		
371+94.34	372+37.43	71.8	81.0		
372+43.62			4.0		
374+97.43				11.2	
375+02.92			4.0		
375+03.43	375+14.43	42.7			
375+26.38	375+54.88	53.0			
375+40.88	375+51.54			12.3	
TOTAL		558.3	466.8	55.7	
USE		559	467	56	

SEEDING SCHEDULE			
STATION TO STATION	TEMPORARY EROSION CONTROL SEEDING	28000250	X2501000
		POUND	SEEDING, CLASS 2 (SPECIAL)
		ACRE	
15TH STREET			
128+18.63	129+56.54	1.6	0.02
SANGAMON STREET			
331+09.55	334+70.00	8.3	0.08
334+70.00	338+50.00	8.7	0.09
338+50.00	342+30.00	8.7	0.09
342+30.00	346+10.00	8.7	0.09
346+10.00	349+90.00	8.7	0.09
349+90.00	353+70.00	8.7	0.09
353+70.00	356+43.39	6.3	0.06
357+06.48	359+85.00	6.4	0.06
359+85.00	362+95.00	7.1	0.07
362+95.00	366+05.00	7.1	0.07
366+05.00	368+69.37	6.1	0.06
369+48.17	372+00.00	2.9	0.03
372+31.73	375+97.45	3.2	0.03
TOTAL		92.6	0.93
USE		93	1.0

SIDEWALK SCHEDULE					
STATION TO STATION	SIDE	42400300	42400800	DETECTABLE WARNINGS	SQ FT
		PORTLAND CEMENT CONCRETE SIDEWALK 6"			
		FOOT			
15TH STREET					
124+50.00	127+71.34	LT	2631.8		17.1
128+09.20	129+57.03	LT	1313.6		47.8
129+70.83	129+82.63	RT	129.4		30.6
SANGAMON STREET					
356+43.39	356+56.56	LT/RT	164.3		20.0
356+92.89	357+06.48	LT/RT	166.9		20.0
368+69.37	368+99.37	LT/RT	449.3		28.3
368+89.35	368+99.37	RT	178.9		28.3
369+33.13	372+00.04	LT/RT	2175.8		60.7
369+35.80	369+56.31	RT	169.5		10.0
372+31.73	375+13.93	LT/RT	2234.4		45.8
375+03.93	375+27.29	RT	302.3		40.0
375+54.47	275+81.98	RT	299.2		19.8
TOTAL			10215.4		368.4
USE			10216		369

STORM SEWER SCHEDULE					
STATION TO STATION	SIDE	20056608	20800150	TRENCH BACKFILL	CU YD
		STORM SEWER (WATER MAIN REQUIREMENTS) 12 INCH			
		FOOT	FOOT		
15TH STREET					
127+16.71	127+22.07	LT	10		1.6
127+16.71	127+22.07	LT/RT	22		2.9
SANGAMON STREET					
368+99.95	369+14.59	RT	20		3.1
368+99.95	369+14.59	LT/RT	34		5.9
369+14.59	369+32.86	LT/RT	36		5.5
369+14.59	369+34.70	RT	18		2.8
TOTAL			140		21.8
USE			140		22

EARTHWORK SCHEDULE		
STATION TO STATION	EARTH EXCAVATION	20200100
		CU YD
		SANGAMON STREET
331+09.55	334+70.00	122.4
334+70.00	338+50.00	129.0
338+50.00	342+30.00	129.0
342+30.00	346+10.00	129.0
346+10.00	349+90.00	129.0
349+90.00	353+70.00	129.0
353+70.00	356+75.00	94.5
356+75.00	359+85.00	

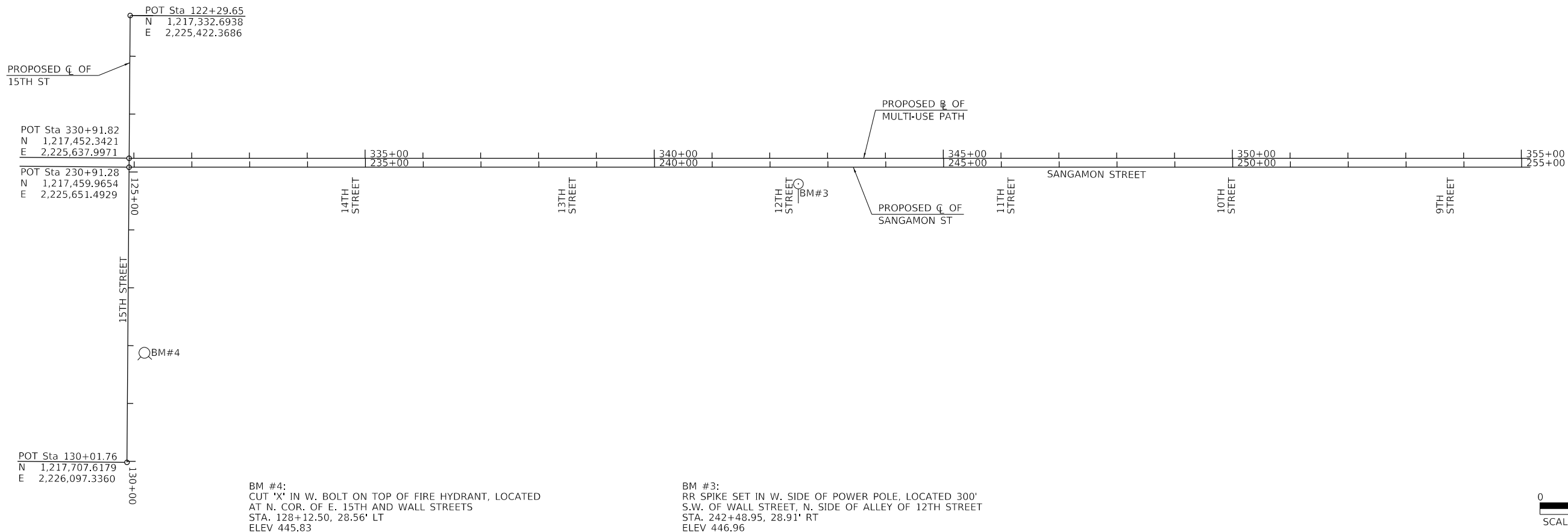

BM #4:
CUT 'X' IN W. BOLT ON TOP OF FIRE HYDRANT, LOCATED
AT N. COR. OF E. 15TH AND WALL STREETS
STA. 128+12.50, 28.56' LT
ELEV 445.83

BM #3:
RR SPIKE SET IN W. SIDE OF POWER POLE, LOCATED 300'
S.W. OF WALL STREET, N. SIDE OF ALLEY OF 12TH STREET
STA. 242+48.95, 28.91' RT
ELEV 446.96

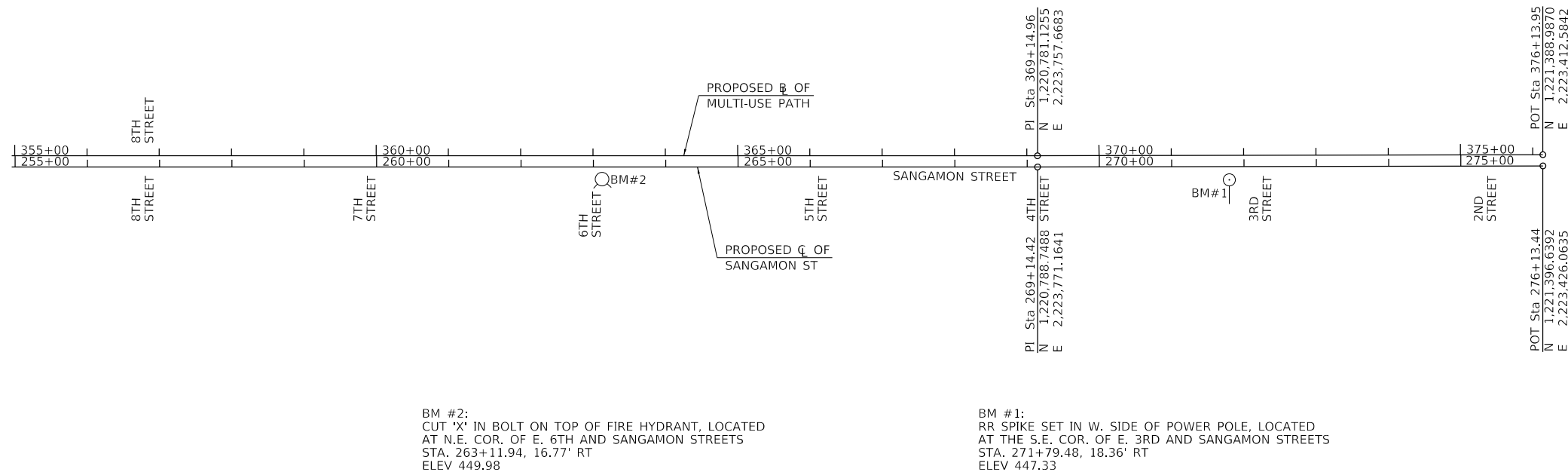
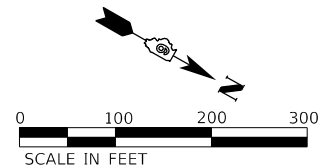

BM #2:
CUT 'X' IN BOLT ON TOP OF FIRE HYDRANT, LOCATED
AT N.E. COR. OF E. 6TH AND SANGAMON STREETS
STA. 263+11.94, 16.77' RT
ELEV 449.98

BM #1:
RR SPIKE SET IN W. SIDE OF POWER POLE, LOCATED
AT THE S.E. COR. OF E. 3RD AND SANGAMON STREETS
STA. 271+79.48, 18.36' RT
ELEV 447.33

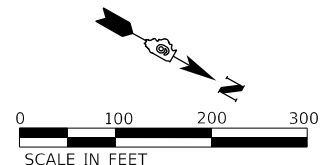

MODEL: \\MODELS\MAMES
FILE: \\net\er_v3\224 - Sangamon St Multi-Use Path (Beardslow)\CADD\CADD_Sheets\106-5025-sh-kat2.dgn

HEI Hutchison
Engineering, Inc.
2024 JOB# 5025

USER NAME = Cburke	DESIGNED - CMB	REVISED -
PLOT SCALE = 200.0000' / in.	DRAWN - CMB	REVISED -
PLOT DATE = 2/28/2024	CHECKED - BMB	REVISED -
	DATE - 10/01/2022	REVISED -

**STATE OF ILLINOIS
DEPARTMENT OF TRANSPORTATION**

**SANGAMON, & 15TH STREETS - MULTI-USE PATH
ALIGNMENT AND BENCHMARKS**

SCALE: 1"=100'-0" SHEET 1 OF 1 SHEETS

SECTION	COUNTY	TOTAL SHEETS	SHEET NO.
21-00080-00-SW	CASS	35	9
CONTRACT NO. 93819			
ILLINOIS FED. AID PROJECT			

T 18 N, R 12 W, 3rd PM
SECTION 14

PLAN	SURVEYED	DATE
	PLOTTED	BY
	ALIGNED	CHECKED
	NOTE BOOK	NO.
	CADD FILE NAME	

PROFILE	SURVEYED	DATE
	PLOTTED	BY
	GRADES CHECKED	
	NOTE BOOK	NO.
	STRUCTURE NOTATIONS	

MODEL Default
FILE NAME: W33025 - Sangamon St Multi-Use Path (Beardstown)CADD\CADD_Sheets\07-5025-int-PP01.dwg
2024

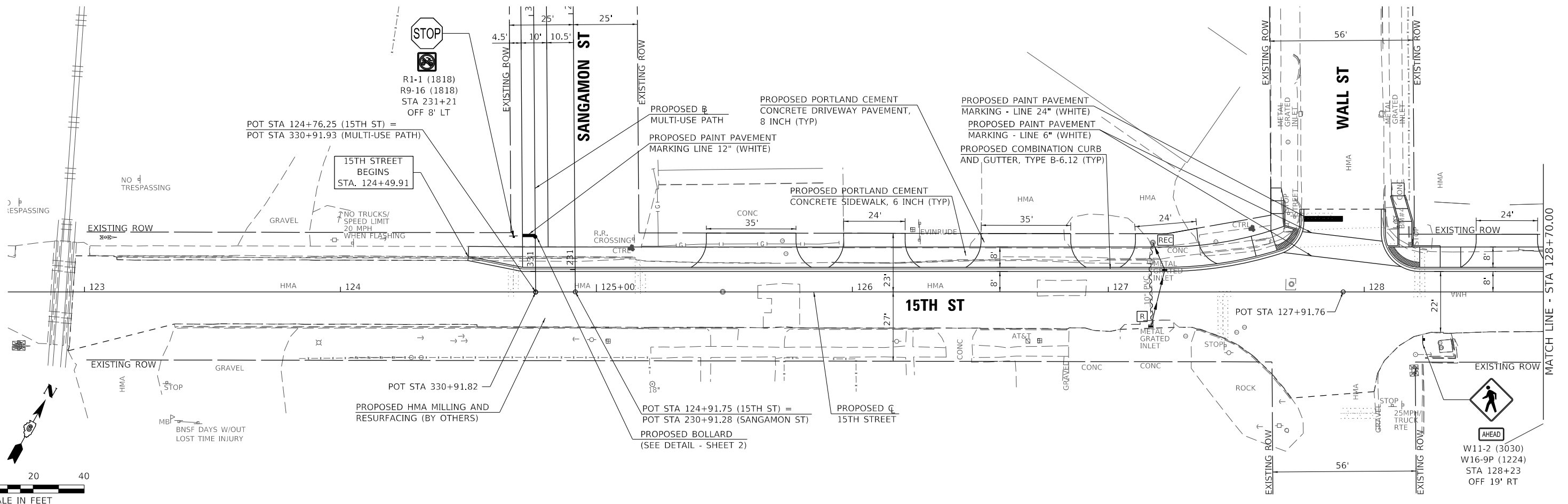

DATE	
BY	
SUBMITTED	
PLANNED	
ALIGNED	
CHECKED	
CADD FILE NAME	
NO.	

DATE	
BY	
SURVEYED	
GRADES CHECKED	
PLOTTED	
STRUCTURE NOTATIONS	
NO.	

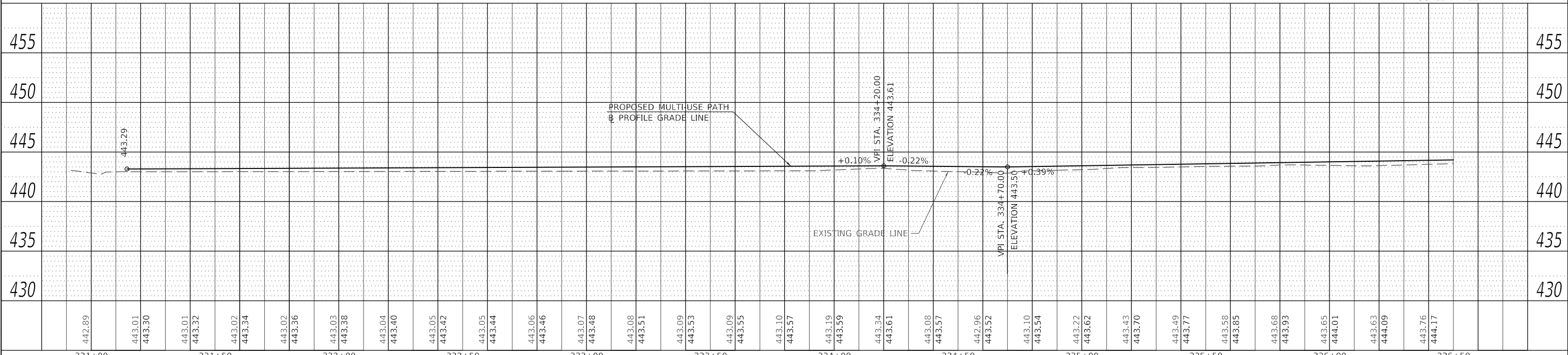
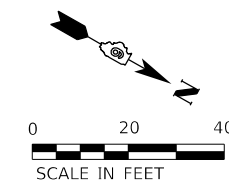
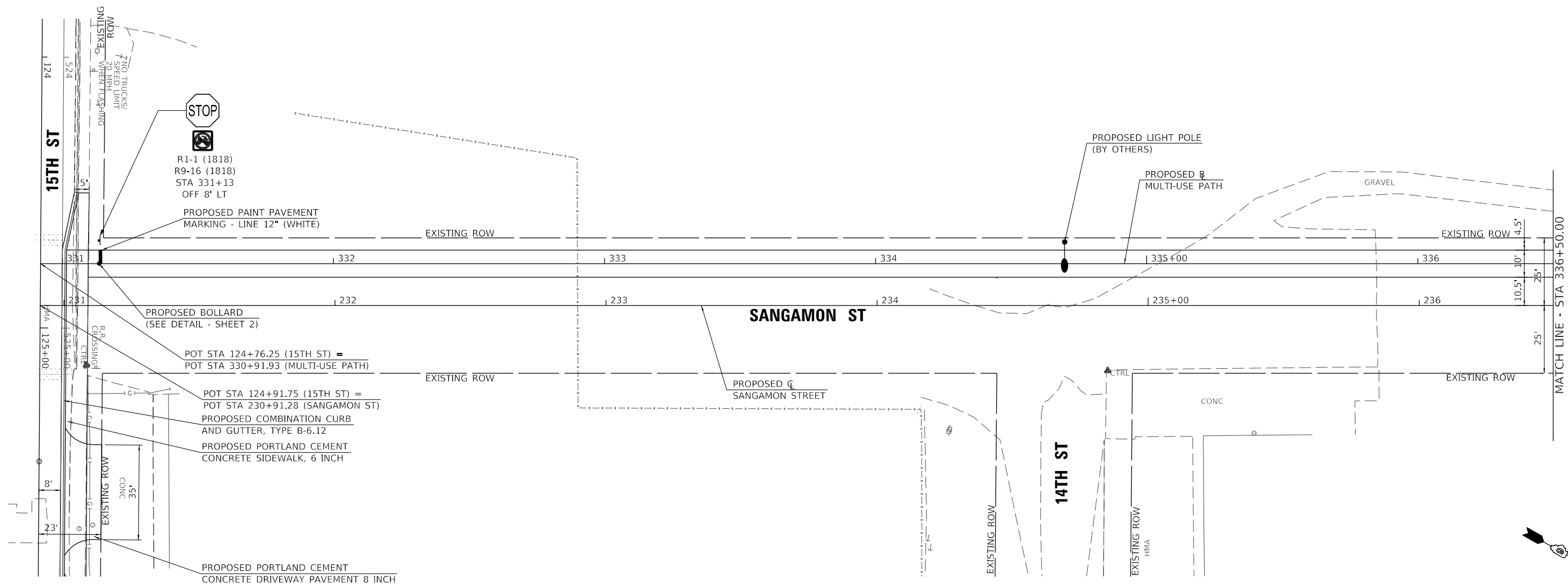

442.89	443.01	443.30	443.01	443.32	443.02	443.34	443.02	443.36	443.03	443.38	443.04	443.40	443.05	443.42	443.05	443.44	443.06	443.46	443.07	443.48	443.08	443.51	443.09	443.53	443.09	443.55	443.10	443.57	443.19	443.59	443.34	443.61	443.08	443.57	442.96	443.52	443.10	443.54	443.22	443.62	443.43	443.70	443.49	443.77	443.58	443.85	443.68	443.93	443.65	444.01	443.63	444.09	443.76	444.17
331+00	331+50	332+00	332+50	333+00	333+50	334+00	334+50	335+00	335+50	336+00	336+50	USER NAME = CBurke		DESIGNED - CMB	REVISED -	STATE OF ILLINOIS DEPARTMENT OF TRANSPORTATION		SANGAMON STREET - MULTI-USE PATH PLAN AND PROFILE				SECTION	COUNTY	TOTAL SHEETS	SHEET NO.																													
PLOT SCALE = 40,0000' / In.		CHECKED - BMB	REVISED -	SCALE: 1"=20'-0"				SHEET 3	OF 10 SHEETS	STA. 330+91.82	TO STA. 336+50.00	21-00080-00-SW	CASS	35	12																																							
PLOT DATE = 2/28/2024		DATE - 1/19/2024	REVISED -	ILLINOIS FED. AID PROJECT				CONTRACT NO. 93819																																														

HEI Hutchison Engineering, Inc.

2024 JOB# 5025

MODEL Default
FILE NAME: V:\3025 - Sangamon St Multi-Use Path (Beardtown)\CADD\CADD_Sheets\09-5025-int-PP03.dgn

PLAN	SUBMITTED	DATE
	PLOTTED	
	ALIGNMENT CHECKED	
	GRADES CHECKED	
	CADD FILE NAME	
	NO.	
	NOTE BOOK	
	NO.	

PROFILE	SURVEYED	DATE
	PLOTTED	
	GRADES CHECKED	
	STRUCTURE NOTATIONS CHECKED	
	NO.	

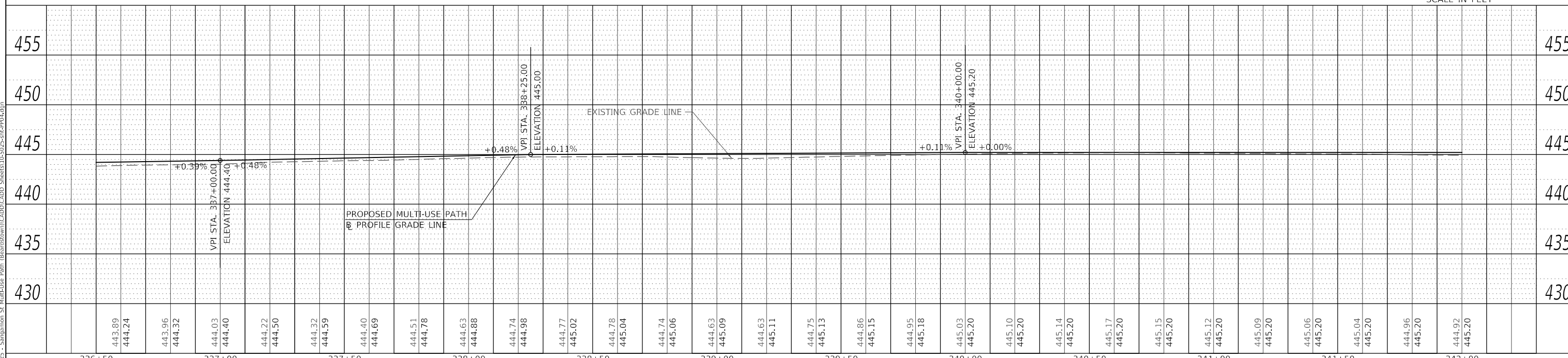
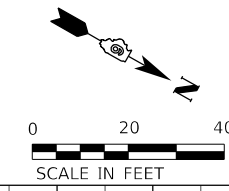
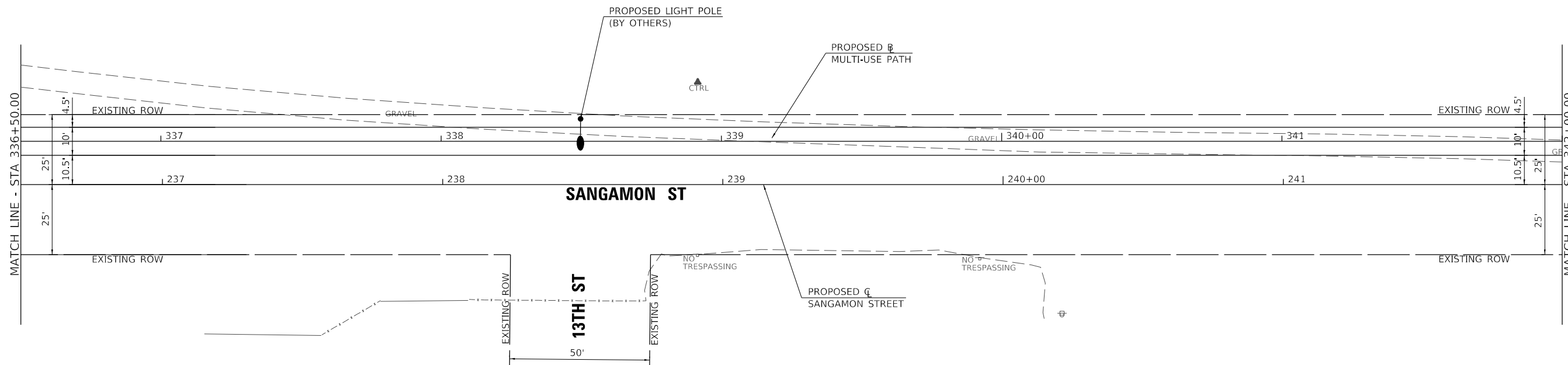

	USER NAME = Cburke	DESIGNED - CMB	REVISED -	STATE OF ILLINOIS DEPARTMENT OF TRANSPORTATION	SANGAMON STREET - MULTI-USE PATH PLAN AND PROFILE			SECTION	COUNTY	TOTAL SHEETS	SHEET NO.
	PLOT SCALE = 40,0000 ' / In.	DRAWN - JCW	REVISED -					21-00080-00-SW	CASS	35	13
	PLOT DATE = 2/28/2024	CHECKED - BMB	REVISED -					CONTRACT NO. 93819			
	DATE - 1/19/2024	REVISIED -	SCALE: 1"=20'-0"					SHEET 4	OF 10 SHEETS	STA. 336+50.00	TO STA. 342+00.00

MODEL Default
 FILE NAME: V:\3025 - Sangamon St Multi-Use Path (Beardtown)\CADD\CADD Sheets\10-5025-int-profile.dwg
 2024 JOB# 5025

PLAN	SURVEYED	DATE
	PLOTTED	
	ALIGNMENT CHECKED	
	GRADE CHECKED	
	STRUCTURE NOTATION CHECKED	
	NOTE BOOK NO.	
	CADD FILE NAME	

PROFILE	SURVEYED	DATE
	PLOTTED	
	GRADES CHECKED	
	STRUCTURE NOTATION CHECKED	
	NOTE BOOK NO.	
	CADD FILE NAME	

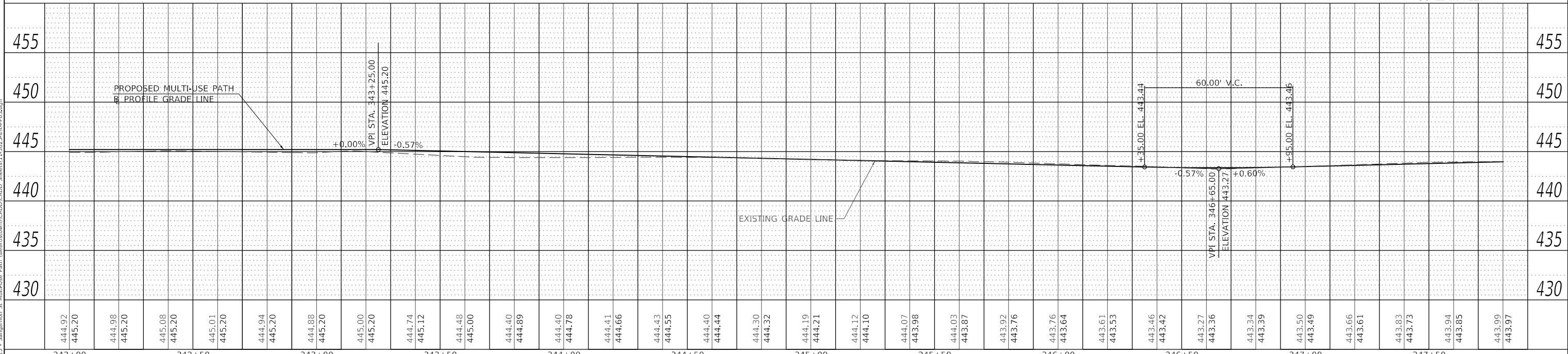
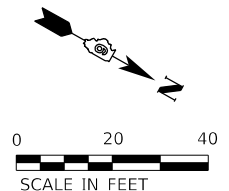
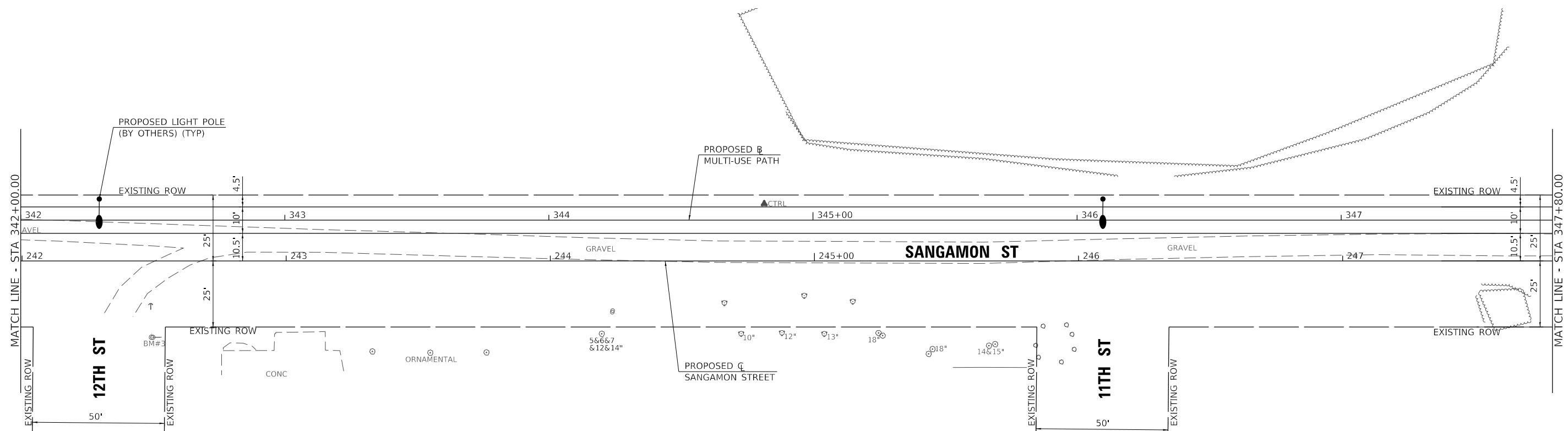

MODEL: Default
FILE NAME: V:\3025 - Sangamon St Multi-Use Path (Beardtown)\CADD\CADD Sheets\11-5025-int-pp05.dwg
2024

444.92 445.20	444.98 445.20	445.08 445.20	445.01 445.20	444.94 445.20	444.88 445.20	445.00 445.20	444.74 445.12	444.48 445.00	444.40 444.89	444.40 444.78	444.41 444.66	444.43 444.55	444.40 444.44	444.30 444.32	444.19 444.21	444.12 444.10	444.07 443.98	444.03 443.87	443.92 443.76	443.76 443.64	443.61 443.53	443.46 443.42	443.27 443.36	443.34 443.39	443.50 443.49	443.66 443.61	443.83 443.73	443.94 443.85	443.99 443.97
342+00	342+50	343+00	343+50	344+00	344+50	345+00	345+50	346+00	346+50	347+00	347+50	347+80																	



USER NAME = C Burke	DESIGNED - CMB	REVISED -
	DRAWN - JCW	REVISED -
PLOT SCALE = 40,0000 ' / in.	CHECKED - BMB	REVISED -
PLOT DATE = 2/28/2024	DATE - 1/19/2024	REVISED -

STATE OF ILLINOIS
DEPARTMENT OF TRANSPORTATION

SANGAMON STREET - MULTI-USE PATH			
PLAN AND PROFILE			
SCALE: 1"=20'-0"	SHEET 5	OF 10 SHEETS	STA. 342+00.00 TO STA. 347+80.00

SECTION	COUNTY	TOTAL SHEETS	SHEET NO.
21-00080-00-SW	CASS	35	14
CONTRACT NO. 93819			
ILLINOIS FED. AID PROJECT			

PLAN	SURVEYED	DATE
	PLOTTED	
	ALIGNMENT CHECKED	
	GRADE CHECKED	
	CADD FILE NAME	
	NO.	

PROFILE	SURVEYED	DATE
	PLOTTED	
	GRADES CHECKED	
	STRUCTURE NOTATIONS CHECKED	
	NO.	

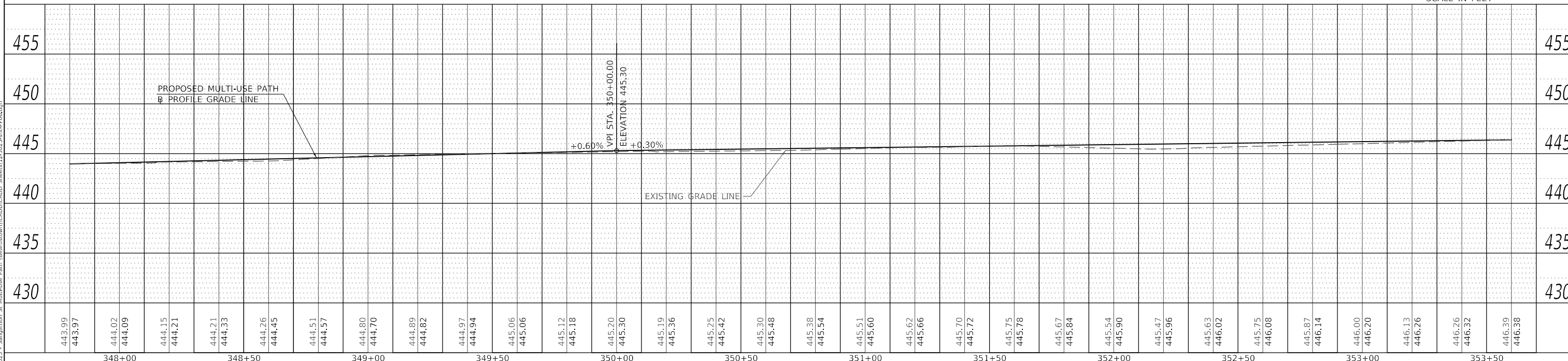
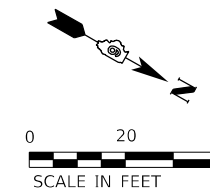
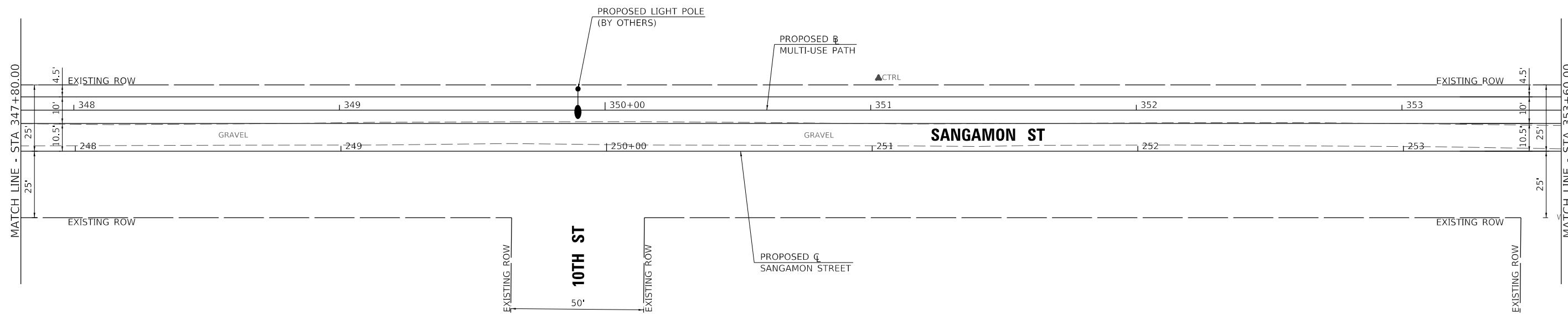

443.99	443.97	444.02	444.09	444.15	444.21	444.33	444.26	444.45	444.51	444.57	444.80	444.70	444.89	444.82	444.97	444.94	445.06	445.06	445.12	445.18	445.20	445.30	445.19	445.36	445.25	445.42	445.30	445.48	445.38	445.54	445.51	445.60	445.62	445.66	445.70	445.72	445.75	445.78	445.67	445.84	445.54	445.90	445.47	445.96	445.63	446.02	445.75	446.08	445.87	446.14	446.00	446.20	446.13	446.26	446.26	446.32	446.39	446.38
348+00		348+50		349+00		349+50		350+00		350+50		351+00		351+50		352+00		352+50		353+00		353+50																																				

MODEL: Default
FILE NAME: V:\3025 - Sangamon St Multi-Use Path (Beardtown)\CADD\CADD Sheets\21-00080-00-00-00.dwg



USER NAME = CBurke	DESIGNED - CMB	REVISED -
	DRAWN - JCW	REVISED -
PLOT SCALE = 40,0000 ' / In.	CHECKED - BMB	REVISED -
PLOT DATE = 2/28/2024	DATE - 1/19/2024	REVISED -

STATE OF ILLINOIS
DEPARTMENT OF TRANSPORTATION

SANGAMON STREET - MULTI-USE PATH
PLAN AND PROFILE
SCALE: 1"=20'-0" SHEET 6 OF 10 SHEETS STA. 347+80.00 TO STA. 353+60.00

SECTION	COUNTY	TOTAL SHEETS	SHEET NO.
21-00080-00-SW	CASS	35	15
CONTRACT NO. 93819			

ILLINOIS FED. AID PROJECT

LEGEND

- TYPE SIZE CLASS C PATCHES, 8" OF THE CLASS & SIZE SPECIFIED
- R INLET TO BE REMOVED
- REC MH TO BE RECONSTRUCTED
- STORM SEWER REMOVAL

PLAN	SUBMITTED	DATE
	PLOTTED	
	ALIGNMENT CHECKED	
	ADD FILE NAME	
	NO.	

PROFILE	SURVEYED	DATE
	GRADES CHECKED	
	STRUCTURE NOTATIONS CHECKED	
	NO.	

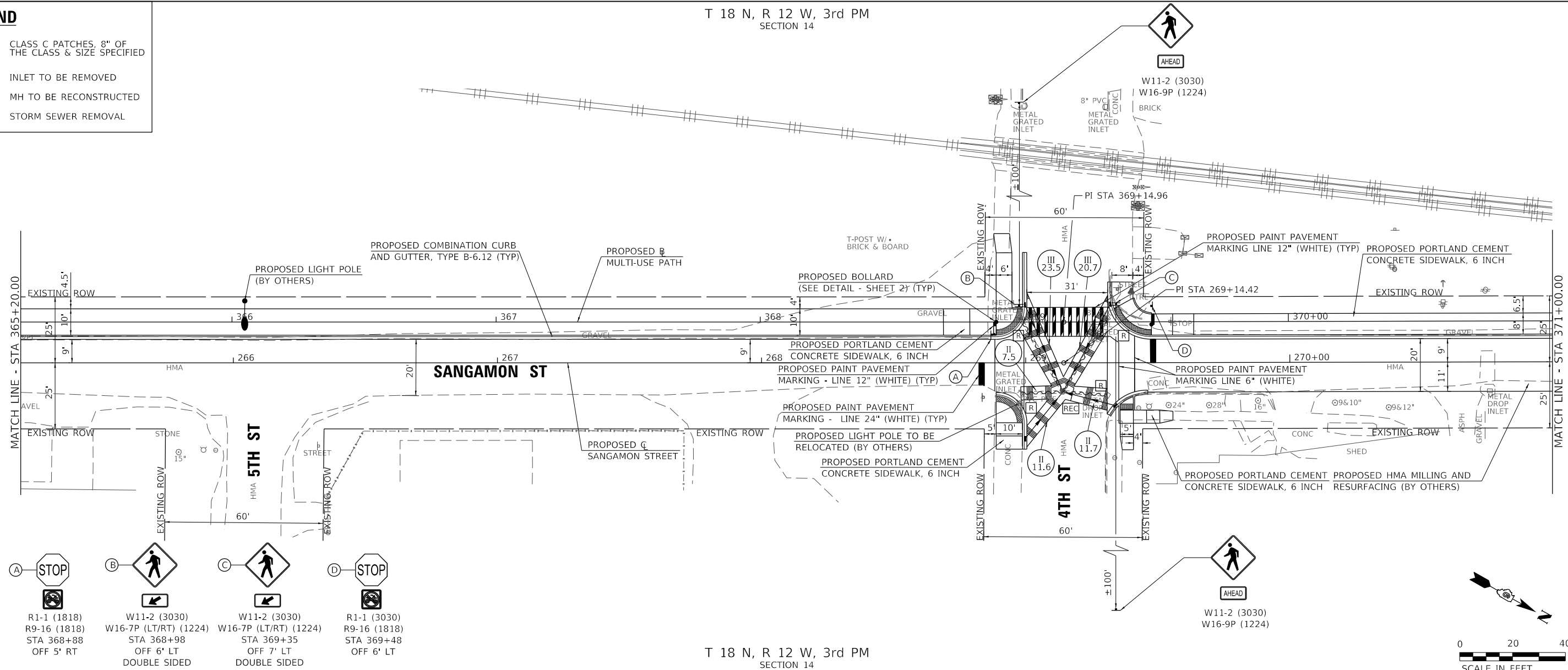

- | | | | |
|--|--|--|--|
|
A STOP
R1-1 (1818)
R9-16 (1818)
STA 368+88
OFF 5' RT |
B W11-2 (3030)
W16-7P (LT/RT) (1224)
STA 368+98
OFF 6' LT
DOUBLE SIDED |
C W11-2 (3030)
W16-7P (LT/RT) (1224)
STA 369+35
OFF 7' LT
DOUBLE SIDED |
D STOP
R1-1 (3030)
R9-16 (1818)
STA 369+48
OFF 6' LT |
|--|--|--|--|

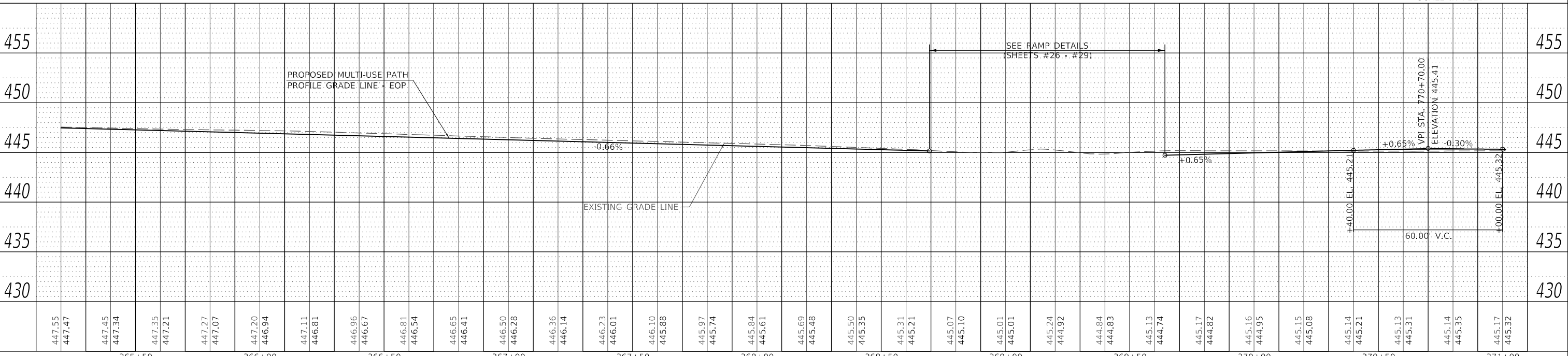
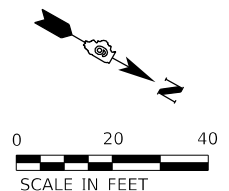

MODEL Default
 FILE NAME: W:\3025 - Sangamon St Multi-Use Path (Beardtown)\CADD\CADD Sheets\13-5025-int-ppb.dwg
 2024

Hutchison Engineering, Inc. JOB# 5025	USER NAME = Cburke	DESIGNED - CMB	REVISED -	STATE OF ILLINOIS DEPARTMENT OF TRANSPORTATION	SANGAMON STREET - MULTI-USE PATH PLAN AND PROFILE			SECTION	COUNTY	TOTAL SHEETS	SHEET NO.	
						SCALE: 1"=20'-0" SHEET 9 OF 10 SHEETS STA. 365+20.00 TO STA. 371+00.00			21-00080-00-SW	CASS	35	18
									CONTRACT NO. 93819			
									ILLINOIS FED. AID PROJECT			

T 18 N, R 12 W, 3rd PM
SECTION 14

T 18 N, R 12 W, 3rd PM
SECTION 15

DATE	
BY	
PLAN	SURVEYED
	PLOTTED
	ALIGNMENT CHECKED
	GRADES CHECKED
	STRUCTURE NOTATIONS CHECKED
NO.	

DATE	
BY	
PROFILE	SURVEYED
	PLOTTED
	GRADES CHECKED
	STRUCTURE NOTATIONS CHECKED
NO.	

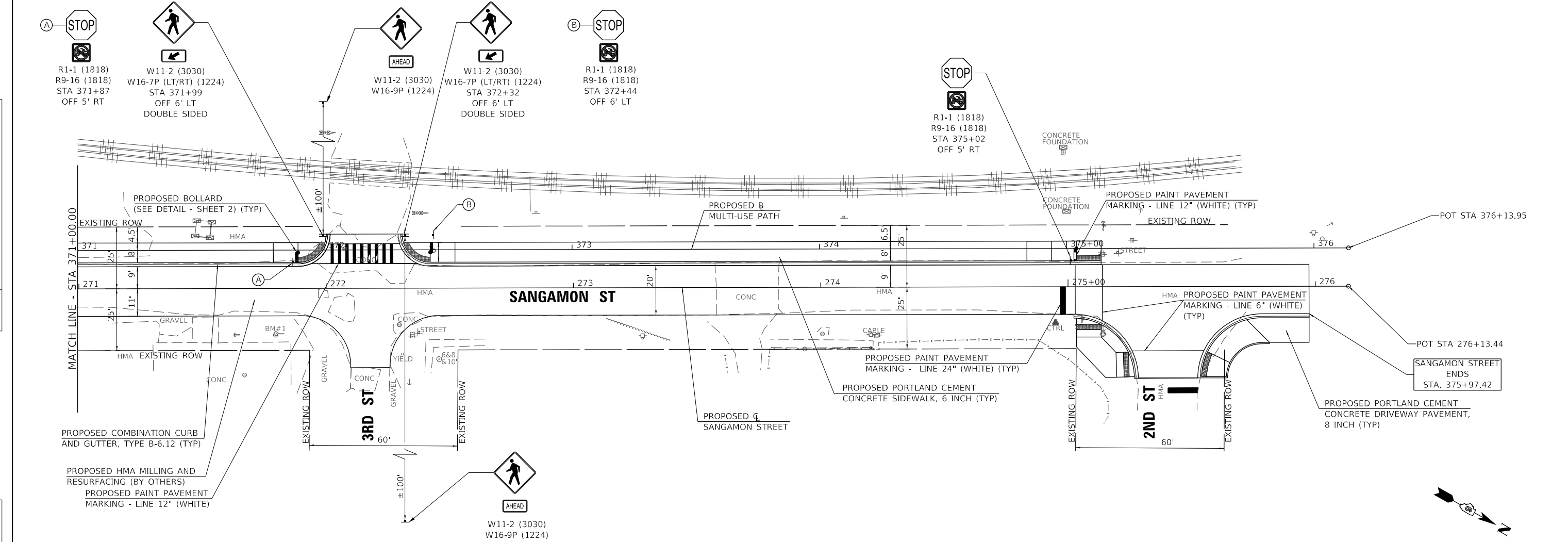

T 18 N, R 12 W, 3rd PM
SECTION 14

T 18 N, R 12 W, 3rd PM
SECTION 15

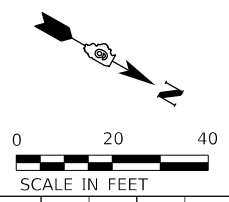
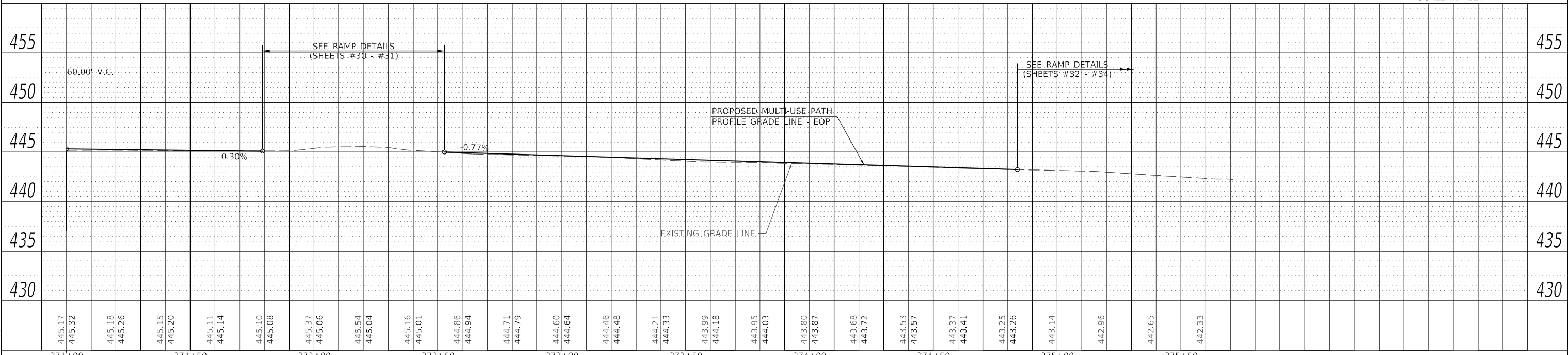

	USER NAME = CBurke	DESIGNED - CMB	REVISED -	STATE OF ILLINOIS DEPARTMENT OF TRANSPORTATION	SANGAMON STREET - MULTI-USE PATH PLAN AND PROFILE			SECTION	COUNTY	TOTAL SHEETS	SHEET NO.
	PLOT SCALE = 40,0000' / In.	DRAWN - JCW	REVISED -		21-00080-00-SW	CASS	35	19			
	PLOT DATE = 2/28/2024	CHECKED - BMB	REVISED -		CONTRACT NO. 93819						
	DATE = 1/19/2024	REVISOR -	REVISED -		ILLINOIS FED. AID PROJECT						
SCALE: 1"=20'-0" SHEET 10 OF 10 SHEETS STA. 371+00.00 TO STA. 376+13.95											

MODEL Default
 FILE NAME: V:\3025 - Sangamon St Multi-Use Path (Beardtown)\CADD\CADD Sheets\16-5025-enc-PP10.dwg
 2024

**15TH STREET /WALL STREET INTERSECTION
WEST QUADRANT SIDEWALK**
HIGHWAY STD. 424011 - CORNER PARALLEL CURB RAMP

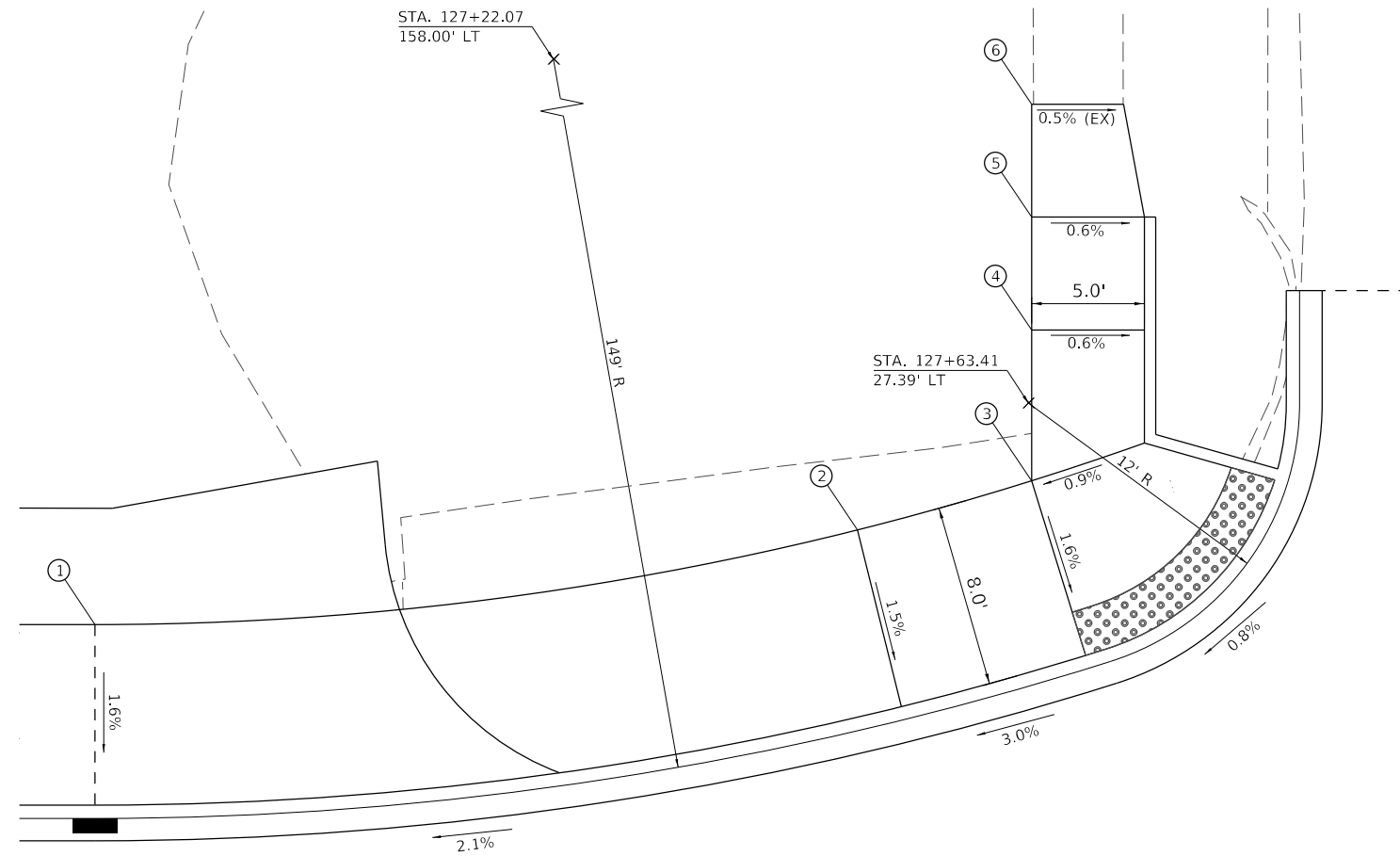

WALL STREET

PT. #	STATION	OFFSET	ELEVATION
1	127+22.07	17.58' LT	442.35
2	127+55.83	21.76' LT	443.37
3	127+63.54	23.94' LT	443.22
4	127+63.54	30.62' LT	443.49
5	127+63.54	35.62' LT	443.73
6	127+63.54	40.62' LT	443.80

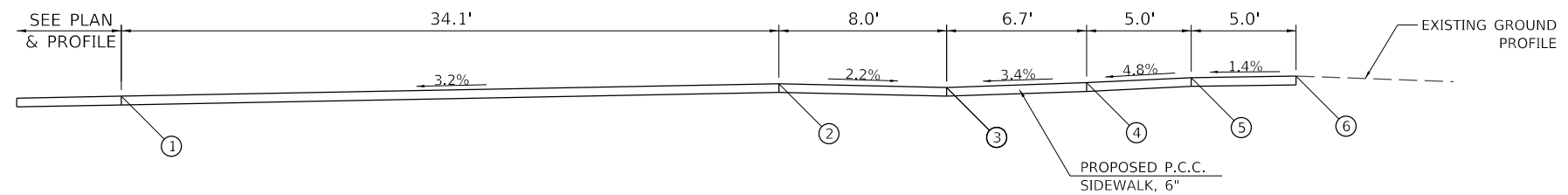

MODEL Path: \\hutchison\17-2025-sid-ramp\01.dgn
FILE Name: 17-2025 - Sidewalk Path (Beardstown)\CADD\CADD_Sheets\17-2025-sid-ramp\01.dgn



USER NAME = CBurke	DESIGNED - CMB	REVISED -
	DRAWN - CMB	REVISED -
PLOT SCALE = 6,000' / In.	CHECKED - BMB	REVISED -
PLOT DATE = 2/28/2024	DATE - 10/01/2022	REVISED -

SECTION	COUNTY	TOTAL SHEETS	SHEET NO.
21-00080-00-SW	CASS	35	20
CONTRACT NO. 93819			
ILLINOIS FED. AID PROJECT			

15TH STREET /WALL STREET INTERSECTION
NORTH QUADRANT SIDEWALK
 HIGHWAY STD. 424021 - DEPRESSED CORNER

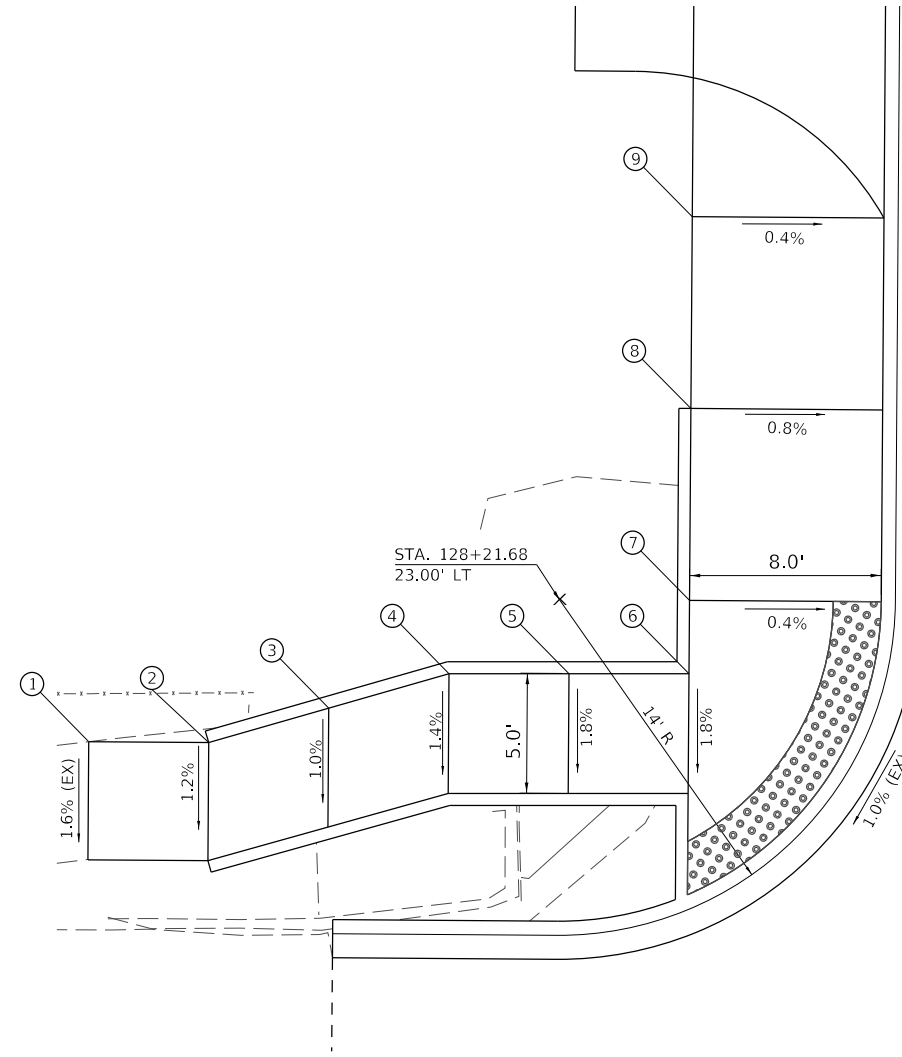

PT. #	STATION	OFFSET	ELEVATION
1	128+15.62	42.58' LT	443.60
2	128+15.62	37.58' LT	443.64
3	128+17.09	32.58' LT	443.68
4	128+18.56	27.58' LT	443.71
5	128+18.60	22.58' LT	443.65
6	128+18.63	17.58' LT	443.59
7	128+21.68	17.58' LT	443.64
8	128+29.68	17.58' LT	443.70
9	128+37.68	17.58' LT	443.73

WALL STREET

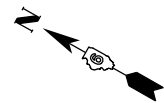
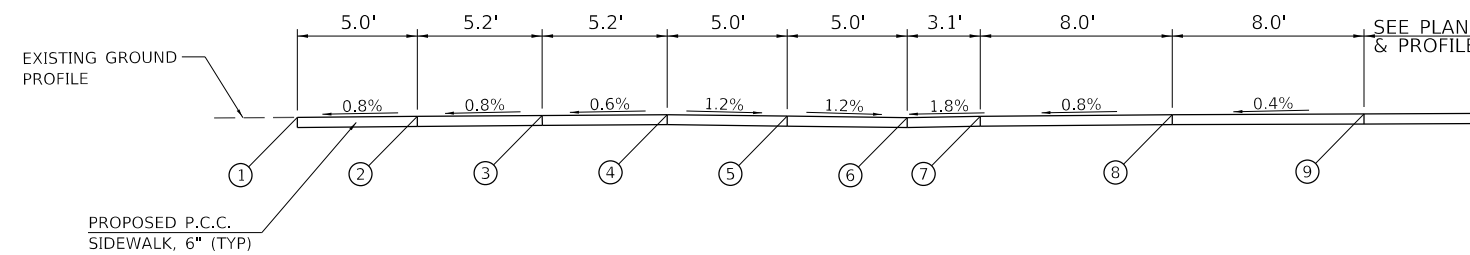

MODEL Default
 FILE Name: 03/2024 - Sangamon St. Multi-Use Path (Beaufortown) (CDD) (CDD) Sheet18-5025-sidRamp02.dgn
 2024



USER NAME = C.Burke	DESIGNED - CMB	REVISED -
	DRAWN - CMB	REVISED -
PLOT SCALE = 6,0000' / In.	CHECKED - BMB	REVISED -
PLOT DATE = 2/28/2024	DATE - 10/01/2022	REVISED -

STATE OF ILLINOIS
DEPARTMENT OF TRANSPORTATION

15TH STREET - MULTI-USE PATH
SIDEWALK RAMP DETAILS

SCALE: N/A SHEET 2 OF 15 SHEETS

SECTION	COUNTY	TOTAL SHEETS	SHEET NO.
21-00080-00-SW	CASS	35	21
CONTRACT NO. 93819			
ILLINOIS FED. AID PROJECT			

15TH STREET / CANAL STREET INTERSECTION
NORTH QUADRANT SIDEWALK
 HIGHWAY STD. 424016 - MIDBLOCK CURB RAMPS FOR SIDEWALKS

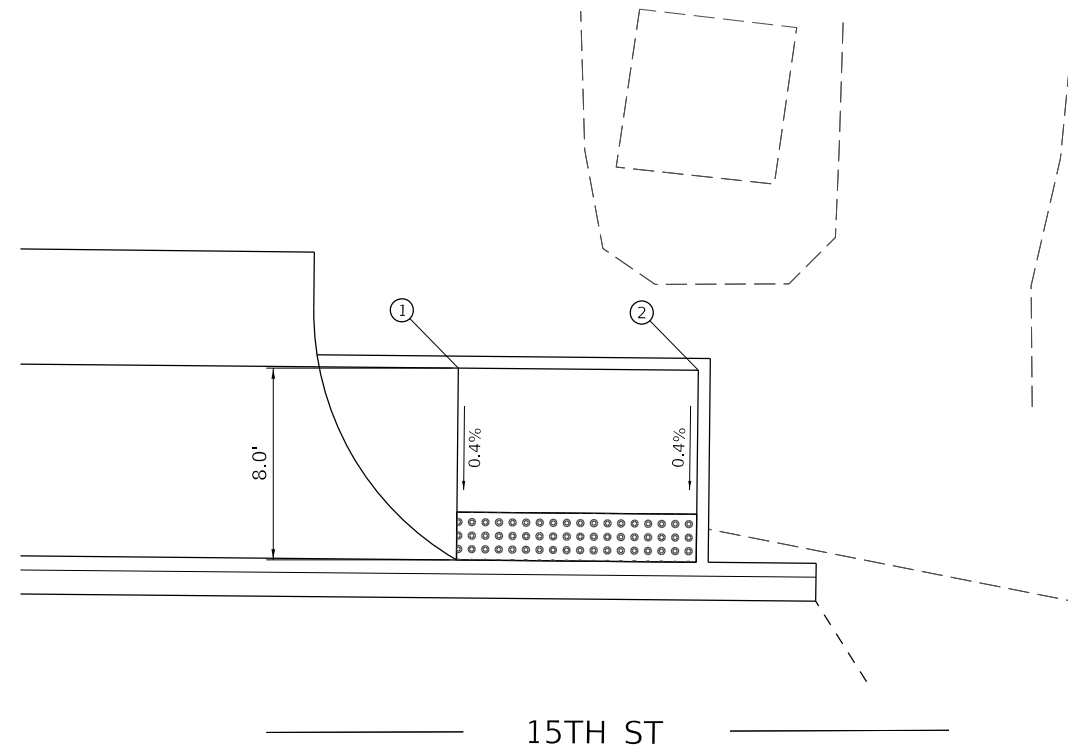

PT. #	STATION	OFFSET	ELEVATION
1	129+46.54	17.58' LT	444.33
2	129+56.54	17.58' LT	444.38

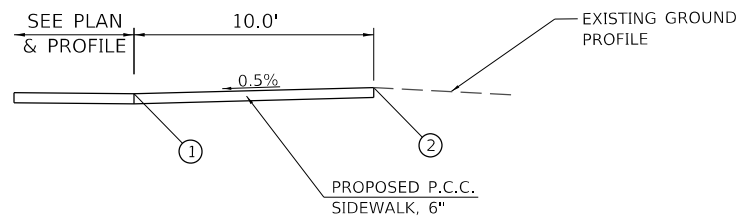

MODEL: Default
 FILE: Model_E_03/2023 - Sangamon St. Multi-Use Path (Beardstown)\CADD\CADD_Sheets\19-2023-SidRamp14.dgn
 2024



USER NAME = C.Burke	DESIGNED - CMB	REVISED -
	DRAWN - CMB	REVISED -
PLOT SCALE = 8,0000' / In.	CHECKED - BMB	REVISED -
PLOT DATE = 2/28/2024	DATE - 10/01/2022	REVISED -

STATE OF ILLINOIS
DEPARTMENT OF TRANSPORTATION

15TH STREET - MULTI-USE PATH SIDEWALK RAMP DETAILS		SECTION	COUNTY	TOTAL SHEETS	SHEET NO.
		21-00080-00-SW	CASS	35	22
SCALE: N/A		SHEET 3 OF 15 SHEETS		ILLINOIS FED. AID PROJECT	

CONTRACT NO. 93819

**15TH STREET /CANAL STREET INTERSECTION
EAST QUADRANT SIDEWALK**
HIGHWAY STD. 424011 - CORNER PARALLEL CURB RAMP

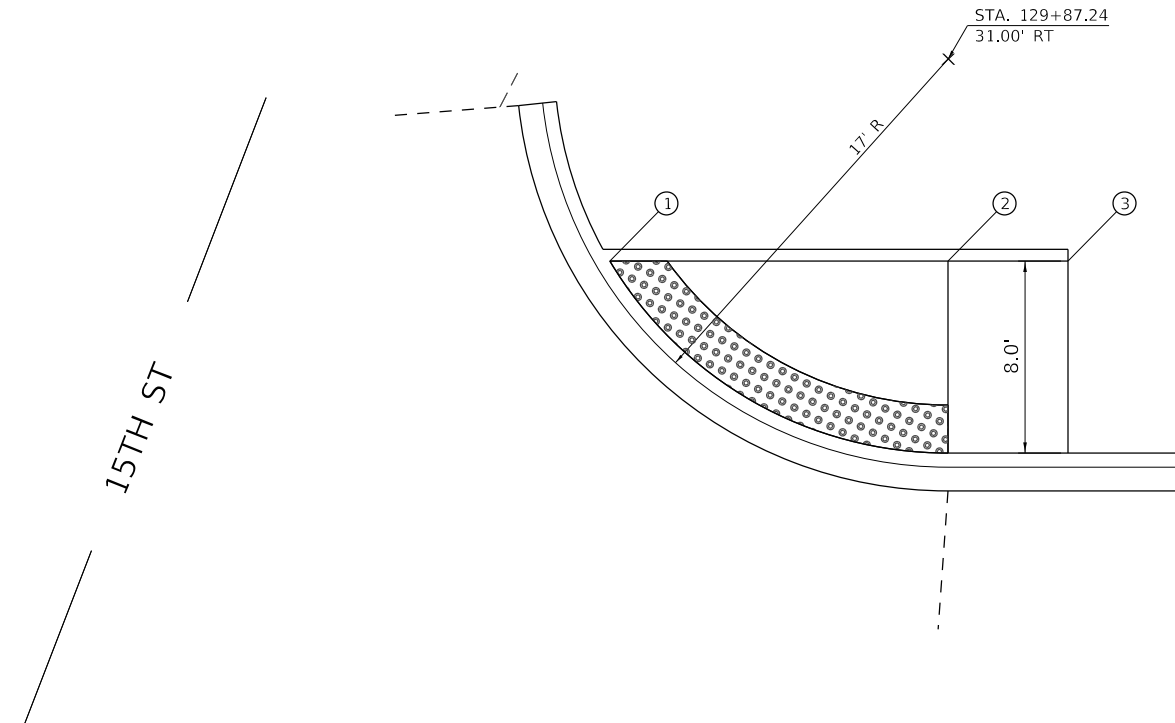

PT. #	STATION	OFFSET	ELEVATION
1	129+73.15	22.57' RT	444.54
2	129+79.83	34.98' RT	444.39
3	129+82.19	39.39' RT	EXIST

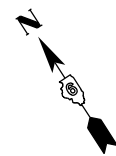
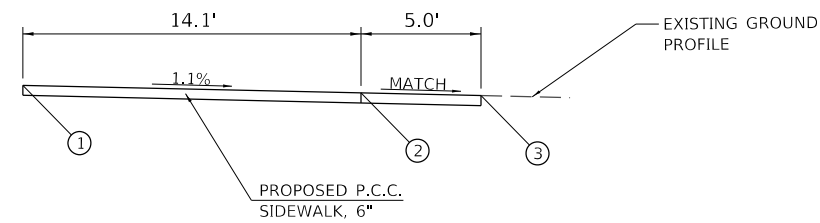

MODEL Path: \\hutchison\15th-Use Path (Beardslow)\CADD\CADD_Sheets\129-5025-15thRamp15.dwg
FILE Name: 129-5025 - 5th-Use Path (Beardslow)\CADD\CADD_Sheets\129-5025-15thRamp15.dwg
2024



USER NAME = CBurke	DESIGNED - CMB	REVISED -
	DRAWN - CMB	REVISED -
PLOT SCALE = 6,000' / In.	CHECKED - BMB	REVISED -
PLOT DATE = 2/28/2024	DATE - 10/01/2022	REVISED -

**STATE OF ILLINOIS
DEPARTMENT OF TRANSPORTATION**

**15TH STREET - MULTI-USE PATH
SIDEWALK RAMP DETAIL**

SCALE: N/A SHEET 4 OF 15 SHEETS

SECTION	COUNTY	TOTAL SHEETS	SHEET NO.
21-00080-00-SW	CASS	35	23
CONTRACT NO. 93819			
ILLINOIS FED. AID PROJECT			

**8TH STREET /SANGAMON STREET INTERSECTION
SOUTH QUADRANT SIDEWALKS**
HIGHWAY STD. 424016 - MID-BLOCK CURB RAMP FOR SIDEWALKS

————— 8TH STREET —————

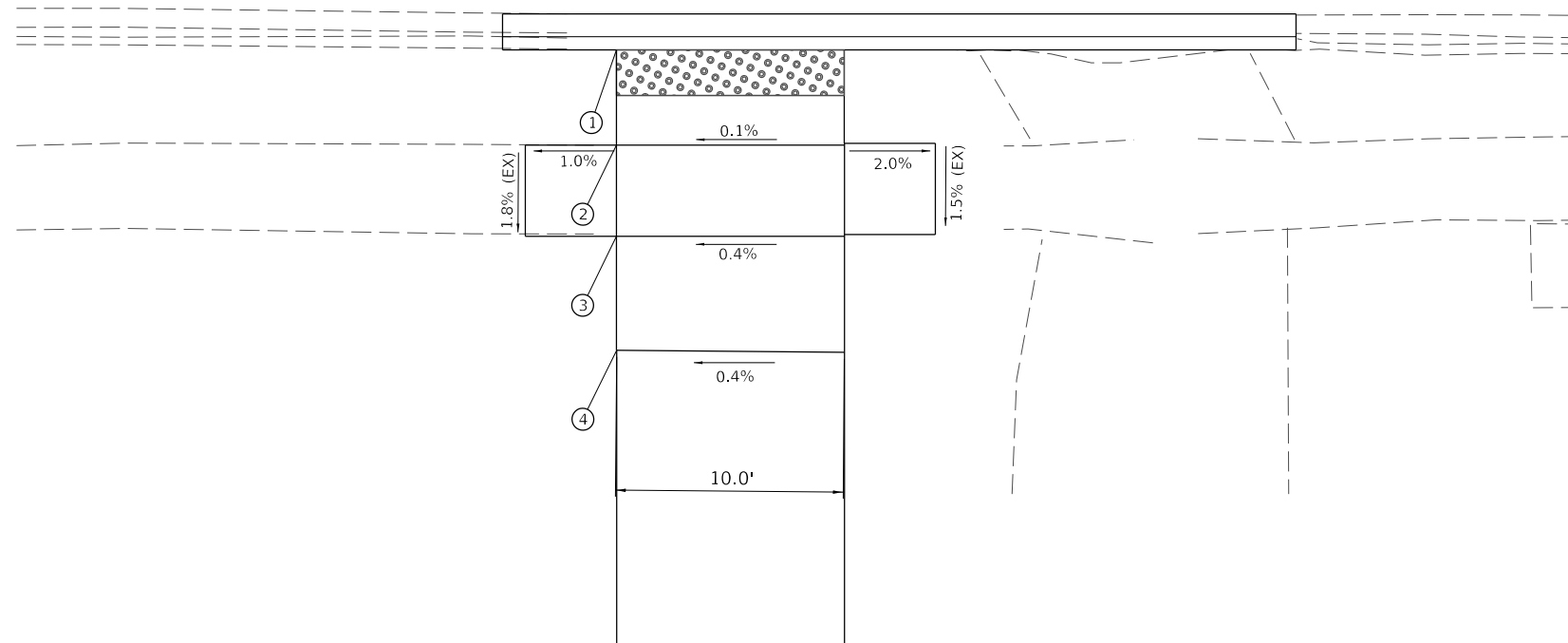

PT. #	STATION	OFFSET	ELEVATION
1	356+56.57	5.00' LT	448.32
2	356+52.39	5.00' LT	448.39
3	356+48.39	5.00' LT	448.41
4	356+43.39	5.00' LT	448.57

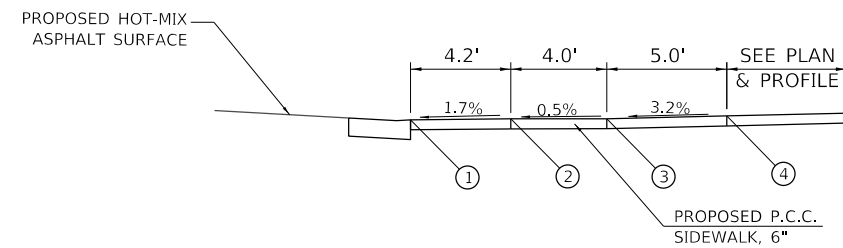

MODEL Path: \\hutchison\Projects\2024\21-00080-00-SW\8th-Sangamon-St-Multi-Use-Path-Beaufort\Drawings\CADD\CADD_Sheets\12-5025-SidewalkRamp03.dwg
FILE Name: 12-5025 - Sangamon St Multi-Use Path (Beaufort)\CADD\CADD_Sheets\12-5025-SidewalkRamp03.dwg
2024



USER NAME = CBurke	DESIGNED - CMB	REVISED -
	DRAWN - CMB	REVISED -
PLOT SCALE = 8,000' / In.	CHECKED - BMB	REVISED -
PLOT DATE = 2/28/2024	DATE - 10/01/2022	REVISED -

**STATE OF ILLINOIS
DEPARTMENT OF TRANSPORTATION**

**SANGAMON STREET – MULTI-USE PATH
SIDEWALK RAMP DETAILS**

SCALE: N/A SHEET 5 OF 15 SHEETS

SECTION	COUNTY	TOTAL SHEETS	SHEET NO.
21-00080-00-SW	CASS	35	24
CONTRACT NO. 93819			
ILLINOIS FED. AID PROJECT			

4TH STREET /SANGAMON STREET INTERSECTION
WEST QUADRANT SIDEWALK
 HIGHWAY STD. 424011 - CORNER PARALLEL CURB RAMP

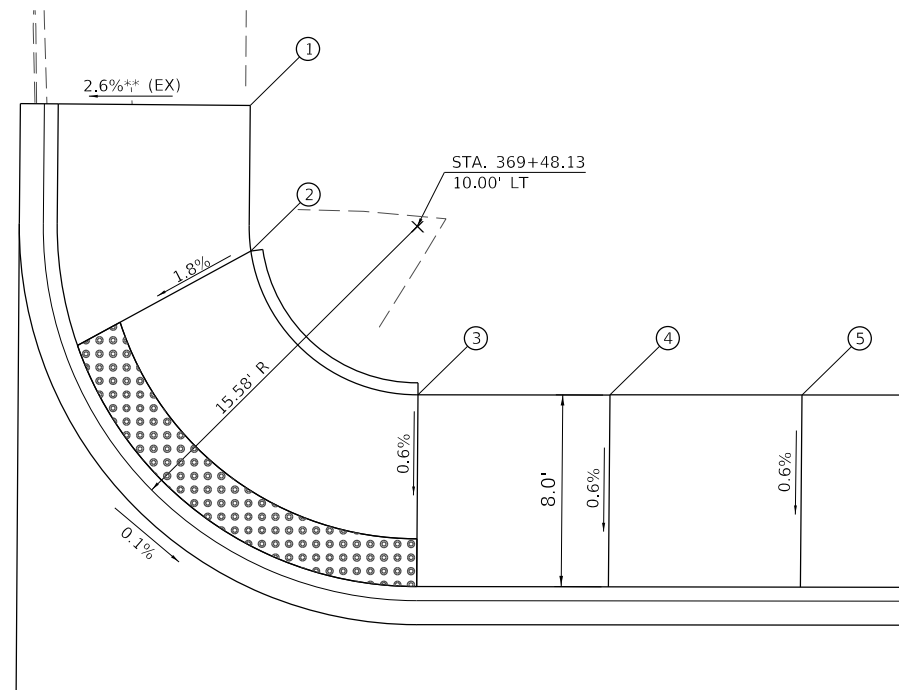

SANGAMON STREET

PT. #	STATION	OFFSET	ELEVATION
1	369+41.16	15.03' LT	445.08
2	369+41.20	8.97' LT	444.91
3	369+48.18	3.00' LT	445.03
4	369+56.18	3.00' LT	445.13
5	369+64.18	3.00' LT	445.21

** EXISTING GRADE EXCEEDS ADA REQUIREMENTS

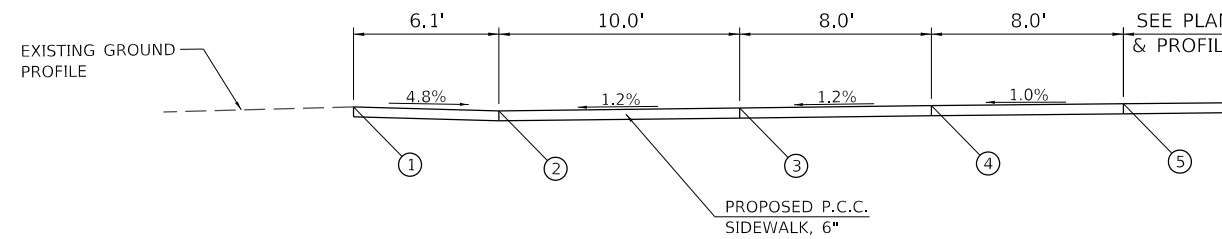

MODEL Default
 FILE Name: 03/2025 - Sangamon St. Multi-Use Path (Berurfdowntown)\CADD\CADD_Sheets\134-2025-sht-Ramp06.dgn
 2024



USER NAME =	CBurke	DESIGNED -	CMB	REVISED -	
DRAWN -	CMB	CHECKED -	BMB	REVISED -	
PLOT SCALE =	6,0000 ' / In.	DATE -	10/01/2022	REVISED -	
PLOT DATE =	2/28/2024				

STATE OF ILLINOIS
DEPARTMENT OF TRANSPORTATION

SANGAMON STREET - MULTI-USE PATH
SIDEWALK RAMP DETAILS

SCALE: N/A SHEET 8 OF 15 SHEETS

SECTION	COUNTY	TOTAL SHEETS	SHEET NO.
21-00080-00-SW	CASS	35	27
CONTRACT NO. 93819			
ILLINOIS FED. AID PROJECT			

**4TH STREET /SANGAMON STREET INTERSECTION
EAST QUADRANT SIDEWALK**
HIGHWAY STD. 424011 - CORNER PARALLEL CURB RAMP

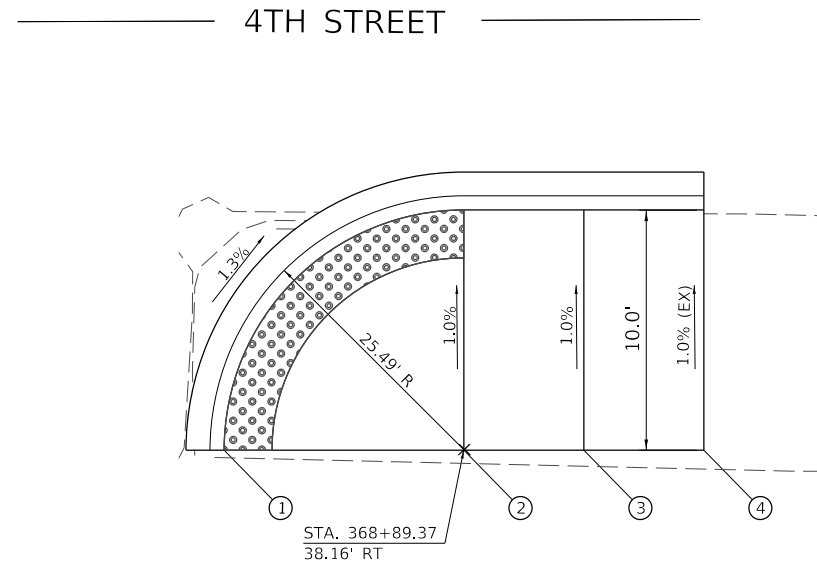

PT. #	STATION	OFFSET	ELEVATION
1	368+89.35	28.16' RT	445.07
2	368+89.35	38.16' RT	444.93
3	368+89.35	43.16' RT	445.32
4	368+89.35	48.16' RT	445.26

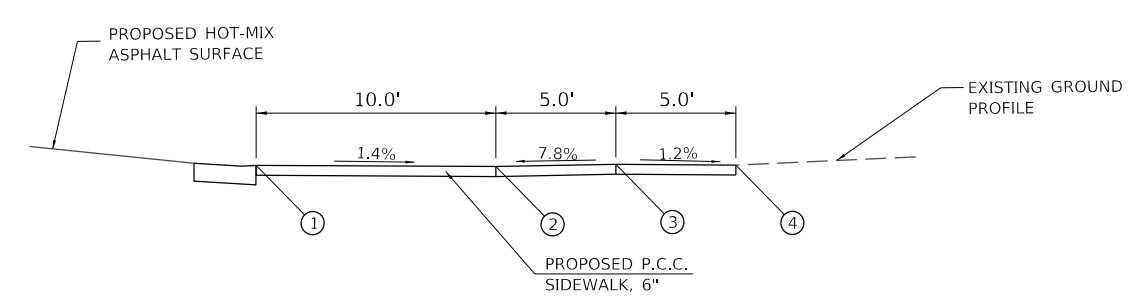

MODEL: Default
FILE: Model_V3.5025 - Sangamon St. Multi-Use Path (Beardstown)\CADD\CADD_Sheets\35-5025-sik-Ramp07.dgn
2024



USER NAME = CBurke	DESIGNED - CMB	REVISED -
	DRAWN - CMB	REVISED -
PLOT SCALE = 6,000' / In.	CHECKED - BMB	REVISED -
PLOT DATE = 2/28/2024	DATE - 10/01/2022	REVISED -

**STATE OF ILLINOIS
DEPARTMENT OF TRANSPORTATION**

SANGAMON STREET – MULTI-USE PATH SIDEWALK RAMP DETAILS		SECTION	COUNTY	TOTAL SHEETS	SHEET NO.
		21-00080-00-SW	CASS	35	28
SCALE: N/A		SHEET 9 OF 15 SHEETS		ILLINOIS FED. AID PROJECT	
CONTRACT NO. 93819					

**4TH STREET /SANGAMON STREET INTERSECTION
NORTH QUADRANT SIDEWALK**
HIGHWAY STD. 424001 - PERPENDICULAR CURB RAMPS FOR SIDEWALKS

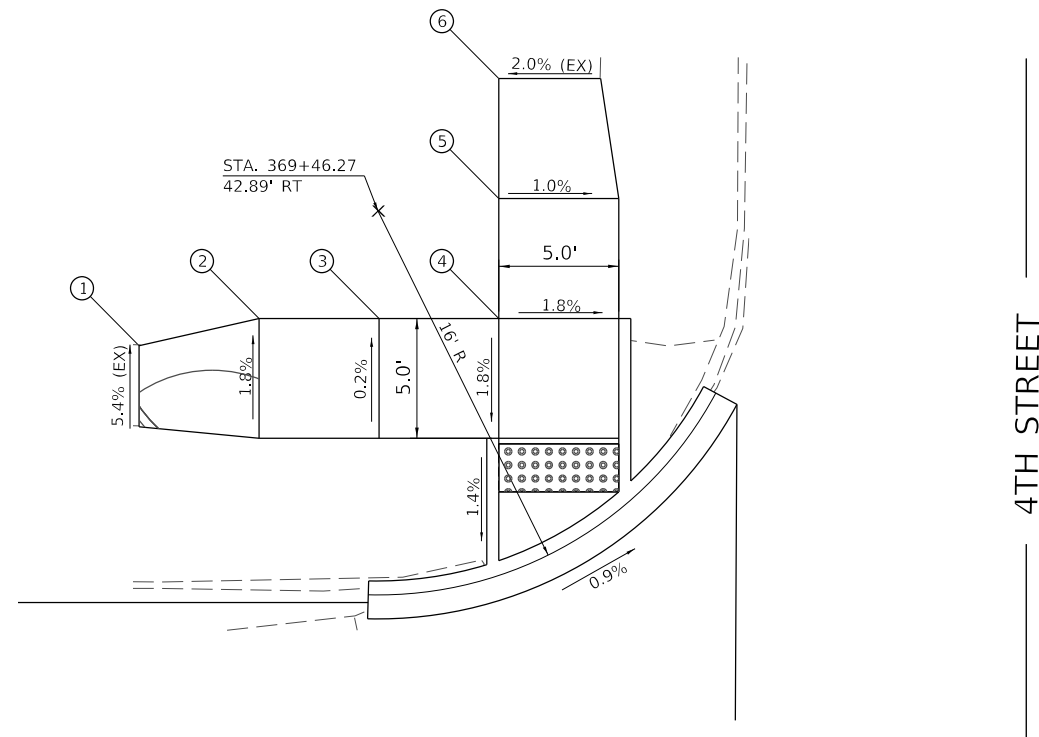

PT. #	STATION	OFFSET	ELEVATION
1	369+56.23	37.29' RT	445.39
2	369+51.23	38.42' RT	445.48
3	369+46.23	38.42' RT	445.24
4	369+41.23	38.42' RT	444.99
5	369+41.23	43.42' RT	445.25
6	369+41.23	48.42' RT	445.28

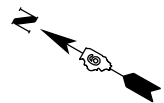
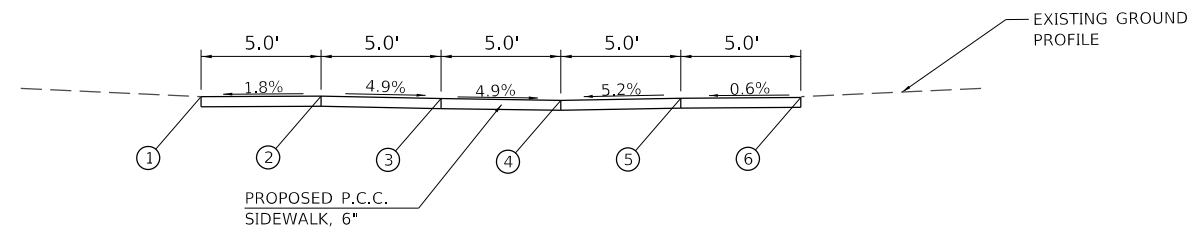

MODEL: Default
FILE: Model_V3.0225 - Sangamon St Multi-Use Path (Berndstown)\CADD\CADD_Sheets\36-5025-sidRamp08.dgn
2024



USER NAME = CBurke	DESIGNED - CMB	REVISED -
	DRAWN - CMB	REVISED -
PLOT SCALE = 6,0000 ' / In.	CHECKED - BMB	REVISED -
PLOT DATE = 2/28/2024	DATE - 10/01/2022	REVISED -

**STATE OF ILLINOIS
DEPARTMENT OF TRANSPORTATION**

**SANGAMON STREET - MULTI-USE PATH
SIDEWALK RAMP DETAILS**

SCALE: N/A SHEET 10 OF 15 SHEETS

SECTION	COUNTY	TOTAL SHEETS	SHEET NO.
21-00080-00-SW	CASS	35	29
CONTRACT NO. 93819			
ILLINOIS FED. AID PROJECT			

**4TH STREET /SANGAMON STREET INTERSECTION
EAST QUADRANT SIDEWALK**
HIGHWAY STD. 424011 - CORNER PARALLEL CURB RAMP

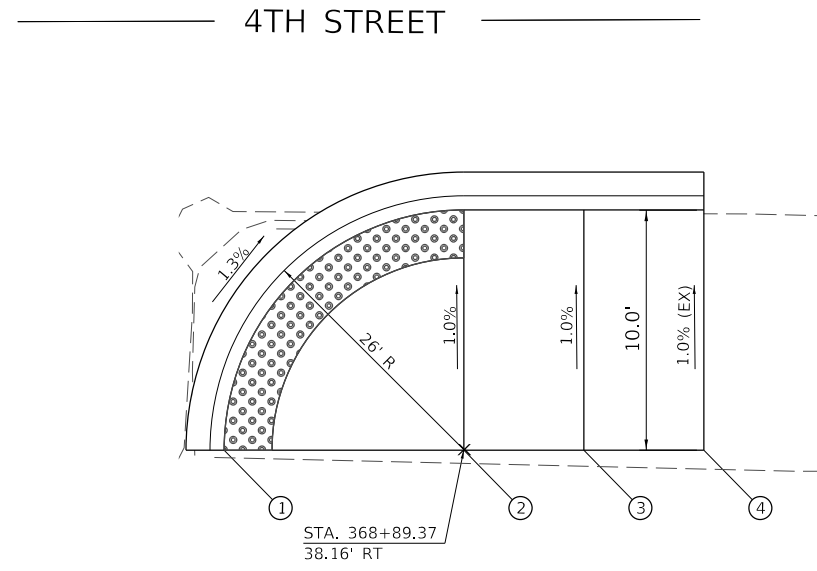

PT. #	STATION	OFFSET	ELEVATION
1	368+89.35	28.16' RT	445.07
2	368+89.35	38.16' RT	444.93
3	368+89.35	43.16' RT	445.32
4	368+89.35	48.16' RT	445.26

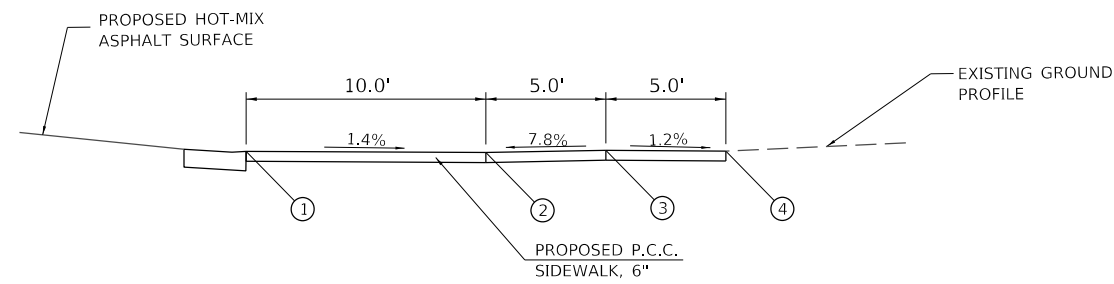

MODEL: Default
FILE: Model_V3.5025 - Sangamon St. Multi-Use Path (Beardstown)\CADD\CADD_Sheets\35-5025-sik-Ramp07.dgn
2024



USER NAME = CBurke	DESIGNED - CMB	REVISED -
	DRAWN - CMB	REVISED -
PLOT SCALE = 6,000' / In.	CHECKED - BMB	REVISED -
PLOT DATE = 2/28/2024	DATE - 10/01/2022	REVISED -

**STATE OF ILLINOIS
DEPARTMENT OF TRANSPORTATION**

**SANGAMON STREET - MULTI-USE PATH
SIDEWALK RAMP DETAILS**

SCALE: N/A SHEET 9 OF 15 SHEETS

SECTION	COUNTY	TOTAL SHEETS	SHEET NO.
21-00080-00-SW	CASS	35	28
CONTRACT NO. 93819			
ILLINOIS FED. AID PROJECT			

**3RD STREET /SANGAMON STREET INTERSECTION
WEST QUADRANT SIDEWALK**
HIGHWAY STD. 424011 - CORNER PARALLEL CURB RAMP

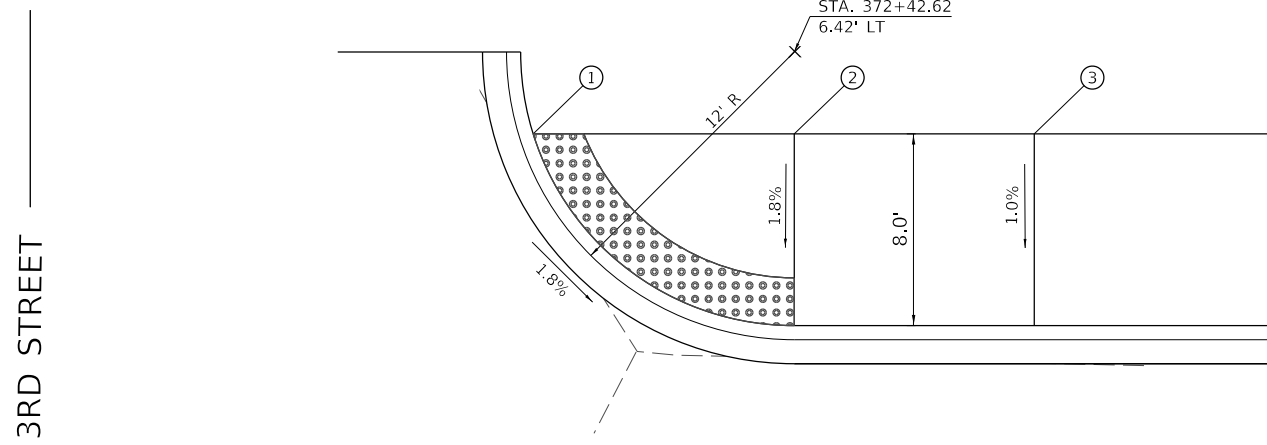

3RD STREET

PT. #	STATION	OFFSET	ELEVATION
1	372+31.73	3.00' LT	445.40
2	372+42.62	3.00' LT	445.24
3	372+52.62	3.00' LT	445.52

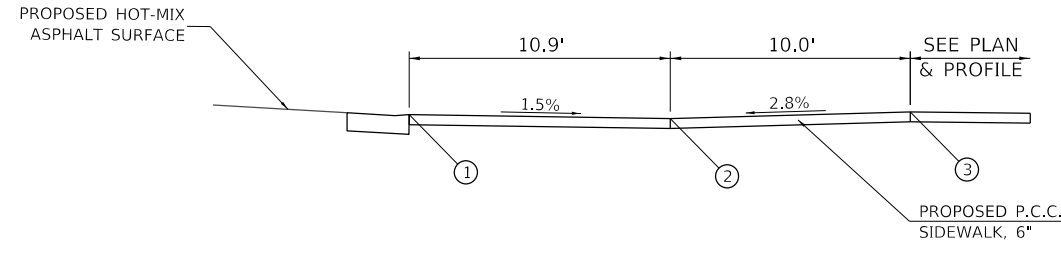

MODEL Path: \\hutchison\3rd-5angamon St Multi-Use Path (Berndtown)\CADD\CADD_Sheets\3rd-5025-sidRamp10.dgn
FILE Name: 03/2025 - 5angamon St Multi-Use Path (Berndtown)\CADD\CADD_Sheets\3rd-5025-sidRamp10.dgn
2024

HEI Hutchison Engineering, Inc.
JOB# 5025

USER NAME = CBurke	DESIGNED - CMB	REVISED -
	DRAWN - CMB	REVISED -
PLOT SCALE = 6,000' / In.	CHECKED - BMB	REVISED -
PLOT DATE = 2/28/2024	DATE - 10/01/2022	REVISED -

**STATE OF ILLINOIS
DEPARTMENT OF TRANSPORTATION**

**SANGAMON STREET - MULTI-USE PATH
SIDEWALK RAMP DETAILS**

SCALE: N/A SHEET 12 OF 15 SHEETS

SECTION	COUNTY	TOTAL SHEETS	SHEET NO.
21-00080-00-SW	CASS	35	31
CONTRACT NO. 93819			
ILLINOIS FED. AID PROJECT			

2ND STREET /SANGAMON STREET INTERSECTION
SOUTH QUADRANT SIDEWALK
 HIGHWAY STD. 424016 - MID-BLOCK CURB RAMPS FOR SIDEWALKS

————— SANGAMON ST —————

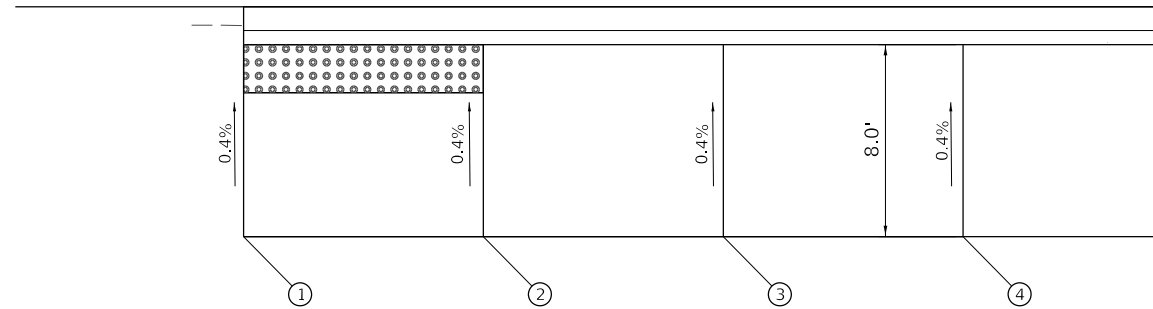

PT. #	STATION	OFFSET	ELEVATION
1	375+13.93	3.00' LT	443.08
2	375+03.93	3.00' LT	443.14
3	374+93.93	3.00' LT	443.64
4	374+83.93	3.00' LT	443.70

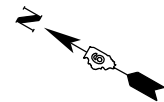
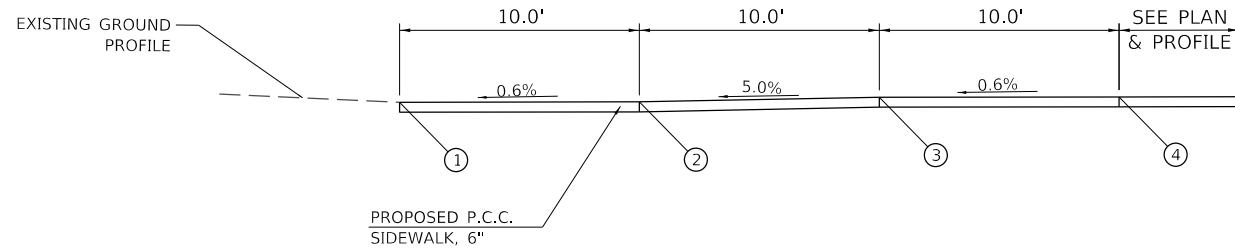

MODEL Path: \\hutchison\2024 - Sangamon St Multi-Use Path (Beaufortown)\CADD\CADD_Sheets\2024-03-15-SidewalkRamp11.dwg
 FILE NAME: 2024 - Sangamon St Multi-Use Path (Beaufortown)\CADD\CADD_Sheets\2024-03-15-SidewalkRamp11.dwg
 2024



USER NAME = C.Burke	DESIGNED - CMB	REVISED -
	DRAWN - CMB	REVISED -
PLOT SCALE = 8,0000' / In.	CHECKED - BMB	REVISED -
PLOT DATE = 2/28/2024	DATE - 10/01/2022	REVISED -

STATE OF ILLINOIS
DEPARTMENT OF TRANSPORTATION

SANGAMON STREET – MULTI-USE PATH
SIDEWALK RAMP DETAILS

SCALE: N/A SHEET 13 OF 15 SHEETS

SECTION	COUNTY	TOTAL SHEETS	SHEET NO.
21-00080-00-SW	CASS	35	32
		CONTRACT NO. 93819	
		ILLINOIS FED. AID PROJECT	

2ND STREET /SANGAMON STREET INTERSECTION
NORTH QUADRANT SIDEWALK
 HIGHWAY STD. 424011 - CORNER PARALLEL CURB RAMP

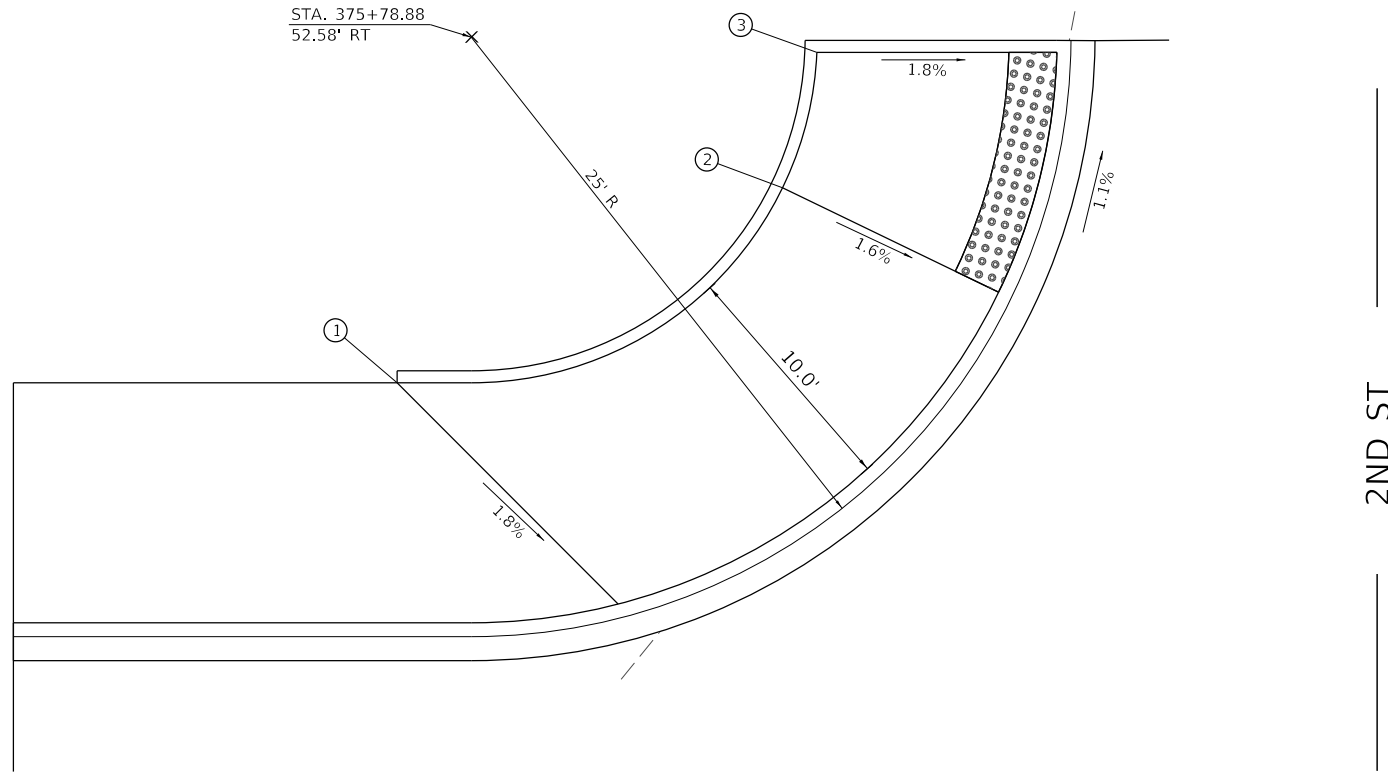

PT. #	STATION	OFFSET	ELEVATION
1	375+81.98	38.17' RT	441.78
2	375+65.90	46.30' RT	441.47
3	375+64.48	51.95' RT	441.36

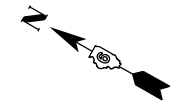
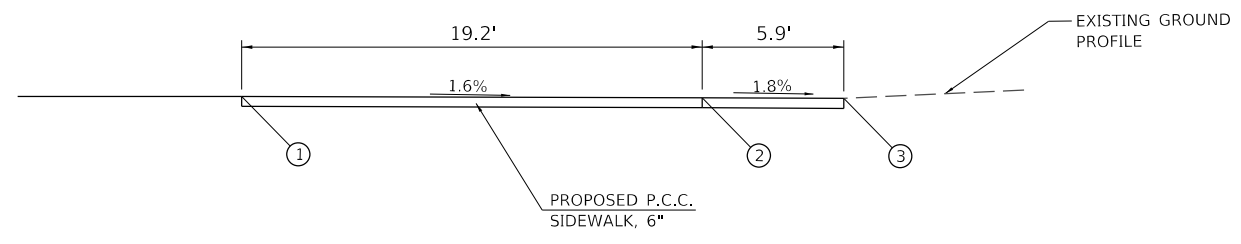

MODEL Default
 FILE Name: E:\5025 - Sangamon St. Multi-Use Path (Beaufortown)\CADD\CADD_Sheets\131-5025-sht-Ramp13.dgn
 2024



USER NAME = C.Burke	DESIGNED - CMB	REVISED -
	DRAWN - CMB	REVISED -
PLOT SCALE = 8,000' / In.	CHECKED - BMB	REVISED -
PLOT DATE = 2/28/2024	DATE - 10/01/2022	REVISED -

STATE OF ILLINOIS
DEPARTMENT OF TRANSPORTATION

SANGAMON STREET - MULTI-USE PATH SIDEWALK RAMP DETAILS		SECTION	COUNTY	TOTAL SHEETS	SHEET NO.
		21-00080-00-SW	CASS	35	34
SCALE: N/A		SHEET 15 OF 15 SHEETS		CONTRACT NO. 93819	
		ILLINOIS		FED. AID PROJECT	

(A) INLET (B-10)
 STA. 127+22.07, 9.00' LT
 FL = 442.10
 S INV = 439.81
 NW INV = 439.71

(B) (SSWMR) (TB)
 12"x22" @1.00% 2.9

(C) INLET (A-1-0)
 STA. 127+16.71, 13.46' RT
 LID = 442.40 (EX)
 N INV = 440.03

(D) MH TO BE RECONSTRUCTED
 (W/ TYPE A-1-0, F&G, AND FST)
 STA. 127+17.42, 19.27' LT
 LID = 442.60
 PR SE INV = 439.61

(E) (SSWMR) (TB)
 12"x10" @1.00% 1.6

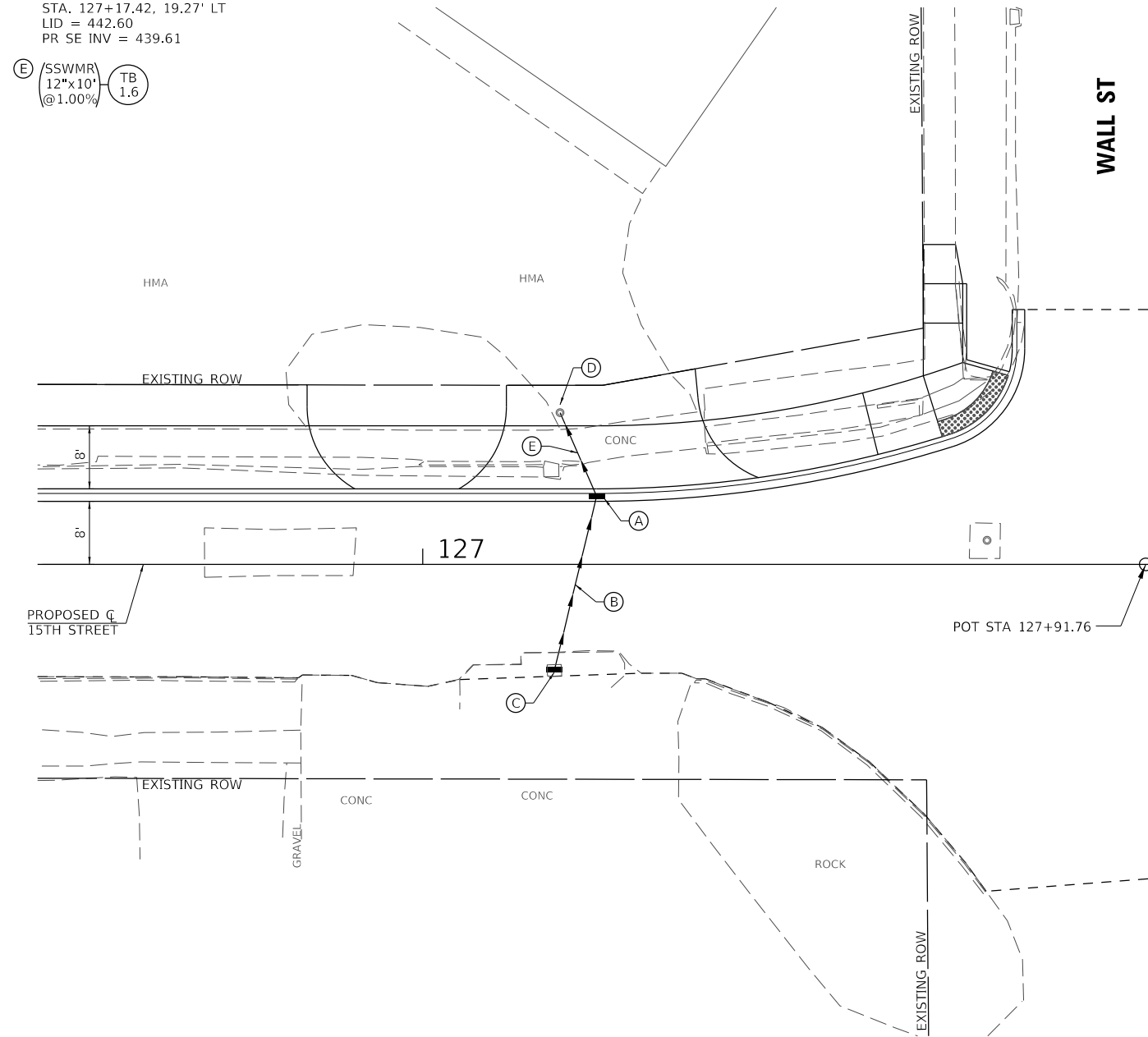

(A) INLET (A-11)
 STA. 368+99.95, 44.16' RT
 TC = 445.20
 W INV = 442.41

(B) (SSWMR) (TB)
 12"x20" @1.00% 3.1

(C) (SSWMR) (TB)
 12"x18" @1.00% 2.8

(D) INLET (A-11)
 STA. 369+34.70, 31.93' RT
 TC = 445.22
 S INV = 442.43

(E) INLET (A-11)
 STA. 368+99.95, 6.50' LT
 TC = 445.28
 NE INV = 442.35

(F) (SSWMR) (TB)
 12"x34" @1.00% 5.9

(G) INLET (A-10)
 STA. 369+32.86, 6.77' LT
 FL = 444.66
 E INV = 442.37

(H) (SSWMR) (TB)
 12"x36" @1.00% 5.5

(I) MH TO BE RECONSTRUCTED
 (W/ TYPE A-1-C, F&G, AND FST)
 STA. 369+14.59, 26.49' RT
 L = 445.34 (EX)
 PR E INV = 442.21
 PR SW INV = 442.01
 PR W INV = 442.01
 PR N INV = 442.15

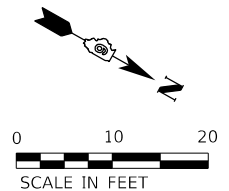
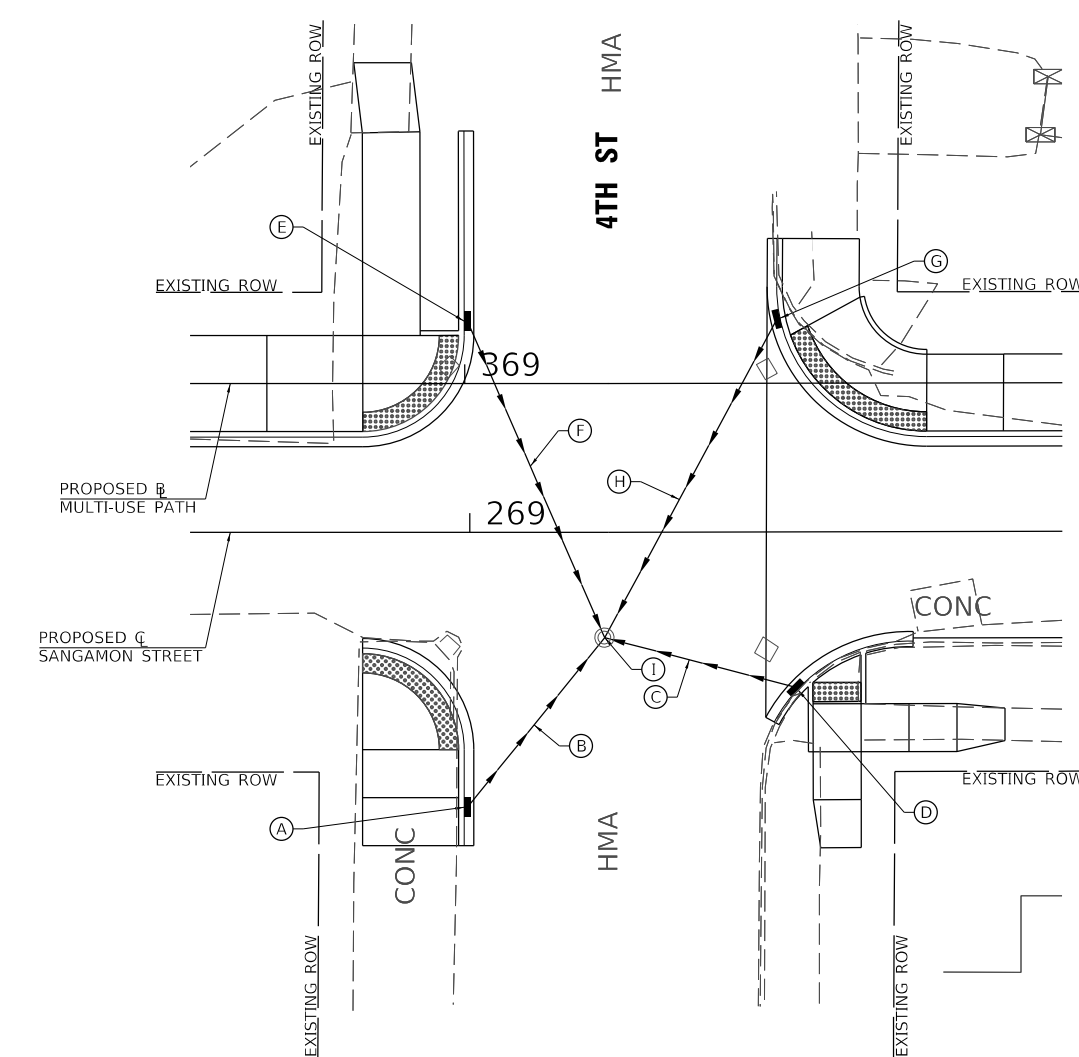

MODEL: D:\a\11 - Sangamon St Multi-Use Path (Beaufortown)\CADD\CADD_Sheets\132-5025-5th-Drainage02.dwg
 FILE: 5/15/2025 - 5:00:00 PM
 JOB# 5025



USER NAME = Cburke	DESIGNED - CMB	REVISED -
DRAWN - CMB	REVISIONS -	
PLOT SCALE = 20,0000 ' / In.	CHECKED - BMB	REVISED -
PLOT DATE = 2/28/2024	DATE - 01/17/2024	REVISED -

STATE OF ILLINOIS
DEPARTMENT OF TRANSPORTATION

15TH STREET, SANGAMON STREET - MULTI-USE PATH
DRAINAGE DETAILS

SECTION	COUNTY	TOTAL SHEETS	SHEET NO.
21-00080-00-SW	CASS	35	35
CONTRACT NO. 93819			
ILLINOIS FED. AID PROJECT			

SCALE: 1"=10'-0" SHEET 1 OF 1 SHEETS