

ROUTE	SECTION	COUNTY	TOTAL SHEETS	SHEET
FAS 950	21-00140-00-FP	JASPER	3	1
		ILLINOIS	CONTRACT NO. 95962	

INDEX OF SHEETS

1. COVER SHEET
2. SUMMARY OF QUANTITIES & GENERAL NOTES
3. TYPICAL SECTIONS

HIGHWAY STANDARDS:

- 701901-09 TRAFFIC CONTROL DEVICES
- BLR 21-9 TYPICAL APPLICATION OF TRAFFIC CONTROL DEVICES FOR CONSTRUCTION ON RURAL LOCAL HIGHWAYS

STATE OF ILLINOIS
DEPARTMENT OF TRANSPORTATION
DIVISION OF HIGHWAYS
PLANS FOR PROPOSED
SURFACE TRANSPORTATION PROGRAM
TRUCK ACCESS ROUTE PROJECT

FAS 950 (CH 10)
SECTION 21-00140-00-FP
JASPER COUNTY
JOB NO. C-97-053-24
PROJECT. Q4C0(323)
CONTRACT 95962

THESE PLANS WERE PREPARED BY ME, OR A FULL TIME MEMBER OF MY STAFF, WORKING UNDER MY PERSONAL SUPERVISION.



3/22/24

ILLINOIS REGISTERED PROFESSIONAL ENGINEER # 062.064183
 LICENSE EXPIRES NOVEMBER 30, 2025
 JASPER COUNTY HIGHWAY DEPARTMENT
 12871 EAST STATE HIGHWAY 33
 NEWTON, ILLINOIS 62448
 PHONE 618-783-2915

DATE

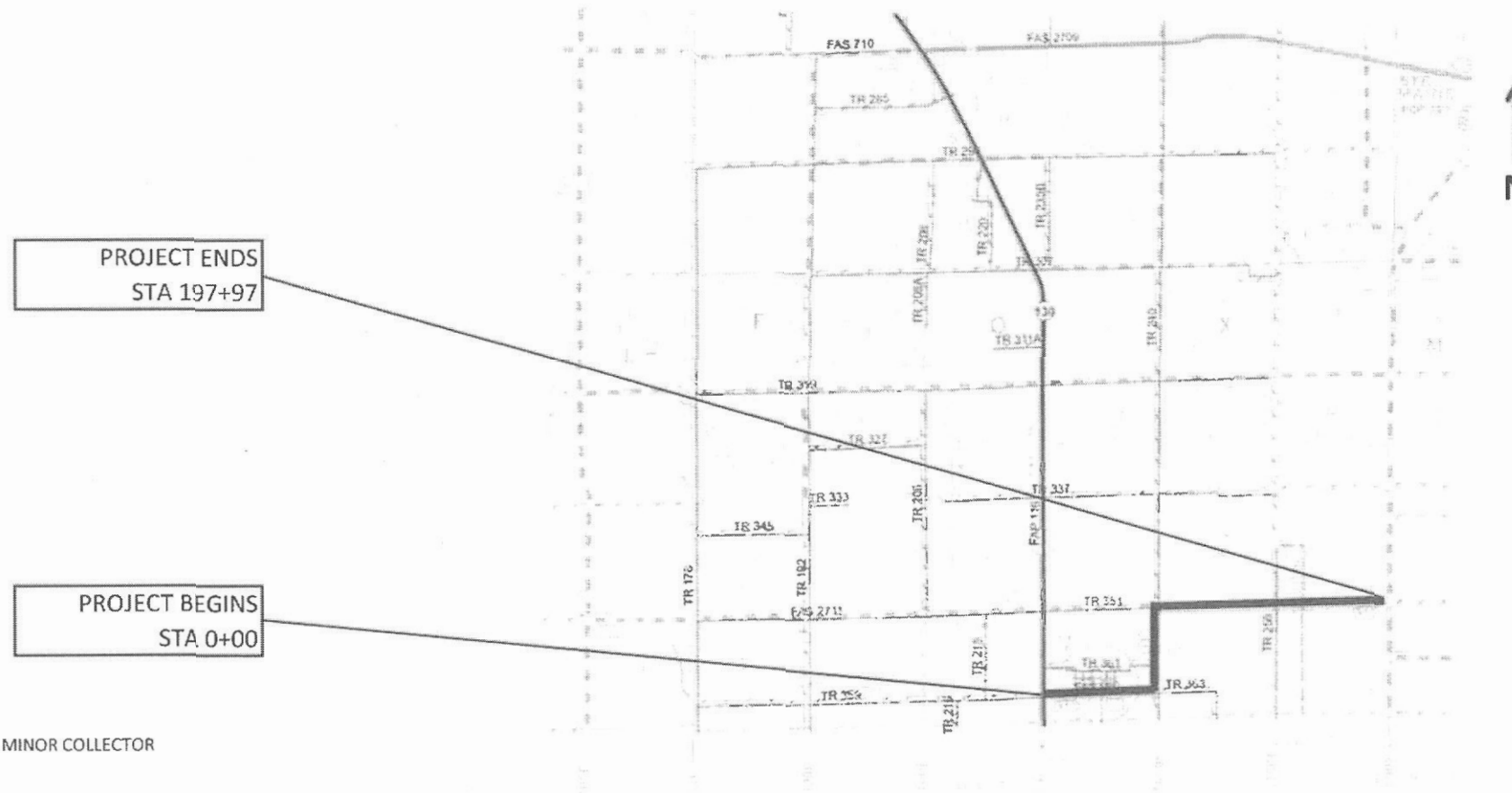

PROJECT ENDS
STA 197+97

PROJECT BEGINS
STA 0+00

FUNCTIONAL CLASS = RURAL MINOR COLLECTOR
 ADT = 350
 DESIGN SPEED = 40 MPH

TOLL FREE JOINT UTILITY LOCATING
 INFORMATION FOR EXCAVATORS (J.U.L.I.E.)
 TELEPHONE NO. 1-800-892-0123

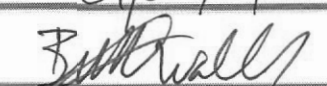

LOCATION MAP
 LENGTH = 19,797.0 FT (3.75 MILES)
 (NOT TO SCALE)

APPROVED <u>March 22nd 24</u>  COUNTY ENGINEER	
PASSED <u>04/02/24</u>  DISTRICT SEVEN ENGINEER OF LOCAL ROADS & STREETS	
RELEASING FOR BID BASED ON LIMITED REVIEW <u>04/02/24</u>  REGION FOUR ENGINEER	
STATE OF ILLINOIS DEPARTMENT OF TRANSPORTATION	

ROUTE	SECTION	COUNTY	TOTAL SHEETS	SHEET
FAS 950	21-00140-00-FP	JASPER	3	2
		ILLINOIS	CONTRACT NO. 95962	

SUMMARY OF QUANTITIES

CODE NO.	ITEM	UNIT	TOTAL QUANTITY
35200300	PROCESSING SOIL-CEMENT BASE COURSE 8"	SQ YD	48,393
35200500	CEMENT	100 WT	25,648
67100100	MOBILIZATION	L SUM	1
LR403400	BITUMINOUS MATERIALS (COVER AND SEAL COATS)	TON	126

SUPERELEVATION TRANSITION TABLES

CURVE #1 (SOUTH/WEST END)			
S.E. DETAIL POINT	STATION	LEFT SLOPE (%)	RIGHT SLOPE (%)
A	48+14.9	-2	-2
B	48+54.9	-2	0
C	48+93.65	-2	2
D	49+32.4	-4	4
E	49+71.15	-6	6
F	50+09.9	-8	8

CURVE #1 (NORTH/EAST END)			
S.E. DETAIL POINT	STATION	LEFT SLOPE (%)	RIGHT SLOPE (%)
F	54+90.3	-8	8
E	55+29.05	-6	6
D	55+67.8	-4	4
C	56+06.55	-2	2
B	56+45.3	-2	0
A	56+85.3	-2	-2

CURVE #2 (SOUTH/WEST END)			
S.E. DETAIL POINT	STATION	LEFT SLOPE (%)	RIGHT SLOPE (%)
A	87+31.45	-2	-2
B	87+71.45	0	-2
C	88+10.2	2	-2
D	88+48.95	4	-4
E	88+87.7	6	-6
F	89+26.45	8	-8

CURVE #2 (NORTH/EAST END)			
S.E. DETAIL POINT	STATION	LEFT SLOPE (%)	RIGHT SLOPE (%)
F	94+03.95	8	-8
E	94+42.7	6	-6
D	94+81.45	4	-4
C	95+20.2	2	-2
B	95+58.95	0	-2
A	95+98.95	-2	-2

GENERAL NOTES

CARE SHALL BE TAKEN SUCH THAT EXISTING CULVERTS ARE NOT DAMAGED DURING PULVERIZATION AND BASE PROCESSING. A GAP IN THE PROCESSING MAY BE REQUIRED AT LOCATIONS WHERE CULVERTS HAVE LIMITED COVER BUT THE DEPTH OF COVER SHALL NOT BE REDUCED.

THE FOLLOWING RATES HAVE BEEN USED TO CALCULATE PLAN QUANTITY

RATE OF CEMENT APPLICATION	8% BY WEIGHT
BITUMINOUS MATERIALS	
COVER COAT (PG 46-28)	0.32 GAL/SQ YD
SEAL COAT (HFRS-2P)	0.30 GAL/SQ YD

THE CURE COAT AGGREGATE SHALL BE SPREAD FOR THE PROJECT BY THE CONTRACTOR BUT SHALL BE FURNISHED AND STOCKPILED BY THE COUNTY AT THE FOLLOWING LOCATION:

JASPER COUNTY HIGHWAY DEPARTMENT
12871 E. STATE HWY 33
NEWTON, IL 62448

THE COVER COAT AND SEAL COAT AGGREGATE SHALL BE FURNISHED AND SPREAD BY THE COUNTY.

THE TRAFFIC CONTROL FOR THIS PROJECT SHALL BE PERFORMED BY THE COUNTY.

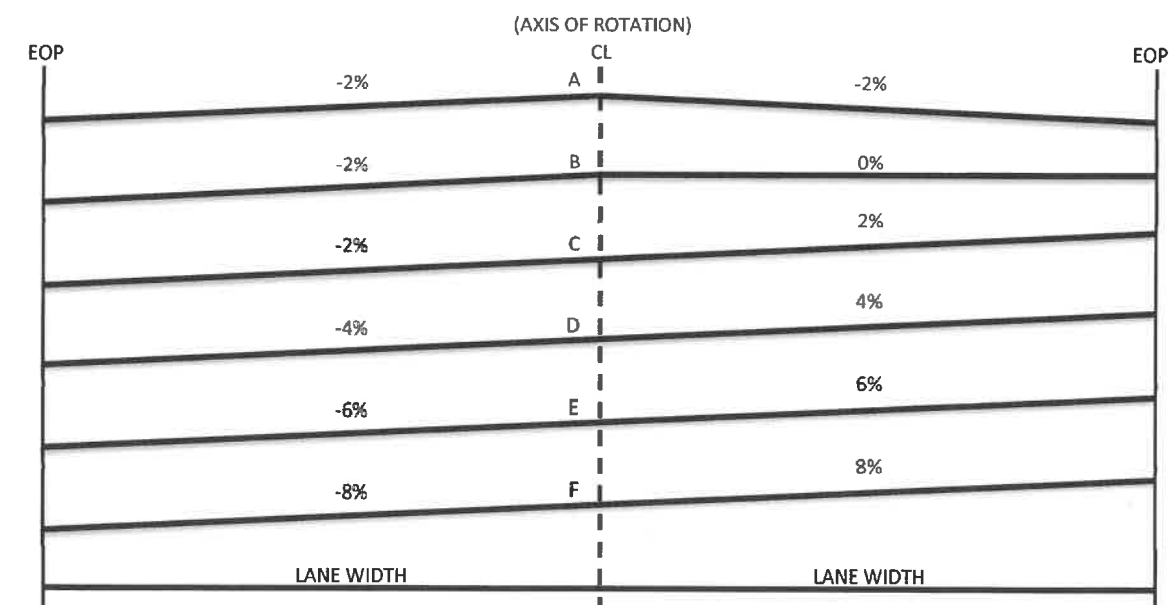

SUPERELEVATION TRANSITION DETAIL (NOT TO SCALE)

ROUTE	SECTION	COUNTY	TOTAL SHEETS	SHEET
FAS 950	21-00140-00-FP	JASPER	3	3
		ILLINOIS	CONTRACT NO. 95962	

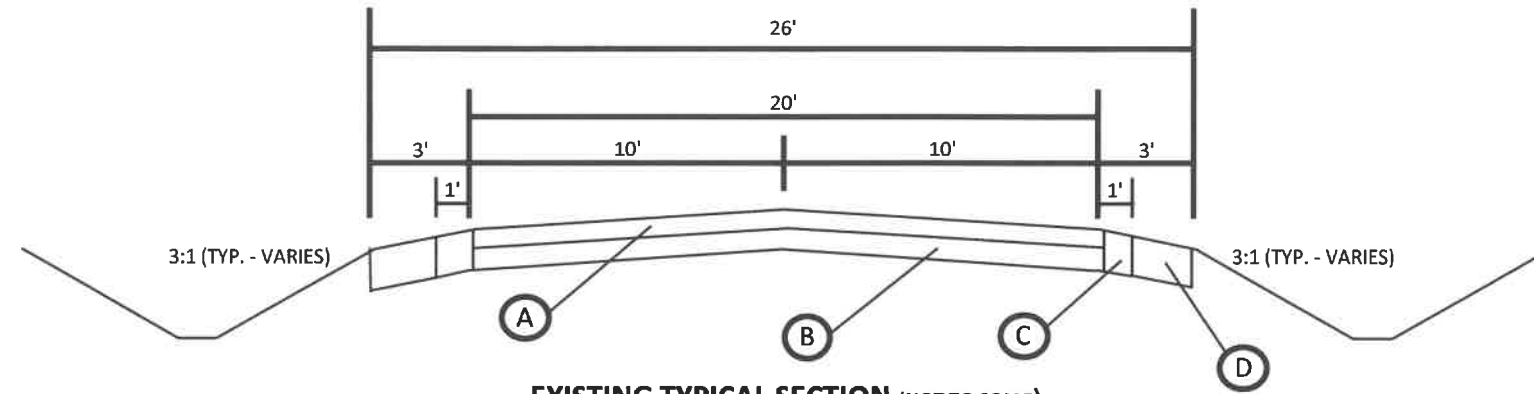

EXISTING TYPICAL SECTION (NOT TO SCALE)
 (STA. 0+00 - STA. 50+09.9, STA. 54+90.3 - STA. 89+26.45, STA. 94+03.95 - STA. 197+97)

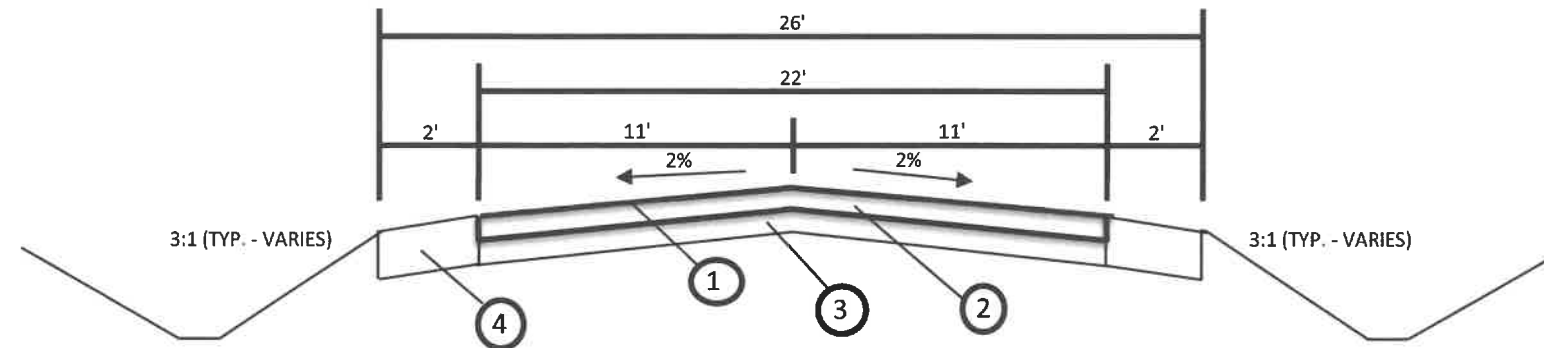

PROPOSED TYPICAL SECTION (NOT TO SCALE)
 (STA. 0+00 - STA. 50+09.9, STA. 54+90.3 - STA. 89+26.45, STA. 94+03.95 - STA. 197+97)

- (A) EXISTING OIL AND CHIP SURFACE $\pm 7''$
- (B) EXISTING AGGREGATE BASE $\pm 8''$
- (C) EXISTING AGGREGATE SHOULDER
- (D) EXISTING EARTH SHOULDER

- (1) PROPOSED BITUMINOUS MATERIALS COVER AND SEAL COAT
 (COVER AND SEAL COAT AGGRAGATE TO BE FURNISHED AND SPREAD BY JASPER COUNTY HIGHWAY DEPARTMENT)
- (2) PROPOSED SOIL-CEMENT BASE COURSE 8"
- (3) REMAINING EXISTING AGGREGATE BASE $\pm 7''$
- (4) REMAINING EXISTING EARTH SHOULDER

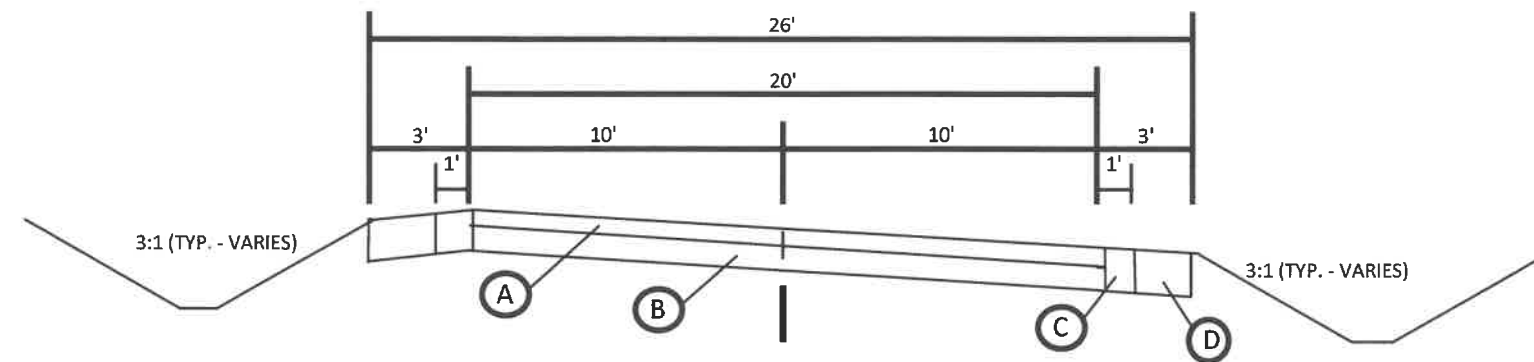

EXISTING TYPICAL SECTION (NOT TO SCALE)
 (STA. STA. 50+09.9 - STA. 54+90.3 - LEFT CURVE, STA. 89+26.45 - STA. 94+03.95 - RIGHT CURVE)

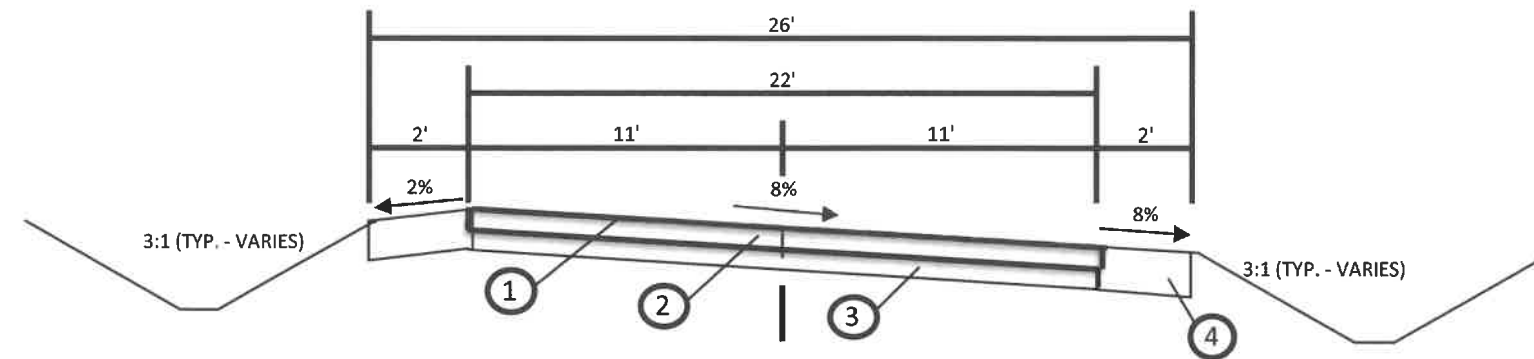

PROPOSED TYPICAL SECTION (NOT TO SCALE)
 (STA. STA. 50+09.9 - STA. 54+90.3 - LEFT CURVE, STA. 89+26.45 - STA. 94+03.95 - RIGHT CURVE)

EXISTING HORIZONTAL CURVE INFORMATION

CURVE #1 (LEFT)	CURVE #2 (RIGHT)
P.C. STA. 50+09.90	P.C. STA. 89+26.45
P.I. STA. 53+19.30	P.I. STA. 92+32.80
P.T. STA. 54+90.30	P.T. STA. 94+03.95
Δ 96° 46'	Δ 91° 12'
D 19° 06'	D 19° 06'
T 309.4 FT	T 306.35 FT
L 480.4 FT	L 477.5 FT
R 300 FT	R 300 FT
E 130.96 FT	E 128.78 FT
e 8.0%	e 8.0%

SEE PAGE 2 FOR SUPERELEVATION TRANSITION INFORMATION