

FILE NAME = p:\1\h-pw-bentley\jucumtkh-pw-01\Documents\01 Active Projects\WV-CIS-16695100 - IL 64\Phase 1\2 Design\CAD\Plan Sheets\Signal\East Corridor - Signal\0108121-int-15-18\_CAI.DGN

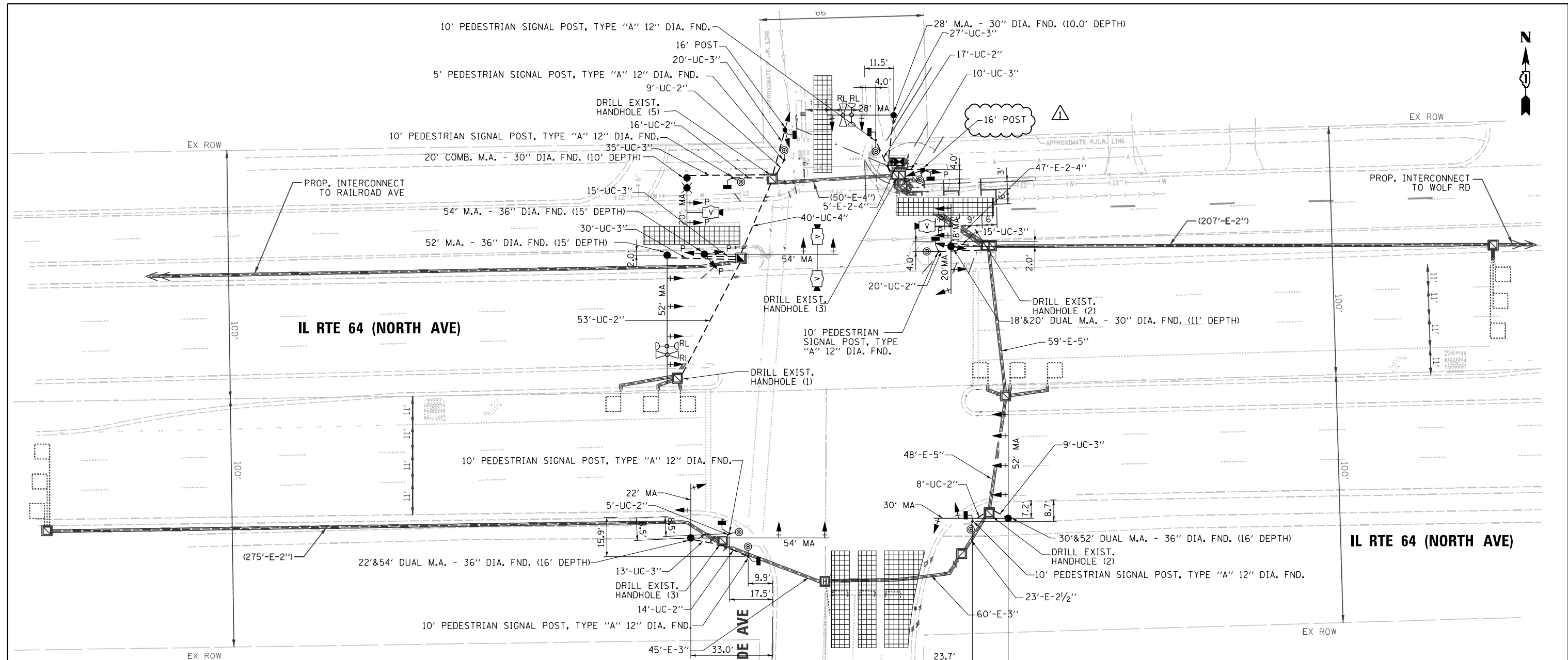

**NOTES:**

1. THE LOOP DETECTORS AND ASSOCIATED CONDUITS ON THE SIDE STREET SHALL BE ABANDONED.
2. ALL EXISTING TRAFFIC SIGNAL CABLE NO LONGER REQUIRED SHALL BE REMOVED.
3. ALL DIMENSIONS ARE FROM EXISTING BACK OF CURB TO CENTER OF POST.
4. ALL PROPOSED TRAFFIC SIGNAL CABLE SHALL BE ROUTED THROUGH THE PROPOSED CONDUIT.
5. THERE SHALL BE A MINIMUM OF 4' SIDEWALK CLEARANCE IN FRONT/BEHIND OF THE TRAFFIC SIGNAL FOUNDATIONS TO BE ADA COMPLIANT.
6. ALL PROPOSED PUSH-BUTTONS SHALL BE APS.
7. THIS LOCATION HAS BEEN DESIGNED TO BE ADA COMPLIANT. ANY DEVIATION FROM THIS PLAN FOR THE POSTS THAT HAVE PEDESTRIAN EQUIPMENT WILL HAVE TO BE APPROVED BY THE ENGINEER TO ENSURE ADA COMPLIANCE.
8. CONTRACTOR SHALL VERIFY THAT THE PLACEMENT OF THE PROPOSED SIGNAL EQUIPMENT ADJACENT TO EXISTING RAMPS MEET ADA REQUIREMENTS. THE ENGINEER SHALL APPROVE THE PROPOSED LOCATIONS OF THE SIGNAL EQUIPMENT BEFORE INSTALLATION.

REVISION 1 REVISED SHEET 6/4/2024

**TS 21850  
IDOT CENTRACS  
FORMER ECON 99**

<p><b>GANDHI AND ASSOCIATES, INC.</b> ENGINEERS AND PLANNERS 5035 N. NORTHWEST HIGHWAY SUITE 206 CHICAGO, ILLINOIS 60630 TEL: 773-774-5900</p>	USER NAME = \$USER\$	DESIGNED - AV, EA	REVISED - 05/31/2024
		DRAWN - AV, EA	REVISED -
	PLOT SCALE = 48.0000' / in.	CHECKED - MS	REVISED -
	PLOT DATE = \$DATE\$	DATE - 3/22/2024	REVISED -

**STATE OF ILLINOIS  
DEPARTMENT OF TRANSPORTATION**

**TRAFFIC SIGNAL MODERNIZATION PLAN  
IL RTE 64 (NORTH AVE) AT HILLSIDE AVE**

SCALE: 1"=20'    SHEET NO.    OF    SHEETS    STA.    TO    STA.

F.A.P. RTE.	SECTION	COUNTY	TOTAL SHEETS	SHEET NO.
307	2020-263-SUR, SW&TS	COOK	492	154
CONTRACT NO. 62N40				
FED. ROAD DIST. NO. - ILLINOIS FED. AID PROJECT				

**SIGN PANEL – TYPE 1 OR TYPE 2**

ALL DIMENSIONS ARE IN INCHES UNLESS OTHERWISE NOTED



DESIGN SERIES	AREA (SQ FT)	SIGN PANEL TYPE	SHEETING TYPE	QTY. REQUIRED
D	12.5	2	ZZ	2

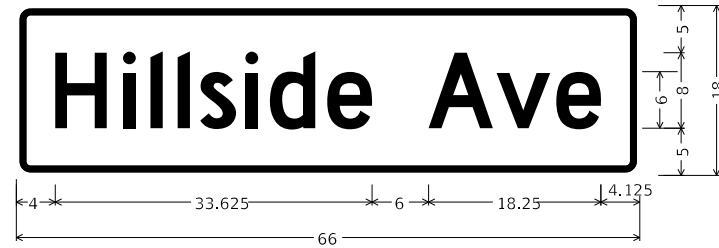

DESIGN SERIES	AREA (SQ FT)	SIGN PANEL TYPE	SHEETING TYPE	QTY. REQUIRED
D	8.25	1	ZZ	2

NOTE: FOR ADDITIONAL DESIGN AND INSTALLATION INFORMATION PLEASE SEE DISTRICT ONE MAST ARM MOUNTED STREET NAME SIGNS DETAIL (TS-02).

**SCHEDULE OF QUANTITIES**

ITEM DESCRIPTION	UNITS	TOTAL QTY.
SIGN PANEL - TYPE 1	SQ FT	16.5
SIGN PANEL - TYPE 2	SQ FT	25
SERVICE INSTALLATION - GROUND MOUNTED	EACH	1
UNDERGROUND CONDUIT, GALVANIZED STEEL, 2" DIA.	FOOT	142
UNDERGROUND CONDUIT, GALVANIZED STEEL, 3" DIA.	FOOT	174
UNDERGROUND CONDUIT, GALVANIZED STEEL, 4" DIA.	FOOT	40
MAINTENANCE OF EXISTING TRAFFIC SIGNAL INSTALLATION	EACH	1
ELECTRIC CABLE IN CONDUIT, SIGNAL NO. 14 2C	FOOT	1365
ELECTRIC CABLE IN CONDUIT, SIGNAL NO. 14 3C	FOOT	1754
ELECTRIC CABLE IN CONDUIT, SIGNAL NO. 14 5C	FOOT	4425
ELECTRIC CABLE IN CONDUIT, SIGNAL NO. 14 7C	FOOT	2115
ELECTRIC CABLE IN CONDUIT, LEAD-IN, NO. 14 1 PAIR	FOOT	2044
ELECTRIC CABLE IN CONDUIT, EQUIPMENT GROUNDING CONDUCTOR, NO. 6 1C	FOOT	961
TRAFFIC SIGNAL POST, GALVANIZED STEEL 16 FT.	EACH	2
<del>STEEL MAST ARM ASSEMBLY AND POLE, 28 FT.</del>	<del>EACH</del>	<del>1</del>
STEEL MAST ARM ASSEMBLY AND POLE, 52 FT.	EACH	1
STEEL MAST ARM ASSEMBLY AND POLE, 54 FT.	EACH	1
STEEL MAST ARM ASSEMBLY AND POLE WITH DUAL MAST ARMS, 22 FT. AND 54 FT.	EACH	1
STEEL COMBINATION MAST ARM ASSEMBLY AND POLE, 20 FT.	EACH	1
CONCRETE FOUNDATION, TYPE A	FOOT	12
CONCRETE FOUNDATION, TYPE E 30-INCH DIAMETER	FOOT	31
CONCRETE FOUNDATION, TYPE E 36-INCH DIAMETER	FOOT	62
DRILL EXISTING HANDHOLE	EACH	16
SIGNAL HEAD, LED, 1-FACE, 3-SECTION, MAST ARM MOUNTED	EACH	12
SIGNAL HEAD, LED, 1-FACE, 3-SECTION, BRACKET MOUNTED	EACH	3
SIGNAL HEAD, LED, 1-FACE, 4-SECTION, BRACKET MOUNTED	EACH	1
SIGNAL HEAD, LED, 1-FACE, 4-SECTION, MAST ARM MOUNTED	EACH	1
SIGNAL HEAD, LED, 1-FACE, 5-SECTION, MAST ARM MOUNTED	EACH	4
OPTICALLY PROGRAMMED SIGNAL HEAD, LED, 1-FACE, 3-SECTION, BRACKET MOUNTED	EACH	4
OPTICALLY PROGRAMMED SIGNAL HEAD, LED, 1-FACE, 3-SECTION, MAST ARM MOUNTED	EACH	5
OPTICALLY PROGRAMMED SIGNAL HEAD, LED, 1-FACE, 4-SECTION, BRACKET MOUNTED	EACH	1
OPTICALLY PROGRAMMED SIGNAL HEAD, LED, 1-FACE, 4-SECTION, MAST ARM MOUNTED	EACH	2
PEDESTRIAN SIGNAL HEAD, LED, 1-FACE, BRACKET MOUNTED WITH COUNTDOWN TIMER	EACH	8
TRAFFIC SIGNAL BACKPLATE, LOUVERED, FORMED PLASTIC	EACH	24
INDUCTIVE LOOP DETECTOR	EACH	8
* RELOCATE EXISTING EMERGENCY VEHICLE PRIORITY SYSTEM, DETECTOR UNIT	EACH	2
* RELOCATE EXISTING EMERGENCY VEHICLE PRIORITY SYSTEM, PHASING UNIT	EACH	1
REMOVE ELECTRIC CABLE FROM CONDUIT	EACH	9800
REMOVE EXISTING TRAFFIC SIGNAL EQUIPMENT	EACH	1
REMOVE EXISTING HANDHOLE	EACH	1
REMOVE EXISTING CONCRETE FOUNDATION	EACH	13
* EMERGENCY VEHICLE PRIORITY SYSTEM LINE SENSOR CABLE, NO. 20 3/C	FOOT	322
CENTRACS LICENSE EXPANSION	EACH	1
LAYER II (DATALINK) SWITCH	EACH	1
TERMINATE FIBER IN CABINET	EACH	36
PEDESTRIAN SIGNAL POST, 10 FT.	EACH	6
PEDESTRIAN SIGNAL POST, 5 FT.	EACH	1
VIDEO VEHICLE DETECTION SYSTEM, SINGLE APPROACH	EACH	4
LED SIGNAL FACE VISOR HEATER	EACH	33
ADVANCED TRANSPORTATION CONTROLLER AND TYPE IV CABINET, SPECIAL	EACH	1
UNINTERRUPTABLE POWER SUPPLY, SPECIAL	EACH	1
ACCESSIBLE PEDESTRIAN SIGNALS	EACH	8
CONCRETE FOUNDATION, TYPE A 12-INCH DIAMETER	FOOT	28
FIBER OPTIC INTERCONNECT CENTER, 48 PORT	EACH	1
STEEL MAST ARM ASSEMBLY AND POLE WITH DUAL MAST ARMS, 18 FT. AND 20 FT.	EACH	1
STEEL MAST ARM ASSEMBLY AND POLE WITH DUAL MAST ARMS, 30 FT. AND 52 FT.	EACH	1

\* 100% COST TO THE CITY OF NORTHLAKE

MODEL: Default FILE: \\nas01\pub\pwbentley.com\hpb\p-01\Documents\01\_Active Projects\MK-CUS-168959100 - IL 64\Phase 02\_Design\CAD\Plan\_Sheets\WOT\East\_Corridor\108121-ent-S5-04\_KHA.dgn



USER NAME = JoelTurk	DESIGNED - AMK	REVISED - 06/02/2024
PLOT SCALE = 2,0000' / in.	CHECKED - SS	REVISED -
PLOT DATE = 3/22/2024	DATE - 3/22/2024	REVISED -

STATE OF ILLINOIS  
DEPARTMENT OF TRANSPORTATION

MAST ARM MOUNTED STREET NAME SIGNS  
AND SCHEDULE OF QUANTITIES  
IL RTE 64 (NORTH AVE) AND HILLSIDE AVE

SCALE: SHEET 1 OF SHEETS STA. TO STA.

F.A.P. RTE.	SECTION	COUNTY	TOTAL SHEETS	SHEET NO.
307	2020-264-SUR-SW&TS	COOK	492	157
CONTRACT NO. 62N40				
ILLINOIS FED. AID PROJECT				

REVISION 1 REVISED SHEET 6/4/2024

TS 21850  
IDOT CENTRICS  
FORMER ECN 99

**SIGN PANEL – TYPE 1 OR TYPE 2**

ALL DIMENSIONS ARE IN INCHES UNLESS OTHERWISE NOTED



DESIGN SERIES	AREA (SQ FT)	SIGN PANEL TYPE	SHEETING TYPE	QTY. REQUIRED
D	12.5	2	ZZ	2

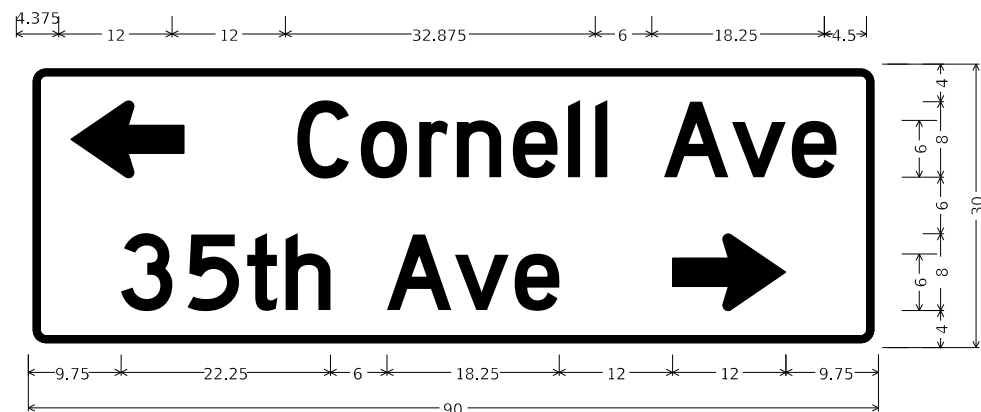

DESIGN SERIES	AREA (SQ FT)	SIGN PANEL TYPE	SHEETING TYPE	QTY. REQUIRED
D	18.75	2	ZZ	1



DESIGN SERIES	AREA (SQ FT)	SIGN PANEL TYPE	SHEETING TYPE	QTY. REQUIRED
D	18.75	2	ZZ	1

NOTE: FOR ADDITIONAL DESIGN AND INSTALLATION INFORMATION PLEASE SEE DISTRICT ONE MAST ARM MOUNTED STREET NAME SIGNS DETAIL (TS-02).

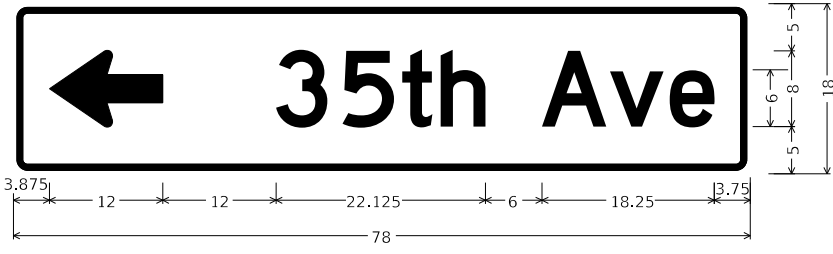

DESIGN SERIES	AREA (SQ FT)	SIGN PANEL TYPE	SHEETING TYPE	QTY. REQUIRED
D	9.75	2	ZZ	1

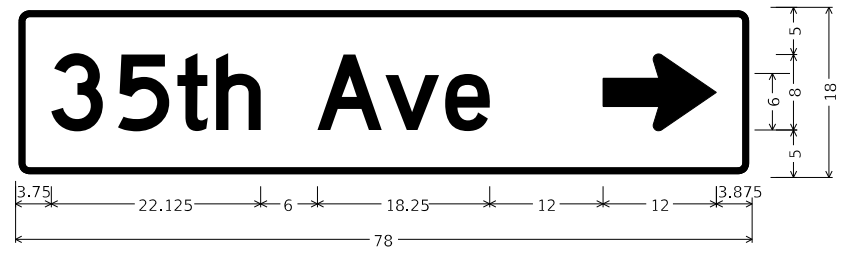

DESIGN SERIES	AREA (SQ FT)	SIGN PANEL TYPE	SHEETING TYPE	QTY. REQUIRED
D	9.75	2	ZZ	1

**SCHEDULE OF QUANTITIES**

ITEM DESCRIPTION	UNITS	TOTAL QTY.
SIGN PANEL - TYPE 2	SQ FT	82
UNDERGROUND CONDUIT, GALVANIZED STEEL, 2" DIA.	FOOT	143
UNDERGROUND CONDUIT, GALVANIZED STEEL, 3" DIA.	FOOT	56
UNDERGROUND CONDUIT, GALVANIZED STEEL, 4" DIA.	FOOT	428
HANDHOLE	EACH	2
MAINTENANCE OF EXISTING TRAFFIC SIGNAL INSTALLATION	EACH	1
ELECTRIC CABLE IN CONDUIT, SIGNAL NO. 14 2C	FOOT	1344
ELECTRIC CABLE IN CONDUIT, SIGNAL NO. 14 3C	FOOT	2092
ELECTRIC CABLE IN CONDUIT, SIGNAL NO. 14 5C	FOOT	4090
ELECTRIC CABLE IN CONDUIT, SIGNAL NO. 14 7C	FOOT	1318
ELECTRIC CABLE IN CONDUIT, LEAD-IN, NO. 14 1 PAIR	FOOT	1511
ELECTRIC CABLE IN CONDUIT, SERVICE, NO. 6 2C	FOOT	79
ELECTRIC CABLE IN CONDUIT, EQUIPMENT GROUNDING CONDUCTOR, NO. 6 1C	FOOT	506
TRAFFIC SIGNAL POST, GALVANIZED STEEL 16 FT.	EACH	2
STEEL MAST ARM ASSEMBLY AND POLE, 56 FT.	EACH	1
STEEL MAST ARM ASSEMBLY AND POLE, 60 FT.	EACH	1
CONCRETE FOUNDATION, TYPE A	FOOT	12
CONCRETE FOUNDATION, TYPE E 30-INCH DIAMETER	FOOT	11
CONCRETE FOUNDATION, TYPE E 36-INCH DIAMETER	FOOT	14
CONCRETE FOUNDATION, TYPE E 42-INCH DIAMETER	FOOT	42
DRILL EXISTING HANDHOLE	EACH	14
SIGNAL HEAD, LED, 1-FACE, 3-SECTION, MAST ARM MOUNTED	EACH	12
SIGNAL HEAD, LED, 1-FACE, 3-SECTION, BRACKET MOUNTED	EACH	2
SIGNAL HEAD, LED, 1-FACE, 5-SECTION, BRACKET MOUNTED	EACH	2
SIGNAL HEAD, LED, 1-FACE, 5-SECTION, MAST ARM MOUNTED	EACH	6
OPTICALLY PROGRAMMED SIGNAL HEAD, LED, 1-FACE, 3-SECTION, BRACKET MOUNTED	EACH	2
OPTICALLY PROGRAMMED SIGNAL HEAD, LED, 1-FACE, 3-SECTION, MAST ARM MOUNTED	EACH	5
PEDESTRIAN SIGNAL HEAD, LED, 1-FACE, BRACKET MOUNTED WITH COUNTDOWN TIMER	EACH	8
TRAFFIC SIGNAL BACKPLATE, LOUVERED, FORMED PLASTIC	EACH	21
INDUCTIVE LOOP DETECTOR	EACH	8
* RELOCATE EXISTING EMERGENCY VEHICLE PRIORITY SYSTEM, DETECTOR UNIT	EACH	3
* RELOCATE EXISTING EMERGENCY VEHICLE PRIORITY SYSTEM, PHASING UNIT	EACH	1
REMOVE ELECTRIC CABLE FROM CONDUIT	FOOT	11040
REMOVE EXISTING TRAFFIC SIGNAL EQUIPMENT	EACH	1
REMOVE EXISTING HANDHOLE	EACH	2
REMOVE EXISTING CONCRETE FOUNDATION	EACH	5
* EMERGENCY VEHICLE PRIORITY SYSTEM LINE SENSOR CABLE, NO. 20 3/C	FOOT	713
CENTRACS LICENSE EXPANSION	EACH	1
OUTDOOR RATED NETWORK CABLE	FOOT	168
UNINTERRUPTABLE POWER SUPPLY AND CABINET, SPECIAL	EACH	1
SERVICE INSTALLATION, GROUND MOUNTED, METERED	EACH	1
REMOTE CONTROLLED VIDEO SYSTEM	EACH	1
LAYER II (DATALINK) SWITCH	EACH	1
TERMINATE FIBER IN CABINET	EACH	24
PEDESTRIAN SIGNAL POST, 10 FT.	EACH	4
VIDEO VEHICLE DETECTION SYSTEM, SINGLE APPROACH	EACH	3
LED SIGNAL FACE VISOR HEATER	EACH	29
FIBER OPTIC INTERCONNECT CENTER, 48 PORT	EACH	3
ADVANCED TRANSPORTATION CONTROLLER AND TYPE IV CABINET, SPECIAL	EACH	1
ACCESSIBLE PEDESTRIAN SIGNALS	EACH	8
CONCRETE FOUNDATION, TYPE A 12-INCH DIAMETER	FOOT	16
STEEL MAST ARM ASSEMBLY AND POLE WITH DUAL MAST ARMS, 22 FT.	EACH	1
STEEL COMBINATION MAST ARM ASSEMBLY AND POLE WITH DUAL MAST ARMS, 18 FT. AND 46 FT.	EACH	1

\* 100% COST TO THE VILLAGE OF MELROSE PARK



MODEL: Default  
FILE: M:\Projects\pvt\_bentley.com\hsp\01\Documents\01\_Active\Projects\WK-CUS-168959100 - IL 64Phase\_IL12\_Design\CAD\Plan\_Sheets\WOT\East\_Corridor\108121ent-Sig-02\_KHA.dgn



USER NAME = JoelTurk	DESIGNED - AMK	REVISED - 06/03/2024
	DRAWN - JJT	REVISED -
PLOT SCALE = 2.0000' / in.	CHECKED - SS	REVISED -
PLOT DATE = 3/22/2024	DATE - 3/22/2024	REVISED -

**STATE OF ILLINOIS  
DEPARTMENT OF TRANSPORTATION**

**MAST ARM MOUNTED STREET NAME SIGNS  
AND SCHEDULE OF QUANTITIES  
IL RTE 64 (NORTH AVE) AND CORNELL AVE /35TH AVE**  
SCALE: SHEET 1 OF SHEETS STA. TO STA.

F.A.P. RTE.	SECTION	COUNTY	TOTAL SHEETS	SHEET NO.
307	2020-264-SUR-SW&TS	COOK	492	176
CONTRACT NO. 62N40				
ILLINOIS FED. AID PROJECT				

**TS 3035  
IDOT CONTRACS  
FORMER ECON 100**

**REVISIED SHEET 6/4/2024**