

ROUTE	SECTION	COUNTY	TOTAL SHEETS	SHEET NUMBER
FAP 362	N-6-7-I-1	COOK	14	4

CONTRACT: 60B28

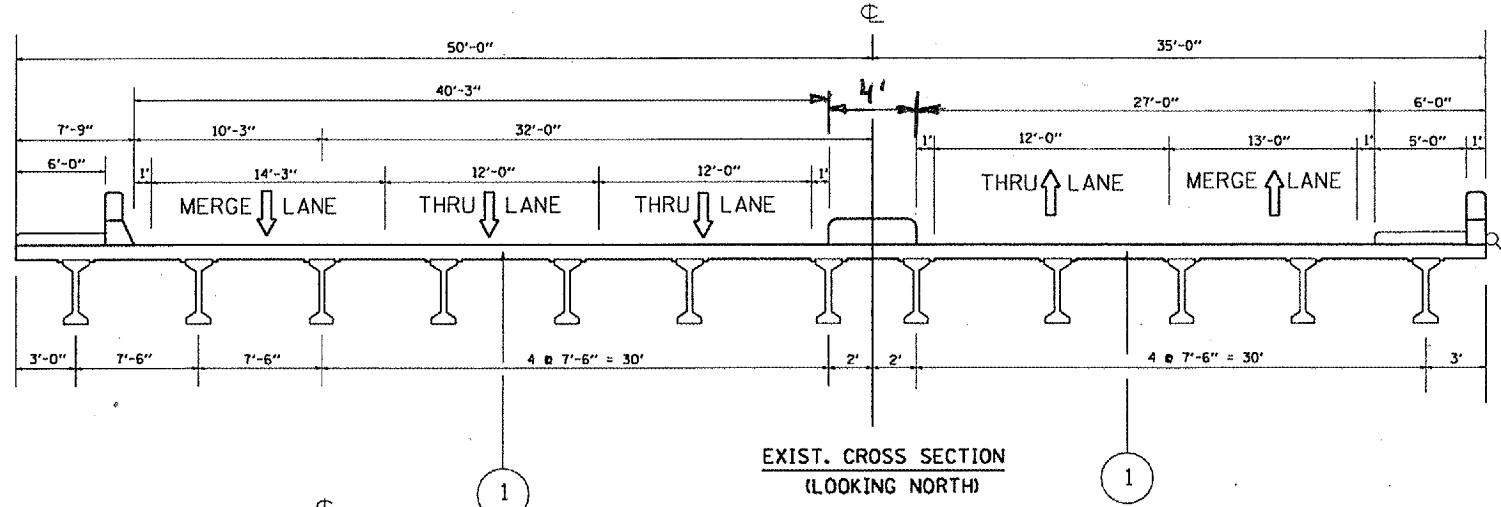

LEGEND
 ① EXIST. DECK THICKNESS, 9 1/2" (INCLUDING EXISTING OVERLAY)

NOTE:
 CONTRACTOR SHALL TAKE PRECAUTION NOT TO DAMAGE EXISTING TRAFFIC CONDUIT. ANY DAMAGE SHALL BE REPAIRED AT THE CONTRACTOR'S EXPENSE.

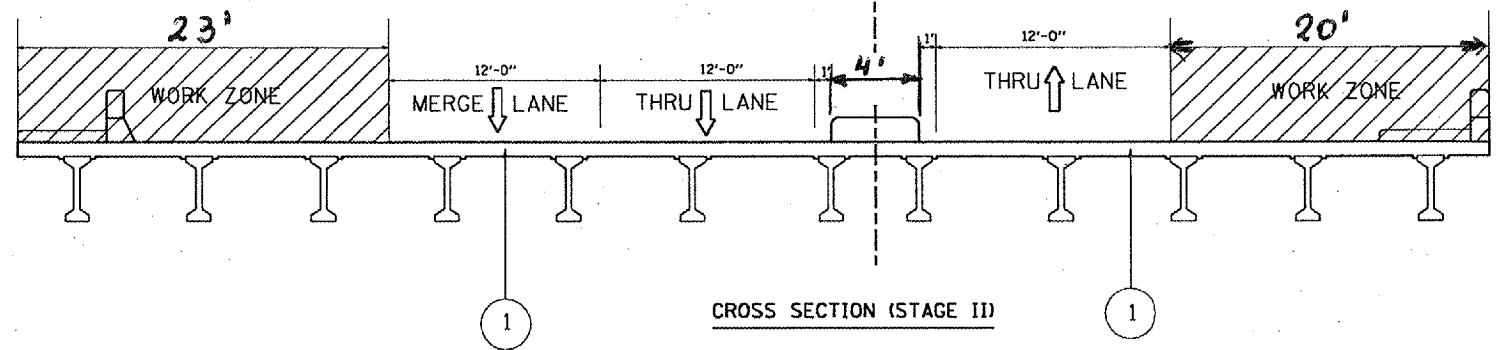
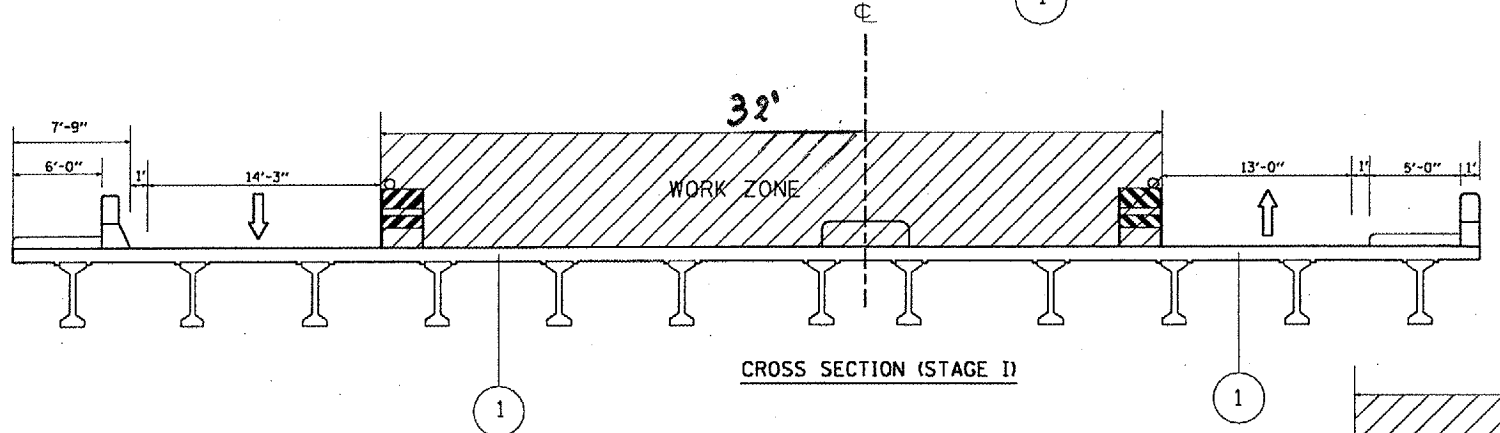

MIXTURE REQUIREMENTS		
MIXTURE USES	AC TYPE	VOIDS
POLY. HOT-MIX ASPHALT SURFACE COURSE, MIX "F", N90, IL 9.5 mm	SBS/SBR PG 70-22	4% AT 90 GYR.
POLY. HOT-MIX ASPHALT BINDER COURSE, IL-19.0, N90	SBS/SBR PG 70-22	4% AT 90 GYR.
LEVELING BINDER (MACHINE METHOD), N70, IL 9.5 mm	PG 64-22 *	4% AT 70 GYR.

NOTE 1: THE UNIT WEIGHT USED TO CALCULATE ALL HOT-MIX ASPHALT SURFACE MIXTURE IS 112 LBS/SQYD/IN
 * NOTE 2: WHEN RAP EXCEEDS 20% THE NEW ASPHALT BINDER IN THE MIX SHALL BE PG 58-22.

ILLINOIS DEPARTMENT OF
 TRANSPORTATION
 BARRINGTON RD
 OVER I-90 (NORTHWEST TOLLWAY)
 TYPICAL SECTION