

PLOT DATE = 03/15/07
 FILE NAME = I:\PROJECTS\60B46\DRAWINGS\STAGING AND TRAFFIC CONTROL\STAGING AND TRAFFIC CONTROL\STAGING AND TRAFFIC CONTROL\STAGING AND TRAFFIC CONTROL.DWG
 PLOT SCALE = 1/4"=1'-0"
 USER NAME = DDH

CONTRACT NO. 60B46

F.A.I. RTE.	SECTION	COUNTY	TOTAL SHEETS	SHEET NO.
55	99 (I&2) WRS-2	WILL	228	92
STA.		TO STA.		
FED. ROAD DIST. NO.		ILLINOIS FED. AID PROJECT		

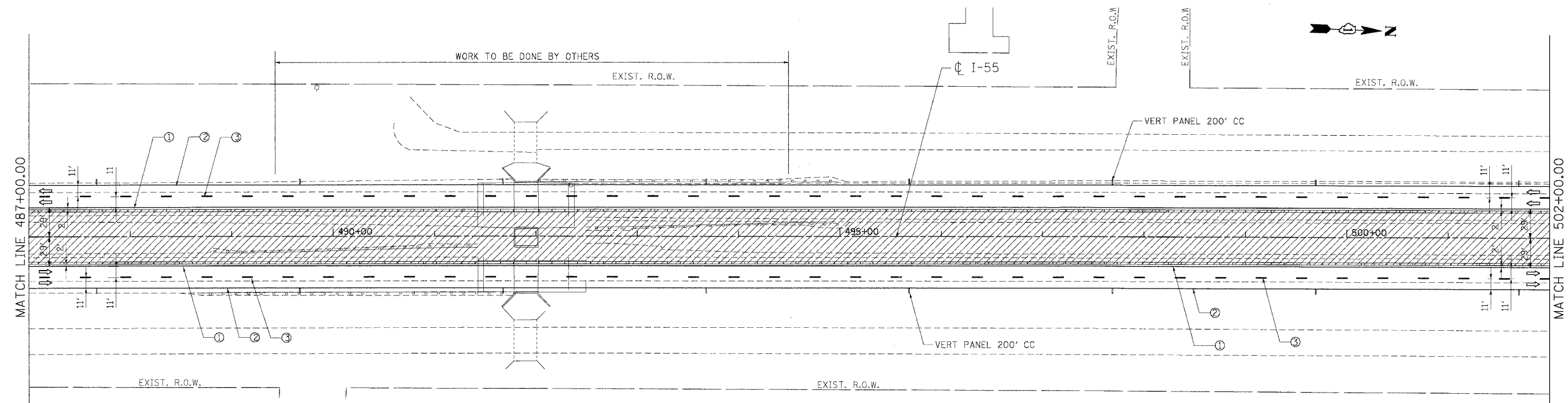
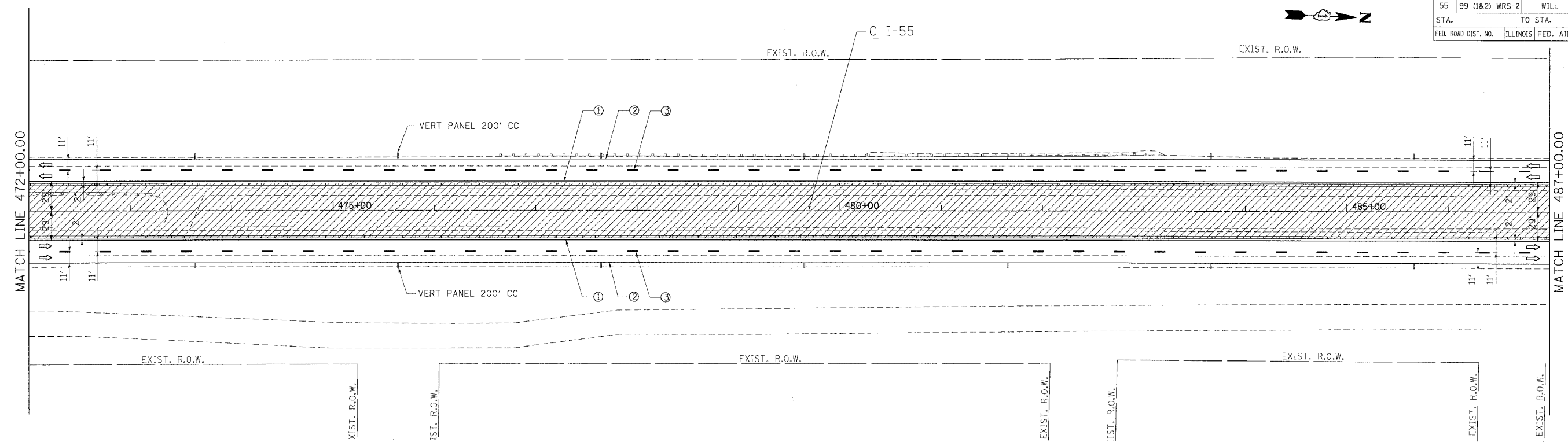
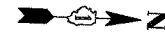

LEGEND

- | | | |
|--|---|--|
| WORK AREA | ① PAVT. MARKING TAPE, TYPE III, 4", YELLOW | ⑦ PAVT. MARKING TAPE, TYPE III, 5", WHITE |
| DRUMS W/ MONO-DIRECTIONAL STEADY BURN LIGHT | ② PAVT. MARKING TAPE, TYPE III, 4", WHITE | ⑧ EPOXY PAVT. MARKING LINE 4", WHITE |
| VERTICAL PANEL | ③ PAVT. MARKING TAPE, TYPE III, 5", WHITE (10' DASH 30' SKIP) | ⑨ EPOXY PAVT. MARKING LINE 4", YELLOW |
| TEMPORARY CONC. BARRIER | ④ PAVT. MARKING TAPE, TYPE III, 4", WHITE (2' DASH 6' SKIP) | ⑩ EPOXY PAVT. MARKING LINE 5", WHITE (10" DASH 30' SKIP) |
| TRAFFIC FLOW | ⑤ PAVT. MARKING TAPE, TYPE III, 8", WHITE | ⑪ EPOXY PAVT. MARKING LINE 5", WHITE |
| BARRICADE, TYPE III WITH TWO FLASHING LIGHTS | ⑥ PAVT. MARKING TAPE, TYPE III, 12", WHITE | |

NOTE:

AFTER THE CONSTRUCTION OF THE CONCRETE BARRIER AND THE BASE COURSE OF NEW INSIDE LANES AND SHOULDERS IS COMPLETE, THE CONTRACTOR SHALL REMOVE THE TEMPORARY CONCRETE BARRIER AND REPLACE IT WITH DRUMS WITH STEADY BURN LIGHTS SPACED AS SHOWN ON THE PLANS. AFTER THE TEMPORARY CONCRETE BARRIER IS REPLACED WITH DRUMS, EMERGENCY PULLOUTS SHALL CONTINUE TO BE PROVIDED APPROXIMATELY EVERY MILE AS DIRECTED BY THE ENGINEER AND AS SHOWN ON THE DETAIL FOR EMERGENCY PULLOUT USING DRUMS IN LIEU OF THE TEMPORARY CONCRETE BARRIER.

REVISIONS	
NAME	DATE

ILLINOIS DEPARTMENT OF TRANSPORTATION
 FAI ROUTE 55 (BLACK ROAD TO U.S. 30)
 WIDENING AND RESURFACING

**STAGING AND TRAFFIC CONTROL
 FAI 55 - STAGE I
 STA. 472+00.00 TO STA. 502+00.00**

SCALE: 1/4"=1'-0" DRAWN BY AG
 DATE 03/15/07 CHECKED BY DDH

TENG
 TENG & ASSOCIATES, INC.
 ENGINEERS/ARCHITECTS/PLANNERS
 CHICAGO, ILLINOIS