

F.A.I. RTE.	SECTION	COUNTY	TOTAL SHEETS	SHEET NO.
55	99 (1&2) WRS-2	WILL	228	99
STA.		TO STA.		
FED. ROAD DIST. NO.		ILLINOIS FED. AID PROJECT		

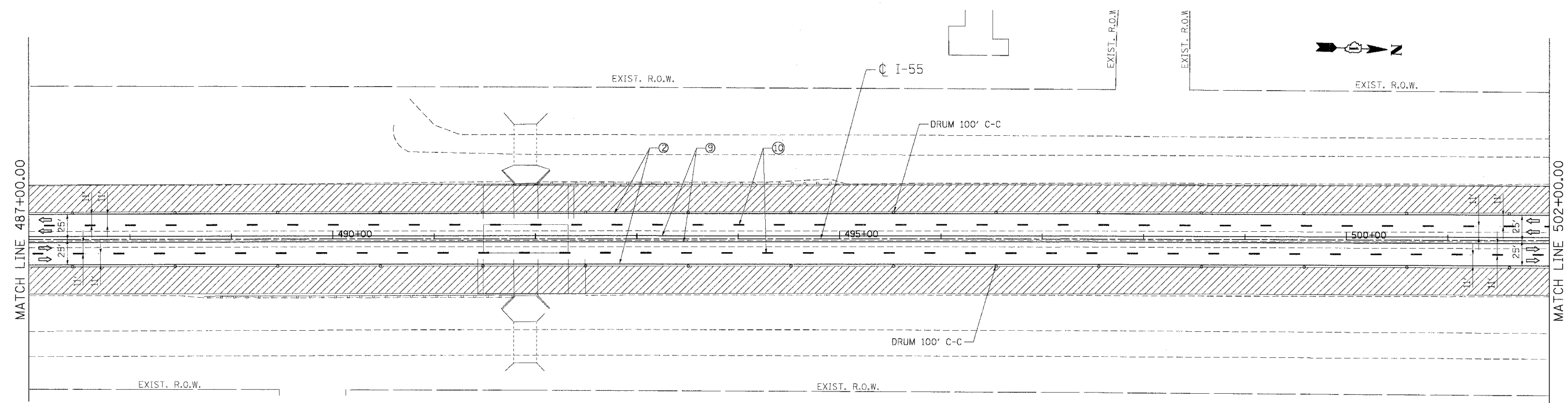
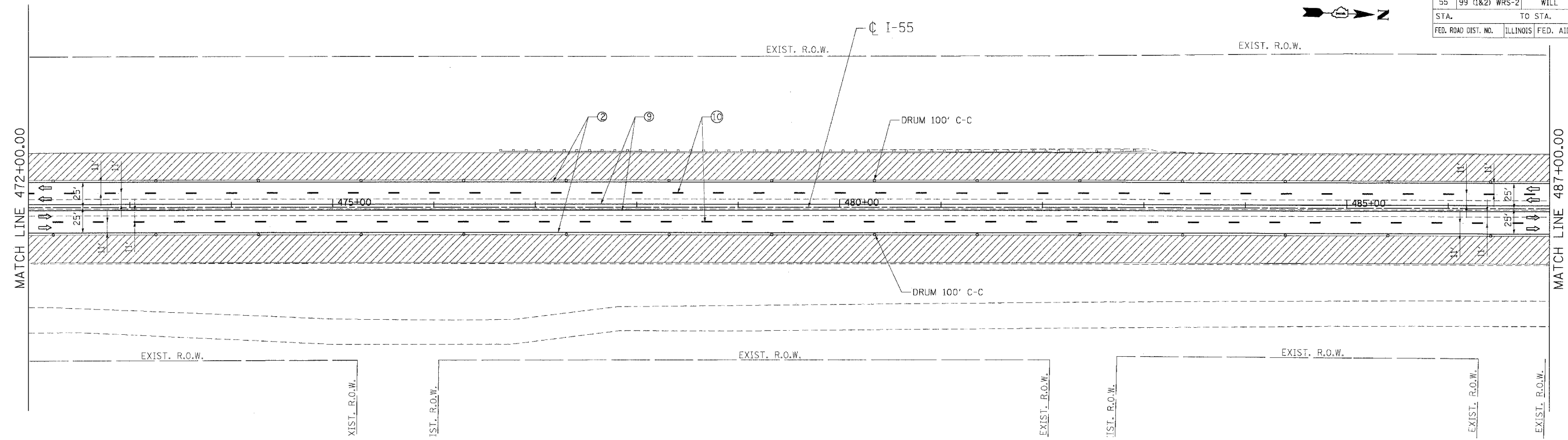
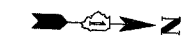

**LEGEND**

- WORK AREA
- DRUMS W/ MONO-DIRECTIONAL STEADY BURN LIGHT
- VERTICAL PANEL
- TEMPORARY CONC. BARRIER
- TRAFFIC FLOW
- BARRICADE, TYPE III WITH TWO FLASHING LIGHTS
- ① PAVT. MARKING TAPE, TYPE III, 4", YELLOW
- ② PAVT. MARKING TAPE, TYPE III, 4", WHITE
- ③ PAVT. MARKING TAPE, TYPE III, 5", WHITE (10' DASH 30' SKIP)
- ④ PAVT. MARKING TAPE, TYPE III, 4", WHITE (2' DASH 6' SKIP)
- ⑤ PAVT. MARKING TAPE, TYPE III, 8", WHITE
- ⑥ PAVT. MARKING TAPE, TYPE III, 12", WHITE

- ⑦ PAVT. MARKING TAPE, TYPE III, 5", WHITE
- ⑧ EPOXY PAVT. MARKING LINE 4", WHITE
- ⑨ EPOXY PAVT. MARKING LINE 4", YELLOW
- ⑩ EPOXY PAVT. MARKING LINE 5", WHITE (10" DASH 30' SKIP)
- ⑪ EPOXY PAVT. MARKING LINE 5", WHITE

REVISIONS	
NAME	DATE

ILLINOIS DEPARTMENT OF TRANSPORTATION  
 FAI ROUTE 55 (BLACK ROAD TO U.S. 30)  
 WIDENING AND RESURFACING

**STAGING AND TRAFFIC CONTROL  
 FAI 55 - STAGE II  
 STA. 472+00.00 TO STA. 502+00.00**

SCALE: 1"=50'  
 DATE: 03/15/07  
 DRAWN BY: AG  
 CHECKED BY: DDH

**TENG**  
 TENG & ASSOCIATES, INC.  
 ENGINEERS/ARCHITECTS/PLANNERS  
 CHICAGO, ILLINOIS

PLOT DATE = #DATE#  
 FILE NAME = #FILE#  
 USER NAME = #USER#  
 3 15 2007 12:09:18