

F.A.I. RTE.	SECTION	COUNTY	TOTAL SHEETS	SHEET NO.
55	99 (1&2) WRS-2	WILL	228	120
STA.		TO STA.		
FED. ROAD DIST. NO.		ILLINOIS FED. AID PROJECT		

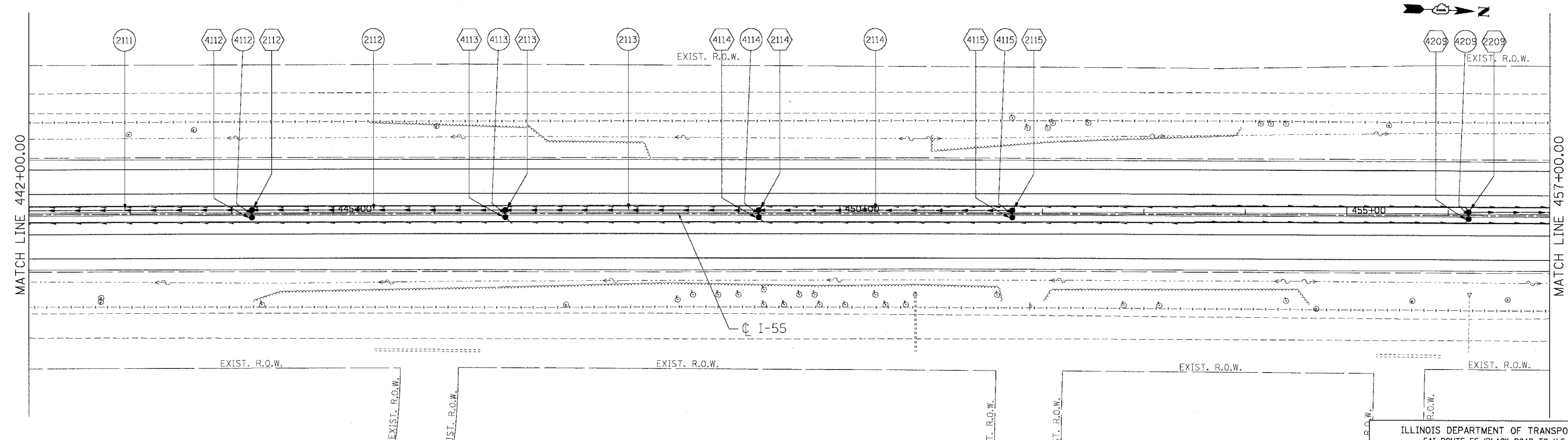
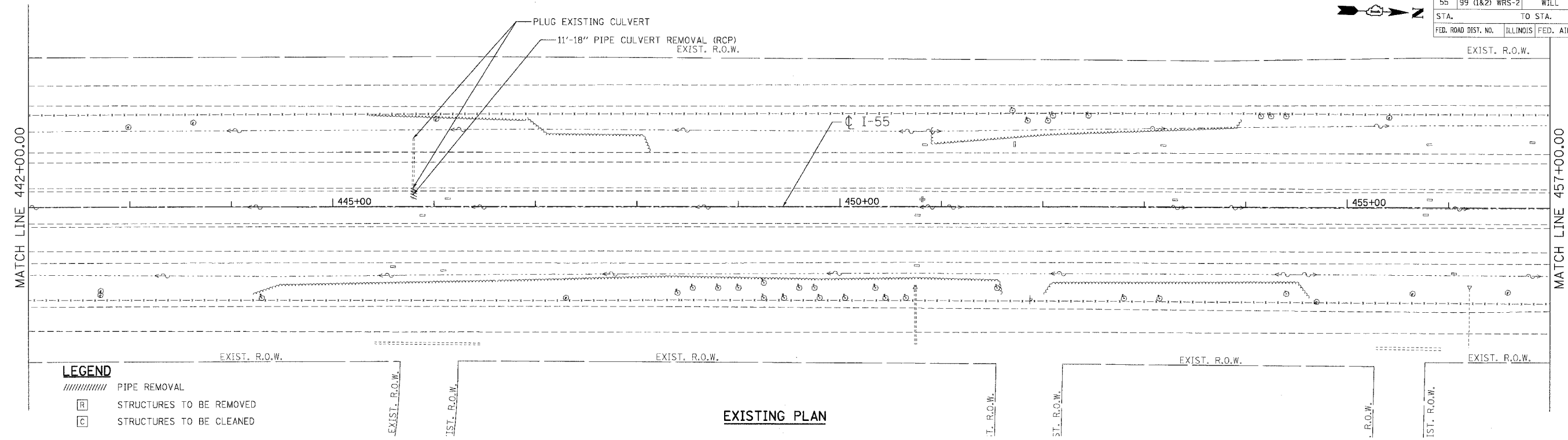

NOTES

- FOR STRUCTURE AND PIPE INFORMATION SEE DRAINAGE SCHEDULES, SHEETS 129, 130, 131, 132, AND 133.
- PROPOSED SEWER AND CULVERT CROSSING BENEATH THE EXISTING PAVEMENT SHALL BE CONSTRUCTED DURING PRE-STAGE PER THE STAGING AND TRAFFIC CONTROL PLANS. SEE ROADWAY PLANS FOR PATCHING DETAILS.

REVISIONS	
NAME	DATE

ILLINOIS DEPARTMENT OF TRANSPORTATION
 FAI ROUTE 55 (BLACK ROAD TO U.S. 30)
 WIDENING AND RESURFACING

DRAINAGE AND UTILITY PLAN
FAI 55
STA. 442+00.00 TO STA. 457+00.00

SCALE: 1"=50'
 DATE: 03/15/07

DRAWN BY: MRK
 CHECKED BY: TKL

TENG
 TENG & ASSOCIATES, INC.
 ENGINEERS/ARCHITECTS/PLANNERS
 CHICAGO, ILLINOIS

PLOT DATE = 03/15/07
 FILE NAME = 031507.DWG
 USER NAME = 031507
 3-15-2007 12:16:56
 SANDEWENTY 22361801 CT WILSON DR WILSONVILLE OH 45396
 DARC/RAZ