

F.A.T. RTE.	SECTION	COUNTY	TOTAL SHEETS	SHEET NO.
55	99 (1&2) WRS-2	WILL	228	127
STA.		TO STA.		
FED. ROAD DIST. NO.		ILLINOIS FED. AID PROJECT		

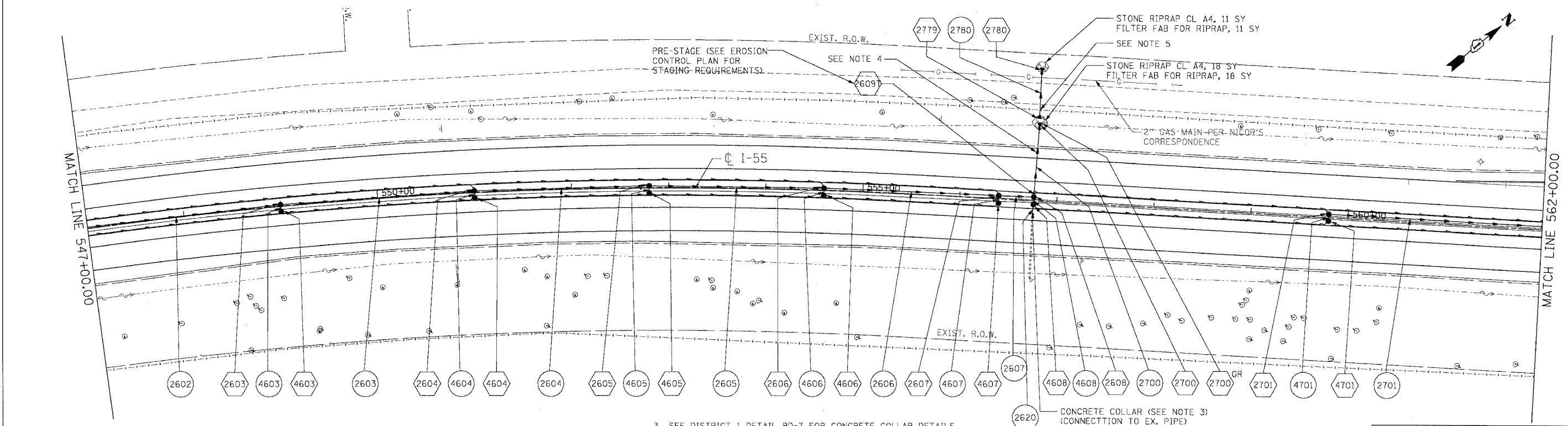
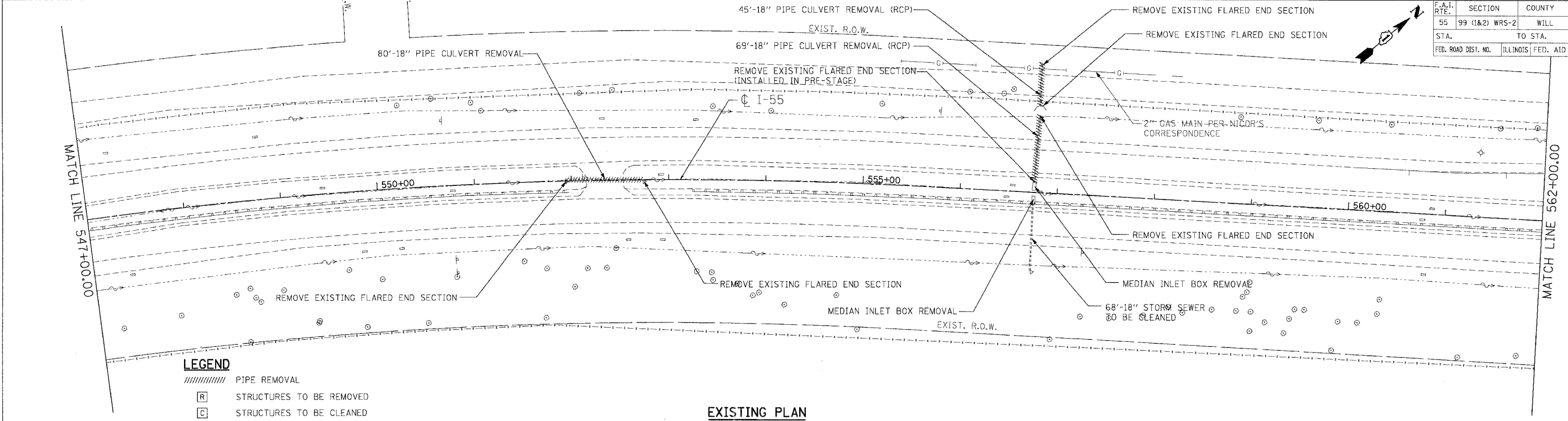

NOTES
 1. FOR STRUCTURE AND PIPE INFORMATION SEE DRAINAGE SCHEDULES, SHEETS 129, 130, 131, 132, AND 133.
 2. PROPOSED SEWER AND CULVERT CROSSING BENEATH THE EXISTING PAVEMENT SHALL BE CONSTRUCTED DURING PRE-STAGE PER THE STAGING AND TRAFFIC CONTROL PLANS. SEE ROADWAY PLANS FOR PATCHING DETAILS.
 3. SEE DISTRICT 1 DETAIL BD-7 FOR CONCRETE COLLAR DETAILS.
 4. STORM SEWER LATERALS SHALL BE INSTALLED PER THE STAGING AND TRAFFIC CONTROL TYPICAL SECTIONS FOR PRE-STAGE (SEE SHEET 83). THE CONTRACTOR SHALL BEGIN CONSTRUCTION OF THIS STORM SEWER LATERAL WHEN PRECIPITATION IS NOT INCLUDED IN THE NATIONAL OCEANIC AND ATMOSPHERIC ADMINISTRATION'S NATIONAL WEATHER SERVICE FORECAST FOR THE 48 HOUR PERIOD FOLLOWING THE START OF CONSTRUCTION OF THIS STORM SEWER LATERAL ([HTTP://WWW.NWS.NOAA.GOV](http://www.nws.noaa.gov)). PRE-STAGE, PHASE II SHALL BE COMPLETED WITHIN 36 HOURS OF COMPLETING PRE-STAGE, PHASE I FOR THIS STORM SEWER LATERAL.
 5. THE CONTRACTOR SHALL REMOVE AND RESTORE THE FENCE WHERE NECESSARY AT THE PROPOSED STORM SEWER TO THE SATISFACTION OF THE ENGINEER AND THE COST SHALL BE INCLUDED IN THE CONTRACT UNIT PRICE FOR STORM SEWER OF TYPE, SIZE AND CLASS SPECIFIED.

REVISIONS	
NAME	DATE

ILLINOIS DEPARTMENT OF TRANSPORTATION
 FAI ROUTE 55 (BLACK ROAD TO U.S. 30)
 WIDENING AND RESURFACING

**DRAINAGE AND UTILITY PLAN
 FAI 55
 STA. 547+00.00 TO STA. 562+00.00**

SCALE: 1"=50'
 DATE 03/15/07
 DRAWN BY MRK
 CHECKED BY TKL

TENG TENG & ASSOCIATES, INC.
 ENGINEERS/ARCHITECTS/PLANNERS
 CHICAGO, ILLINOIS

PLT DATE: 03/15/07
 FILE NAME: #11E11
 PLOT SCALE: #SCALE#
 USER NAME: #USER#