

F.A.I. RTE.	SECTION	COUNTY	TOTAL SHEETS	SHEET NO.
55	99 (1&2) WRS-2	WILL	228	164
STA.		TO STA.		
FED. ROAD DIST. NO.		ILLINOIS	FED. AID PROJECT	

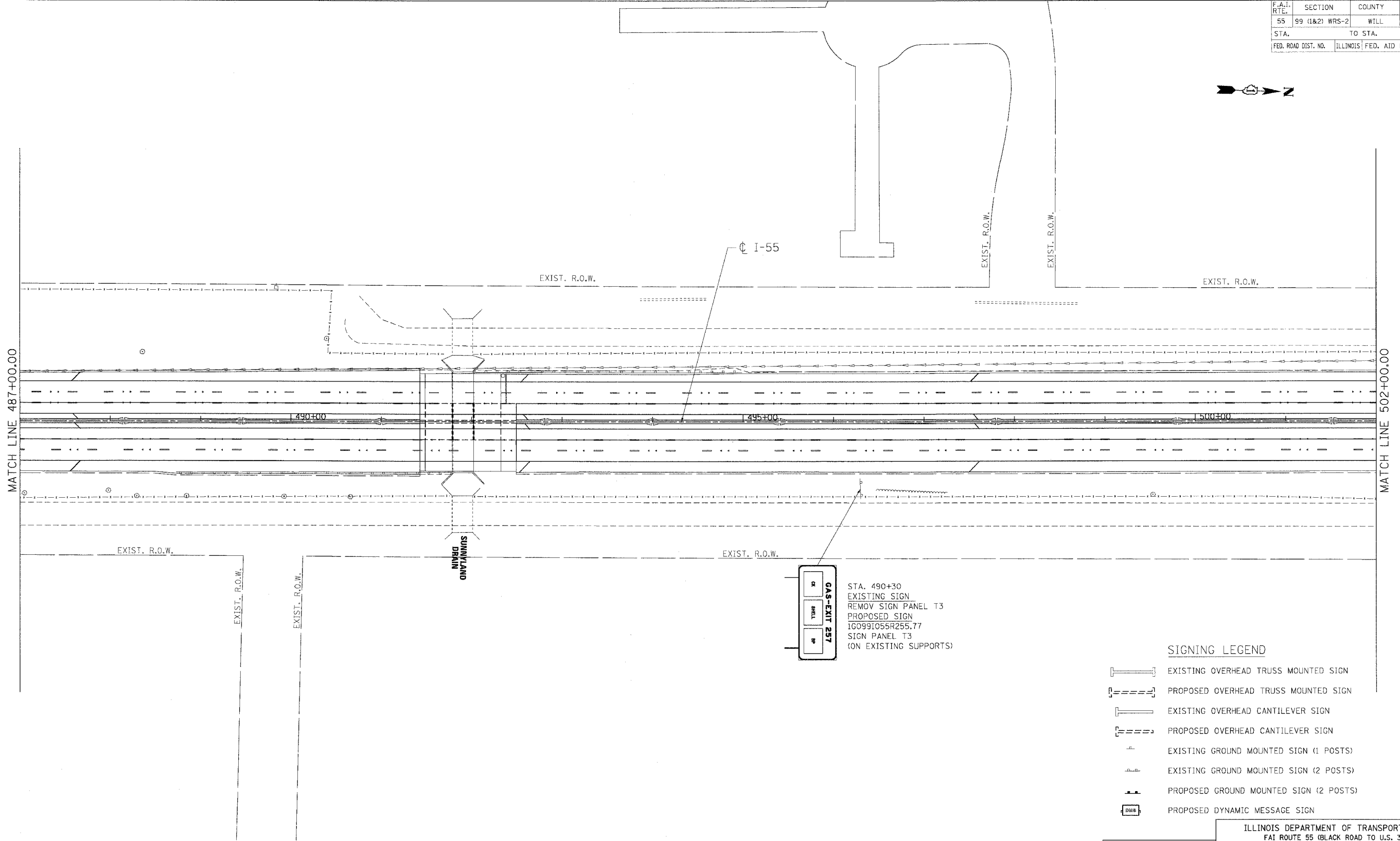

STA. 490+30
 EXISTING SIGN
 REMOVE SIGN PANEL T3
 PROPOSED SIGN
 1G099I055R255.77
 SIGN PANEL T3
 (ON EXISTING SUPPORTS)

SIGNING LEGEND

- EXISTING OVERHEAD TRUSS MOUNTED SIGN
- PROPOSED OVERHEAD TRUSS MOUNTED SIGN
- EXISTING OVERHEAD CANTILEVER SIGN
- PROPOSED OVERHEAD CANTILEVER SIGN
- EXISTING GROUND MOUNTED SIGN (1 POSTS)
- EXISTING GROUND MOUNTED SIGN (2 POSTS)
- PROPOSED GROUND MOUNTED SIGN (2 POSTS)
- PROPOSED DYNAMIC MESSAGE SIGN

REVISIONS	
NAME	DATE

ILLINOIS DEPARTMENT OF TRANSPORTATION
 FAI ROUTE 55 (BLACK ROAD TO U.S. 30)
 WIDENING AND RESURFACING
SIGNING PLAN
FAI 55
STA. 487+00.00 TO STA. 502+00.00
 SCALE: 1"=50'
 DATE 02/23/07
 DRAWN BY MW
 CHECKED BY DDH
TENG

TENG & ASSOCIATES, INC.
 ENGINEERS/ARCHITECTS/PLANNERS
 CHICAGO, ILLINOIS

PLOT DATE = 02/23/07
 FILE NAME = 022307.DWG
 USER NAME = JGIBSON
 SCALE = 1"=50'
 USER NAME = JGIBSON