

F.A. RTE.	SECTION	COUNTY	TOTAL SHEETS	SHEET NO.
55	99(1f2)WES-2	WILL	228	186
STA.	TO STA.			
FED. ROAD DIST. NO.	ILLINOIS	FED. AID PROJECT		

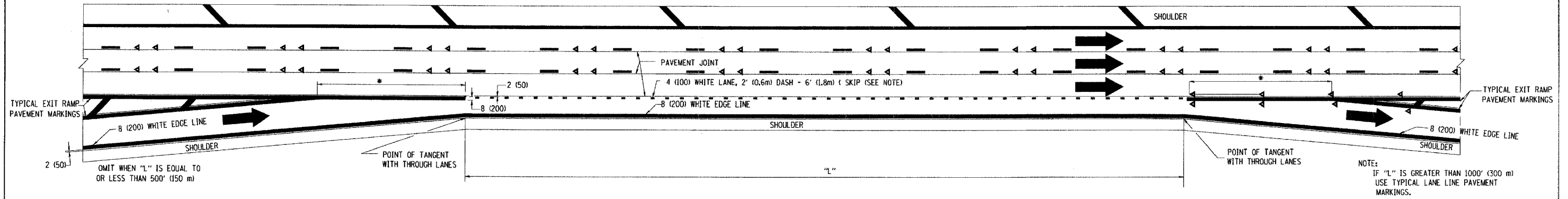

TYPICAL ENTRANCE/EXIT RAMP COMBINATION PAVEMENT MARKINGS

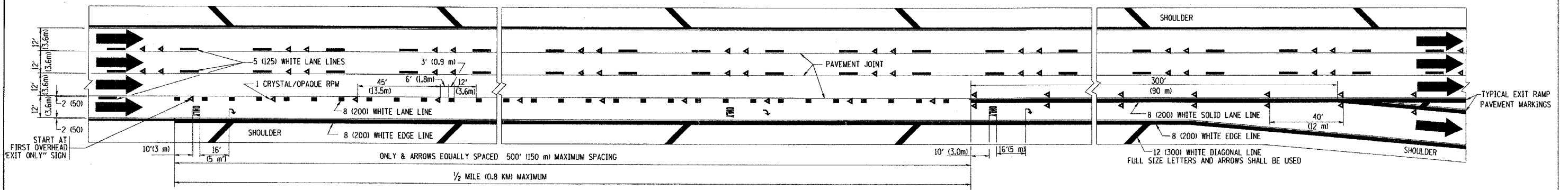

TYPICAL EXIT ONLY LANE PAVEMENT MARKINGS

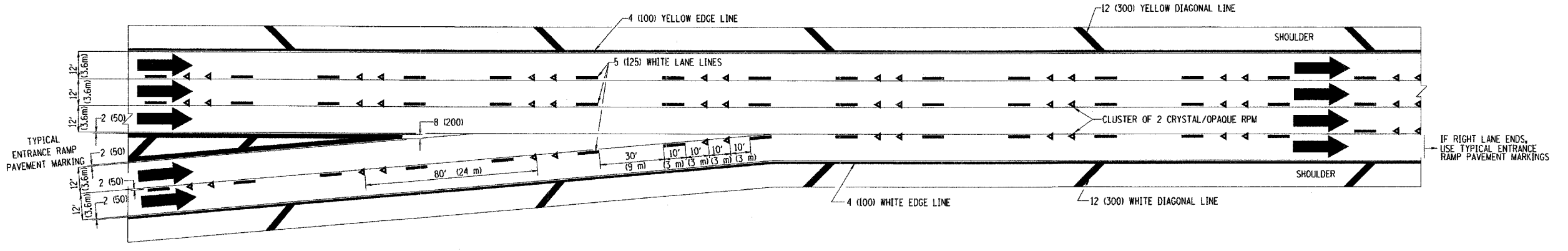

TYPICAL TWO LANE ENTRANCE RAMP PAVEMENT MARKINGS

REVISIONS	
NAME	DATE
DWS	1/90
DWS	5/91
SPB	1/07

ILLINOIS DEPARTMENT OF TRANSPORTATION

MULTI-LANE FREEWAY PAVEMENT MARKING DETAILS

SCALE: NONE
DATE: 1/16/2007

DRAWN BY C.A.D.D.
CHECKED BY

TC12 SHEET 2 OF 2
REVISION DATE: 01/01/07

PLOT DATE = 1/16/2007
FILE NAME = K:\data\std\std12.dgn
PLOT SCALE = 50:000 / 1" = 100'
USER NAME = jaygo