

F.A.P. RTE.	SECTION	COUNTY	TOTAL SHEETS	SHEET NO.
344	3034 RS-3	COOK	24	10
STA.		TO STA.		
FED. ROAD DIST. NO.		ILLINOIS FED. AID PROJECT		

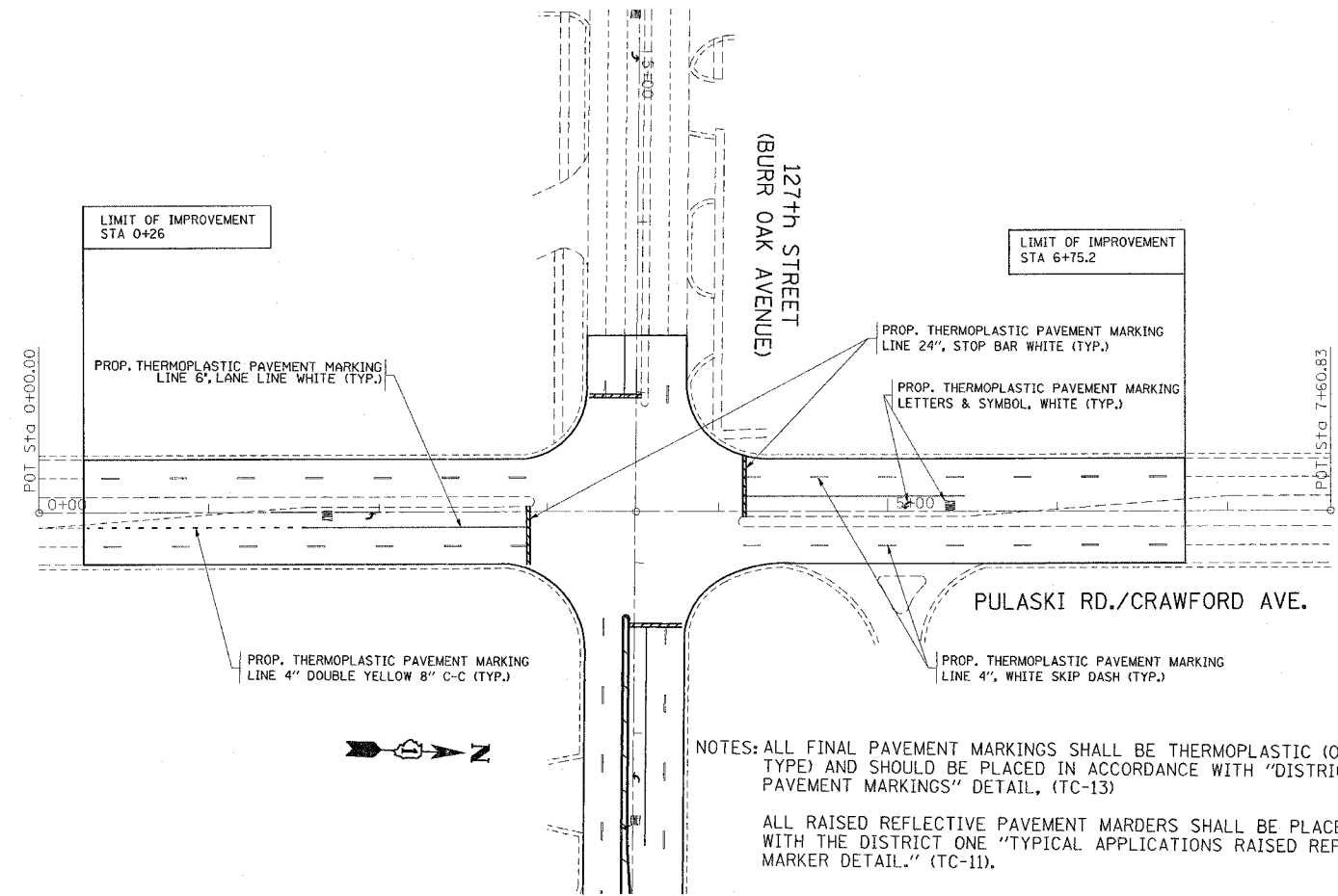

NOTES: ALL FINAL PAVEMENT MARKINGS SHALL BE THERMOPLASTIC (OR THE EXTRUDED TYPE) AND SHOULD BE PLACED IN ACCORDANCE WITH "DISTRICT ONE TYPICAL PAVEMENT MARKINGS" DETAIL, (TC-13)

ALL RAISED REFLECTIVE PAVEMENT MARDERS SHALL BE PLACED IN ACCORDANCE WITH THE DISTRICT ONE "TYPICAL APPLICATIONS RAISED REFLECTIVE PAVEMENT MARKER DETAIL." (TC-11).

PLOT DATE = 4/11/2007  
 FILE NAME = s:\projects\60c71\10\1000\pav\_mrk\_dwg.dgn  
 USER NAME = bgunsh

REVISIONS	
NAME	DATE

ILLINOIS DEPARTMENT OF TRANSPORTATION  
**PAVEMENT MARKING PLAN**  
**127th STREET**  
**CRAWFORD AVE. TO KEDZIE AVE.**

SCALE: VERT. 1"=50'  
 HORIZ. 1"=50'  
 DATE 4/11/2007

DRAWN BY  
 CHECKED BY