

F.A.P. RTE.	SECTION	COUNTY	TOTAL SHEETS	SHEET NO.
305	2007-028 RS	COOK	23	6
STA.		TO STA.		
FED. ROAD DIST. NO.	ILLINOIS	FED. AID PROJECT		

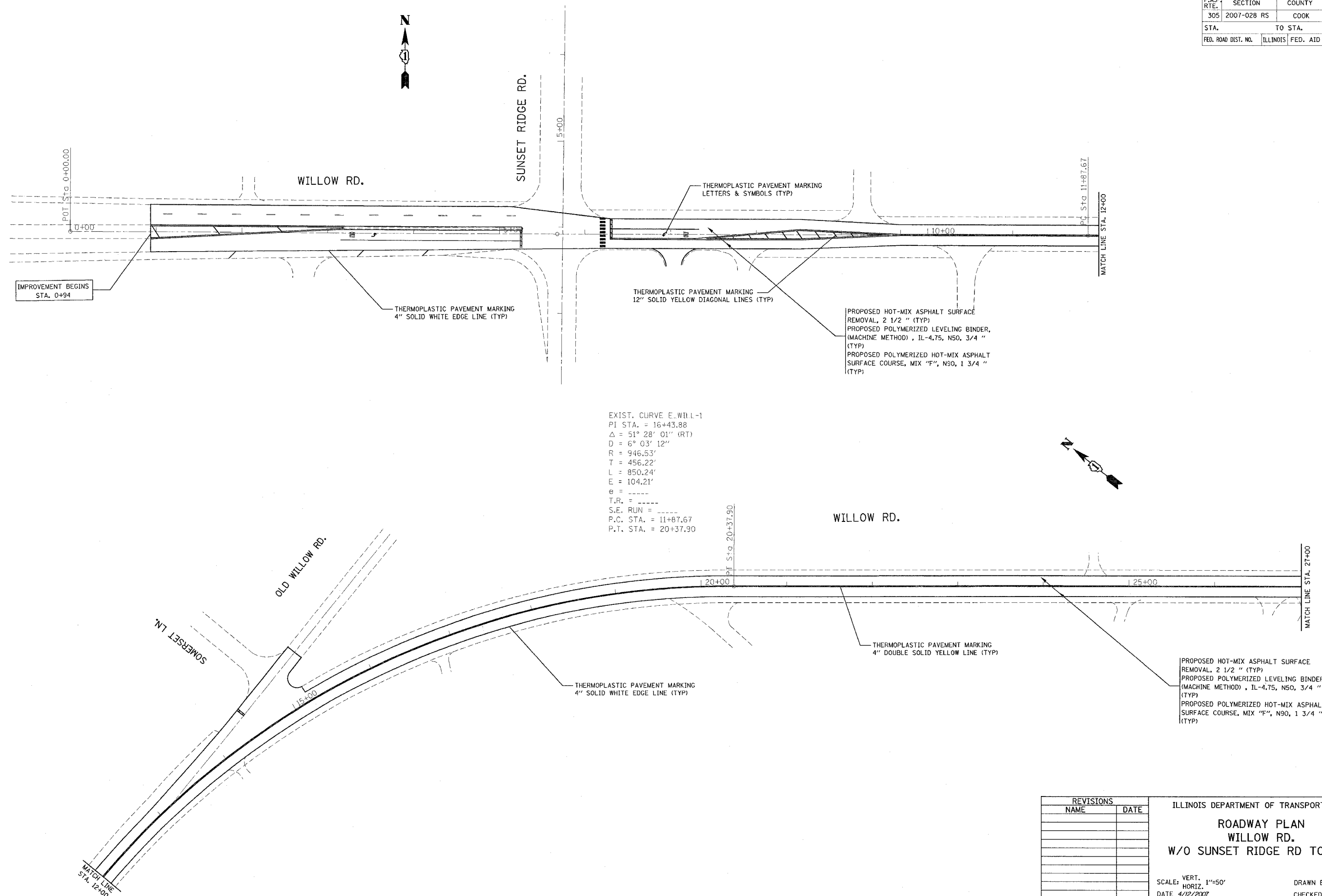

EXIST. CURVE E.WILL-1  
 PI STA. = 16+43.88  
 $\Delta = 51^\circ 28' 01''$  (RT)  
 $D = 6^\circ 03' 12''$   
 $R = 946.53'$   
 $T = 456.22'$   
 $L = 850.24'$   
 $E = 104.21'$   
 $e = \text{-----}$   
 $T.R. = \text{-----}$   
 $S.E. \text{ RUN} = \text{-----}$   
 $P.C. \text{ STA.} = 11+87.67$   
 $P.T. \text{ STA.} = 20+37.90$

REVISIONS	
NAME	DATE

ILLINOIS DEPARTMENT OF TRANSPORTATION  
**ROADWAY PLAN**  
**WILLOW RD.**  
**W/O SUNSET RIDGE RD TO I-94**

SCALE: VERT. 1"=50'  
 HORIZ. 1"=50'  
 DATE 4/12/2007

DRAWN BY  
 CHECKED BY

PLOT DATE = 4/12/2007  
 PLOT SCALE = 50.0000 / IN.  
 USER NAME = gullieumfp