

PLOT DATE = 1/2/2007
 PLOT SCALE = 1/8"=1'-0"
 USER NAME = dr-wk

ORIGINAL SURVEYED PLOTTED TEMPLATE AREAS CHECKED

FINAL SURVEY PLOTTED TEMPLATE AREAS CHECKED

BY DATE

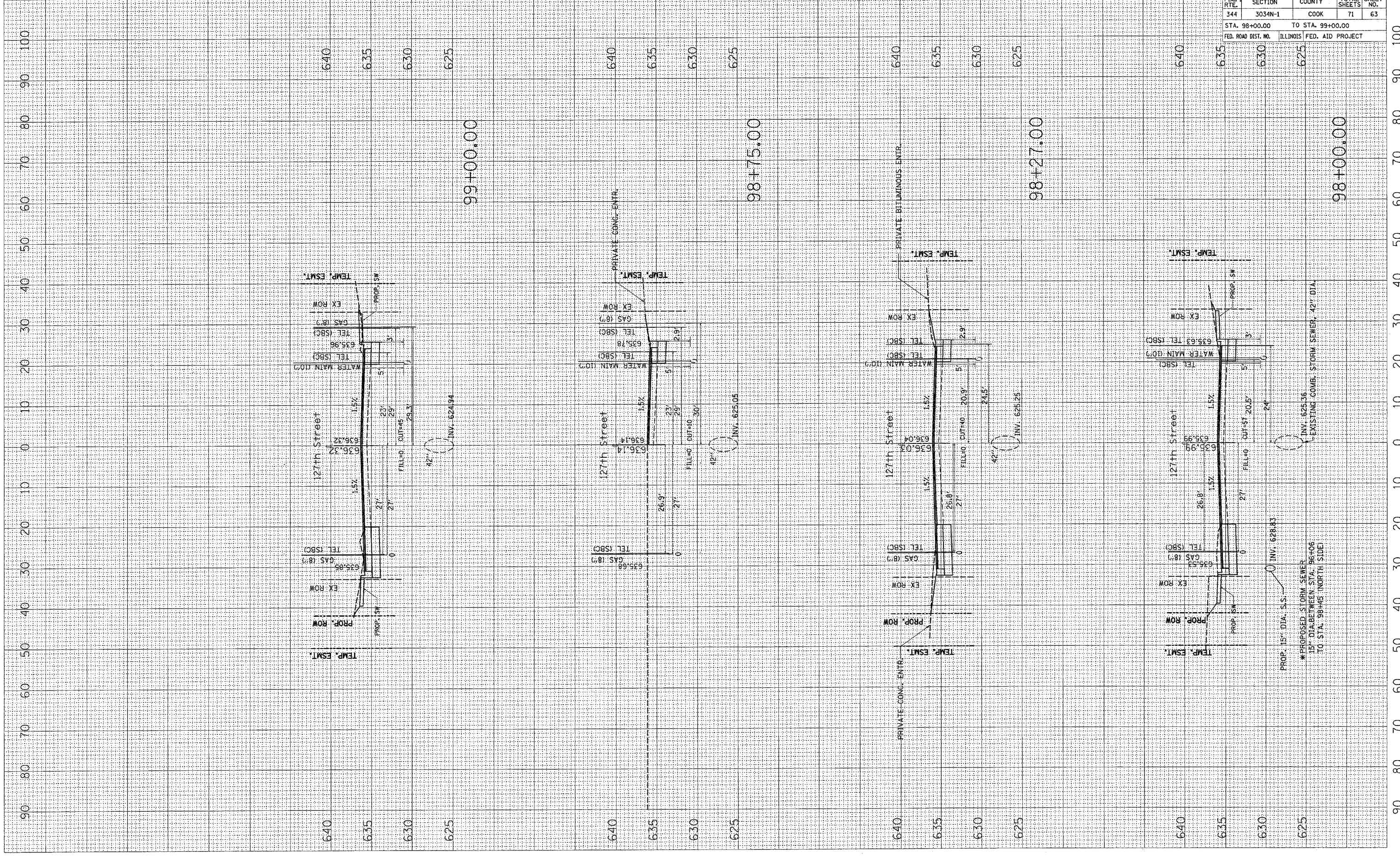

F.A.P. RTE.	SECTION	COUNTY	TOTAL SHEETS	SHEET NO.
344	3034N-1	COOK	71	63
STA. 98+00.00		TO STA. 99+00.00		
FED. ROAD DIST. NO.	ILLINOIS	FED. AID PROJECT		

PROP. 15" DIA. S.S.
 *PROPOSED STORM SEWER
 15" DIA. BETWEEN STA. 98+00
 TO STA. 98+45 (NORTH SIDE)

EXISTING COMB. STORM SEWER 42" DIA.