

F.A.P. RTE.	SECTION	COUNTY	TOTAL SHEETS	SHEET NO.
326	106-N-1	KANE	82	12
STA.		TO STA.		
FED. ROAD DIST. NO.		ILLINOIS	FED. AID PROJECT	

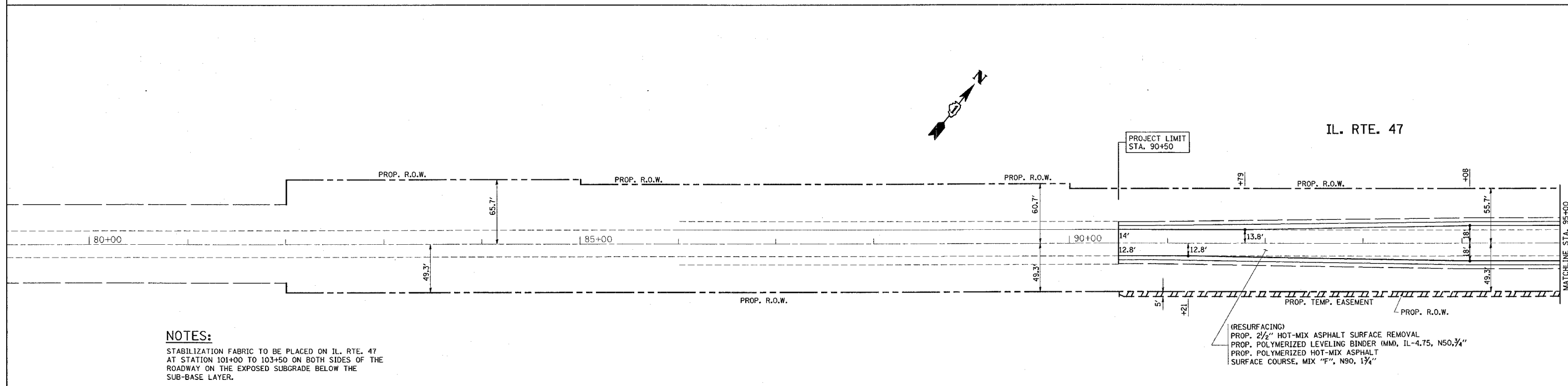
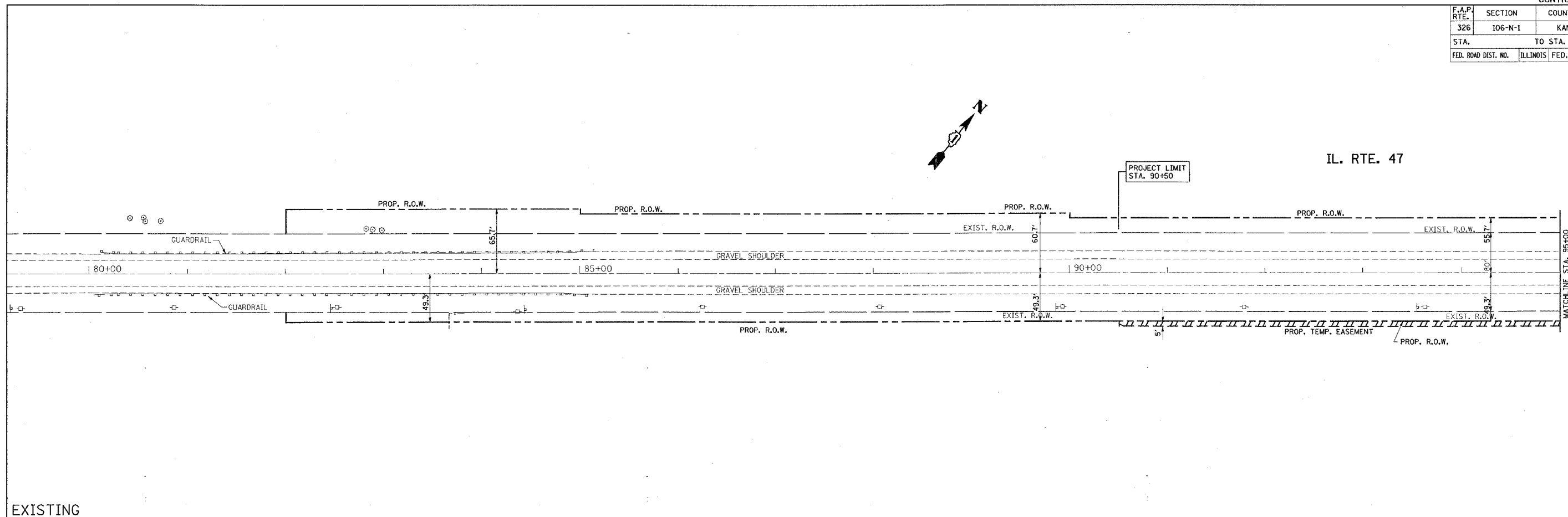

**NOTES:**

STABILIZATION FABRIC TO BE PLACED ON IL. RTE. 47 AT STATION 101+00 TO 103+50 ON BOTH SIDES OF THE ROADWAY ON THE EXPOSED SUBGRADE BELOW THE SUB-BASE LAYER.

POROUS GRANULAR EMBANKMENT, SUBGRADE LOCATIONS TO BE DETERMINED IN THE FIELD AT THE TIME OF CONSTRUCTION BY THE GEOTECHNICAL ENGINEER. APPROXIMATE LOCATIONS OF PGES ARE ON BIG TIMBER RD. AT STA. 47+30 TO 49+00 (RIGHT) AND STA. 54+50 TO 57+50 (RIGHT AND LEFT).

4-INCH DIAMETER LONGITUDINAL PIPE UNDERDRAINS TO BE PLACED AT THE OUTSIDE EDGES OF THE PROPOSED WIDENING WITHIN AREAS WHICH ARE UNDERCUT AND BACKFILLED WITH PGES. THE UNDERDRAINS SHOULD BE INSTALLED AT A DEPTH OF 30 INCHES BELOW THE TOP OF PROPOSED PAVEMENT.

(RESURFACING)  
 PROP. 2 1/2" HOT-MIX ASPHALT SURFACE REMOVAL  
 PROP. POLYMERIZED LEVELING BINDER (MM, IL-4.75, N50, 3/4")  
 PROP. POLYMERIZED HOT-MIX ASPHALT SURFACE COURSE, MIX "F", N90, 1 1/4"

REVISIONS	
NAME	DATE

ILLINOIS DEPARTMENT OF TRANSPORTATION  
**IL. RTE. 47 AT BIG TIMBER ROAD**  
 EXISTING AND PROPOSED  
 ROADWAY PLAN  
 SCALE: 1"=50'  
 DATE 2/28/2007  
 DRAWN BY  
 CHECKED BY

PLOT DATE = 2/28/2007  
 FILE NAME = c:\pcc\pcc\pcc\106n01\106n01.dgn  
 PLOT SCALE = 1/8"=1'-0" / IN.  
 USER NAME = bauerdl

PROPOSED

REV. 1