

F.A.I. RTE.	SECTION	COUNTY	TOTAL SHEETS	SHEET NO.
55	99 (I&2) WRS	WILL	334	34
STA.		TO STA.		
FED. ROAD DIST. NO.		ILLINOIS FED. AID PROJECT		

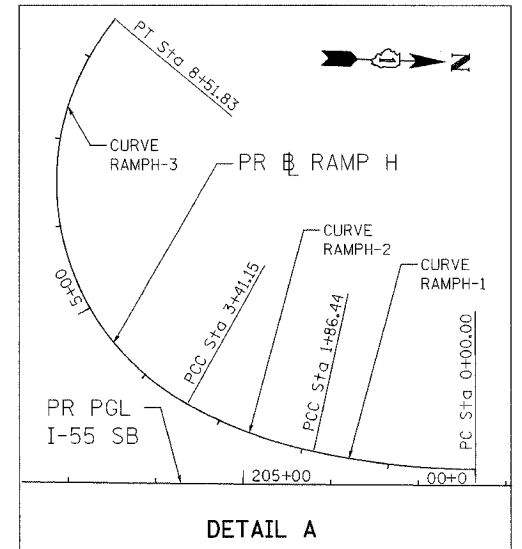
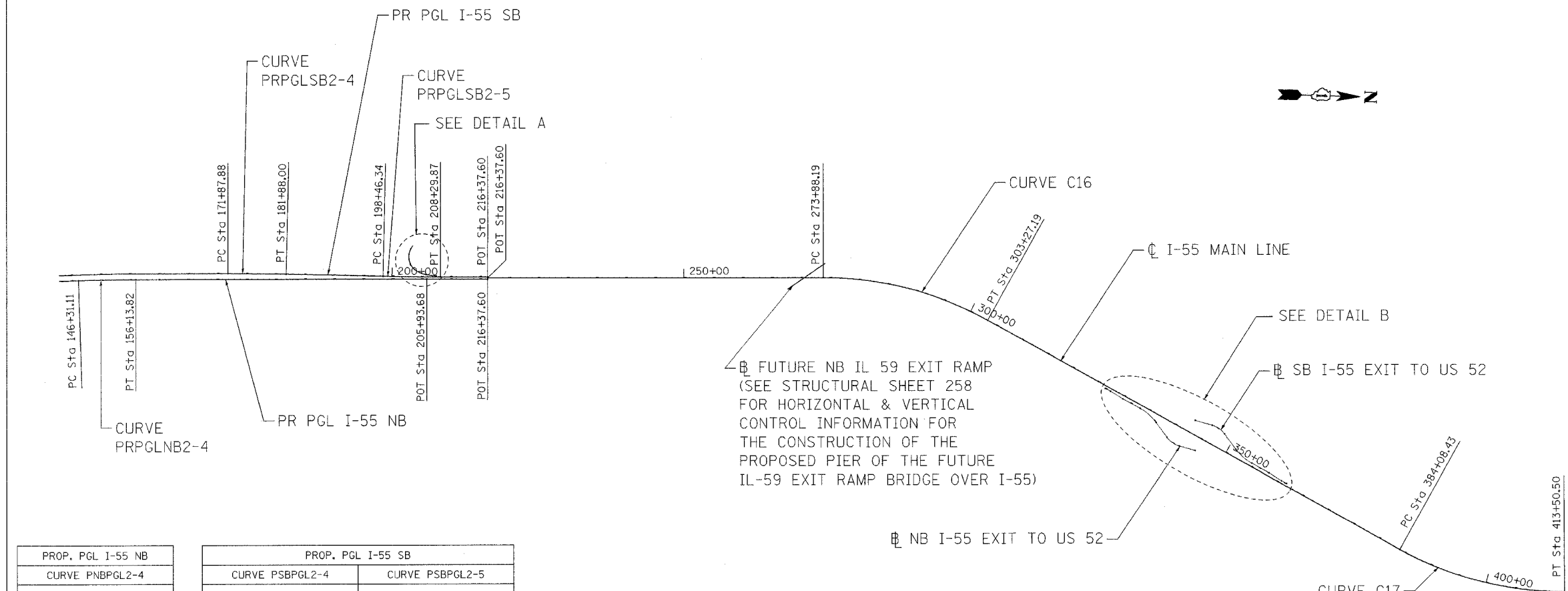

PROP. PGL I-55 NB		PROP. PGL I-55 SB	
CURVE PNBPGL2-4		CURVE PSBPGL2-4	CURVE PSBPGL2-5
PROP. CURVE PNBPGL2-4	PI STA. = 151+22.50	PROP. CURVE PSBPGL2-4	PROP. CURVE PSBPGL2-5
$\Delta = 1^\circ 43' 09''$ (RT)	$\Delta = 1^\circ 18' 02''$ (RT)	$\Delta = 1^\circ 16' 39''$ (LT)	
$D = 0^\circ 10' 30''$	$D = 0^\circ 07' 48''$	$D = 0^\circ 07' 48''$	
$R = 32,752.45'$	$R = 44,060.28'$	$R = 44,113.27'$	
$T = 491.39'$	$T = 500.08'$	$T = 491.78'$	
$L = 982.71'$	$L = 1,000.13'$	$L = 983.53'$	
$E = 3.69'$	$E = 2.84'$	$E = 2.74'$	
P.C. STA. = 146+31.11	P.C. STA. = 171+87.88	P.C. STA. = 198+46.34	
P.T. STA. = 156+13.82	P.T. STA. = 181+88.00	P.T. STA. = 208+29.87	

PROP. CL I-55	
CURVE C16	CURVE C17
PROP. CURVE C16	PROP. CURVE C17
PI STA. = 288+90.31	PI STA. = 399+12.72
$\Delta = 29^\circ 11' 03''$ (RT)	$\Delta = 29^\circ 26' 39''$ (LT)
$D = 0^\circ 59' 35''$	$D = 1^\circ 00' 03''$
$R = 5,770.00'$	$R = 5,725.00'$
$T = 1,502.12'$	$T = 1,504.28'$
$L = 2,939.00'$	$L = 2,942.06'$
$E = 192.32'$	$E = 194.33'$
P.C. STA. = 273+88.19	P.C. STA. = 384+08.43
P.T. STA. = 303+27.19	P.T. STA. = 413+50.50

PROP. ☉ RAMP H		
CURVE RAMPH-1	CURVE RAMPH-2	CURVE RAMPH-3
PROP. CURVE RAMPH-1	PROP. CURVE RAMPH-2	PROP. CURVE RAMPH-3
PI STA. = 0+93.58	PI STA. = 2+64.36	P.I. STA. = 6+91.35
$\Delta = 12^\circ 20' 07''$ (RT)	$\Delta = 16^\circ 51' 06''$ (RT)	$\Delta = 100^\circ 33' 00''$ (RT)
$D = 6^\circ 36' 58''$	$D = 10^\circ 53' 33''$	$D = 19^\circ 41' 22''$
$R = 866.00'$	$R = 526.01'$	$R = 350.20'$
$T = 93.58'$	$T = 77.92'$	$T = 510.68'$
$L = 186.44'$	$L = 154.71'$	$L = 291.00'$
$E = 5.04'$	$E = 5.74'$	$E = 164.32'$
P.C. STA. = 0+00.00	P.C. STA. = 1+86.44	P.C. STA. = 3+41.15
P.T. STA. = 1+86.44	P.T. STA. = 3+41.15	P.T. STA. = 8+51.83

EXIST. ☉ NB I-55 EXIT TO US 52	
CURVE EN52EXT-1	CURVE EN52EXT-2
EXIST. CURVE EN52EXT-1	EXIST. CURVE EN52EXT-2
PI STA. = 5208+74.78	PI STA. = 5215+06.15
$\Delta = 24^\circ 26' 31''$ (RT)	$\Delta = 37^\circ 15' 00''$ (LT)
$D = 6^\circ 42' 56''$	$D = 14^\circ 19' 26''$
$R = 853.17'$	$R = 400.00'$
$T = 184.79'$	$T = 134.81'$
$L = 363.96'$	$L = 260.05'$
$E = 19.78'$	$E = 22.11'$
P.C. STA. = 5206+89.99	P.C. STA. = 5213+71.34
P.T. STA. = 5210+53.95	P.T. STA. = 5216+31.40

EXIST. ☉ SB I-55 EXIT TO US 52	
CURVE ES52EXT-1	CURVE ES52EXT-2
EXIST. CURVE ES52EXT-1	EXIST. CURVE ES52EXT-2
PI STA. = 5258+77.52	PI STA. = 5265+16.07
$\Delta = 24^\circ 26' 31''$ (RT)	$\Delta = 37^\circ 15' 00''$ (LT)
$D = 6^\circ 42' 56''$	$D = 14^\circ 19' 26''$
$R = 853.17'$	$R = 400.00'$
$T = 184.79'$	$T = 134.81'$
$L = 363.96'$	$L = 260.05'$
$E = 19.78'$	$E = 22.11'$
P.C. STA. = 5256+92.73	P.C. STA. = 5263+81.26
P.T. STA. = 5260+56.68	P.T. STA. = 5266+41.32

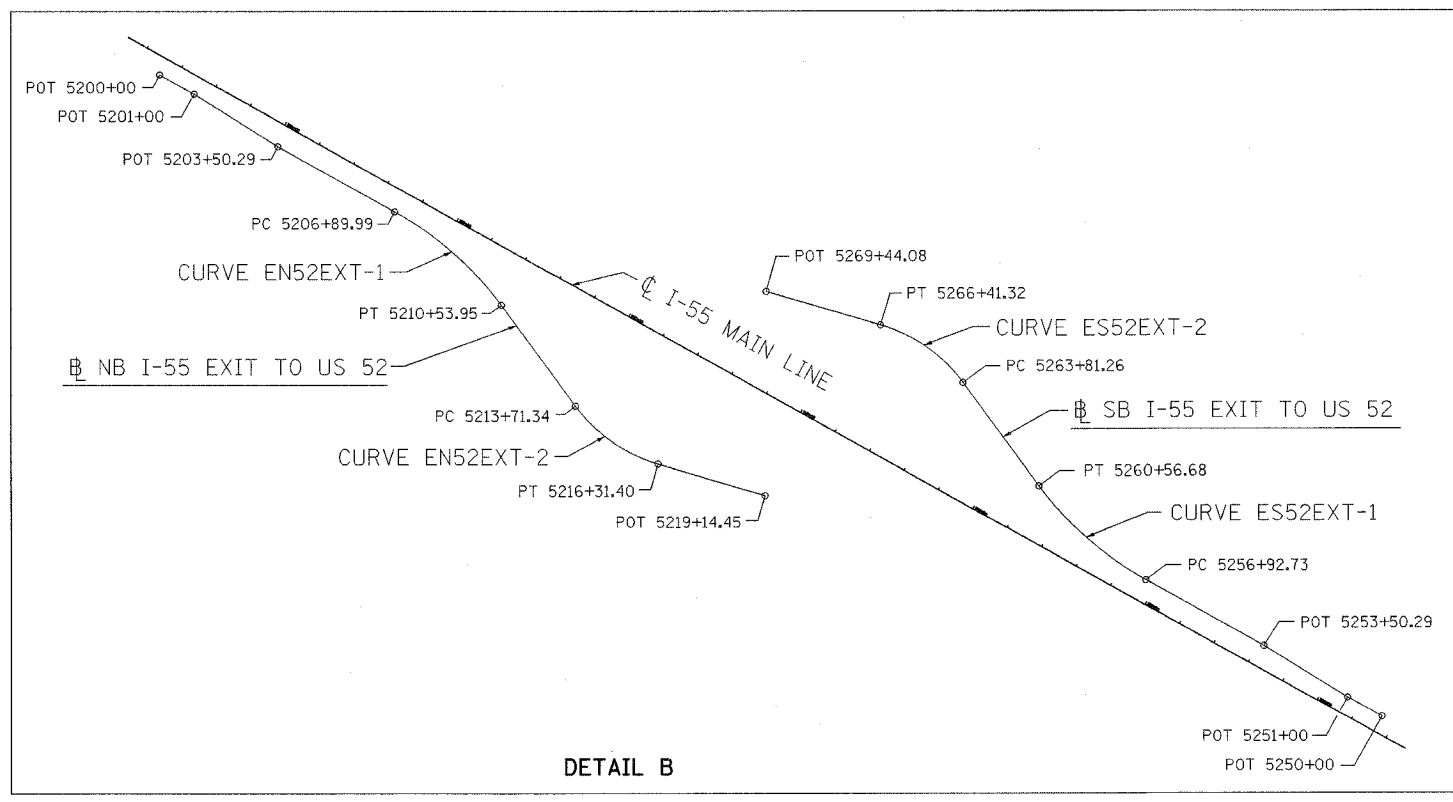

REVISIONS	
NAME	DATE

ILLINOIS DEPARTMENT OF TRANSPORTATION
 FAI ROUTE 55 (I-80 TO BLACK ROAD)
 WIDENING AND RESURFACING

ALIGNMENT, TIES AND BENCHMARKS
 I

SCALE: DRAWN BY OP
 DATE 03/22/07 CHECKED BY DDH

TENG TENG & ASSOCIATES, INC.
 ENGINEERS/ARCHITECTS/PLANNERS
 CHICAGO, ILLINOIS

PLOT DATE = 03/22/07
 PLOT SCALE = 1"=100'
 USER NAME = MUSEM