

F.A.I. ROUTE	SECTION	COUNTY	TOTAL SHEETS	SHEET NO.
55	99 (I&2) WRS	WILL	334	128
STA. 202+00.00		TO STA. 217+00.00		
FED. ROAD DIST. NO.		ILLINOIS FED. AID PROJECT		

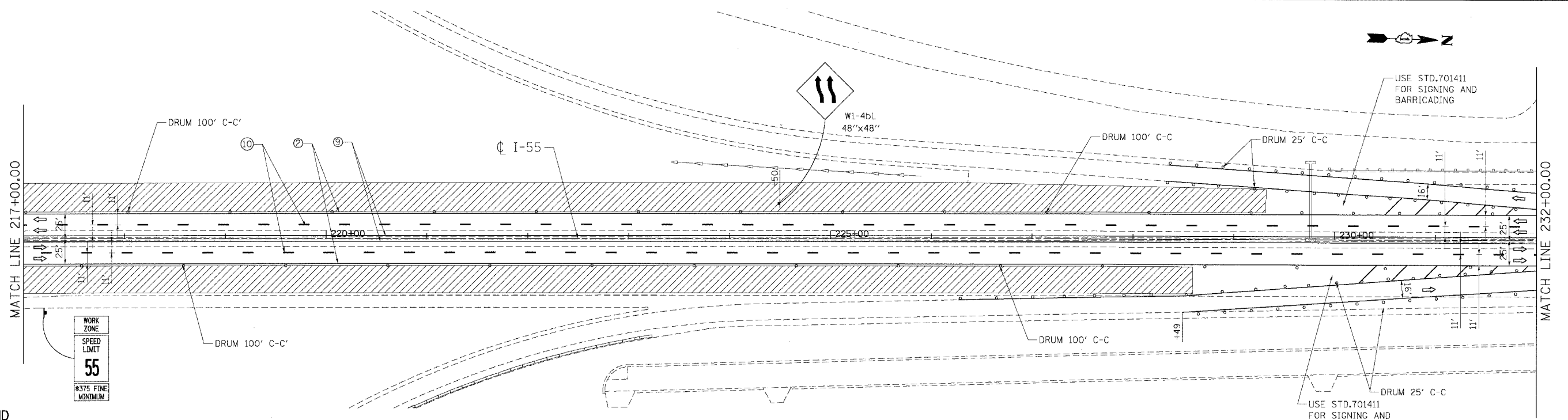
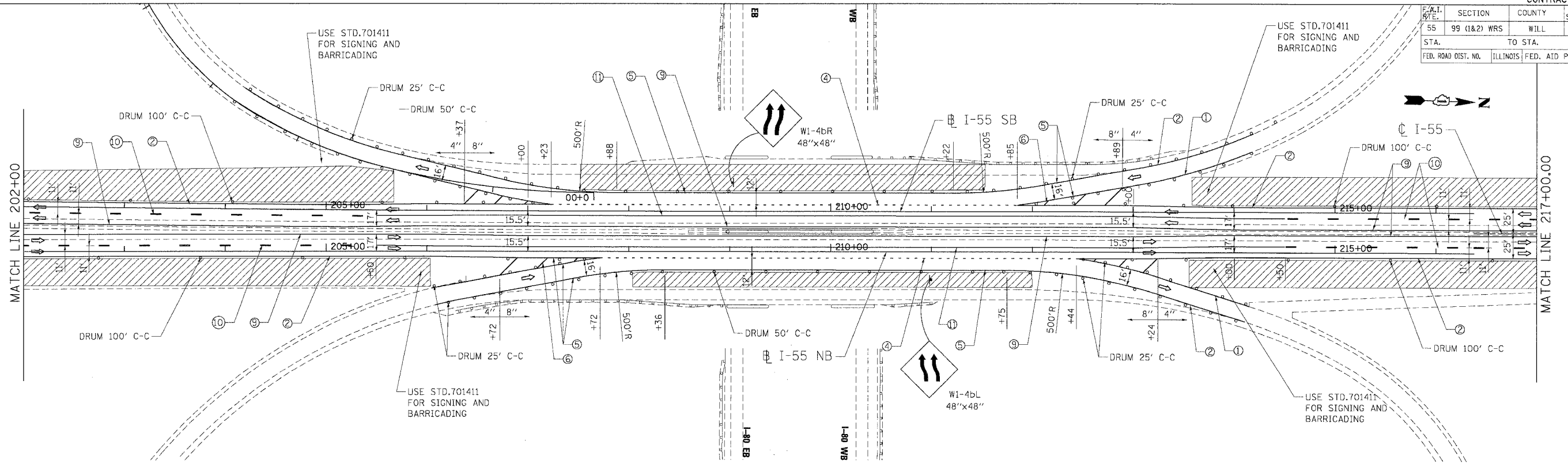

**LEGEND**

- WORK AREA
- DRUMS W/ MONO-DIRECTIONAL STEADY BURN LIGHT
- VERTICAL PANEL
- TEMPORARY CONC. BARRIER
- TRAFFIC FLOW
- BARRICADE, TYPE III WITH TWO FLASHING LIGHTS
- PAVT. MARKING TAPE, TYPE III, 4", YELLOW
- PAVT. MARKING TAPE, TYPE III, 4", WHITE
- PAVT. MARKING TAPE, TYPE III, 5", WHITE (10' DASH 30' SKIP)
- PAVT. MARKING TAPE, TYPE III, 4", WHITE (2' DASH 6' SKIP)
- PAVT. MARKING TAPE, TYPE III, 8", WHITE
- PAVT. MARKING TAPE, TYPE III, 12", WHITE
- PAVT. MARKING TAPE, TYPE III, 5", WHITE
- EPOXY PAVT. MARKING LINE 4", WHITE
- EPOXY PAVT. MARKING LINE 4", YELLOW
- EPOXY PAVT. MARKING LINE 5", WHITE (10" DASH 30' SKIP)
- EPOXY PAVT. MARKING LINE 5", WHITE

REVISIONS	
NAME	DATE

ILLINOIS DEPARTMENT OF TRANSPORTATION  
 FAI ROUTE 55 (I-80 TO BLACK ROAD)  
 WIDENING AND RESURFACING

**STAGING AND TRAFFIC CONTROL  
 FAI 55 - STAGE II  
 STA. 202+00.00 TO STA. 232+00.00**

SCALE: 1"=50'  
 DATE 03/15/07

DRAWN BY AG  
 CHECKED BY DDH

**TENG**  
 TENG & ASSOCIATES, INC.  
 ENGINEERS/ARCHITECTS/PLANNERS  
 CHICAGO, ILLINOIS

PLOT DATE = 03/15/07  
 FILE NAME = STAGING  
 PLOT SCALE = 1"=50'  
 USER NAME = JWB