

CONTRACT NO. 62895

F.A.I. RTE.	SECTION	COUNTY	TOTAL SHEETS	SHEET NO.
55	99 (1&2) WRS	WILL	334	145
STA. TO STA.				
FED. ROAD DIST. NO.	ILLINOIS	FED. AID PROJECT		

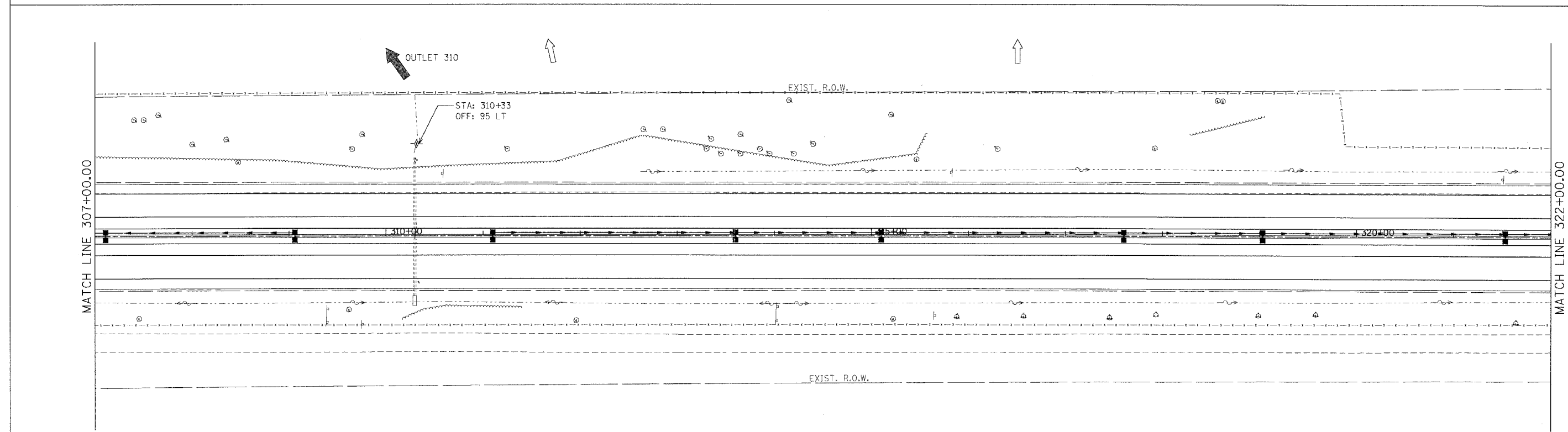
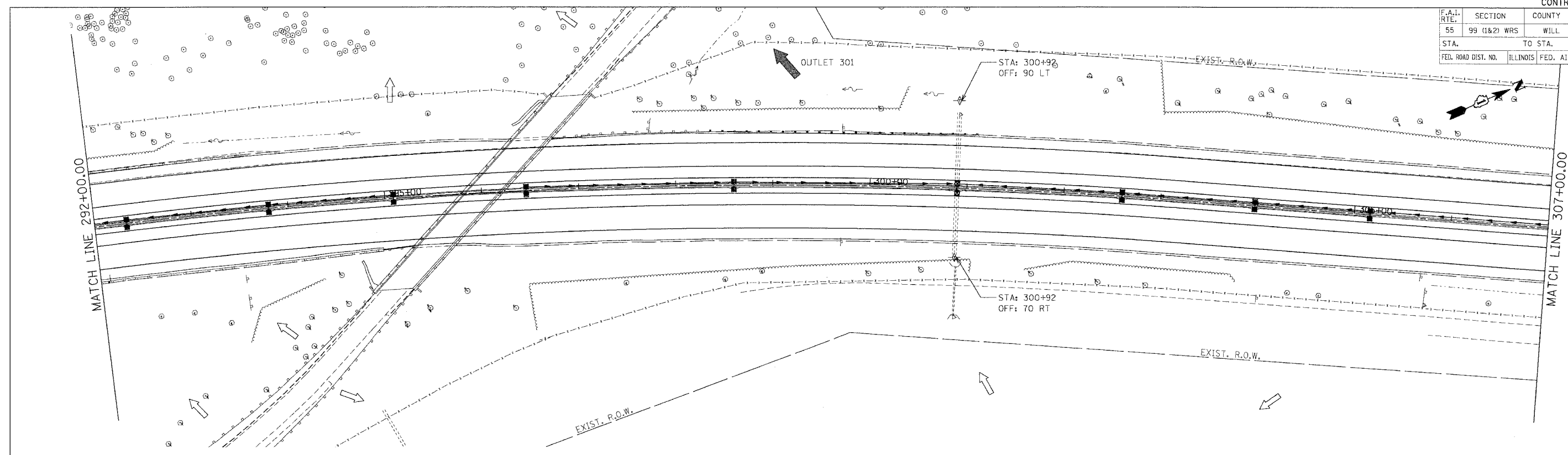

PLOT DATE = 03/15/07  
 FILE NAME = #FILE#  
 PLOT SCALE = #SCALE#  
 USER NAME = #USER#

- LEGEND**
- ◊ INLET FILTERS
  - ⊡ TEMPORARY DITCH CHECK
  - ▨ TEMPORARY EROSION CONTROL SEEDING AND MULCH METHOD 2
  - ▩ RIPRAP CLASS A3 & A4
  - TEMPORARY SILT FENCE

- NOTES:**
- FOR PERMANENT STRUCTURE, PERMANENT PIPE AND SEDIMENT CONTROL INLET FILTER, SEE DRAINAGE SCHEDULES, SHEETS 169 TO 175.
- OUTLET  
 SHEET FLOW

REVISIONS	
NAME	DATE

ILLINOIS DEPARTMENT OF TRANSPORTATION  
 FAI ROUTE 55 (I-80 TO BLACK ROAD)  
 WIDENING AND RESURFACING

**EROSION AND SEDIMENT CONTROL  
 FAI 55  
 STA. 292+00.00 TO STA. 322+00.00**

SCALE: 1"=50'  
 DATE: 03/15/07

DRAWN BY: SN  
 CHECKED BY: TKL

**TENG** ENGINEERS/ARCHITECTS/PLANNERS  
 CHICAGO, ILLINOIS