

F.A.I. RTE.	SECTION	COUNTY	TOTAL SHEETS	SHEET NO.
55	99 (I&2) WRS	WILL	334	160
STA. TO STA.		ILLINOIS FED. AID PROJECT		
FED. ROAD DIST. NO.				

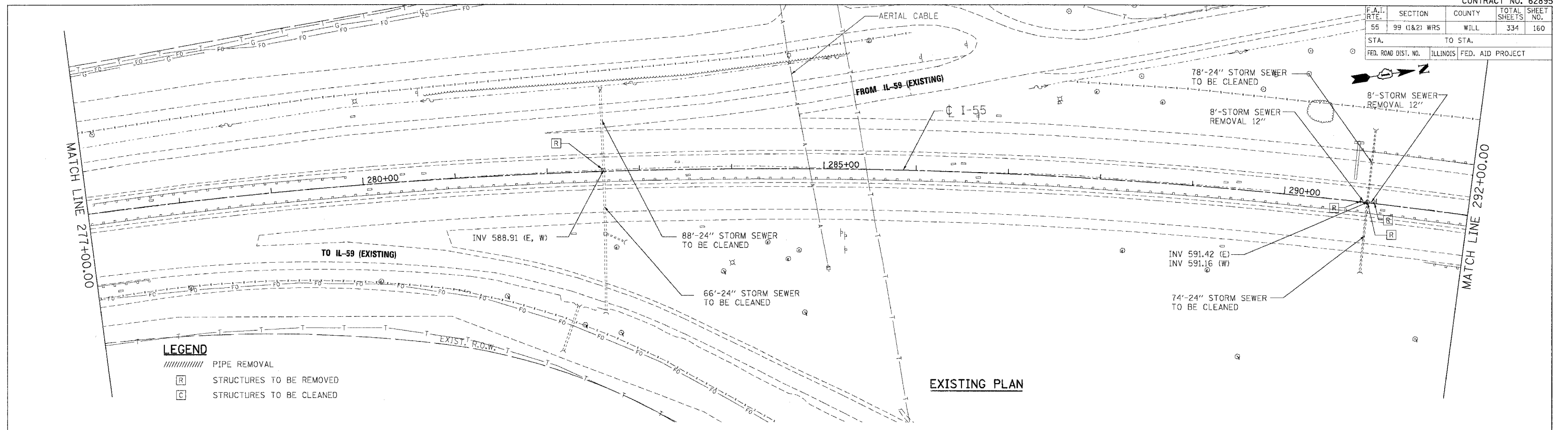

LEGEND

////	PIPE REMOVAL
[R]	STRUCTURES TO BE REMOVED
[C]	STRUCTURES TO BE CLEANED

EXISTING PLAN

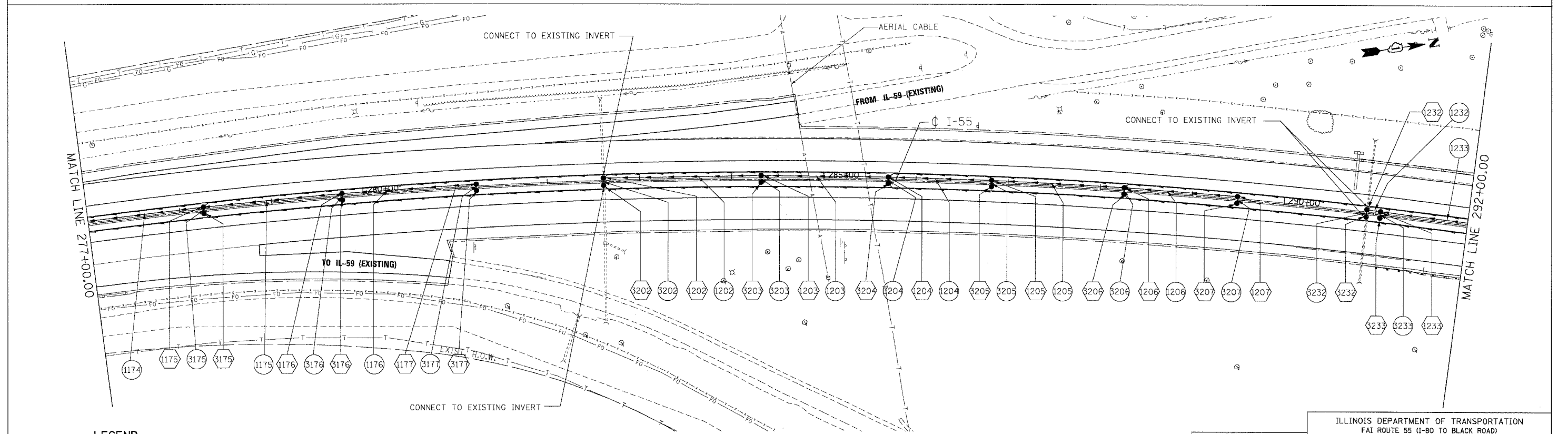

LEGEND

(1001)	STRUCTURE NUMBER	●	CATCH BASIN
GR	GRATING FOR STRUCTURE	○	MANHOLE
(1001)	PIPE NUMBER	▲	FLARED END SECTION
→	STORM SEWER	⌋	HEADWALL
		—	PIPE UNDERDRAINS

NOTES

- FOR STRUCTURE AND PIPE INFORMATION SEE DRAINAGE SCHEDULES, SHEETS 169, 170, 171, 172, 173, 174 AND 175.
- PROPOSED SEWER AND CULVERT CROSSING BENEATH THE EXISTING PAVEMENT SHALL BE CONSTRUCTED DURING PRE-STAGE PER THE STAGING AND TRAFFIC CONTROL PLANS. SEE ROADWAY PLANS FOR PATCHING DETAILS.

PROPOSED PLAN

REVISIONS	
NAME	DATE

ILLINOIS DEPARTMENT OF TRANSPORTATION
 FAI ROUTE 55 (I-80 TO BLACK ROAD)
 WIDENING AND RESURFACING

DRAINAGE AND UTILITY PLAN
FAI 55
STA. 277+00.00 TO STA. 292+00.00

SCALE: 1"=50'
 DATE 03/15/07
 DRAWN BY WRK
 CHECKED BY TKL

TENG
 TENG & ASSOCIATES, INC.
 ENGINEERS/ARCHITECTS/PLANNERS
 CHICAGO, ILLINOIS

PLOT DATE = 04/01/07
 FILE NAME = 81515.DWG
 PLOT SCALE = 1"=50'
 USER NAME = 40598