

F.A.I. RTE.	SECTION	COUNTY	TOTAL SHEETS	SHEET NO.
55	99 (I&2) WRS	WILL	334	163
STA.		TO STA.		
FED. ROAD DIST. NO.		ILLINOIS FED. AID PROJECT		

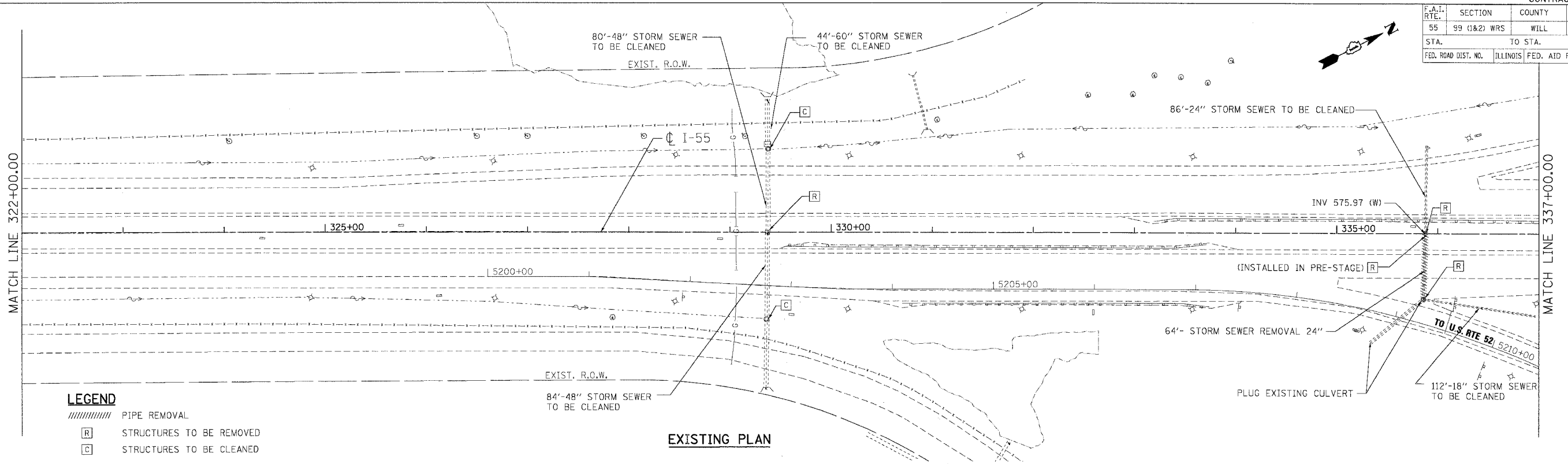

**LEGEND**

////////// PIPE REMOVAL

[R] STRUCTURES TO BE REMOVED

[C] STRUCTURES TO BE CLEANED

**EXISTING PLAN**

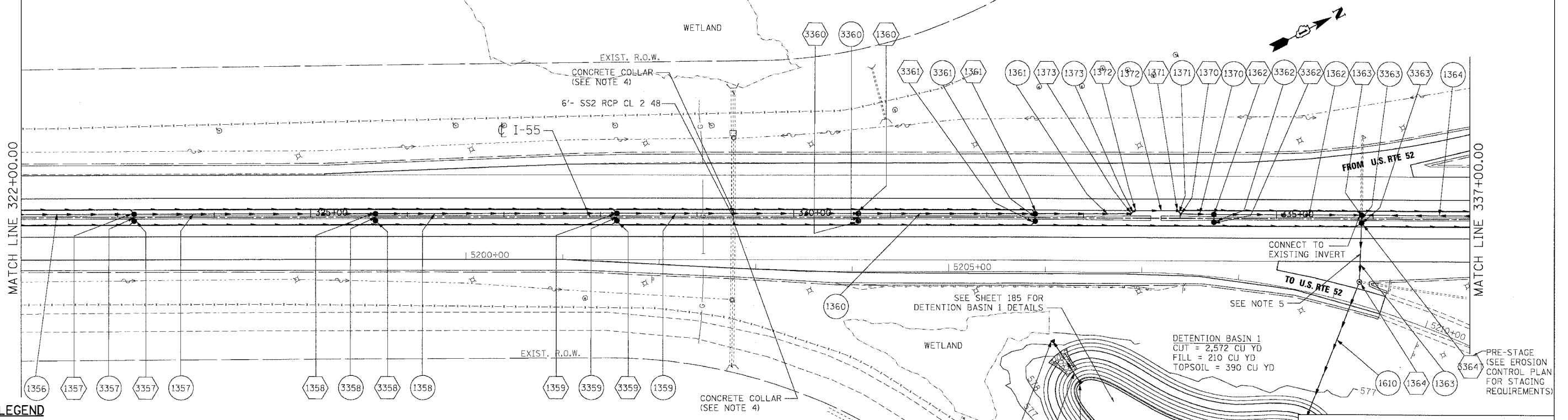

**LEGEND**

(100) STRUCTURE NUMBER

(100) GR GRATING FOR STRUCTURE

(100) PIPE NUMBER

→ STORM SEWER

● CATCH BASIN

○ MANHOLE

▴ FLARED END SECTION

⊂ HEADWALL

— PIPE UNDERDRAINS

**NOTES**

1. FOR STRUCTURE AND PIPE INFORMATION SEE DRAINAGE SCHEDULES, SHEETS 169, 170, 171, 172, 173, 174 AND 175.

2. PROPOSED SEWER AND CULVERT CROSSING BENEATH THE EXISTING PAVEMENT SHALL BE CONSTRUCTED DURING PRE-STAGE PER THE STAGING AND TRAFFIC CONTROL PLANS. SEE ROADWAY PLANS FOR PATCHING DETAILS.

3. FOR DETENTION BASIN 1 DETAILS SEE DRAINAGE DETAILS, DETENTION BASINS 1&2, SHEET 185.

4. SEE DISTRICT 1 DETAIL BD-7 FOR CONCRETE COLLAR DETAILS.

5. STORM SEWER LATERALS SHALL BE INSTALLED PER THE STAGING AND TRAFFIC CONTROL TYPICAL SECTIONS FOR PRE-STAGE (SEE SHEET 111). THE CONTRACTOR SHALL BEGIN CONSTRUCTION OF THIS STORM SEWER LATERAL WHEN PRECIPITATION IS NOT INCLUDED IN THE NATIONAL OCEANIC AND ATMOSPHERIC ADMINISTRATION'S NATIONAL WEATHER SERVICE FORECAST FOR THE 48 HOUR PERIOD FOLLOWING THE START OF CONSTRUCTION OF THIS STORM SEWER LATERAL ([HTTP://WWW.NWS.NOAA.GOV](http://www.nws.noaa.gov)). PRE-STAGE, PHASE II SHALL BE COMPLETED WITHIN 36 HOURS OF COMPLETING PRE-STAGE, PHASE I FOR THIS STORM SEWER LATERAL.

**PROPOSED PLAN**

REVISIONS	
NAME	DATE

ILLINOIS DEPARTMENT OF TRANSPORTATION  
FAI ROUTE 55 (I-80 TO BLACK ROAD)  
WIDENING AND RESURFACING

**DRAINAGE AND UTILITY PLAN  
FAI 55  
STA. 322+00.00 TO STA. 337+00.00**

SCALE: 1"=50'  
DATE 03/15/07

DRAWN BY MRK  
CHECKED BY TKL

**TENG**  
TENG & ASSOCIATES, INC.  
ENGINEERS/ARCHITECTS/PLANNERS  
CHICAGO, ILLINOIS

PLOT DATE = #DATE#  
PLOT SCALE = #SCALE#  
USER NAME = #USER#