

| F.A.I. RTE. | SECTION | COUNTY | TOTAL SHEETS | SHEET NO. |
|---|--------------|--------|--------------|-----------|
| 55 | 99 (I&2) R-6 | WILL | 185 | 185 |
| STA. TO STA. | | | | |
| FED. ROAD DIST. NO. ILLINOIS FED. AID PROJECT | | | | |

DETENTION BASIN 1 INFORMATION

100-YEAR
 DETENTION VOLUME REQUIRED = 1.082 AC-FT
 DETENTION VOLUME PROVIDED = 1.265 AC-FT
 HIGH WATER ELEVATION = 579.0
 MAX. RELEASE RATE = 14.8 CFS
 WATER QUALITY VOLUME REQUIRED = 0.160 AC-FT
 WATER QUALITY VOLUME PROVIDED = 0.160 AC-FT

NOTES

- IF THE BEDROCK GRADE WILL NOT ALLOW THE CONSTRUCTION OF THE PROPOSED WET BOTTOM DETENTION BASIN, THE BASIN WILL BE CONSTRUCTED AS A DRY BOTTOM DETENTION BASIN. THE BOTTOM ELEVATION MAY BE RAISED TO 575.2 AND STILL PROVIDE THE REQUIRED 100-YR DETENTION VOLUME.
- FOR STRUCTURE AND PIPE INFORMATION SEE DRAINAGE SCHEDULES, SHEETS 169, 170, 171, 172, 173, 174 AND 175.

| STATION | CONTOUR OFFSET AT: | | | |
|---------|--------------------|-------|-------|-------|
| | 580.0 | 574.5 | 574.5 | 580.0 |
| 332+71 | 178.0 | -- | -- | 178.0 |
| 332+80 | 156.7 | -- | -- | 205.6 |
| 332+90 | 149.3 | -- | -- | 218.8 |
| 333+00 | 146.1 | 168.9 | 195.8 | 229.6 |
| 333+10 | 145.5 | 167.6 | 208.3 | 238.8 |
| 333+20 | 147.0 | 170.0 | 218.3 | 247.0 |
| 333+30 | 150.2 | 174.3 | 226.9 | 254.3 |
| 333+40 | 154.7 | 179.8 | 234.5 | 260.7 |
| 333+50 | 160.1 | 185.7 | 241.0 | 266.1 |
| 333+60 | 166.0 | 191.6 | 246.5 | 270.4 |
| 333+70 | 172.0 | 197.4 | 250.7 | 273.5 |
| 333+80 | 177.8 | 202.6 | 253.3 | 275.4 |
| 333+90 | 183.0 | 207.2 | 253.9 | 275.9 |
| 334+00 | 187.6 | 211.2 | 253.0 | 275.2 |
| 334+10 | 191.5 | 214.7 | 251.0 | 273.5 |
| 334+20 | 194.7 | 217.5 | 248.5 | 271.2 |
| 334+30 | 197.3 | 219.8 | 246.2 | 268.7 |
| 334+40 | 199.2 | 221.5 | 244.7 | 266.8 |
| 334+50 | 200.4 | 222.5 | 244.2 | 266.2 |
| 334+60 | 200.9 | 222.9 | 244.6 | 266.7 |
| 334+70 | 200.7 | 222.7 | 245.8 | 268.0 |
| 334+80 | 200.1 | 222.2 | 247.5 | 269.8 |
| 334+90 | 199.6 | 221.6 | 249.4 | 271.7 |
| 335+00 | 199.5 | 221.4 | 250.8 | 272.9 |
| 335+10 | 200.0 | 222.1 | 250.5 | 272.7 |
| 335+20 | 201.6 | 225.0 | 246.6 | 270.7 |
| 335+30 | 205.4 | -- | -- | 266.3 |
| 335+40 | 212.8 | -- | -- | 258.6 |
| 335+50 | 236.2 | -- | -- | 236.2 |

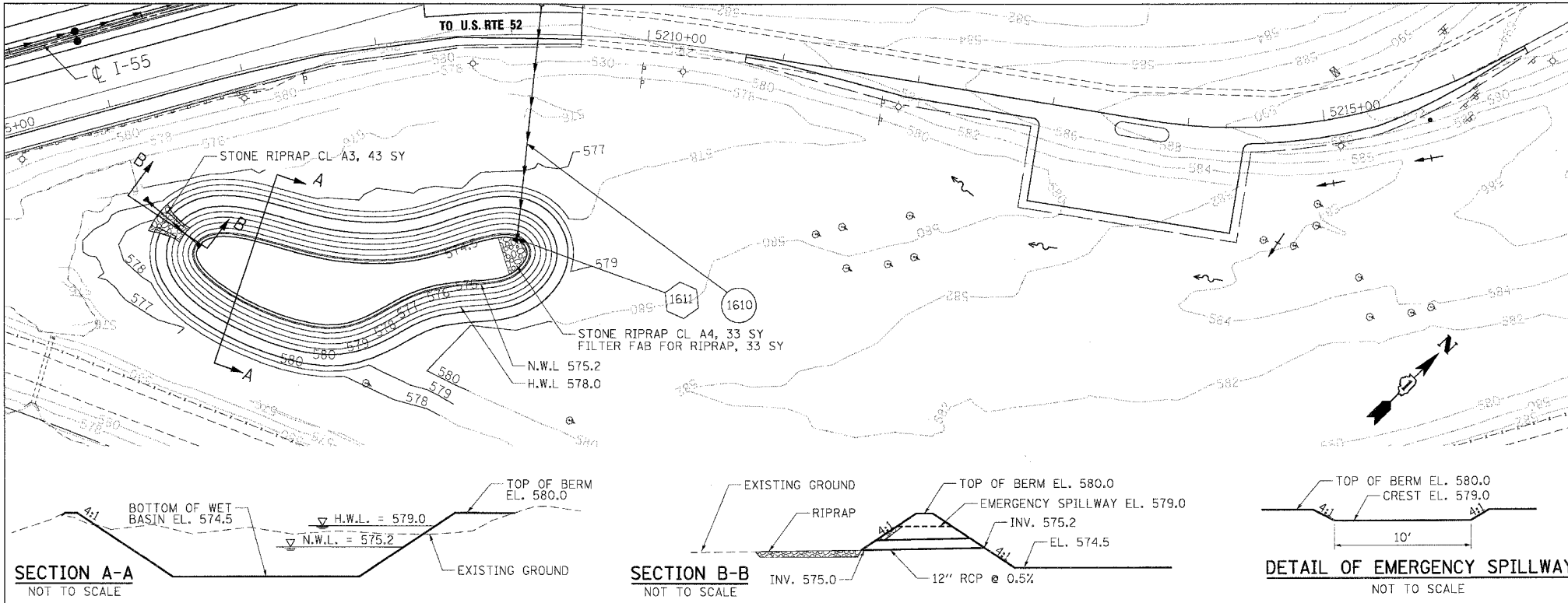

SECTION A-A
NOT TO SCALE

SECTION B-B
NOT TO SCALE

DETAIL OF EMERGENCY SPILLWAY
NOT TO SCALE

DETENTION BASIN 1

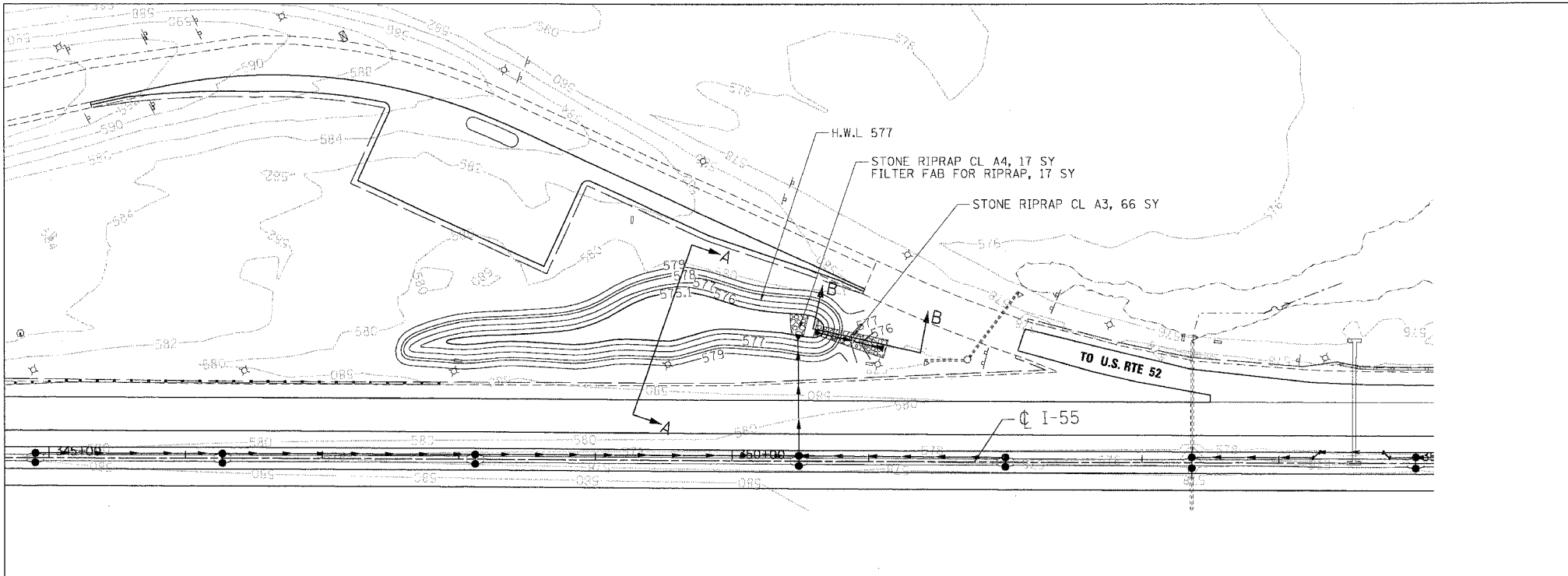

SECTION A-A
NOT TO SCALE

SECTION B-B
NOT TO SCALE

DETAIL OF EMERGENCY SPILLWAY
NOT TO SCALE

DETENTION BASIN 2

| STATION | CONTOUR OFFSET AT: | | | |
|---------|--------------------|--------|-------|-------|
| | 578.0 | 575.1 | 575.1 | 578.0 |
| 347+58 | -79.7 | -- | -- | -79.7 |
| 347+60 | -84.3 | -- | -- | -75.2 |
| 347+70 | -90.8 | -- | -- | -73.3 |
| 347+80 | -94.5 | -- | -- | -72.8 |
| 347+90 | -97.4 | -85.9 | -84.2 | -72.0 |
| 348+00 | -99.4 | -88.0 | -83.0 | -71.6 |
| 348+10 | -100.7 | -89.0 | -88.5 | -71.9 |
| 348+20 | -101.5 | -89.8 | -84.7 | -73.0 |
| 348+30 | -101.9 | -90.3 | -85.6 | -74.0 |
| 348+40 | -102.3 | -90.7 | -85.7 | -74.1 |
| 348+50 | -102.9 | -91.2 | -85.3 | -73.7 |
| 348+60 | -103.5 | -91.9 | -84.7 | -73.1 |
| 348+70 | -101.4 | -92.7 | -84.2 | -72.6 |
| 348+80 | -103.0 | -94.2 | -84.0 | -72.2 |
| 348+90 | -108.7 | -96.6 | -84.0 | -72.4 |
| 349+00 | -112.8 | -100.1 | -85.5 | -73.8 |
| 349+10 | -118.6 | -105.1 | -87.1 | -75.4 |
| 349+20 | -124.3 | -111.0 | -87.8 | -76.4 |
| 349+30 | -128.5 | -116.1 | -87.6 | -76.0 |
| 349+40 | -131.4 | -119.5 | -87.1 | -75.5 |
| 349+50 | -133.4 | -121.7 | -86.8 | -75.1 |

| STATION | CONTOUR OFFSET AT: | | | |
|---------|--------------------|--------|-------|-------|
| | 578.0 | 575.1 | 575.1 | 578.0 |
| 349+60 | -133.8 | -122.1 | -88.8 | -76.8 |
| 349+70 | -133.2 | -121.4 | -92.3 | -80.0 |
| 349+80 | -130.9 | -118.8 | -95.4 | -83.4 |
| 349+90 | -127.7 | -115.5 | -96.9 | -85.3 |
| 350+00 | -124.5 | -112.4 | -96.7 | -85.1 |
| 350+10 | -121.7 | -109.8 | -95.8 | -84.1 |
| 350+20 | -119.8 | -108.1 | -95.0 | -83.4 |
| 350+30 | -118.7 | -107.0 | -94.6 | -83.0 |
| 350+40 | -118.1 | -106.4 | -93.4 | -81.6 |
| 350+50 | -117.5 | -105.8 | -91.4 | -79.6 |
| 350+60 | -115.9 | -103.5 | -90.7 | -79.1 |
| 350+70 | -110.5 | -- | -- | -82.7 |
| 350+76 | -95.6 | -- | -- | -95.6 |

DETENTION BASIN 2 INFORMATION

100-YEAR
 DETENTION VOLUME REQUIRED = 0.271 AC-FT
 DETENTION VOLUME PROVIDED = 0.297 AC-FT
 HIGH WATER ELEVATION = 577.0
 RELEASE RATE = 1.02 CFS

NOTES

- FOR STRUCTURE AND PIPE INFORMATION SEE DRAINAGE SCHEDULES, SHEETS 169, 170, 171, 172, 173, 174 AND 175.

| REVISIONS | |
|-----------|------|
| NAME | DATE |
| | |
| | |
| | |
| | |
| | |
| | |
| | |
| | |
| | |
| | |

ILLINOIS DEPARTMENT OF TRANSPORTATION
 FAI ROUTE 55 (I-80 TO BLACK ROAD)
 WIDENING AND RESURFACING

DRAINAGE DETAILS - I
DETENTION BASINS

SCALE: _____ DRAWN BY SN
 DATE 02/23/07 CHECKED BY TKL

TENG
 TENG & ASSOCIATES, INC.
 ENGINEERS/ARCHITECTS/PLANNERS
 CHICAGO, ILLINOIS

PLOT DATE = 02/23/07
 FILE NAME = #FILES#
 PLOT SCALE = #SCALE#
 USER NAME = #USER#