

F.A.I. RTE.	SECTION	COUNTY	TOTAL SHEETS	SHEET NO.
55	99 (I&2) WRS	WILL	334	224
STA.		TO STA.		
FED. ROAD DIST. NO.	ILLINOIS	FED. AID PROJECT		

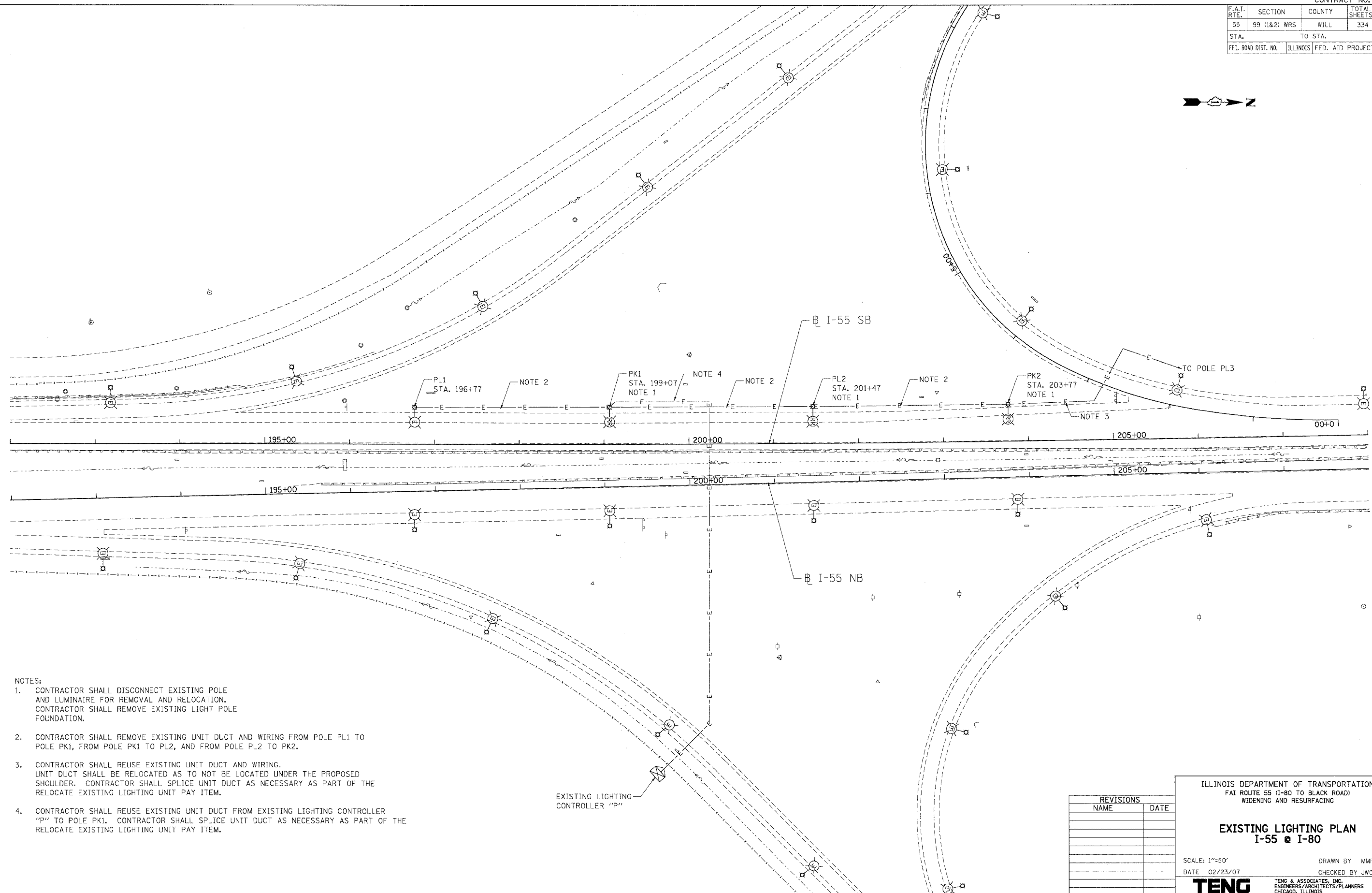

NOTES:

- CONTRACTOR SHALL DISCONNECT EXISTING POLE AND LUMINAIRE FOR REMOVAL AND RELOCATION. CONTRACTOR SHALL REMOVE EXISTING LIGHT POLE FOUNDATION.
- CONTRACTOR SHALL REMOVE EXISTING UNIT DUCT AND WIRING FROM POLE PL1 TO POLE PK1, FROM POLE PK1 TO PL2, AND FROM POLE PL2 TO PK2.
- CONTRACTOR SHALL REUSE EXISTING UNIT DUCT AND WIRING. UNIT DUCT SHALL BE RELOCATED AS TO NOT BE LOCATED UNDER THE PROPOSED SHOULDER. CONTRACTOR SHALL SPLICE UNIT DUCT AS NECESSARY AS PART OF THE RELOCATE EXISTING LIGHTING UNIT PAY ITEM.
- CONTRACTOR SHALL REUSE EXISTING UNIT DUCT FROM EXISTING LIGHTING CONTROLLER "P" TO POLE PK1. CONTRACTOR SHALL SPLICE UNIT DUCT AS NECESSARY AS PART OF THE RELOCATE EXISTING LIGHTING UNIT PAY ITEM.

EXISTING LIGHTING CONTROLLER "P"

REVISIONS	
NAME	DATE

ILLINOIS DEPARTMENT OF TRANSPORTATION  
 FAI ROUTE 55 (I-80 TO BLACK ROAD)  
 WIDENING AND RESURFACING

**EXISTING LIGHTING PLAN**  
**I-55 @ I-80**

SCALE: 1"=50'  
 DATE 02/23/07

DRAWN BY MMP  
 CHECKED BY JWO

**TENG**  
 TENG & ASSOCIATES, INC.  
 ENGINEERS/ARCHITECTS/PLANNERS  
 CHICAGO, ILLINOIS

PLT DATE = 02/23/07  
 FILE NAME = 021114.DWG  
 PLOT SCALE = 1"=50'  
 USER NAME = JWO