

F.A.I. RTE.	SECTION	COUNTY	TOTAL SHEETS	SHEET NO.
55	99 (I&Z) WRS	WILL	334	228
STA.	TO STA.			
FED. ROAD DIST. NO.	ILLINOIS	FED. AID PROJECT		

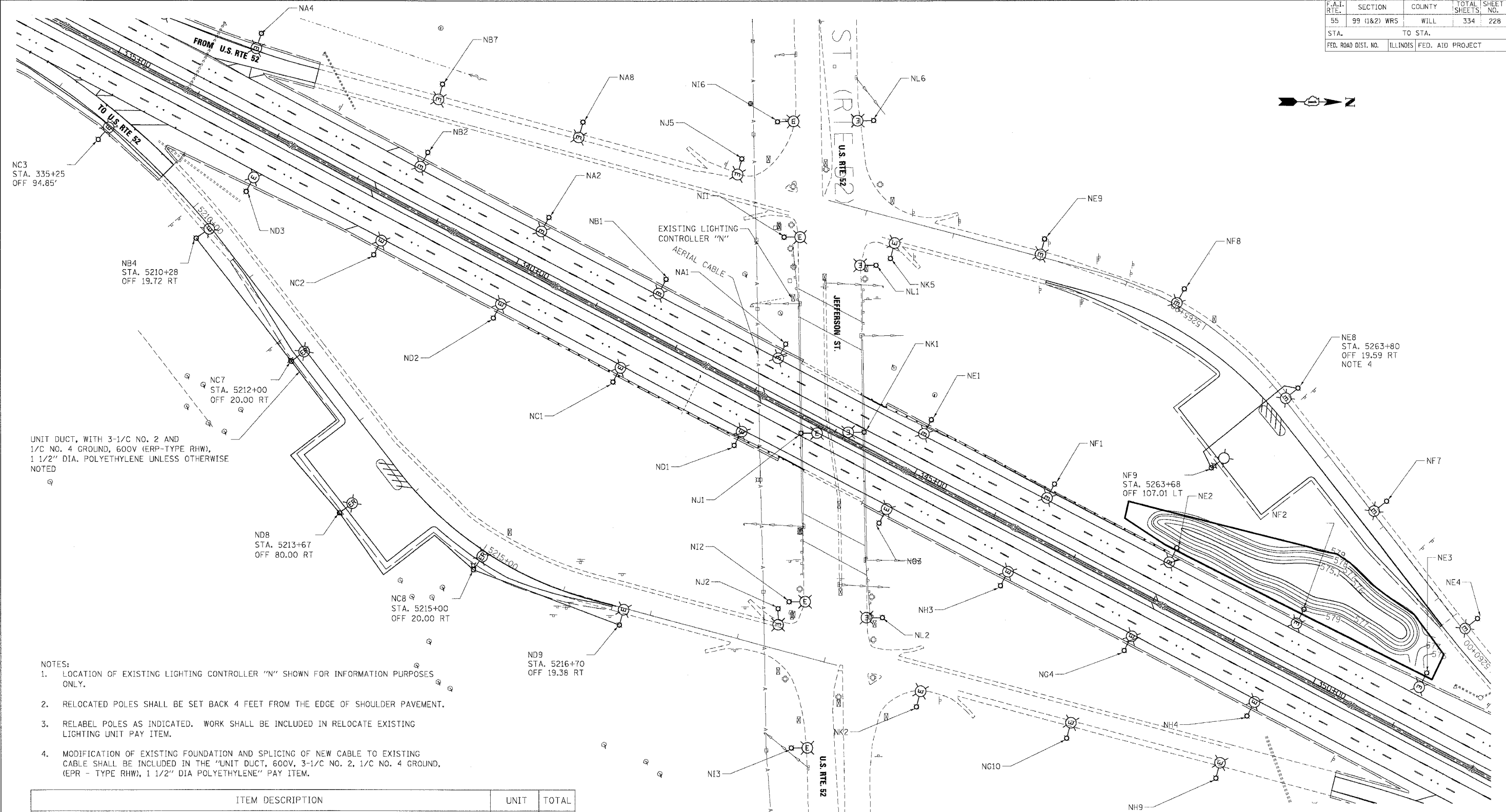

UNIT DUCT, WITH 3-1/2 NO. 2 AND 1/2 NO. 4 GROUND, 600V (EPR-TYPE RHW), 1 1/2" DIA. POLYETHYLENE UNLESS OTHERWISE NOTED

- NOTES:
1. LOCATION OF EXISTING LIGHTING CONTROLLER "N" SHOWN FOR INFORMATION PURPOSES ONLY.
  2. RELOCATED POLES SHALL BE SET BACK 4 FEET FROM THE EDGE OF SHOULDER PAVEMENT.
  3. RELABEL POLES AS INDICATED. WORK SHALL BE INCLUDED IN RELOCATE EXISTING LIGHTING UNIT PAY ITEM.
  4. MODIFICATION OF EXISTING FOUNDATION AND SPLICING OF NEW CABLE TO EXISTING CABLE SHALL BE INCLUDED IN THE "UNIT DUCT, 600V, 3-1/2 NO. 2, 1/2 NO. 4 GROUND, (EPR - TYPE RHW), 1 1/2" DIA POLYETHYLENE" PAY ITEM.

ITEM DESCRIPTION	UNIT	TOTAL
GROUND ROD, 5/8" DIA. x 10FT	EACH	4
UNIT DUCT, 600V, 3-1/2 NO. 2, 1/2 NO. 4 GROUND, (EPR-TYPE RHW), 1 1/2" DIA. POLYETHYLENE	FOOT	935
LIGHT POLE FOUNDATION, 24" DIA.	FOOT	38.0
POLE FOUNDATION, REMOVED	EACH	3
RELOCATE EXISTING LIGHTING UNIT	EACH	3
TRENCH AND BACKFILL FOR ELECTRICAL WORK	FOOT	935
MAINTENANCE OF LIGHTING SYSTEM	CAL MO	12
LUMINAIRE, SODIUM VAPOR, HORIZONTAL MOUNT, 400W	EACH	1
LIGHT POLE, ALUMINUM, 47.5FT M.H., 15FT MAST ARM	EACH	1
BREAKAWAY DEVICE, COUPLING, WITH ALUMINUM SKIRT	EACH	1

REVISIONS	
NAME	DATE

ILLINOIS DEPARTMENT OF TRANSPORTATION  
 FAI ROUTE 55 (I-80 TO BLACK ROAD)  
 WIDENING AND RESURFACING

**PROPOSED LIGHTING PLAN  
 US 52 & I-55**

SCALE: 1"=50'  
 DATE: 02/23/07  
 DRAWN BY: MMP  
 CHECKED BY: JWO

**TENG**  
 TENG & ASSOCIATES, INC.  
 ENGINEERS/ARCHITECTS/PLANNERS  
 CHICAGO, ILLINOIS

PLOT DATE = 02/23/07  
 FILE NAME = #SCALE#  
 PLOT SCALE = #SCALE#  
 USER NAME = #USER#