

F.A.I. RTE.	SECTION	COUNTY	TOTAL SHEETS	SHEET NO.
55	99 (1&2) WRS	WILL	334	257
STA.		TO STA.		
FED. ROAD DIST. NO.		ILLINOIS FED. AID PROJECT		

**BENCHMARK:**

TBM#1 Top of a large nail set in the east face of power pole on west side of West Frontage Rd. near Interstate 55 Sta. 116+00. El. 595.91 (NGVD 29 Vertical Datum)

**SALVAGE:**

None.

**STAGING:**

Traffic will be maintained on existing NB IL 59 Exit Ramp Bridge (S.N. 099-0030).

ELEVATIONS SHOWN ON SHEETS 257 THRU 262 ARE BASED ON NGVD 29 VERTICAL DATUM, WHILE ALL OTHER CONTRACT 62895 ELEVATIONS ARE BASED ON NAVD 88 VERTICAL DATUM. ELEVATIONS SHOWN ON SHEETS 257 THRU 262 MUST BE CONVERTED TO NAVD 88 VERTICAL DATUM BY SUBTRACTING 0.31 FEET FROM ELEVATIONS DENOTED.

FOR EXAMPLE:  
ON SHT. 257 @ BRG. PIER, STA. 8021+09.68, EL. 623.44 (NGVD 29)  
CONVERT: EL. 623.44 (NGVD 29)  
- 0.31  
EL. 623.13 (NAVD 88)  
USE EL. 623.13

**EXISTING STRUCTURE:**

S.N. 099-0030 Four span, 269'-8" back to back of abutments, continuous steel multi-beam bridge on multi-column concrete piers and open abutments. 26' between barriers. Existing structure is approximately 2500' north of proposed structure.

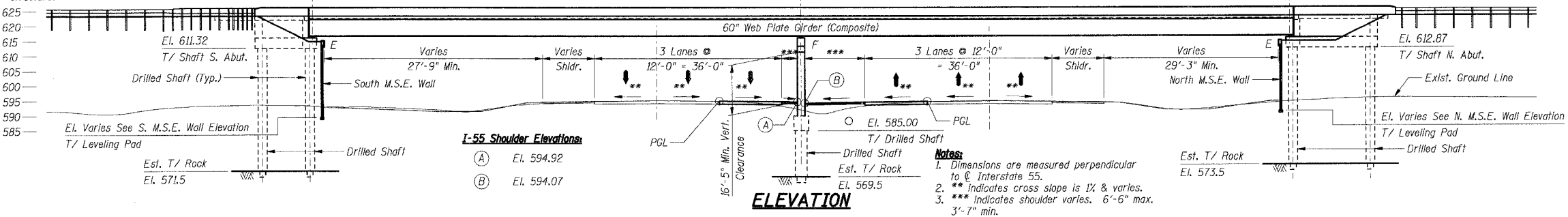

**DESIGN SPECIFICATIONS:**  
1996 AASHTO Standard Specifications for Highway Bridges 1997 thru 2002 Interim Specifications.

**DESIGN LOADING:**  
Roadway Live Load: HS 20-44  
Future Wearing Surface = 50 psf

**DESIGN STRESSES:**  
Concrete, f'c = 3,500 psi  
Reinforcement, fy = 60,000 psi  
Structural Steel, fy = 50,000 psi (M 270 Grade 50)

**SEISMIC DATA:**  
Seismic Performance Category (SPC) = A  
Bedrock Acceleration Coefficient (A) = 0.04g  
Site Coefficient (S) = 1.0



DATE 11/30/07  
EXP. 11/30/08

**APPROVED**  
FOR STRUCTURAL ADEQUACY ONLY  
S. E. Anderson (P.E.)  
ENGINEER OF BRIDGES AND STRUCTURES

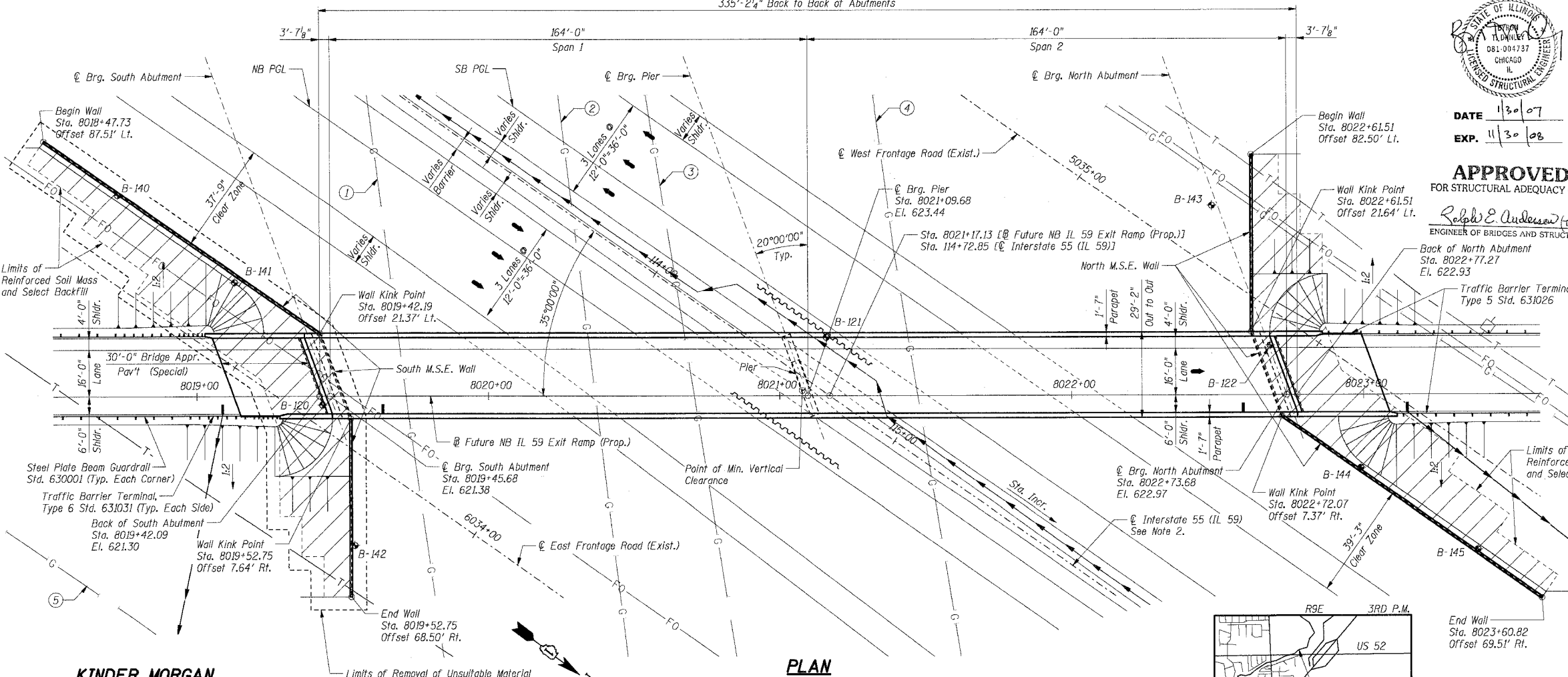
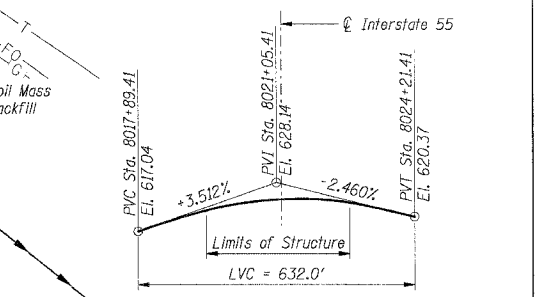
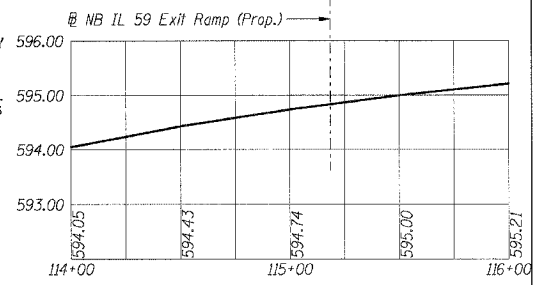
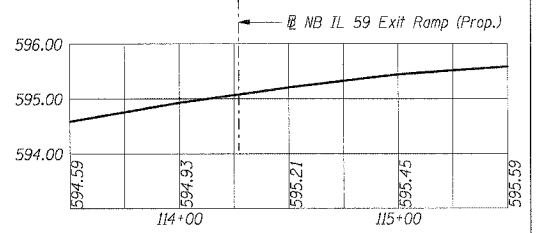

**KINDER MORGAN GAS PIPELINES**

ID	DESIGNATION	DIAMETER
1	GC #1	30"
2	AM #4	36" w/ 42" casing under roadway
3	AM #2	24"
4	GC #3	36"
5	GC #2	36"

**Notes:**

- Center pier shall be constructed under this contract. Abutments, superstructure, approach embankments, bridge approach pavements and guardrails will be constructed by others under a separate future contract.
- Center pier shall be constructed based on alignment defined as @ Future NB IL 59 Exit Ramp (Prop.). For alignment sketch and control points, see Sht. 2 of 6.

- LEGEND**
- B-0 Soil Boring Location
  - T Telephone Line
  - G Gas Line
  - FO Fiber Optic Line
  - Electrical Pole
  - Storm Sewer
  - Drainage Scupper or Inlet
  - Temporary Soil Retention System

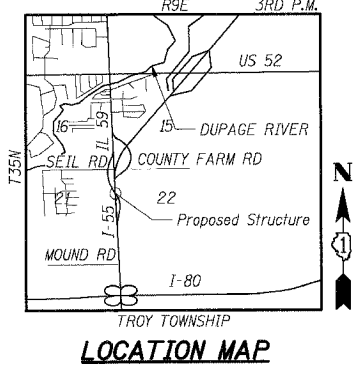

SHT. 1 OF 6

REVISIONS	
NAME	DATE

ILLINOIS DEPARTMENT OF TRANSPORTATION  
FAI ROUTE 55 (I-80 TO BLACK ROAD)  
WIDENING AND RESURFACING  
IL ROUTE 59 OVER I-55, S.N. 099-4642  
STA. 8021+17.13, SECTION 26H3-1BR & 114R-1  
WILL COUNTY

**GENERAL PLAN & ELEVATION**

SCALE: DATE 02/23/07 DRAWN BY TMH CHECKED BY MJK



PLOT DATE = 02/23/07  
 FILE NAME = S:\PROJECTS\62895\STRUCT\JOBIN\SPR6160765.SHT  
 PLOT SCALE = 1/8"=1'-0"  
 USER NAME = SIBERIS