

F.A.I. RTE.	SECTION	COUNTY	TOTAL SHEETS	SHEET NO.
55	99 (1&2) WRS-1	WILL	227	21
STA. 607+00		TO STA. 637+00		
FED. ROAD DIST. NO. 1		ILLINOIS FED. AID PROJECT		
ALIGN-02 OF 13				

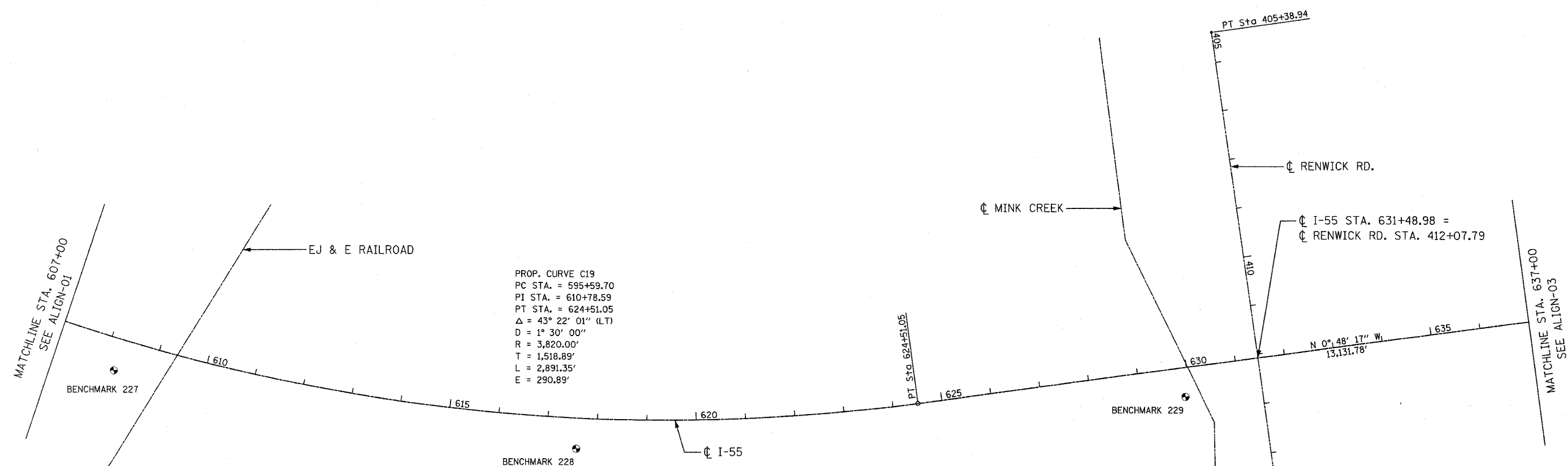

PROP. CURVE C19
 PC STA. = 595+59.70
 PI STA. = 610+78.59
 PT STA. = 624+51.05
 $\Delta = 43^\circ 22' 01''$ (LT)
 $D = 1^\circ 30' 00''$
 $R = 3,820.00'$
 $T = 1,518.89'$
 $L = 2,891.35'$
 $E = 290.89'$

CURVE C19			
PI STA.	610+78.59	N 1,792,669.4770	E 1,030,860.5160
PC STA.	595+59.70	N 1,791,550.7503	E 1,029,833.1498
PT STA.	624+51.05	N 1,794,188.2184	E 1,030,839.1839
CC		N 1,794,134.5684	E 1,027,019.5607

BENCHMARK INFORMATION

- BENCHMARK 227 CHISELED SQUARE ON SW HEADWALL OF NB I-55 BRIDGE CROSSING R.R. TRACKS NORTH OF US. RTE. 30 +/- 2050'.
- BENCHMARK 228 SET REBAR +/- 5' SE OF EXISTING PAVEMENT.
- BENCHMARK 229 CHISELED SQUARE ON SE HEADWALL OF NB I-55 BRIDGE OVER CREEK (+/- 120' SOUTH OF RENWICK RD.)
- BENCHMARK 3206 FD SQUARE CUT ON TO SE WING WALL OF BRIDGE OVER MINK CREEK AND 200' S. OF RENWICK RD. STA 474+41.65 STRUCTURE # 099-4615 N 1794728.35 E 1030890.54, ELEV. 606.27

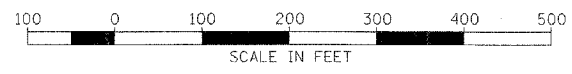

REVISIONS	
NAME	DATE

ILLINOIS DEPARTMENT OF TRANSPORTATION
 FAI ROUTE 55
 US 30 (PLAINFIELD ROAD) TO 143RD STREET

ALIGNMENTS, TIES AND
 BENCHMARKS

SCALE: 1"=100'
 DATE: 02-23-07

DRAWN BY ALR
 CHECKED BY RH

FINAL